

(Draft) **COLUMBUS AVE REPAVING PROJECT PAVEMENT MARKINGS**

Daylighting   Fire hydrant parking restriction   Existing parking restriction   Bike box   Bike crossing

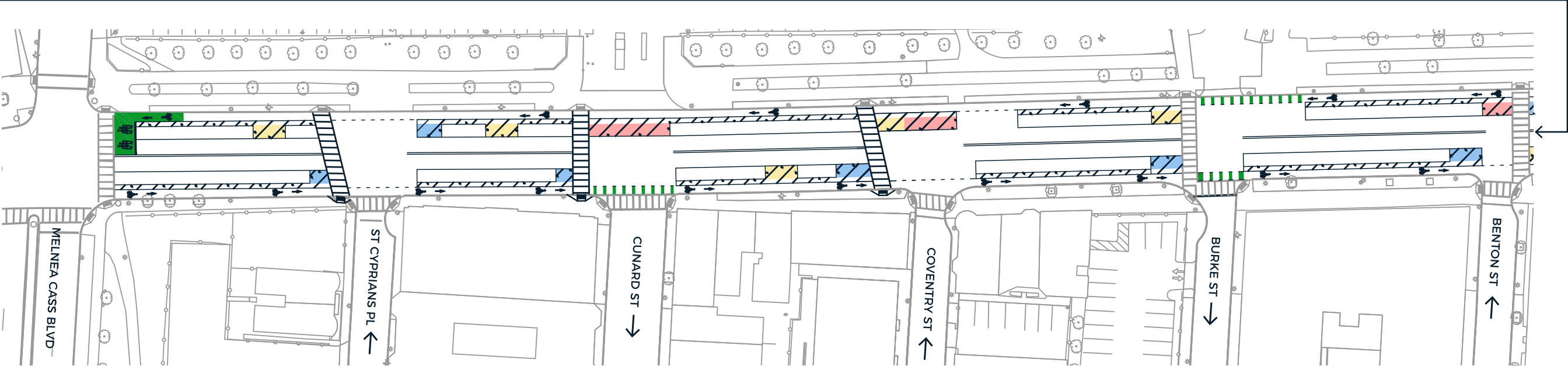
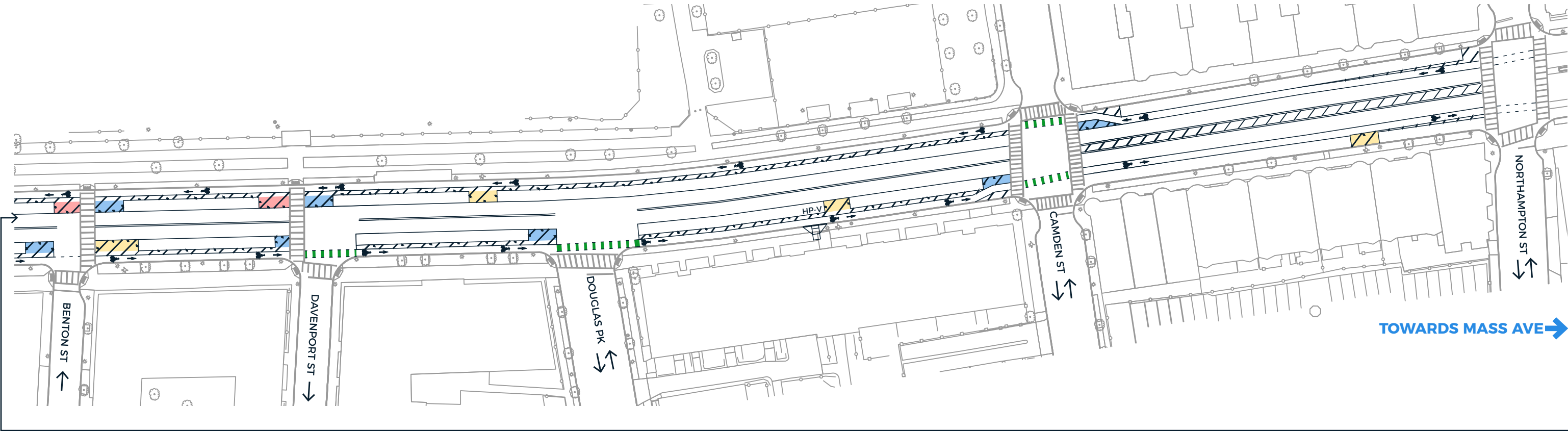

**PARKING-PROTECTED BIKE LANE**

- ▶ Reduces crossing distance for people walking
  - ▷ People cross bike lane first, then car travel lanes
- ▶ Reduces conflicts between people on bikes and in vehicles
- ▶ Prevents people from opening the door into the bike lane
- ▶ Feels more comfortable, more separated from traffic

**DAYLIGHTING**

- ▶ Improves visibility for drivers and pedestrians
- ▶ Restricts the parking 20' from intersection, per BTB rules
  - ▷ Some of these non-conforming spots are used as parking today



EXISTING COLUMBUS AVE @ CAMDEN ST (SOUTHWEST)



PROPOSED



**CONTACT**  
Najah Casimir | 617.635.4765 | najah.casimir@boston.gov

CITY OF BOSTON  
Martin J. Walsh, Mayor

BOSTON TRANSPORTATION DEPARTMENT  
Gina N. Fiandaca, Commissioner

EXISTING CONDITION

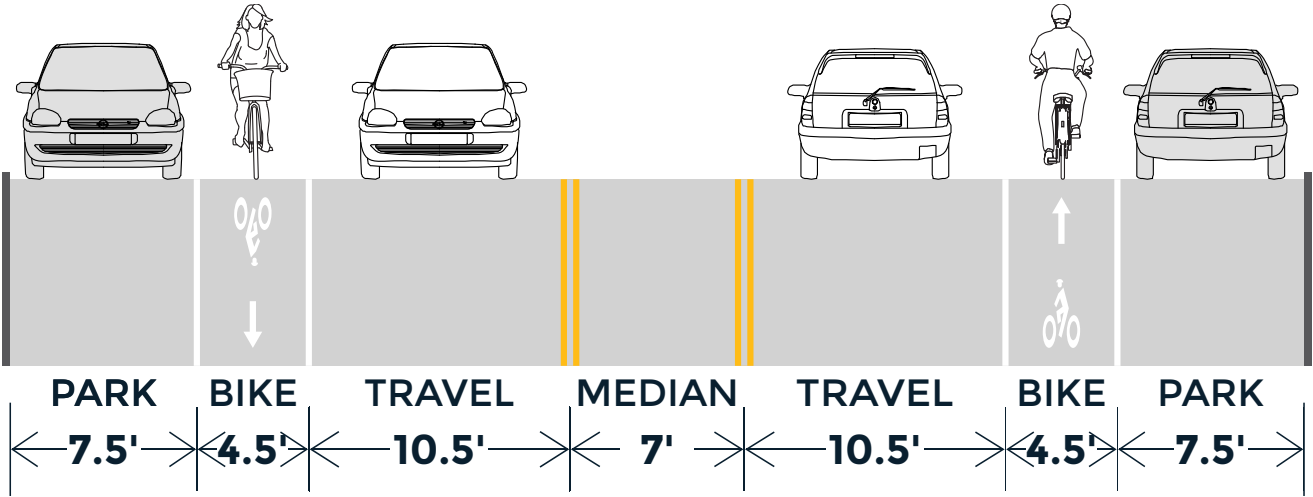

PROPOSED NORTHAMPTON ST TO CAMDEN ST

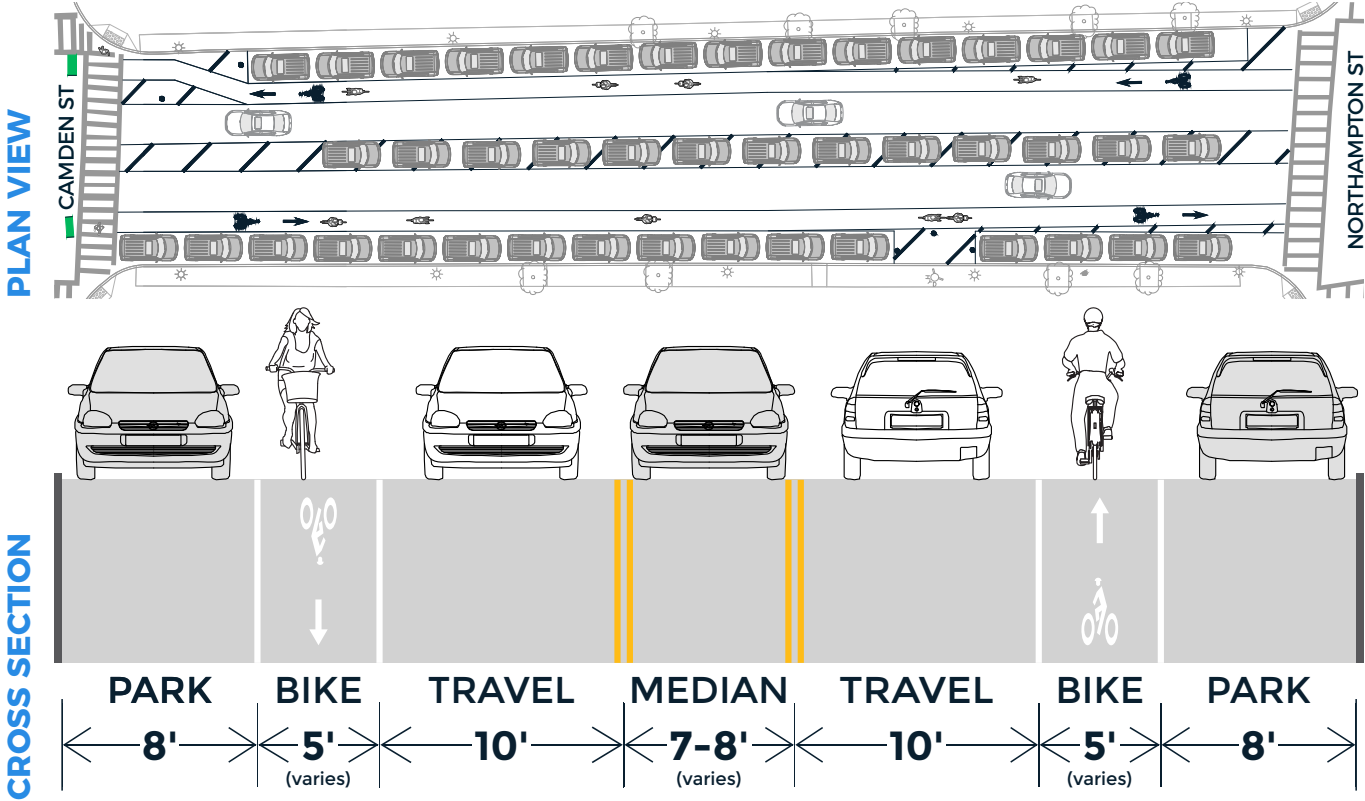

PROPOSED CAMDEN ST TO MELNEA CASS BLVD

