

BOSTON COMMON

MASTER PLAN

Open House #3
Public Presentation I
16 September 2020

Our meeting will begin
at 6 PM.

Visit www.BostonCommonMasterPlan.com/virtual-open-house-3
for all presentation materials. Meeting recordings will be added
following each meeting.

Drop us a line on the website **OR** connect with **BPRD Project**
Manager Nate Frazee at nathan.frazee@boston.gov or
617-961-3167 with any additional thoughts or questions.

LANGUAGES & INTERPRETERS

Select your language (listing will be different than noted here)

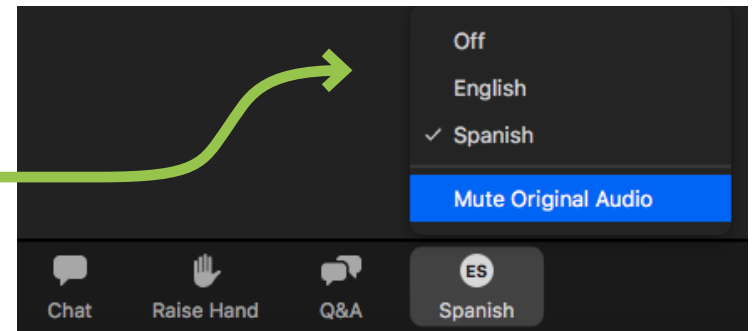

For ASL, select one of the ASL interpreters listed above to pin their video for the duration of the call. Right click on their video and select 'Pin Video'.

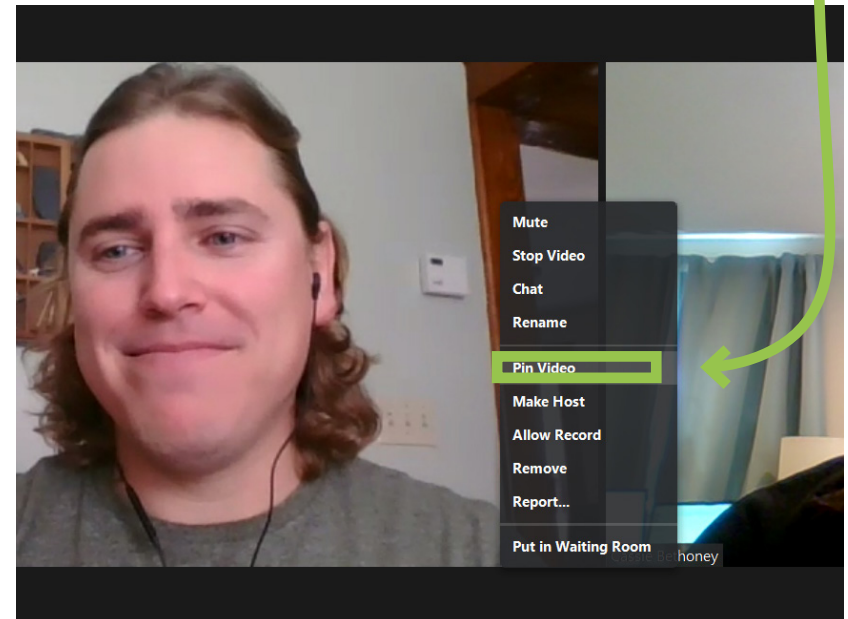

LANGUAGE		ZOOM BUTTON
Haitian Creole	kreyòl ayisyen	French
Spanish	Español	Spanish
Vietnamese	Tiếng Việt	Russian
Cape Verdean Creole	kriolu	Portuguese
Cantonese	廣東話	German
Mandarin	普通話	Chinese
ASL		Japanese



BOSTON COMMON
MASTER PLAN

HOW TO PARTICIPATE TONIGHT

VIA WEB

- Type your question by clicking the 'Q&A' icon
- Click the 'Raise Hand' icon to be called on and unmuted to ask a question

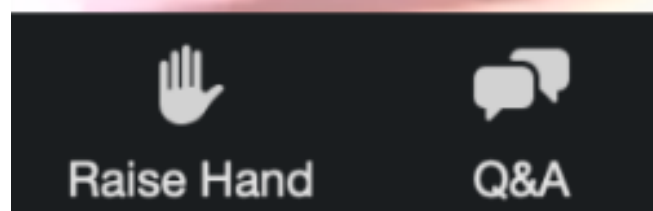

VIA PHONE

- Dial *9 to raise your hand
- Dial *6 to unmute and remute yourself



POLL!

Answer via Zoom or text your
response to (617) 504-4383

Where do you live?



BOSTON COMMON
MASTER PLAN

TONIGHT'S AGENDA

Project Background

What We've Heard So Far

Guiding Principles

Park-wide Strategies

Proposed Improvements

General Q&A

VIRTUAL OPEN HOUSE #3 PROGRAM

Public Presentation #1 – Tonight!

Open Discussion Forums

- 1. Park-wide Strategies for Improvements**
Sept. 22, 2020, 12 to 1 PM
- 2. Visitor Activities and Play**
Sept. 24, 2020, 6 to 7 PM
- 3. Performances and Active Recreation**
Sept. 29, 2020, 6 to 7 PM
- 4. Gateways and Edges**
Oct. 1, 2020, 12 to 1 PM

Public Presentation #2 (date tbd)

GUIDING PRINCIPLES



MANY THINGS TO ALL PEOPLE



DESTINATION AND CROSSROADS



HISTORIC AND CONTEMPORARY



BALANCE PARK USE AND CARE



CHAMPION RESILIENT STRATEGIES



BOSTON COMMON
MASTER PLAN

For more on Guiding Principals,
Goals, and Objectives, visit:

www.bostoncommonmasterplan.com/about



Property Owner
& Project Proponent



FRIENDS
OF THE
PUBLIC GARDEN

Park Steward
& Project Proponent



Liza Meyer, RLA
Chief Landscape Architect



Liz Vizza
President



Nate Frazee, RLA
Project Manager



Bob Mulcahy
Director of Parks Case &
Capital Projects

TEAM



Gene Bolinger, RLA
Vice President



Cheri Ruane, RLA
Vice President



Elise Bluell
Landscape Architect



Louise Roland
Landscape Architect



Cassie Bethoney, RLA
Senior Landscape Architect

Weston & SampsonSM
design studio
Lead Designer

kzla
Kyle Zick Landscape
Architecture for Cultural
Landscapes support



BOSTON COMMON
MASTER PLAN

PROJECT SCHEDULE

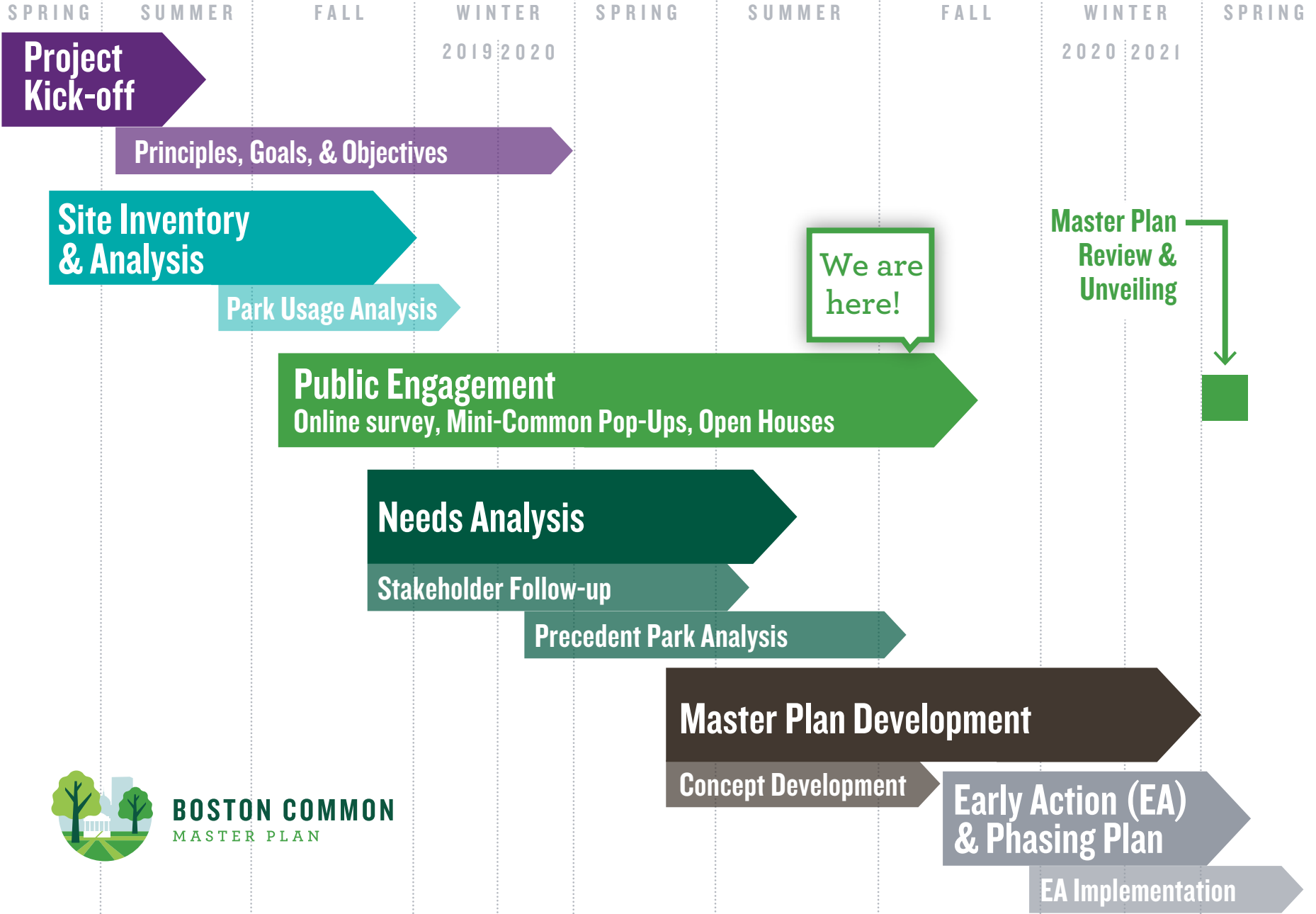

BOSTON COMMON
MASTER PLAN

ENGAGEMENT EVENTS TO DATE



MINI COMMON POP UPS & PARK PRESENCE DAYS



OPEN HOUSE #1



OPEN HOUSE #2



PROJECT WEBSITE & SOCIAL MEDIA

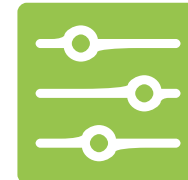

ONLINE SURVEY



BOSTON COMMON
MASTER PLAN



Image courtesy of the Friends of the Public Garden



BOSTON COMMON

MASTER PLAN

An aerial photograph of a large city park during the golden hour of sunset. The park is filled with green grass, numerous trees (some bare, some with light foliage), and winding paths. In the foreground, there's a stone building and a parking lot with a few cars. In the middle ground, a prominent circular gazebo-like structure sits on a raised platform. The background shows a dense urban skyline with various skyscrapers and buildings, all bathed in the warm, orange light of the setting sun. The sky is filled with soft, colorful clouds.

Park-wide Strategies

PARK WIDE STRATEGIES



TREE CANOPY



BENCHES AND SEATING



CIRCULATION AND ACCESS



EVENTS AND PROGRAMMING



TREE PLANTING STRATEGY

RECOMMENDATIONS:

- Enhance views, fill gaps in the tree canopy, and better define pedestrian malls
- Provide shady spots for comfortable seating
- Plant for the enjoyment and benefit of future generations

KEY:

- Tree Canopy
- Replace Tree
- New Tree
- ▨ Raise Canopy

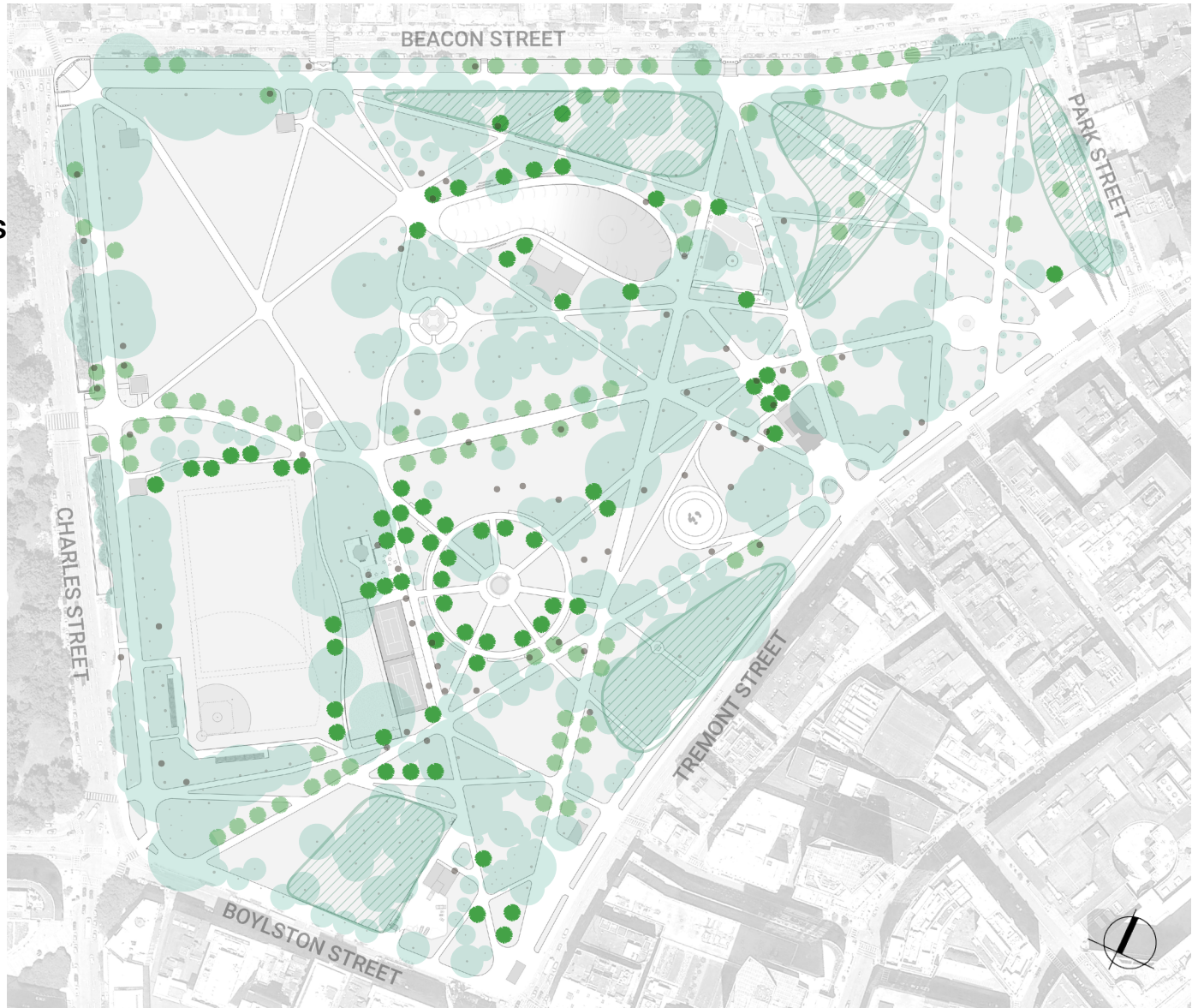

BENCHES AND SEATING STRATEGY

RECOMMENDATIONS:

- Coordinate with tree planting
- Enhance visual qualities of pedestrian corridors
- Increase capacity
- Activate social nodes

KEY:

-  Benches Both Sides of Path
-  Benches One Side of Path

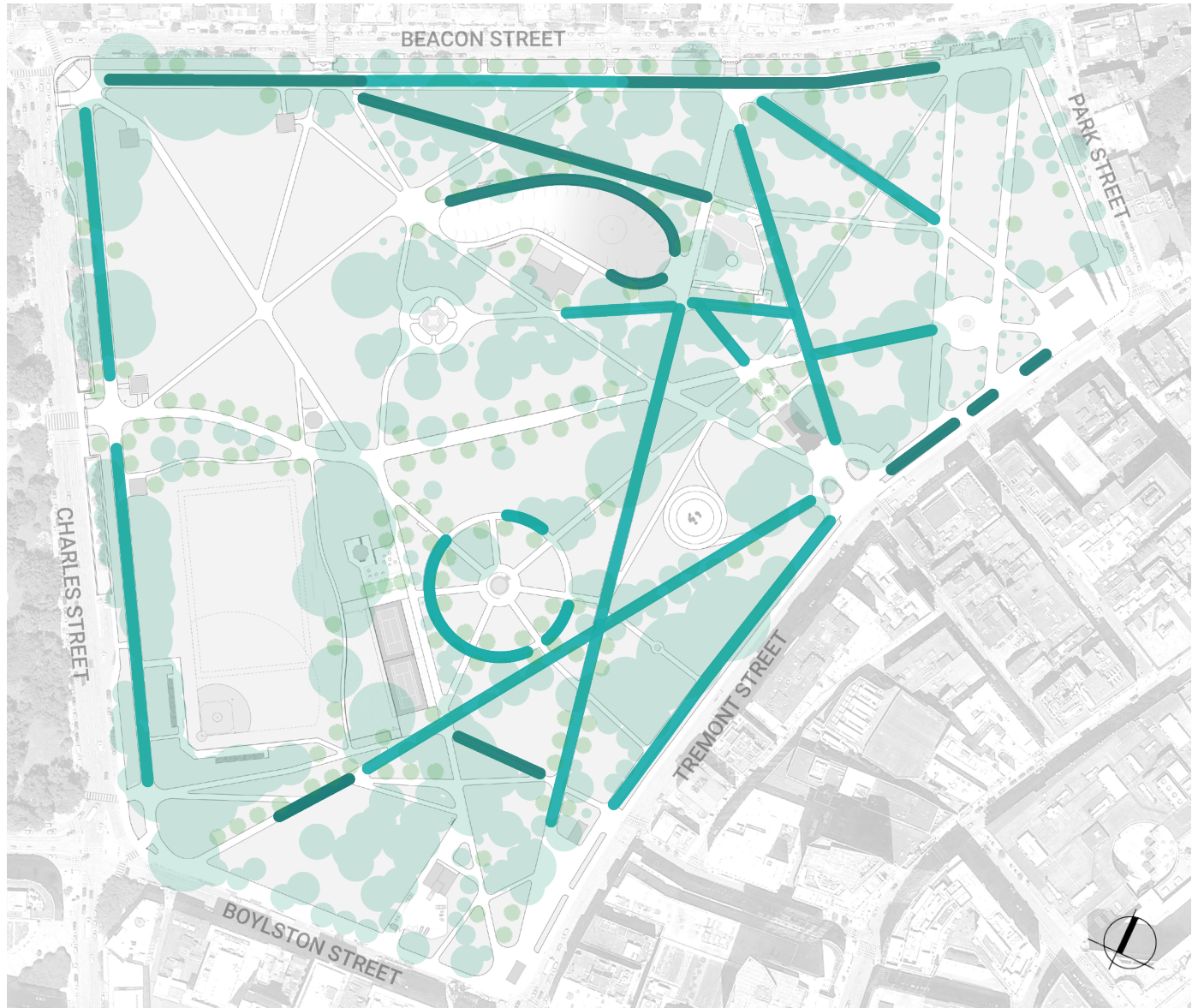

CIRCULATION AND ACCESS STRATEGY

RECOMMENDATIONS:

- Designate an interior loop that connects amenities
- Provide direct ADA connections
- Add directional signage (wayfinding)
- Coordinate, clarify, and celebrate arrival at the Common

KEY:

- Interior Loop
- Visitor Amenities

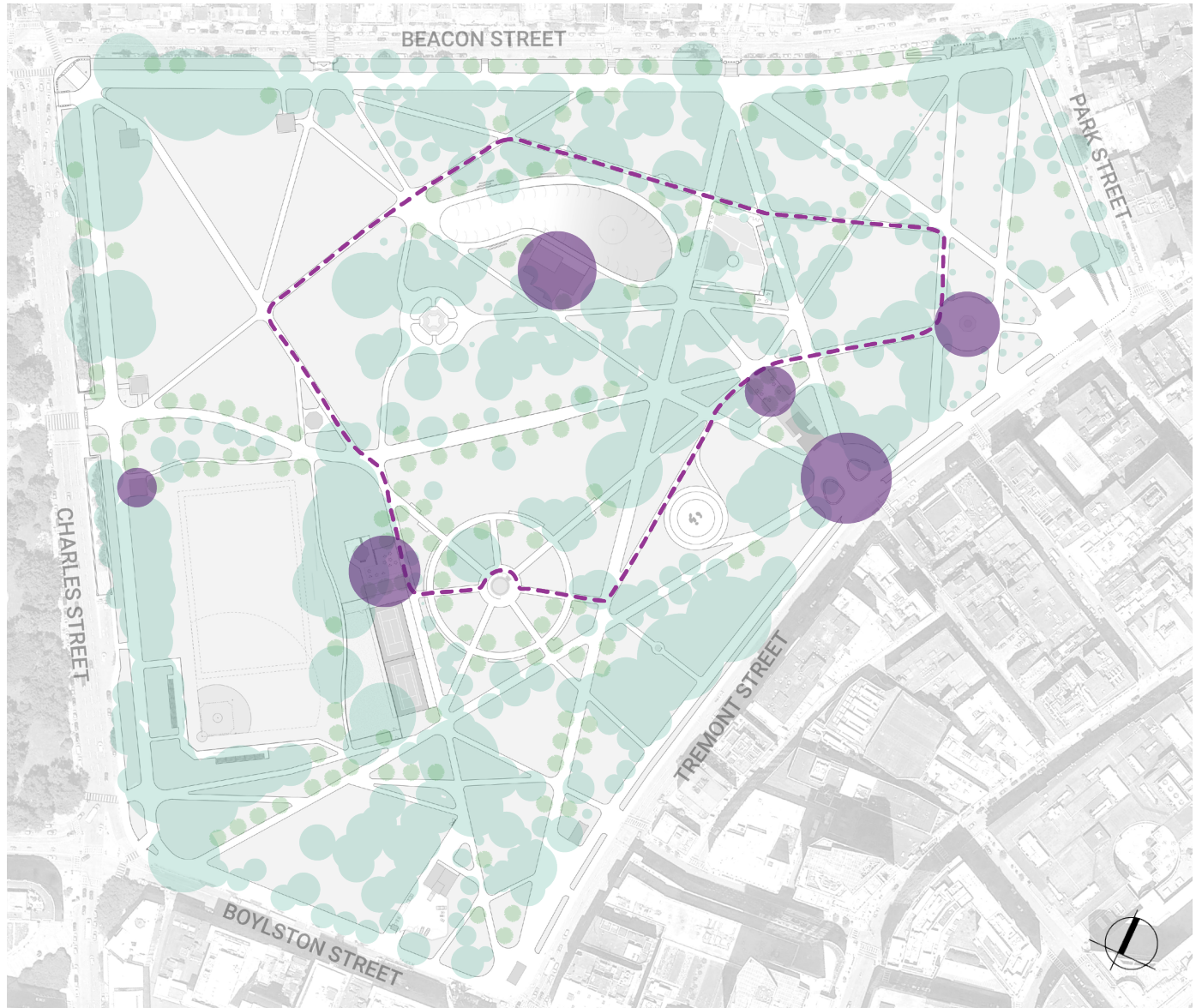

EVENTS AND PROGRAMS TODAY

CONSIDERATIONS:

- Major, large events leave damaging footprints on the landscape
- Infrastructure and amenities are limited in supporting events, programming, and daily park use

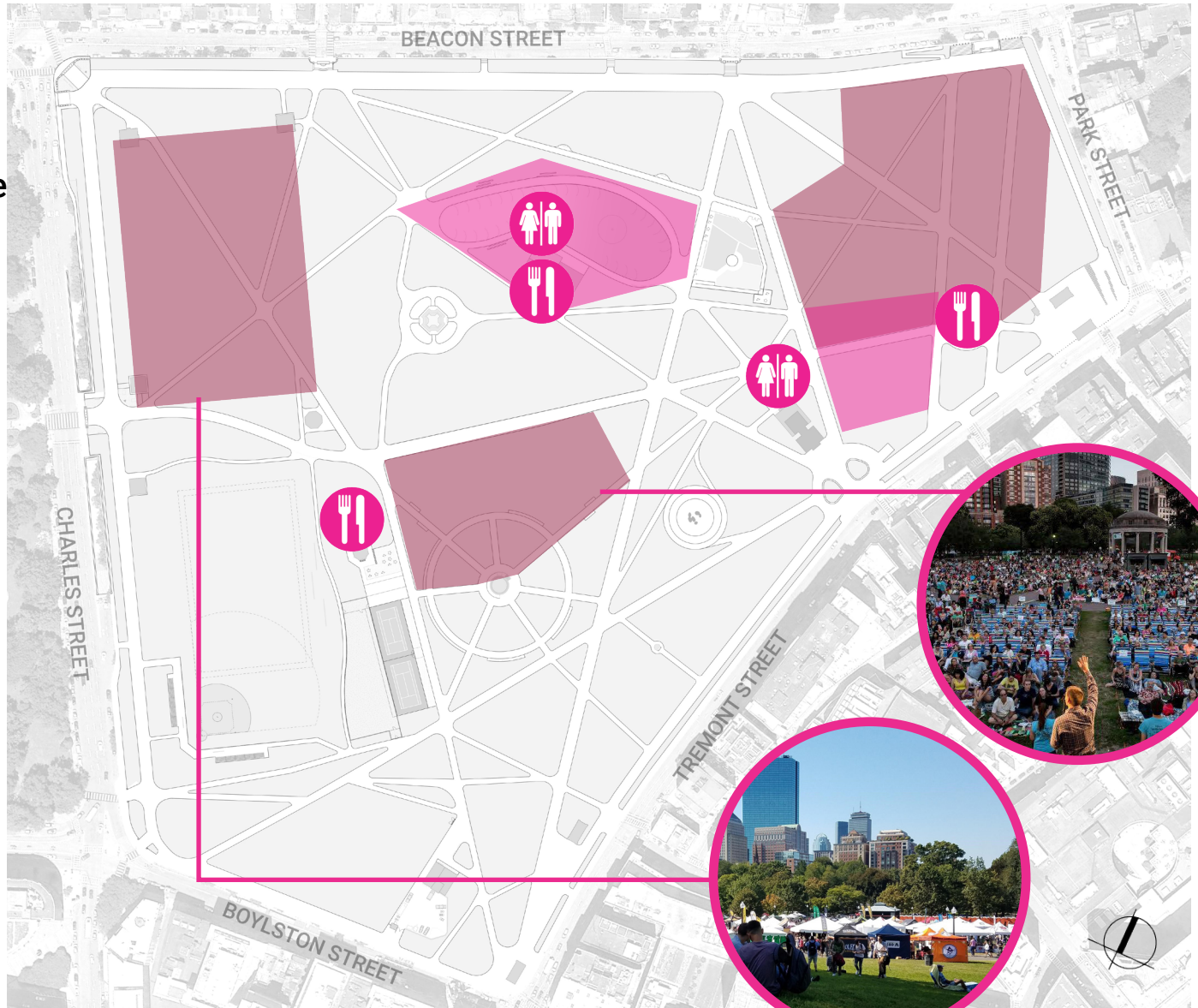

KEY:





- Large Events
- Small Events
- 🍴 🚼 Amenities

EVENTS AND PROGRAMS STRATEGY

RECOMMENDATIONS:

- Allocate space by event size, better distribute
- Make better use of hard surfaces to support events and programs
- Improve infrastructure to better support events, programs, and daily park use
- Improve visitor conveniences

KEY:

-  Large Events
-  Small Events
-  Stage and podium
-  Back of House

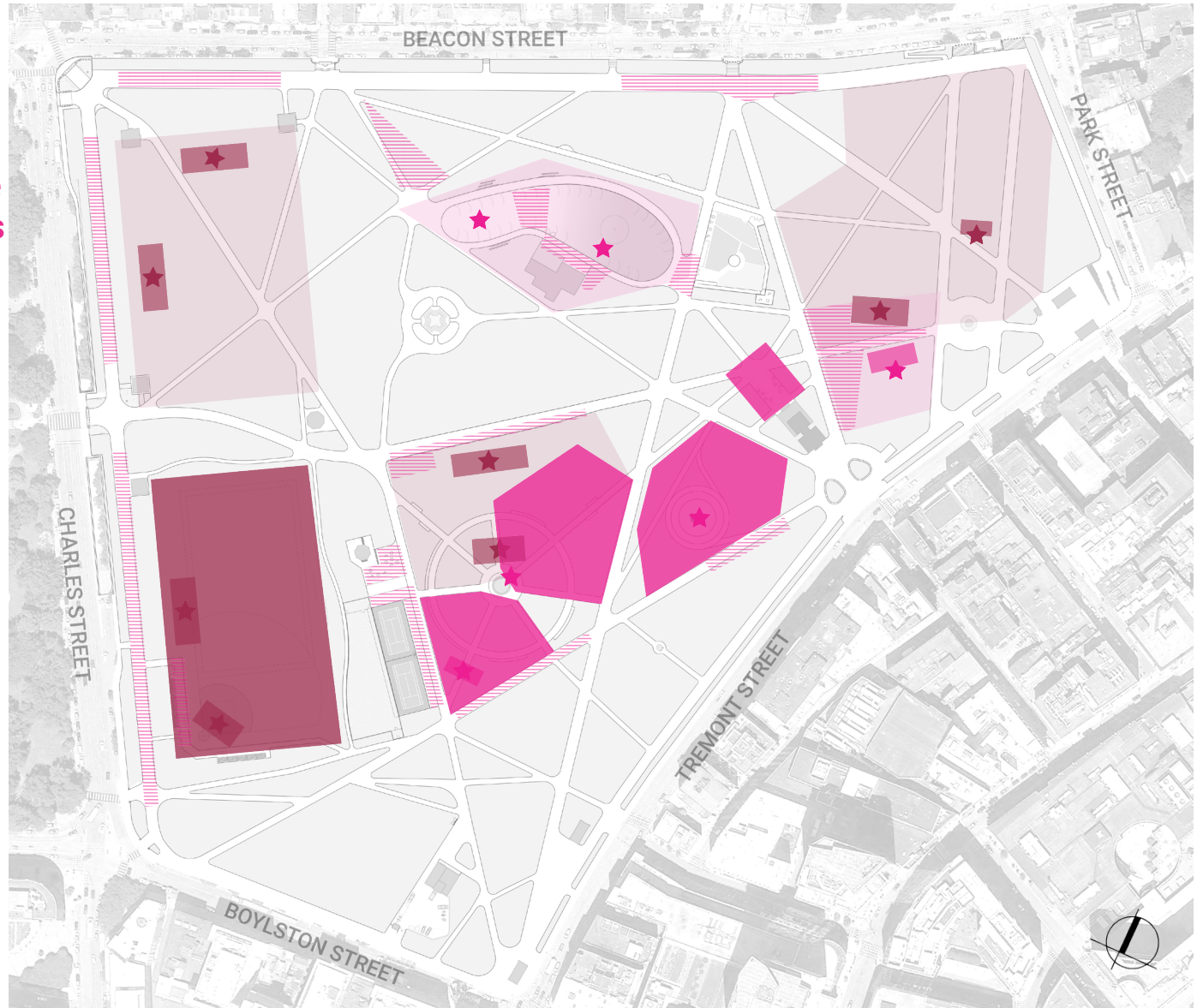

EVENTS AND PROGRAMS STRATEGY

RECOMMENDATIONS:

- Allocate space by event size, better distribute
- Make better use of hard surfaces to support events and programs
- Improve infrastructure to better support events, programs, and daily park use
- Improve visitor conveniences

KEY:

 Large Events

 Small Events

 Stage and podium

  Amenities

 Utility Hook Ups

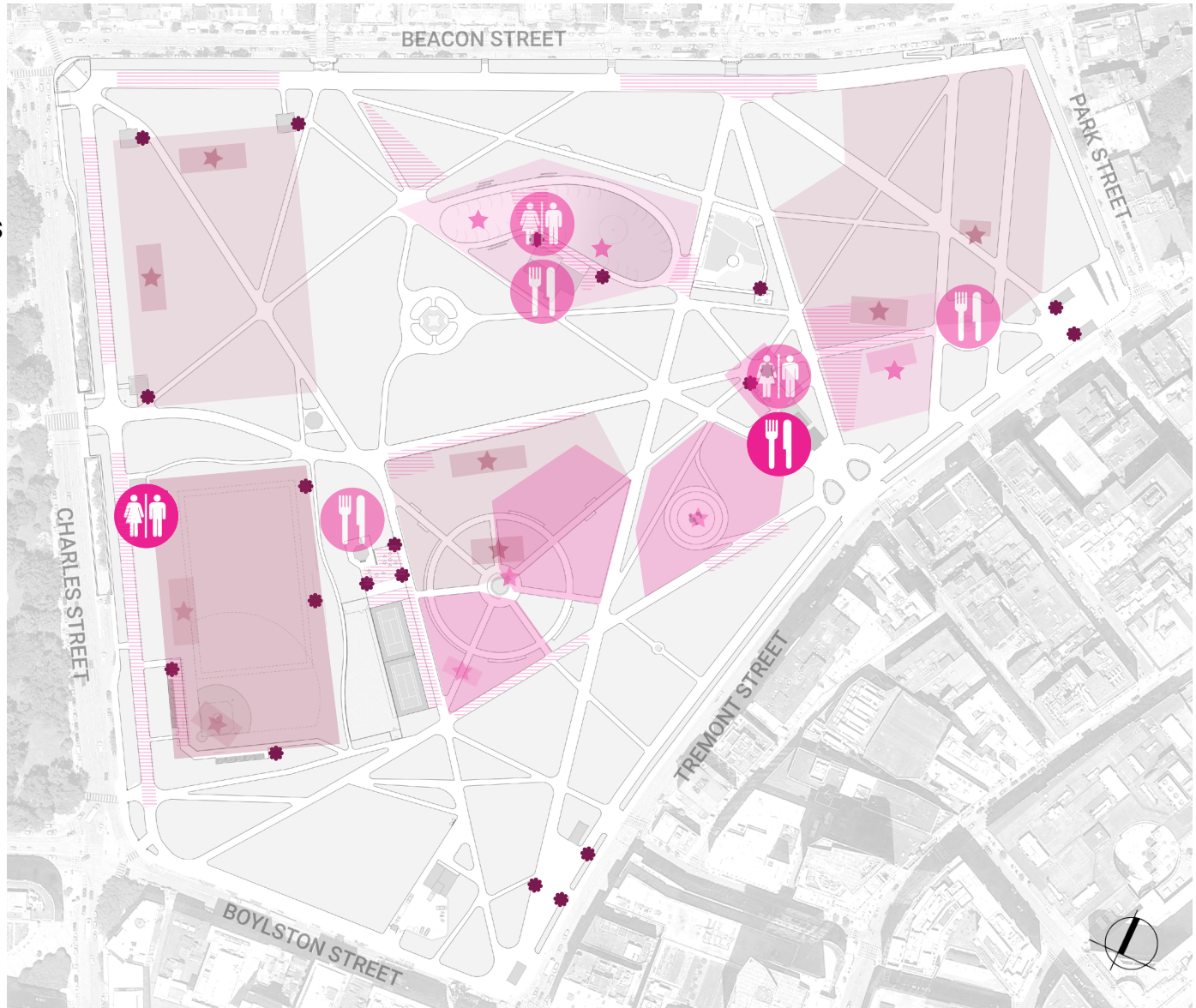

A large, leafy tree in the foreground of a park with people walking on a path. The scene is bright and sunny, with green grass and trees in the background. The text "Proposed Improvement Areas" is overlaid in the center of the image.

Proposed Improvement Areas

PROPOSED IMPROVEMENT AREAS

OPEN DISCUSSION FORUMS

1. **Park-wide Strategies for Improvements**
9/22/2020
12 to 1 PM
2. **Visitor Activities and Play**
9/24/2020
6 to 7 PM
3. **Performances and Active Recreation**
9/29/2020
6 to 7 PM
4. **Gateways and Edges**
10/1/2020
12 to 1 PM

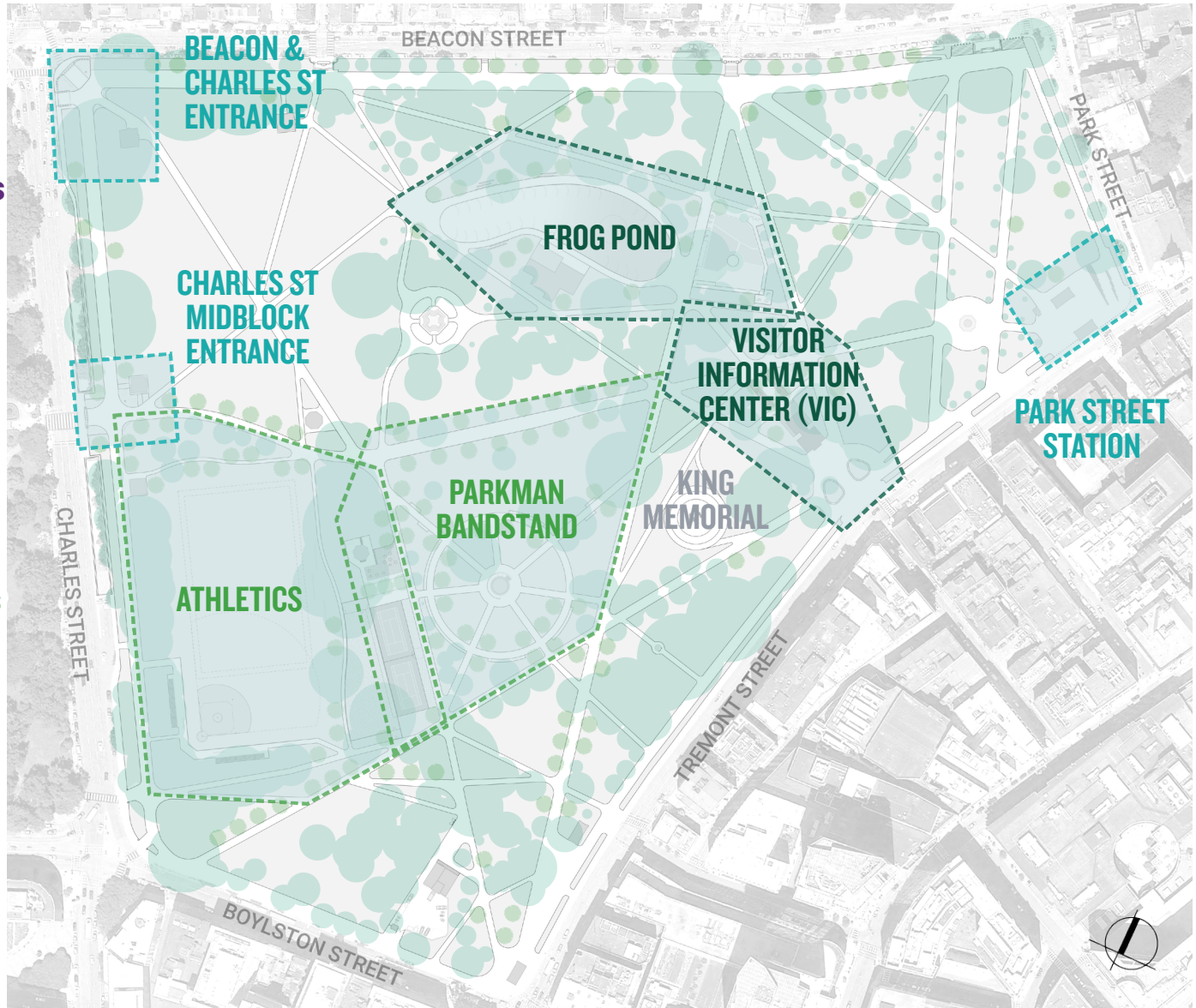

FROG POND TODAY

EXISTING CONDITIONS AND PUBLIC FEEDBACK:

- Water play, ice skating, and playground activities are valued and often crowded
- More shady seating is needed
- More and different opportunities for play for big and little kids in the playground and Frog Pond are desired
- Frog Pond Pavilion does not adequately support staff and visitor needs

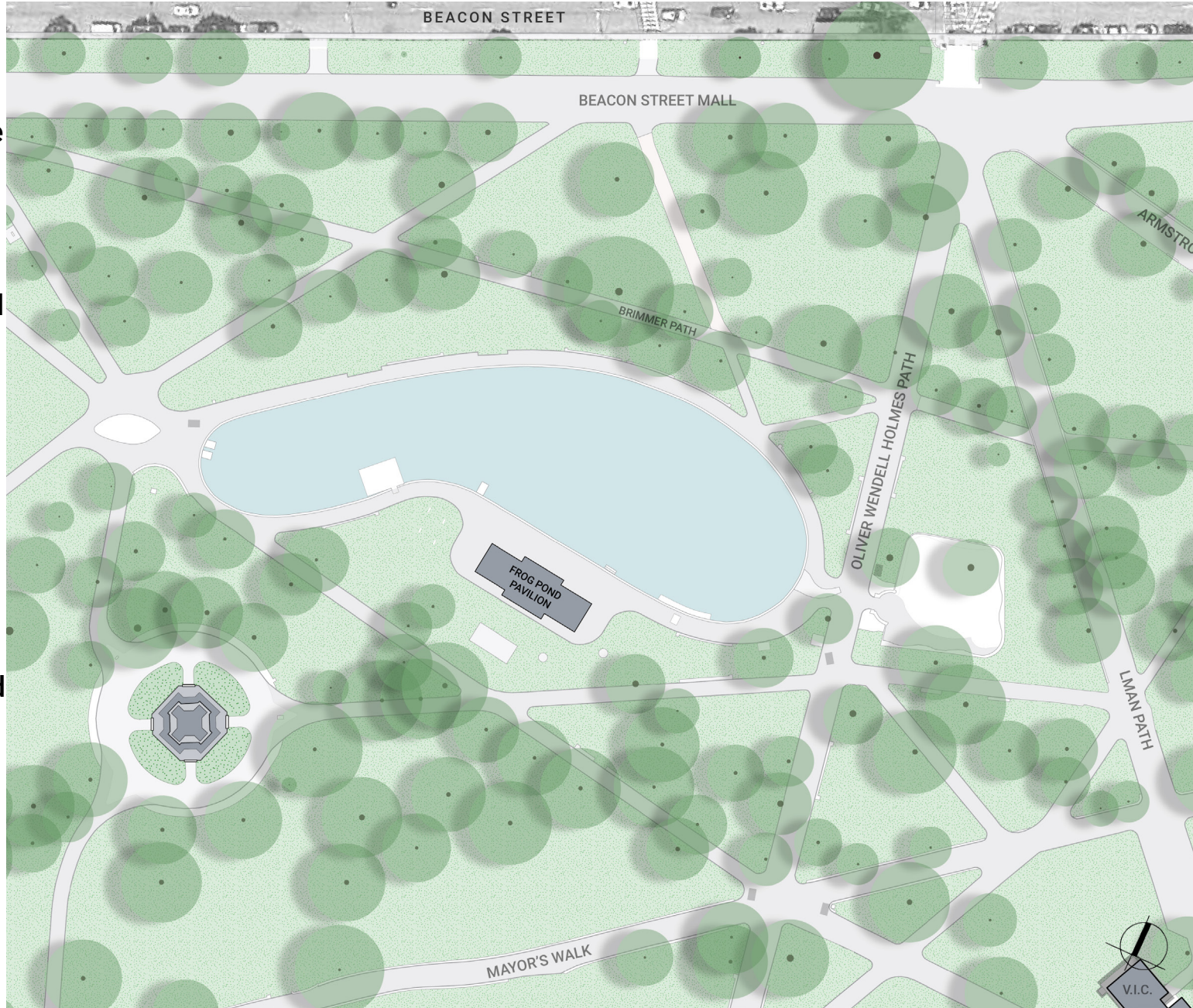

PROPOSED FROG POND PLAN

RECOMMENDED FEATURES:

- Expand the Frog Pond Pavilion with added amenities
- Plant trees to increase shade
- Expand the children's playground with diverse play opportunities
- Expand seating options
- Provide support infrastructure for multi-season events and flexible programmed use

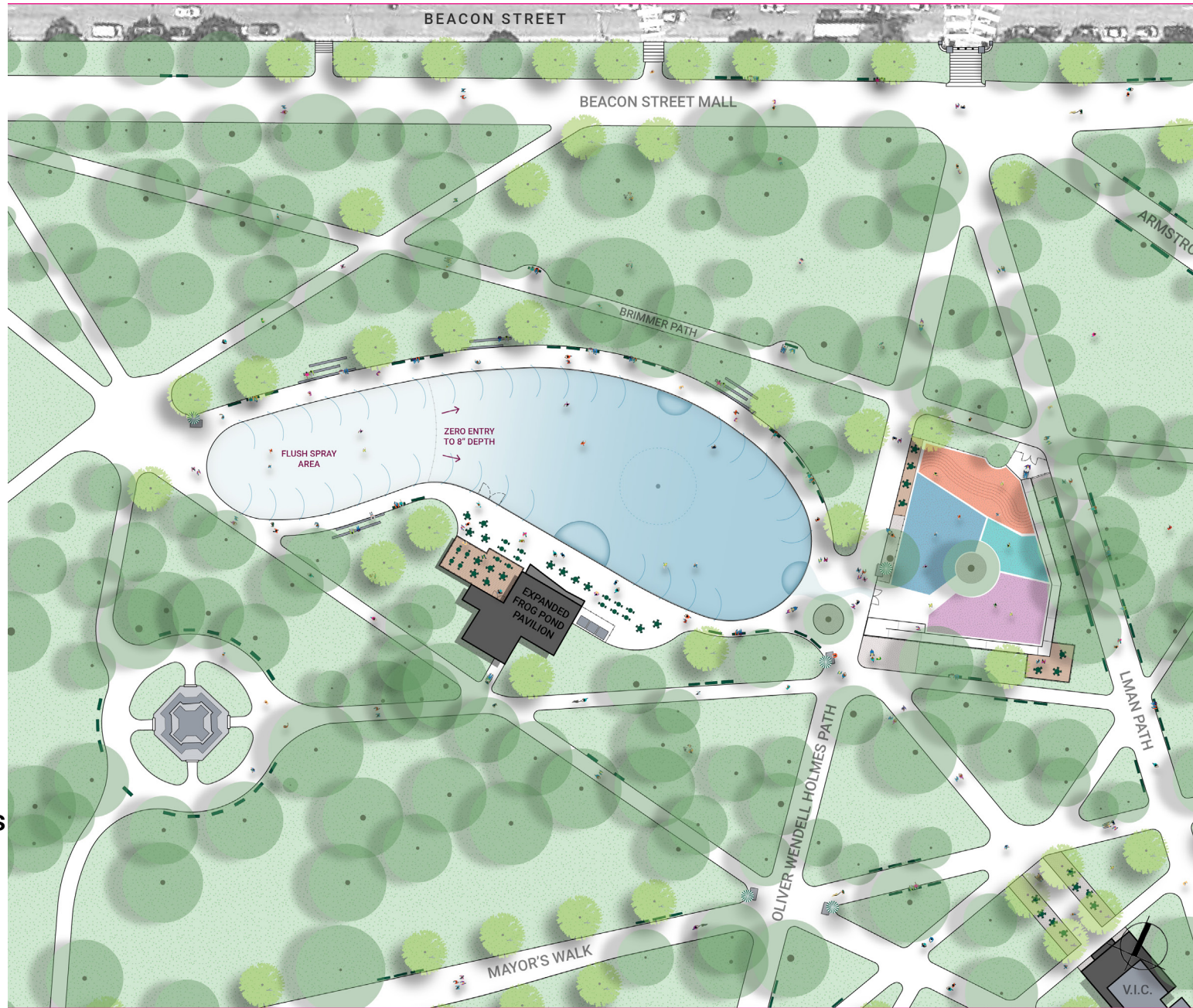

FROG POND TODAY



PROPOSED FROG POND IMPROVEMENTS



PROPOSED FROG POND IMPROVEMENTS



VISITOR INFORMATION CENTER TODAY

EXISTING CONDITIONS AND PUBLIC FEEDBACK:

- More restrooms are needed
- More space is needed inside and outside the Visitor Information Center (V.I.C.) for tourism and social gatherings
- Disconnected from the park interior; visual connections to Frog Pond and Parkman Bandstand will enhance the experience
- Connection to King Memorial will be needed



PROPOSED V.I.C. PLAN

RECOMMENDED FEATURES:

- Invest in visitor resources and amenities; expand the V.I.C. building footprint
- Establish a pedestrian connection between the V.I.C. and Mayor's Walk
- Provide pathway connections to the forthcoming King Memorial
- Expand seating options for increased convenience
- Increase park-wide wayfinding



VISITOR INFORMATION CENTER TODAY



PROPOSED V.I.C. IMPROVEMENTS



ATHLETICS TODAY

EXISTING CONDITIONS:

- Far from park amenities like restrooms
- Outfield fence limits playability of the fields
- Tennis court alignment is incongruous with the pathway alignment
- Better integrate accessibility at Earl of Sandwich; the outdoor cafe space in front has potential as a hub of activity for this area

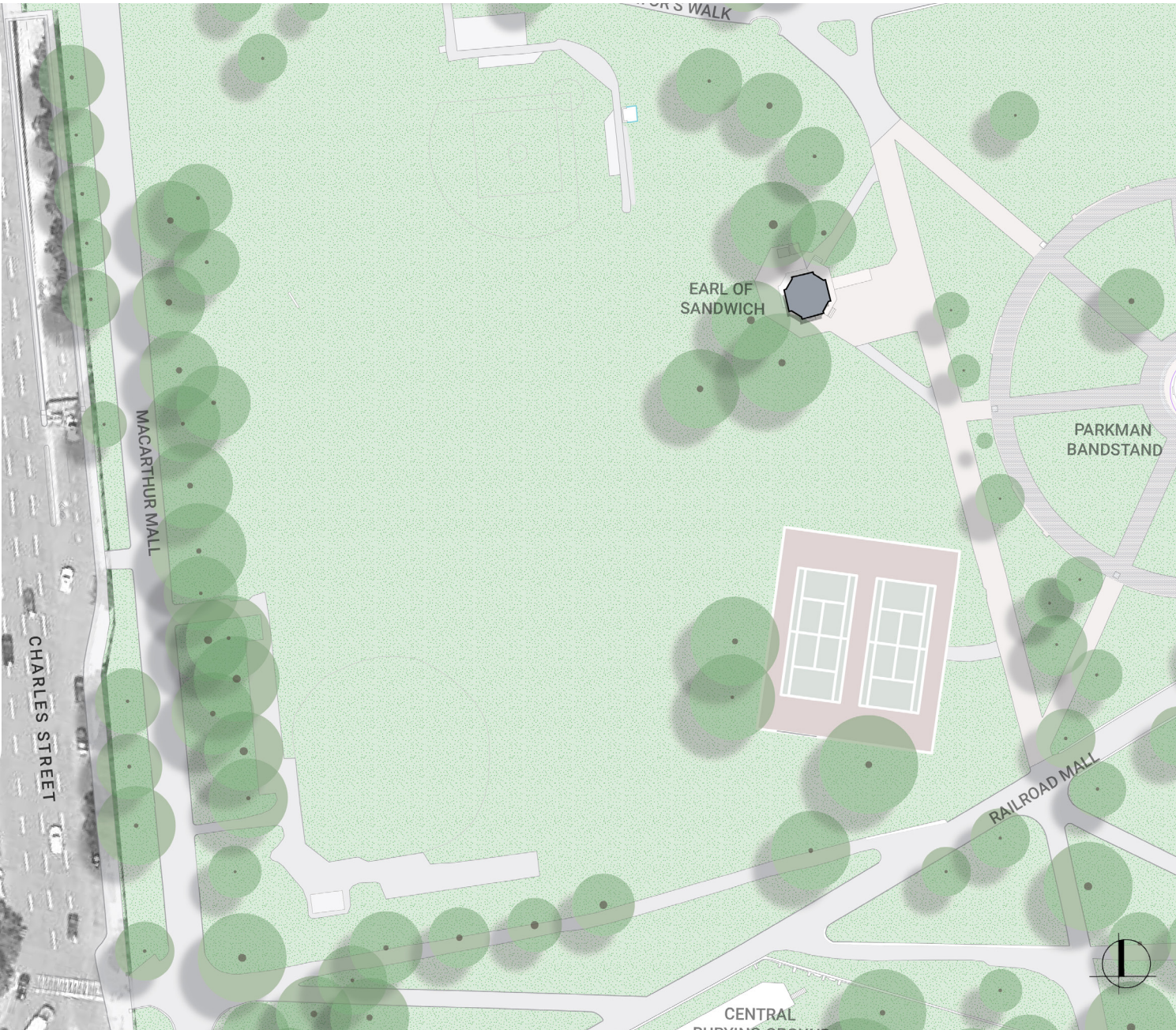

PROPOSED ATHLETICS PLAN

RECOMMENDED FEATURES:

- Establish a fully accessible restroom facility
- Increase flexibility of the athletic field footprint - single 60' ballfield with a multi-use rectangular field
- Provide support infrastructure for events and diverse programmed use
- Improve visibility and access; establish new pedestrian routes
- Invest in a fenced-in dog park



ATHLETICS TODAY



PROPOSED ATHLETICS IMPROVEMENTS

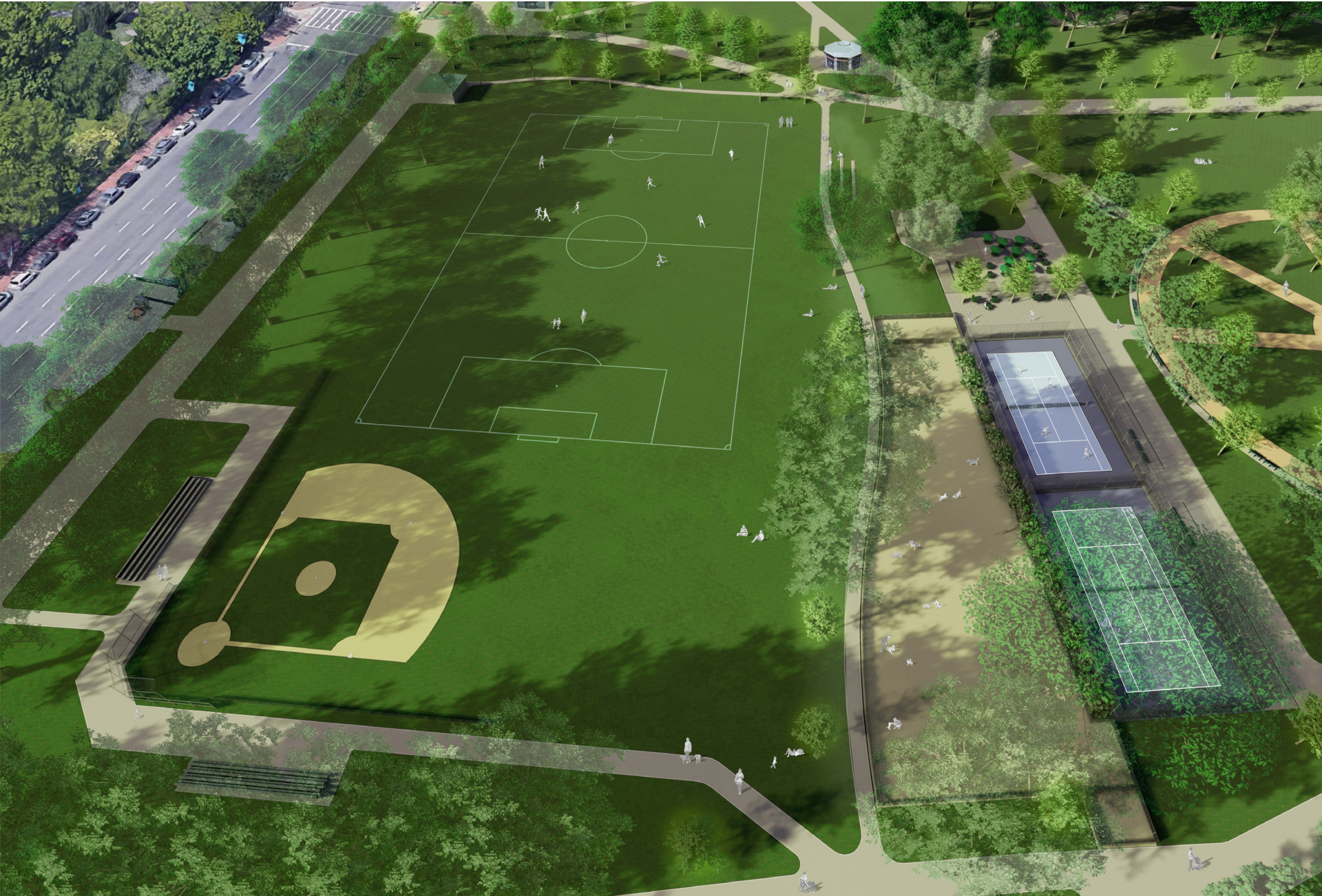

PARK STREET STATION TODAY

EXISTING CONDITIONS AND PUBLIC FEEDBACK:

- Accessibility across the plaza is limited
- This corner lacks a strong sense of arrival
- Vending locations lack intention
- Spaces are not clearly defined (commuting and gathering spaces conflict)
- Circulation and wayfinding are difficult
- An increased level of security and safety are desired



PROPOSED PARK STREET PLAN

RECOMMENDED

FEATURES:

- Establish a fully accessible route through the plaza to the MBTA headhouses
- Enhance pedestrian arrival with historic-based gateway
- Provide support infrastructure for vending and programmed use
- Increase park-wide wayfinding
- Protect the iconic viewshed to the State House

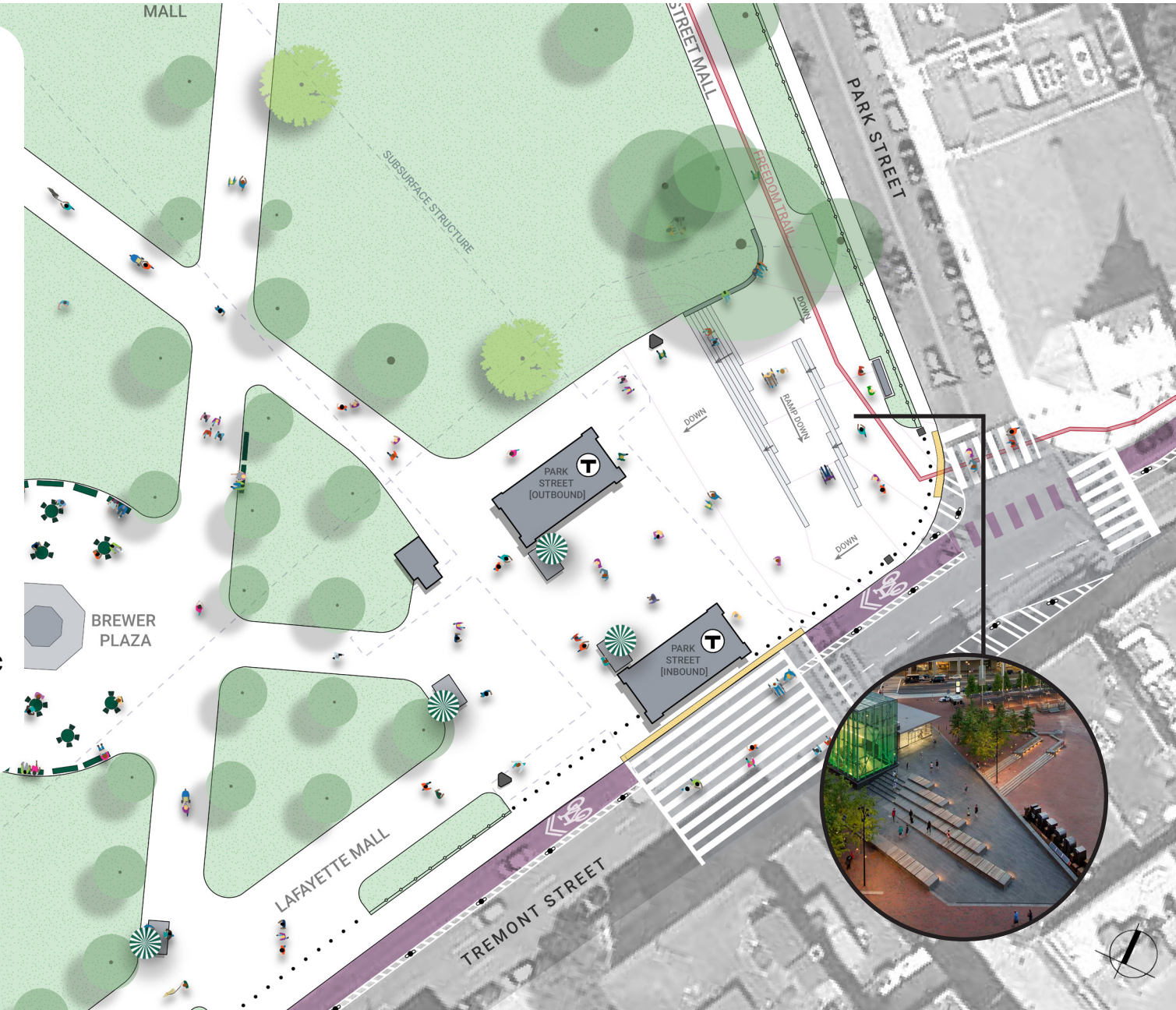

CHARLES ST. MIDBLOCK ENTRANCE



Toward the
Public Garden



Toward Boston
Common

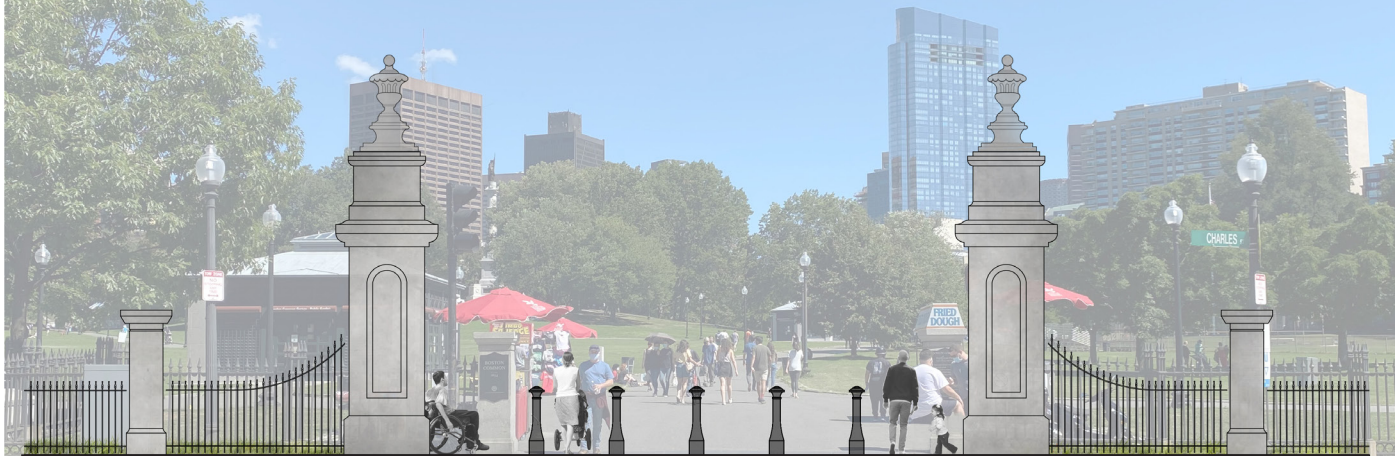

PROPOSED
ORNAMENTAL
FENCE

PROPOSED
HISTORIC REPLICA
BOLLARDS

PROPOSED
LARGE PIER

PROPOSED
MEDIUM
PIER

JOIN US FOR THIS SERIES OF UPCOMING VIRTUAL EVENTS

Open Discussion Forums

1. Park-wide Strategies for Improvements → Sept. 22, 2020, 12 to 1 PM

2. Visitor Activities and Play → Sept. 24, 2020, 6 to 7 PM

3. Performances and Active Recreation → Sept. 29, 2020, 6 to 7 PM

4. Gateways and Edges → Oct. 1, 2020, 12 to 1 PM

Public Presentation #2 → Date TBD

Visit www.BostonCommonMasterPlan.com/virtual-open-house-3 for dates and more information.

POLL!

Answer via Zoom or text your response to (617) 504-4383

Which of the open discussion forums do you hope to join?

- Park-wide Strategies for Improvements
- Visitor Activities and Play
- Performances and Active Recreation
- Gateways and Edges



HOW TO PARTICIPATE TONIGHT

Visit www.BostonCommonMasterPlan.com/virtual-open-house-3 for all presentation materials. Meeting recordings will be added following each meeting.

Drop us a line on the website OR connect with BPRD Project Manager Nate Frazee at nathan.frazee@boston.gov or 617-961-3167 with any additional thoughts or questions.

VIA WEB

- Type your question by clicking the 'Q&A' icon
- Click the 'Raise Hand' icon to be called on and unmuted to ask a question

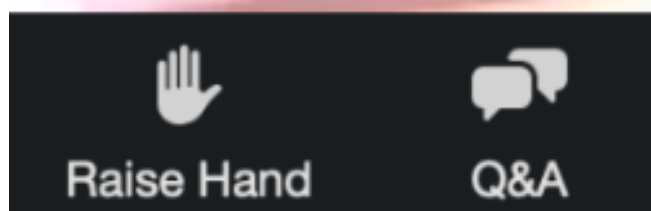

VIA PHONE

- Dial *9 to raise your hand
- Dial *6 to unmute and remute yourself

