

CEYLON PARK

Design Meeting 3

June 28, 2023



Interpretation Information

English: For interpretation in [_____],

1. Go to the horizontal control bar at the bottom of your screen. Click on “Interpretation.”
2. Then click on the language that you would like to hear.
3. You are now accessing this meeting in [_____]

Cabo Verdean Creole: Gossim bu ta entra na reuniao na kriolu,

1. Bai na barra de controlo horizontal na parte inferior di computador bu kalka na “Interpretation”.
2. Depos kalka na idioma qui bu kre ovi.
3. Agora djabu sta ta entra na reuniaun em creole.

Spanish: Para traducción en Español,

1. Vaya a la parte baja de la pantalla, en la barra horizontal, y presione la tecla “Interpretation”.
2. Luego seleccione el idioma que desea escuchar.
3. Después de seleccionar, usted entrará a la reunión en el idioma “Español”.

Haitian Creole: Pou entèpretasyon Kreyòl ayisyen,

1. Ale nan kontwòl ba nan pati anba ekran an epi Klike sou "Interpretation"
2. Apre sa, klike sou lang ke ou ta renmen tande a.
3. Kounye a ou gen aksè a reyinyon an Kreyòl ayisyen

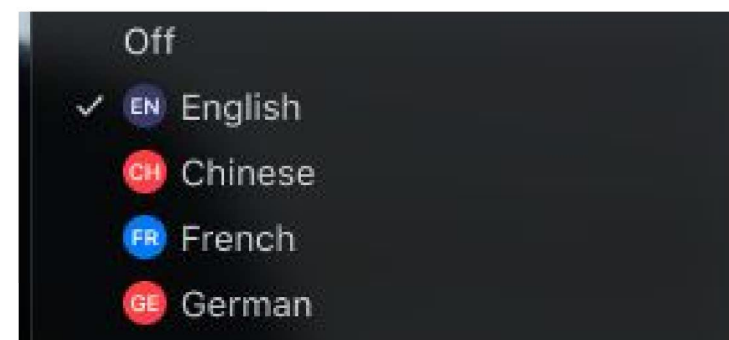

MEETING RECORDING



The Boston Parks and Recreation Department will be recording the meeting and posting to our project webpage for those who are unable to attend the Zoom meeting live.

It is possible that participants may also be recording the meeting with their phones cameras or other devices. If you do not wish to be recorded during this meeting, please keep your microphone and camera off.

VIRTUAL MEETING ETIQUETTE

We want to ensure this conversation feels accessible to everyone and each one of you feels comfortable sharing your questions and comments.

Please be respectful and mindful of other's time when asking questions/ providing comments, so that all attendees are able to participate in the meeting.

Keep questions/ comments project-specific and not personal to yield a solution driven discussion.

You can always set up a conversation with Amy Linné, amy.linne@boston.gov to further discuss the project or process.



ZOOM TIPS

Here is how you can participate during the question and answer part of the presentation.

DURING THE PRESENTATION:



VIA WEB:

Turn video on / off.

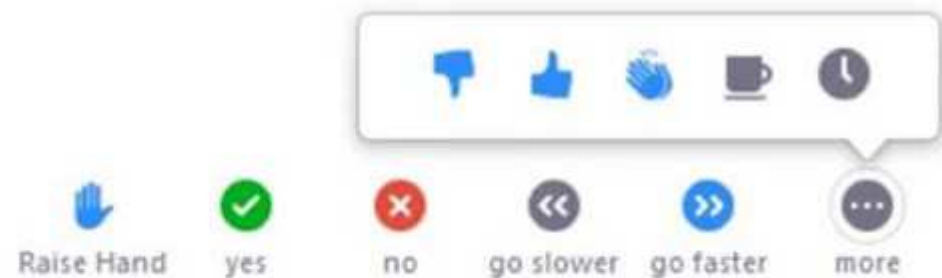

To use these non-verbal options click on participants (bottom of screen); these options will pop up in side bar.

DURING THE Q&A:



JOINING VIA PHONE?

Use *9 to raise hand to ask for audio / video permission to ask questions or provide comments.



VIA WEB:

Chat to ask questions / comments or provide responses to poll questions



Raise hand to ask for audio / video permission to ask questions or provide comments.

AGENDA

- 1 Project Team Introduction**
- 2 Project Overview**
- 3 Presentation**
 - Existing Conditions Summary**
 - Design Process**
 - Schematic Design Plan**
- 4 Listening & Discussion**
- 5 Closing Remarks & Next Steps**



1

PROJECT TEAM INTRODUCTION



PROJECT TEAM

City of Boston

Amy Linné

Project Manager

amy.linne@boston.gov or 617-961-3045

Alize Cabral

Cape Verdean Cultural Liaison Mayor's Office of
Neighborhood Services

alize.cabral@boston.gov

Ashley Gomes

Mid-Dorchester Neighborhood Liaison
Mayor's Office of Neighborhood Services

ashley.gomes@boston.gov

Design Consultant Team

Zach Chrisco

Principal-In-Charge, Sasaki

zchrisco@sasaki.com or 617-926-3300

Garrett Craig-Lucas

Project Manager, Sasaki

gcraiglucas@sasaki.com or 617-923-5344

Kira Sargent

Landscape Architect, Sasaki

ksargent@sasaki.com or 617-923-7216

Sophie Bellemare

Landscape Architecture, Sasaki

sbellemare@sasaki.com or 617-923-7221



2

PROJECT OVERVIEW



PROJECT SCHEDULE | DESIGN PROCESS

PARK RENOVATION

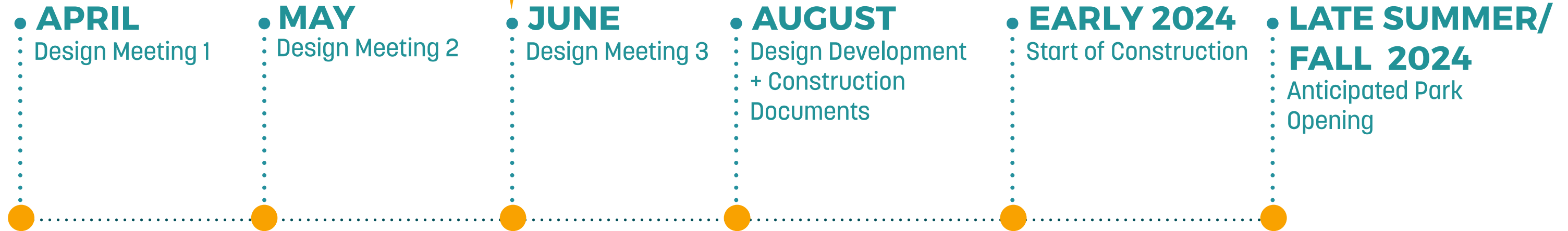

FIELD RENOVATION

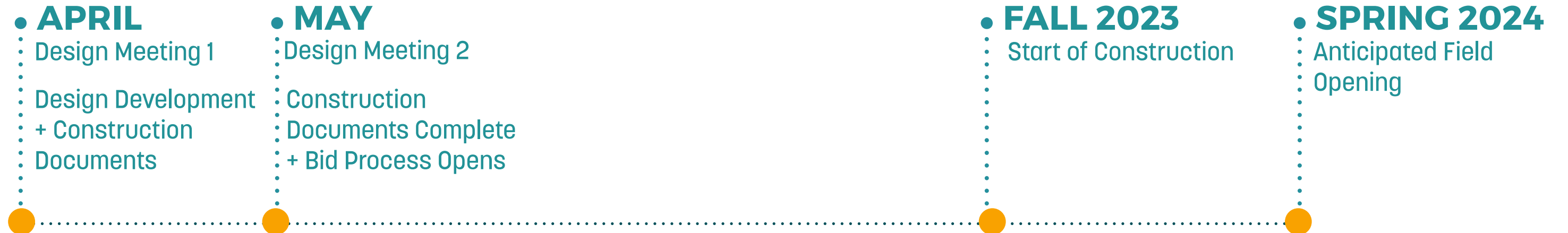

PROJECT APPROACH



CITY OF BOSTON PRIORITIES

- Expanding walkable access to parks
- Addressing equity
- Climate resilience
- Health
- Housing and community building

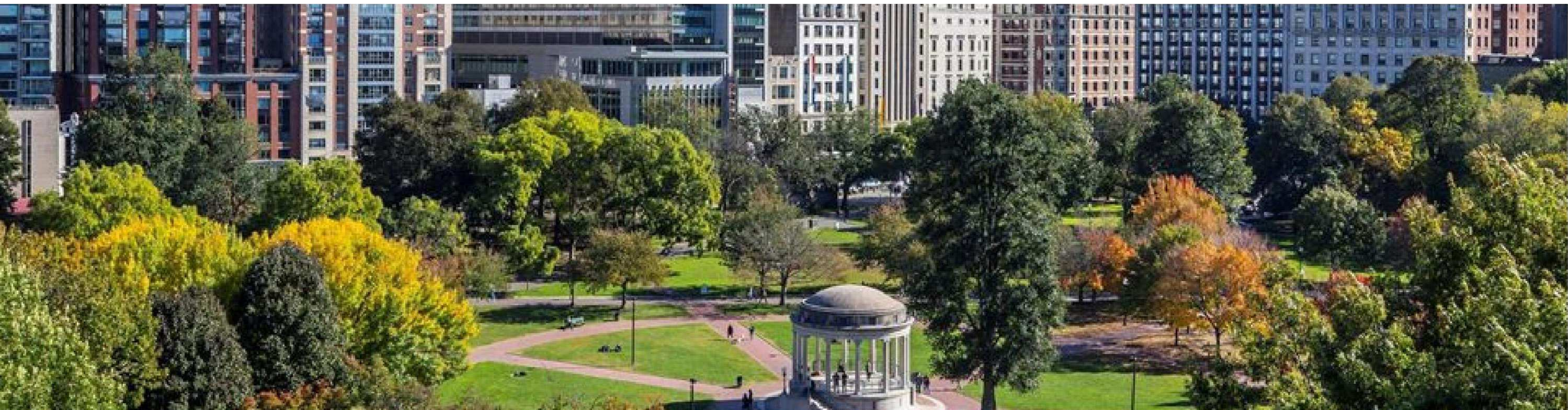

PARKS AND RECREATION GOALS

1. Accessible and available to all
2. Diverse, balanced, and efficient mix of uses
3. Meaningful and inclusive community engagement
4. Adaptive and resilient landscapes
5. Promote connections



3

PRESENTATION



Existing Conditions



Summary



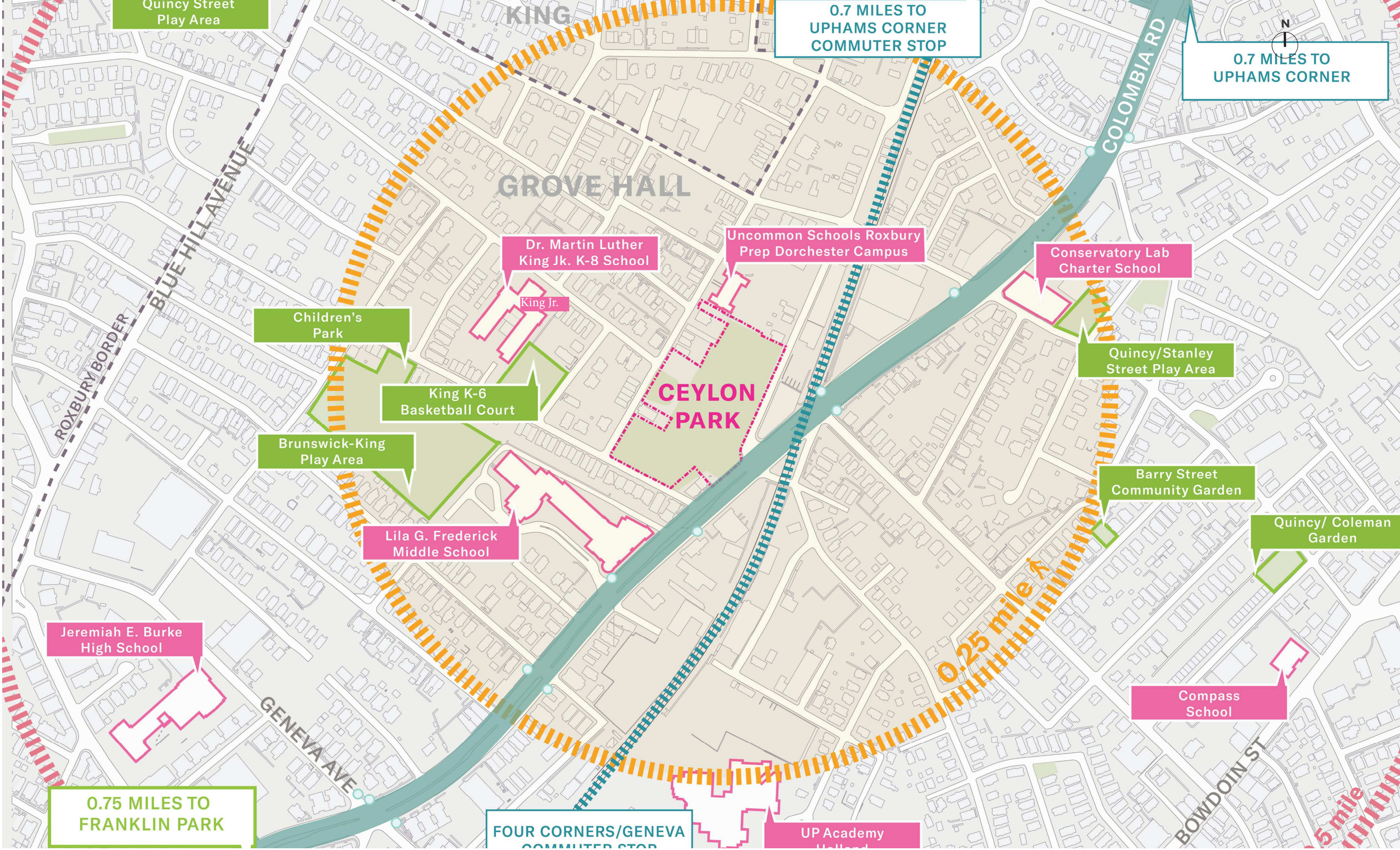

2008 Renovations

In 2008, the park underwent significant renovations, including: the sports field, upper play area, lower play area, and community event space

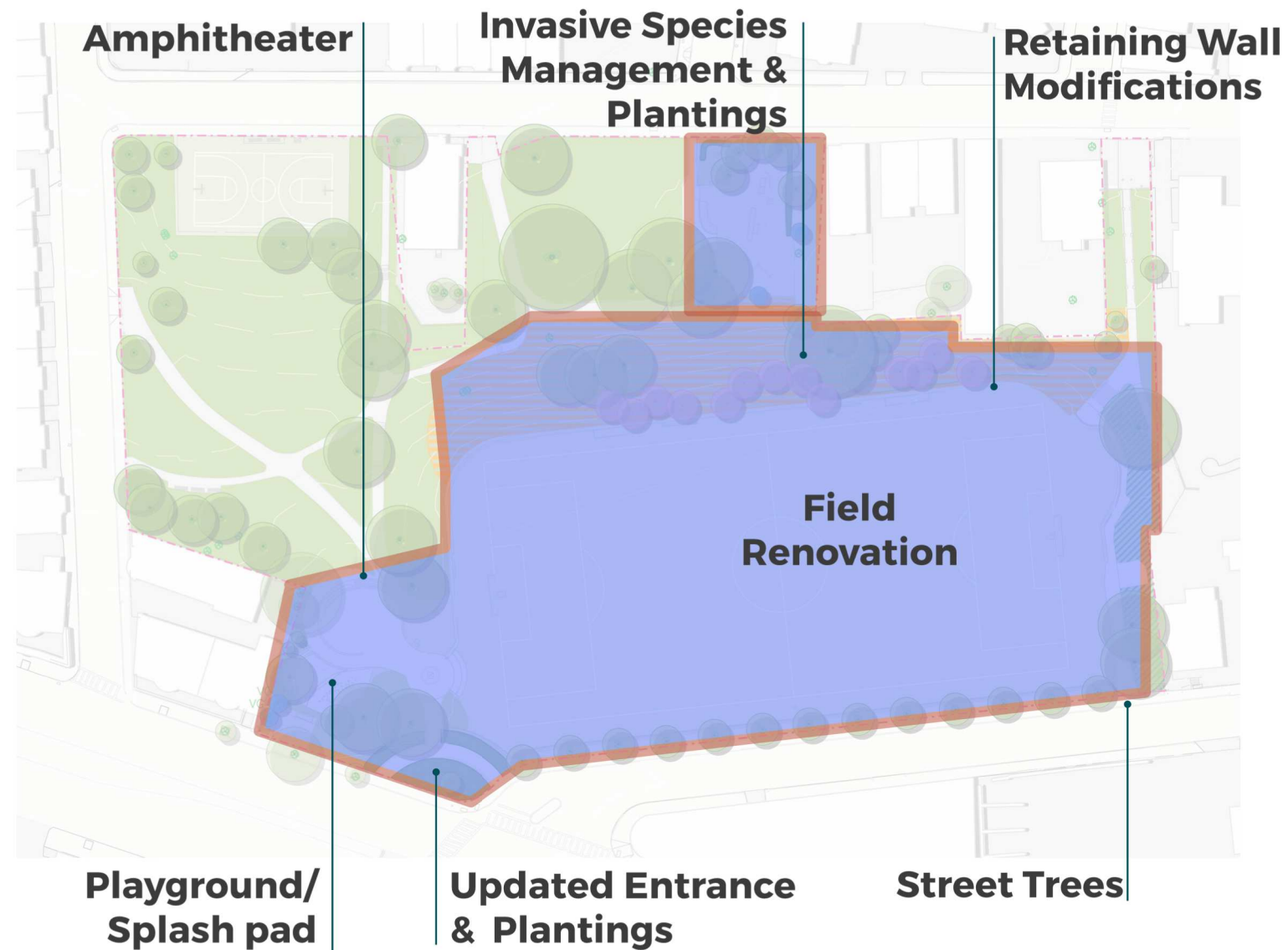

GOALS FOR CEYLON PARK RENOVATION

Update a much-loved community Park to 21st Century standards

Promote a safe environment

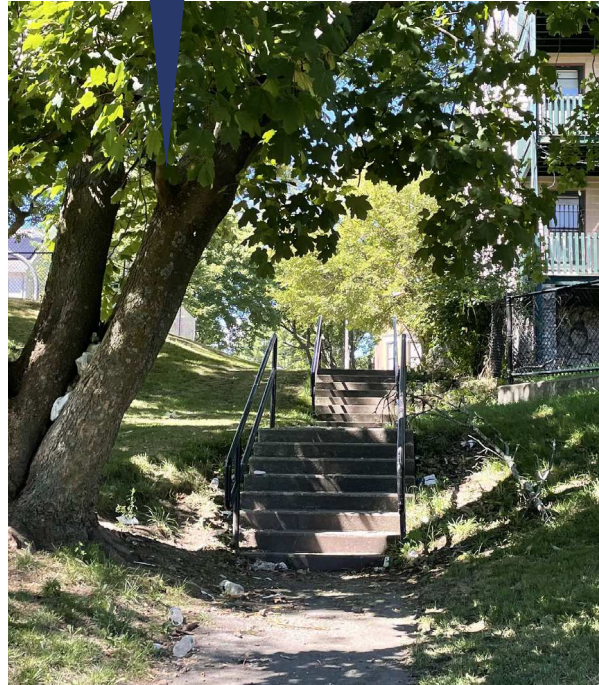

Increase Accessibility and availability for all users

Create a diverse, balanced, and efficient mix of uses

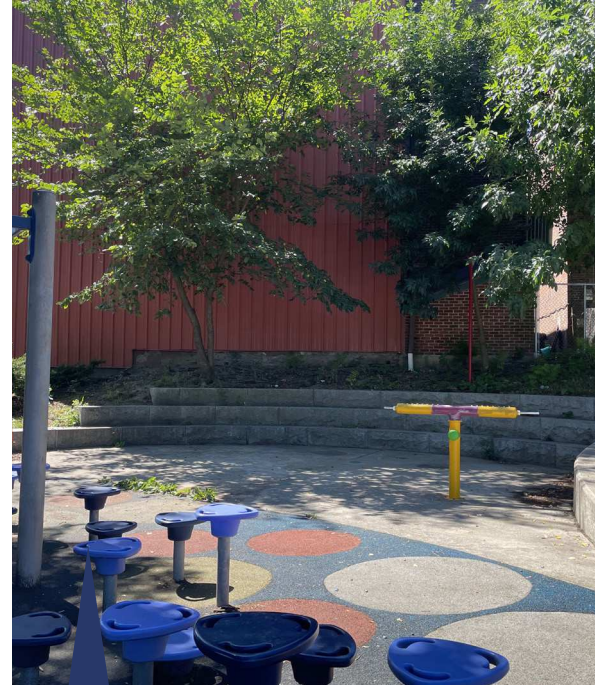

Design for successful maintenance



Generate a resilient landscape that adapts to future conditions

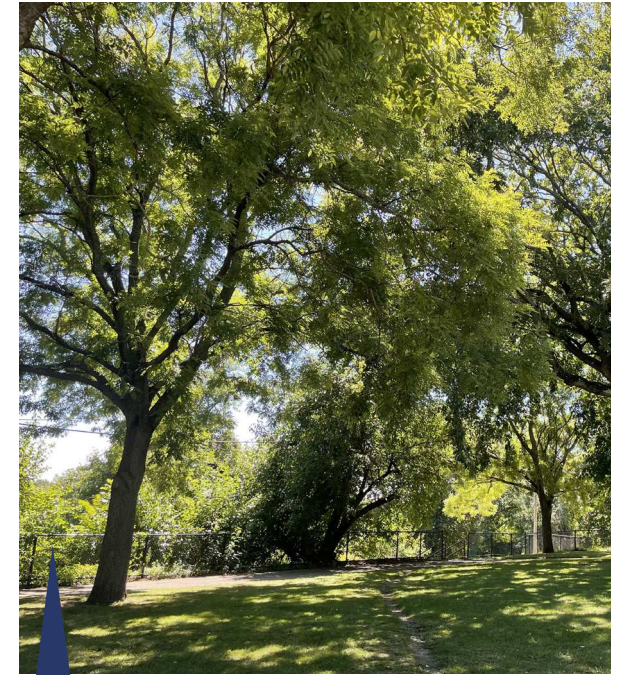

Opportunities & Constraints

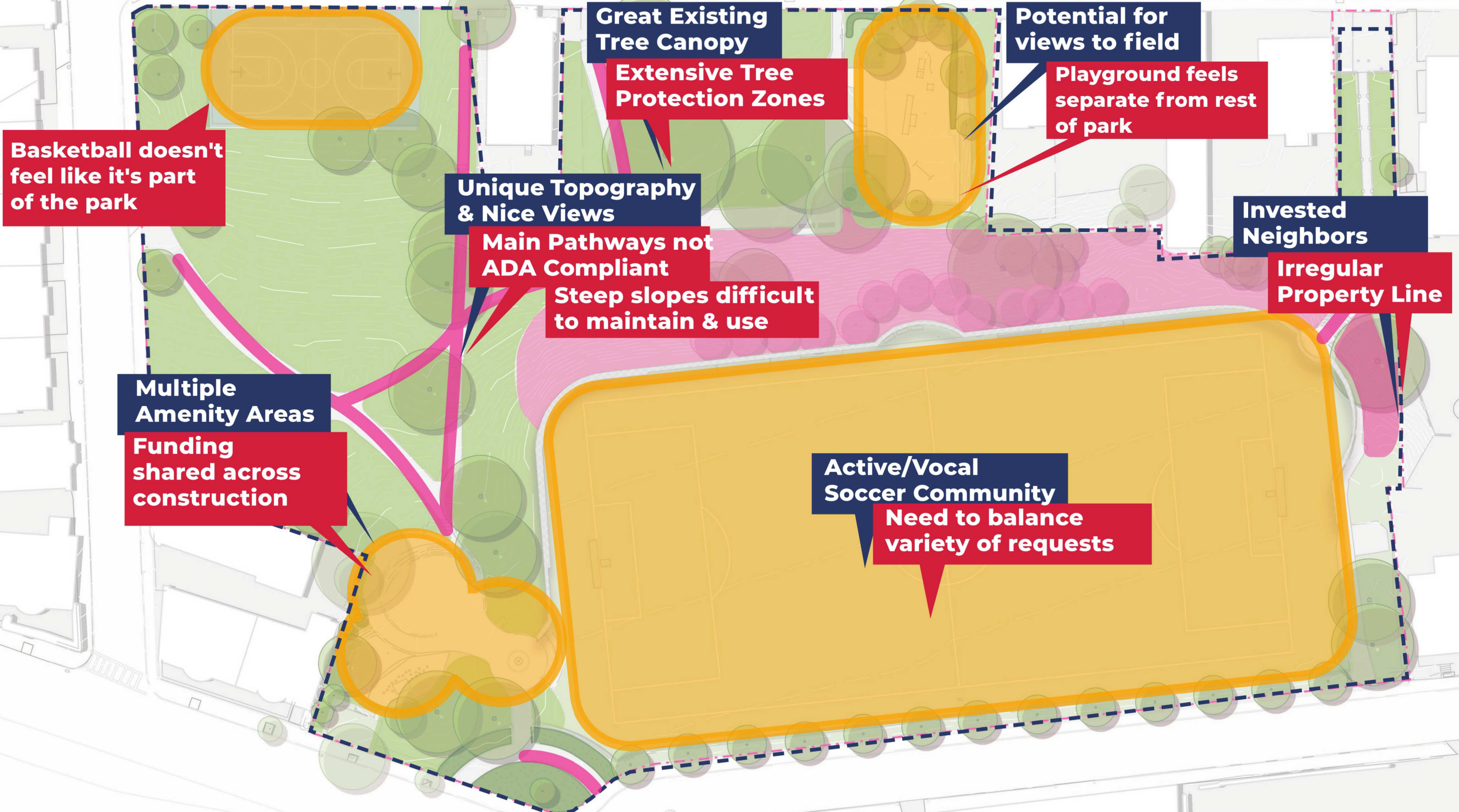

Opportunities & Constraints

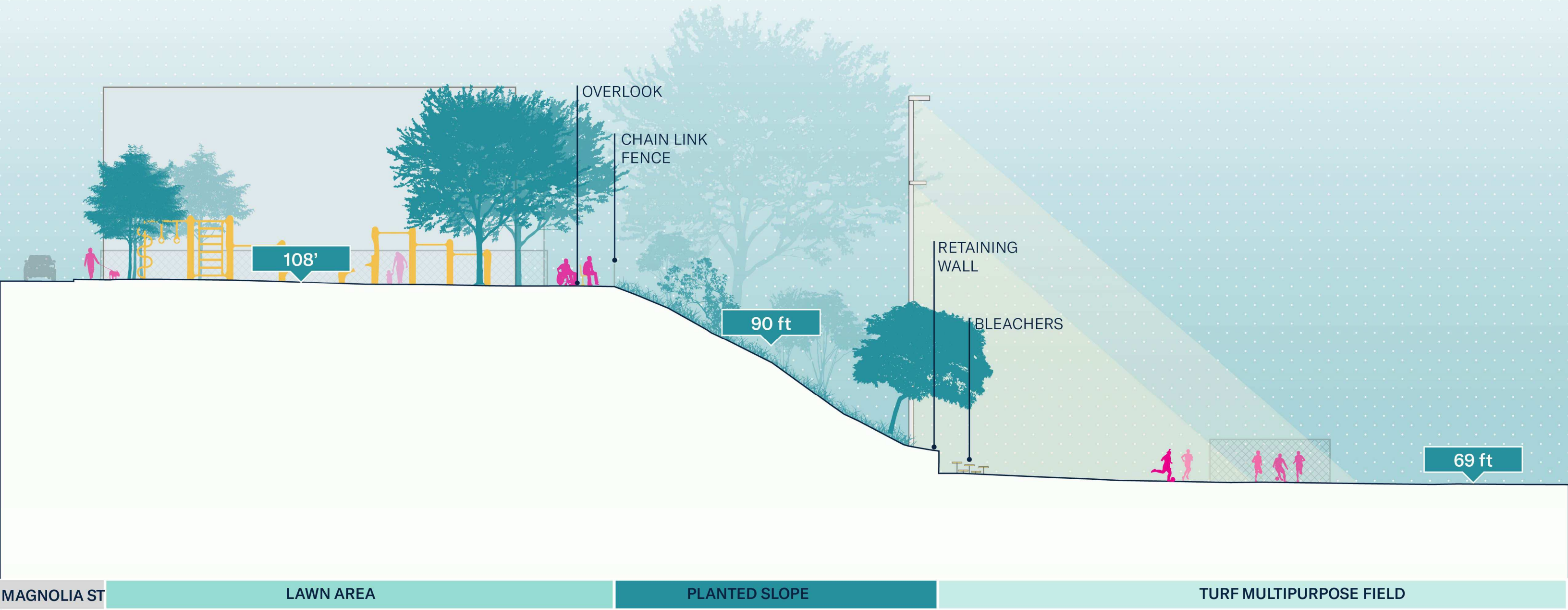

Existing Trees





Suitability for Preservation & Protection



Tree to protect are:

- In good health
- Not threatened by pests or diseases
- Likely to survive for many more years
- Not invasive species
- Provide landscape value to humans (shade, beauty) and other species

SUITABILITY FOR PRESERVATION

-  HIGH
-  MODERATE
-  LOW
-  TO BE REMOVED



Existing Trees

Construction Protection Zones



Tree to protect need:

- Protection from construction activities
- No digging near critical root zones
- Varying levels of protection depending on current condition, existing context, and species

TREE PROTECTION ZONES

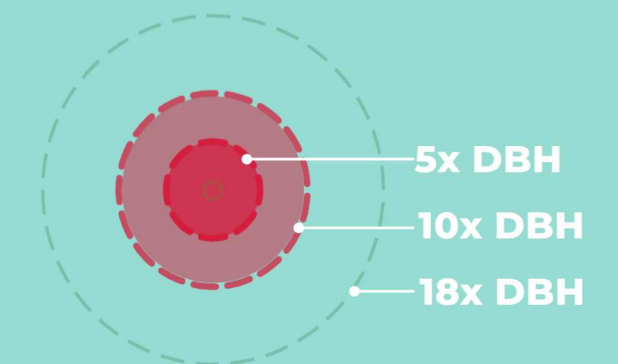

Design Process



Design Meeting / Survey 1

INFORMATION PRESENTED

- **BPRD Project Goals**
- **Site History & Analysis**

WHAT WE HEARD:

- **Priority Areas for Renovation:**
Sports Field, Seating,
and Lighting, Restrooms
Improvements
- **Top activities:**
Soccer, Walking/Exercise,
Sports, and Playground
- **Safety & maintenance** are
common themes

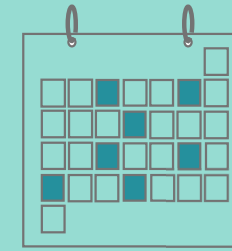

81%

Visit Daily or Weekly



80%

Of respondents
utilize the park for
soccer



#1 CONCERN

For the park was
maintenance, with
sports field condition
a close 2nd



Design Meeting / Survey 2

INFORMATION PRESENTED

- BPRD Project Goals & Timeline
- Three concepts incorporating Design Meeting 1 / Survey 1 feedback

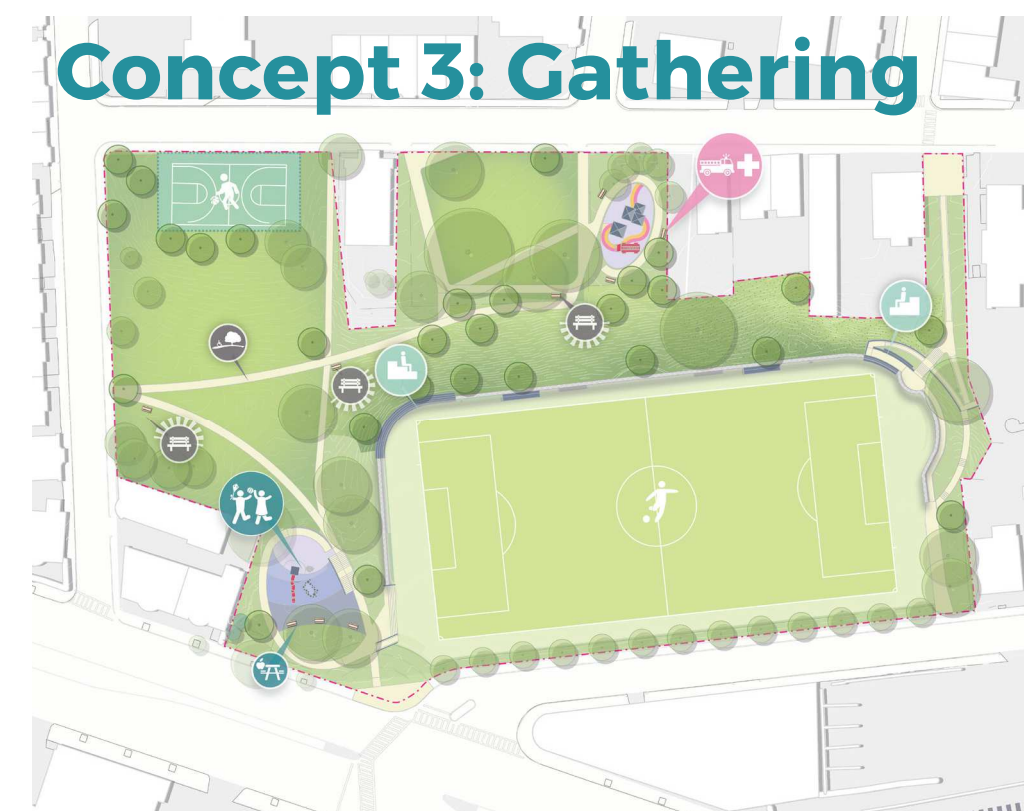
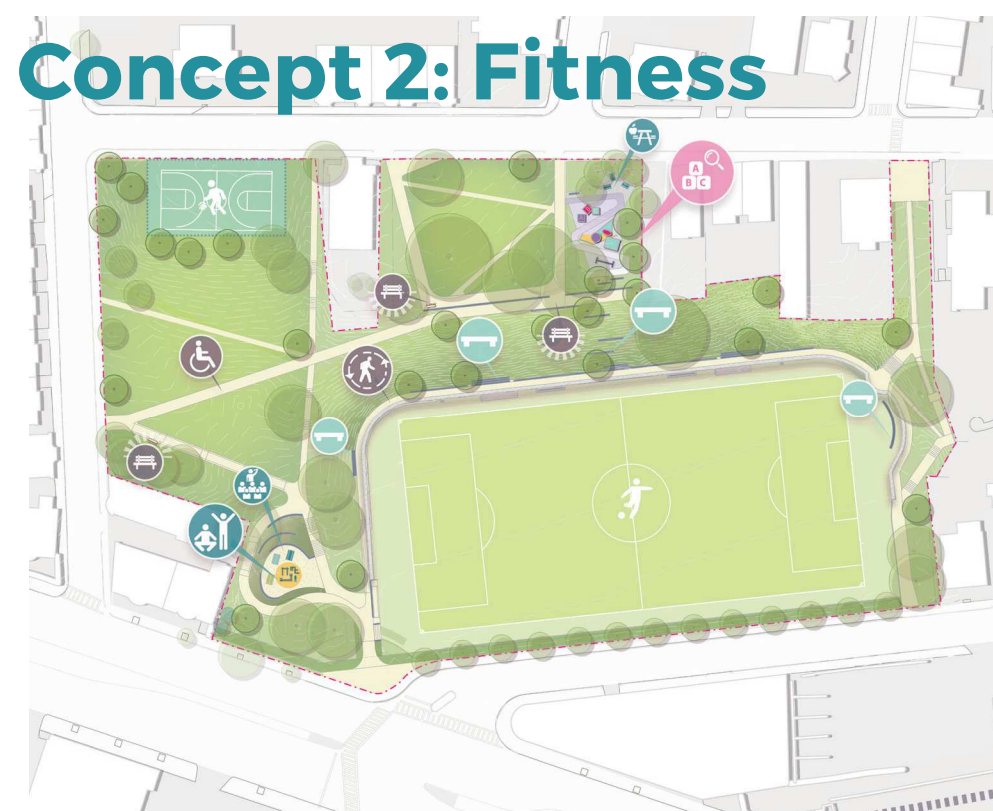

Design Meeting / Survey 2

HOW WE GATHERED FEEDBACK:



Listening

With on-site translation & interpretation in three languages (Spanish, Haitian Creole, and Cape Verdean Creole)

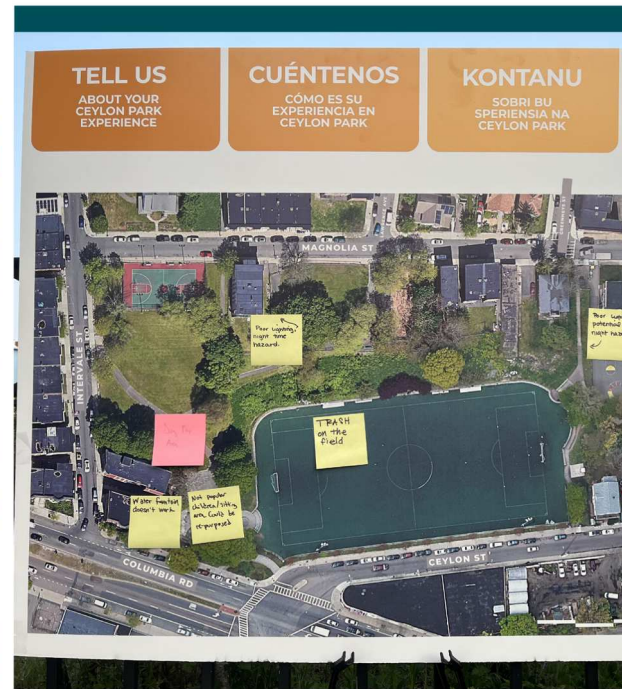

Writing on Site Map



Voting on Schemes

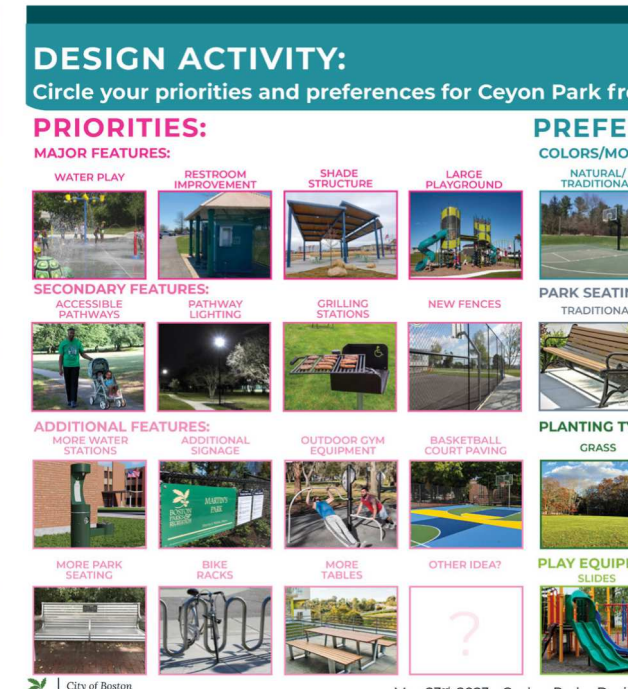

Priority & Preferences Survey



Online Survey Respondents

Pop-up boards, activities, and surveys included Spanish, Haitian Creole, and Cape Verdean Creole translations.



Concept 1: Play - Feedback

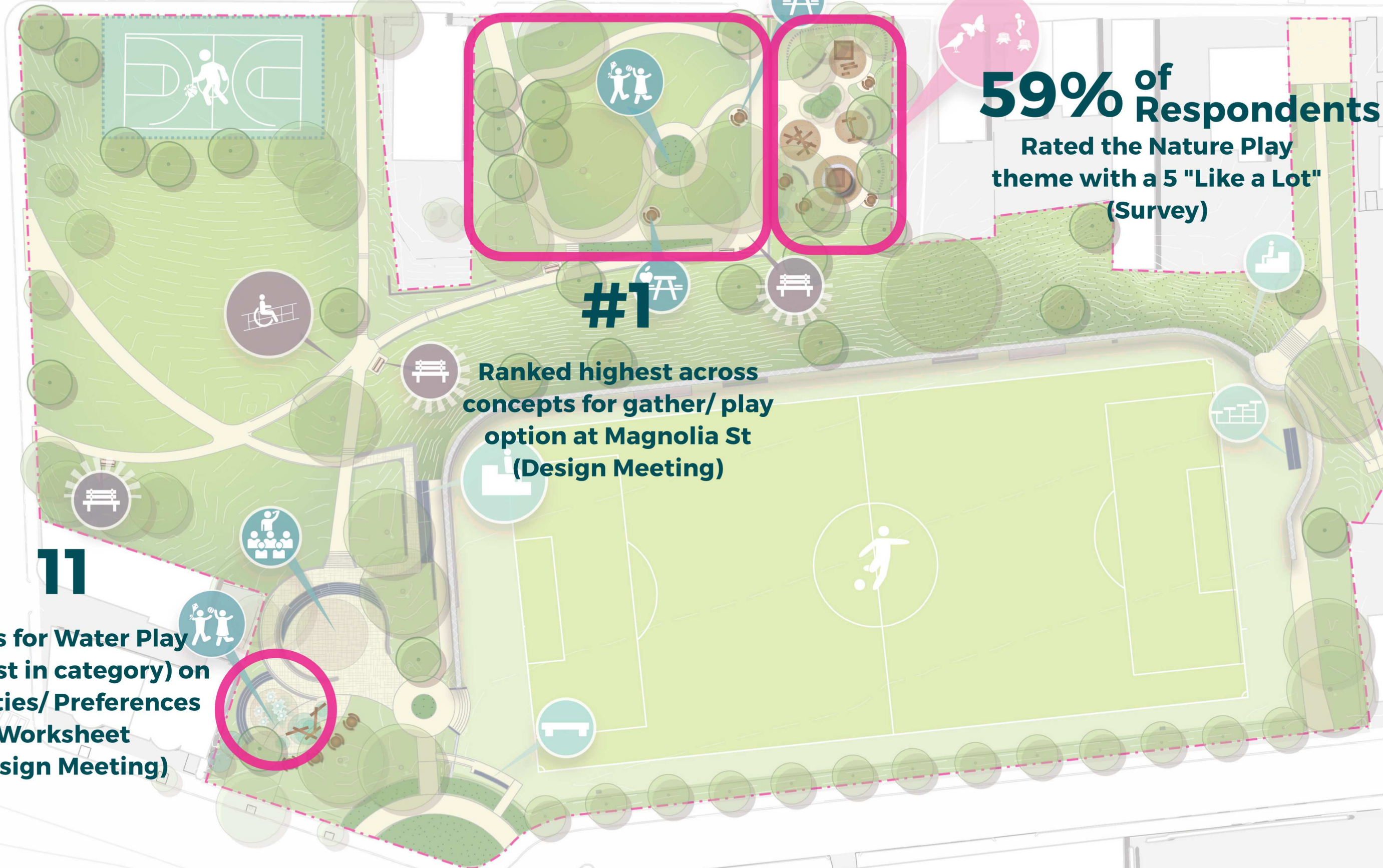

59% of Respondents
Rated the Nature Play
theme with a 5 "Like a Lot"
(Survey)

#1

Ranked highest across
concepts for gather/ play
option at Magnolia St
(Design Meeting)

11

Votes for Water Play
(highest in category) on
Priorities/ Preferences
Worksheet
(Design Meeting)



Concept 2: Fitness - Feedback

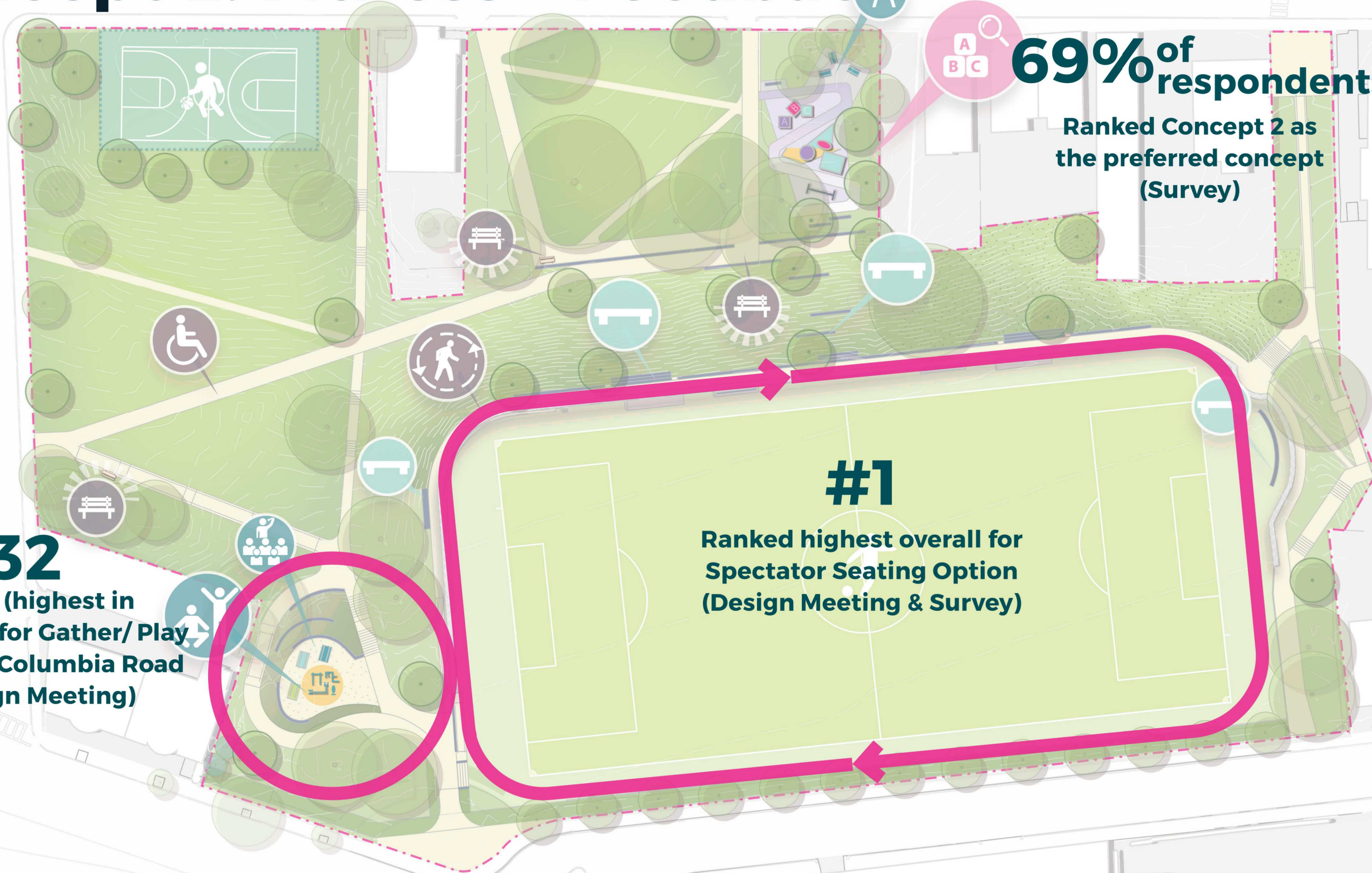

69% of respondents
Ranked Concept 2 as
the preferred concept
(Survey)

32
Votes (highest in
category) for Gather/ Play
option at Columbia Road
(Design Meeting)

#1
Ranked highest overall for
Spectator Seating Option
(Design Meeting & Survey)

Concept 3: Gathering - Feedback:

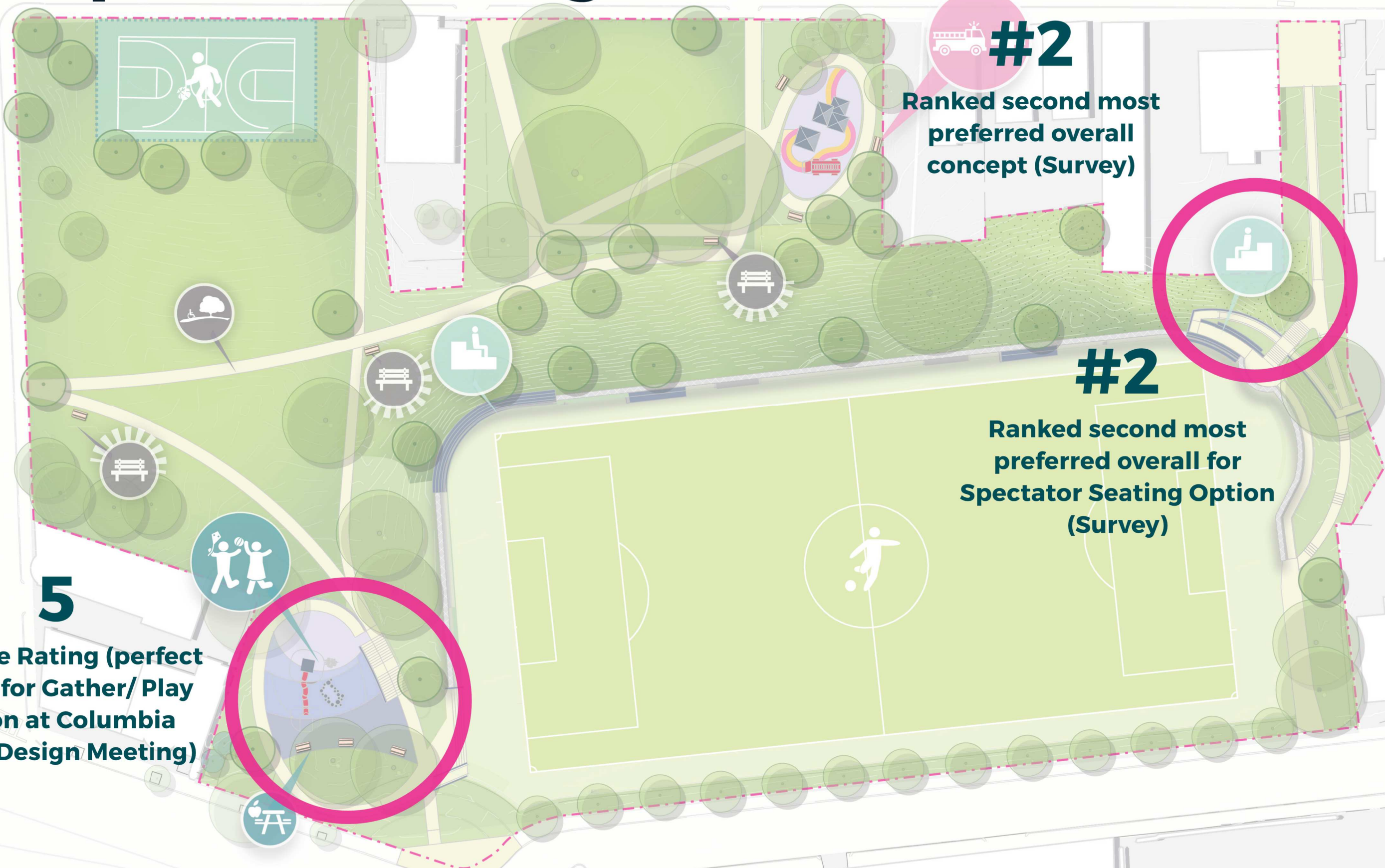

#2
Ranked second most preferred overall concept (Survey)

#2
Ranked second most preferred overall for Spectator Seating Option (Survey)

5
Average Rating (perfect score) for Gather/ Play option at Columbia Road (Design Meeting)

Schematic Design

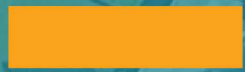

Project Goal

Considerations & Community Input

Design Direction

1. Accessible & available to all

Required by Law, appreciated by users

-Make main routes ADA compliant

2. Promote a safe environment

Concern of park users

-Lighting, cameras, signage,
-Increase visibility

3. Diverse, balanced, and efficient mix of uses

Soccer, playgrounds, basketball, & seating are all priorities

-Create synergy between field & walking routes
-Diversify & connect play areas to park capabilities

4. Design for successful maintenance

Requests for upkeep of restrooms and better routine maintenance

-Convert overgrown areas to lawn
-Use proven, durable materials

5. Generate a resilient landscape that adapts to future conditions

Consider existing tree canopy, increased heat and rain, community need for cooling

-Diversify canopy tree species
-Provide a cooling station for kids & adults
-Focus on drainage of steep slopes



DESIGN DIRECTION

Basketball:
Update
lighting and
resurface court



**Add amenities to
Magnolia Lawn**



**Nature-based
Play Theme**



**Seating above
wall at ends of
field**

**Improve North
Entrance and
provide ADA**

**Lighting &
Safety along
main path**

**Make Main Routes
ADA Compliant**



**Diversify Program
at Columbia Rd
gathering area**



SOCCER FIELD

**FITNESS
ROUTE**

Schematic Design Plan



Circulation

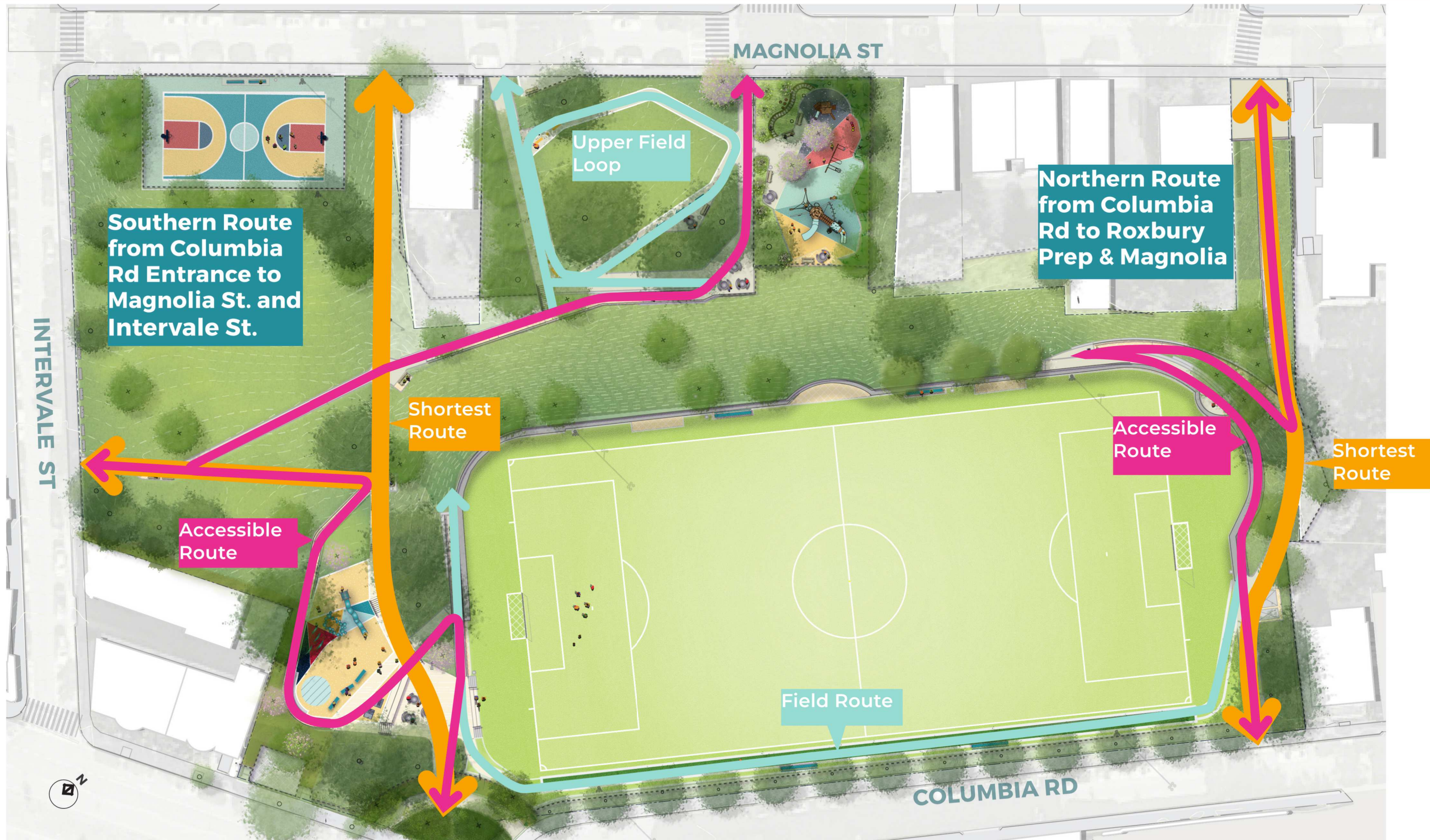

Circulation | A Closer Look



Safety Measures

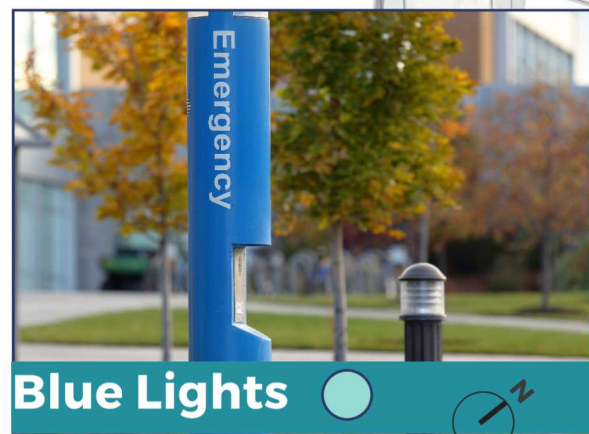
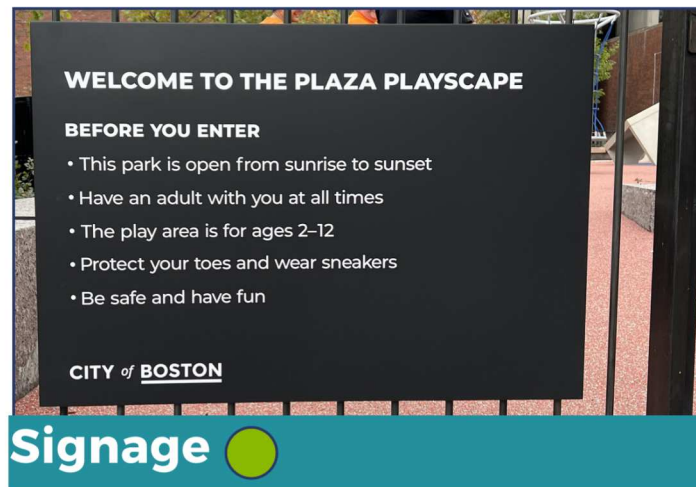

Field Renovation

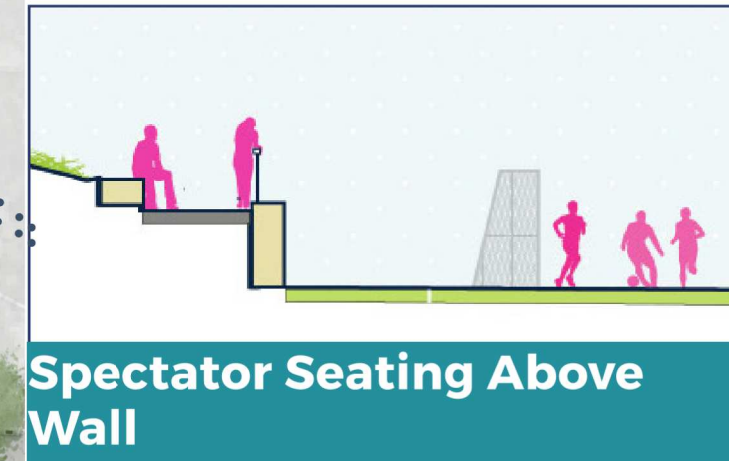

Spectator Seating Above Wall



Storage Box



Team Benches on Both Sides of Field



New Turf & Goals



Field Fitness Route & Stations



Vibrant Path Markings



S Prompt for Stretches and Exercises

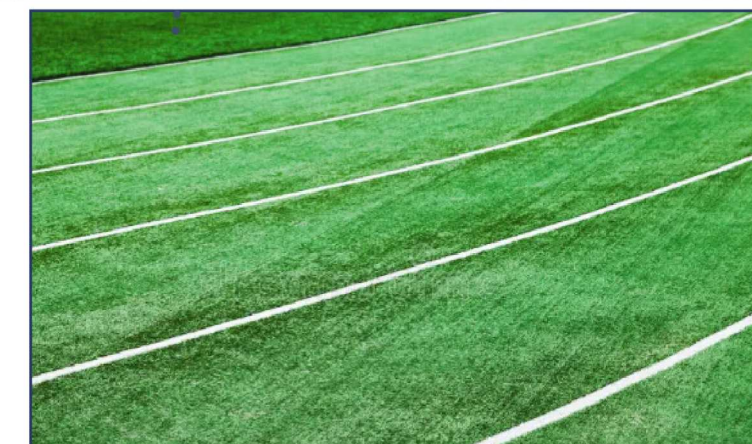

100m Track

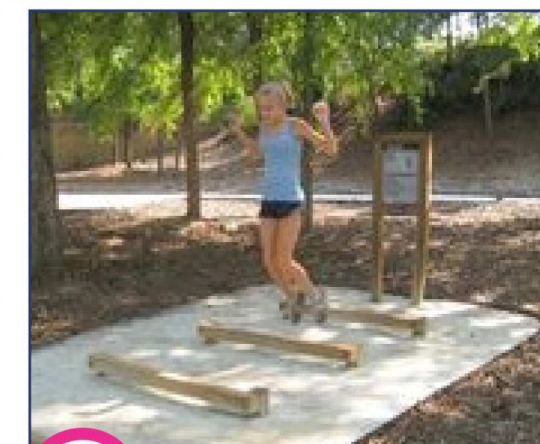

EQ Fitness Equipment

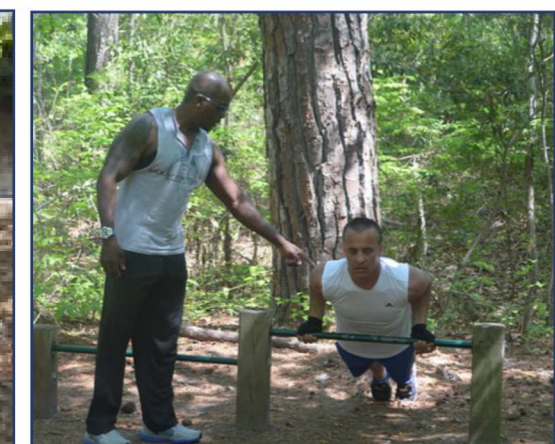

Columbia St. Gathering Area



SLOPED PLAYSCAPE



Cooling Station



Fitness Equipment

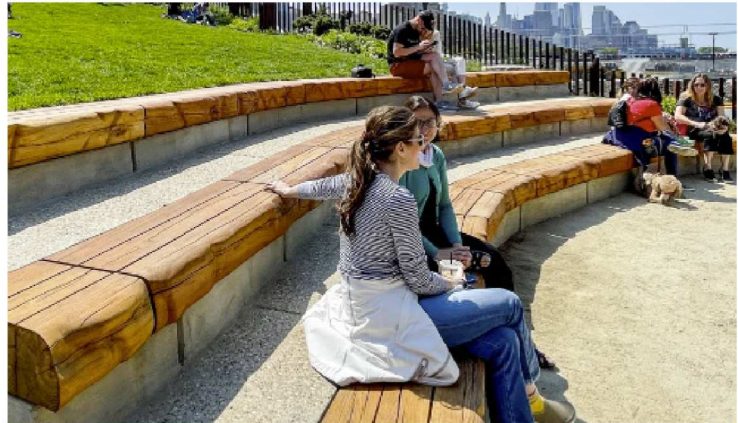
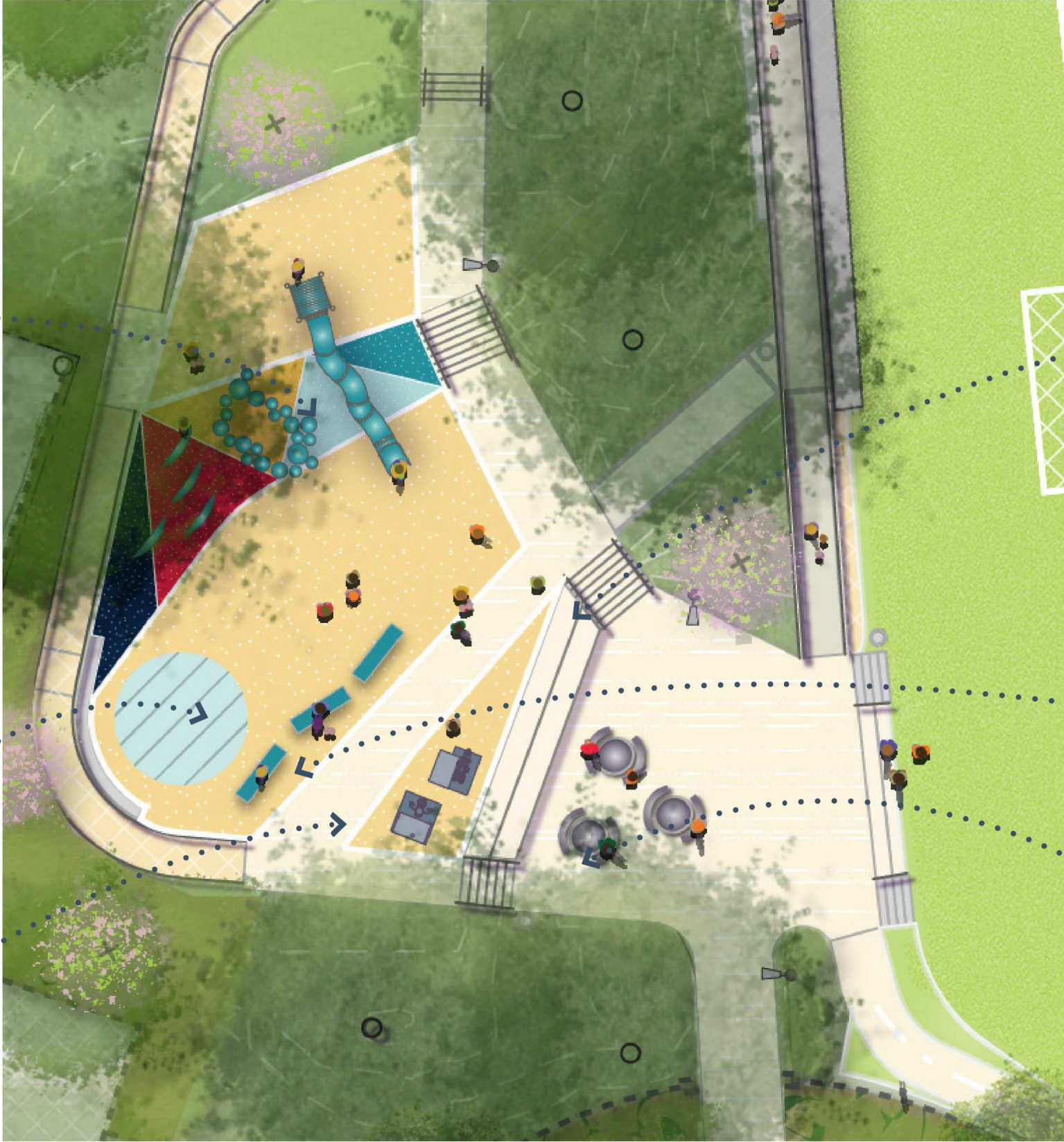

STEPPED SEATING



INFORMAL SEATING



Tables/Seating

Magnolia St. Gathering Area



Loop Pathway



Connection to Play



Picnic Grove



Engaging Pavement Marking

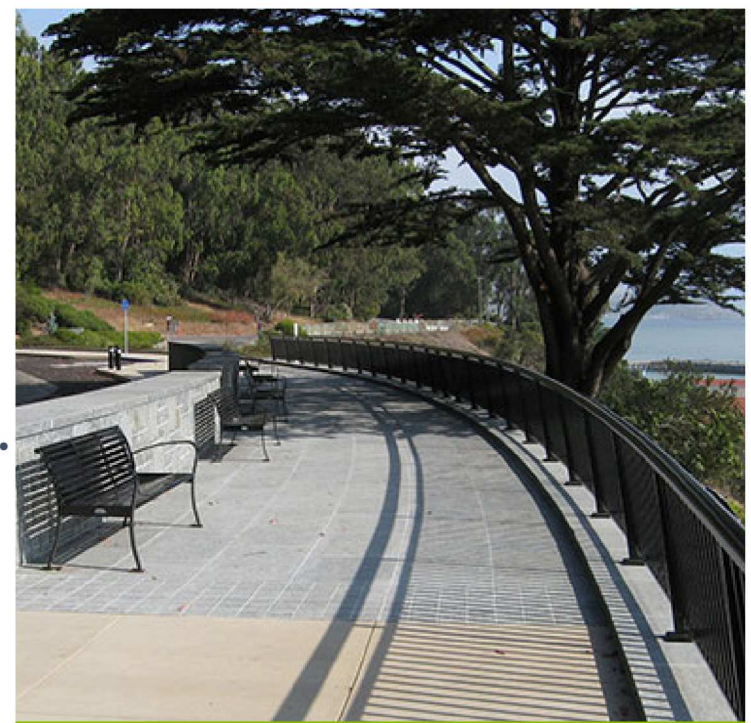

Updated Overlook

View & Connect to Field

Magnolia St. Playground

Flowering Tree "Forest"



Acorn Seats @ Woodland

Entrance

Planting Islands



5-12 Play Structure



2-5 Play Structure



Musical Instrument



Universal Swings

Picnic Overlook View to Field



Magnolia St. Playground

5-12 Structure Options



2-5 Structure Options

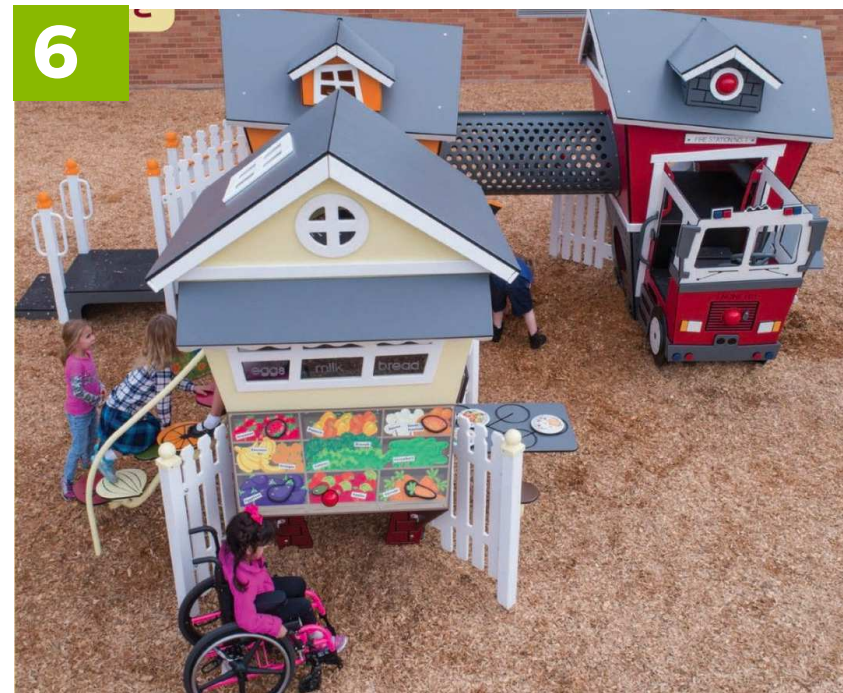

Basketball Improvements



RE-SURFACING + PAINT

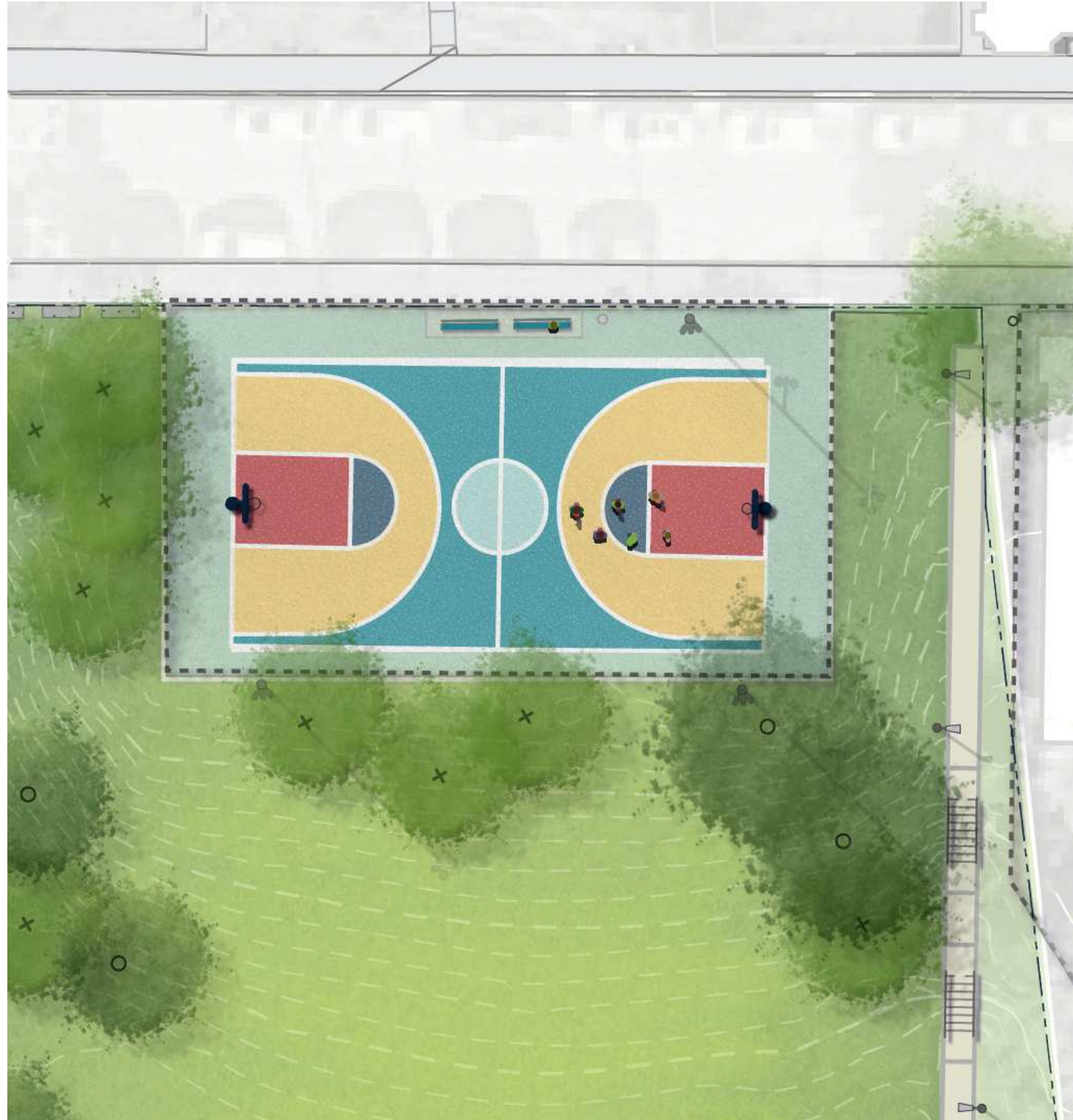

Shade Trees



NEW FENCING



UPDATED BENCHES



UPDATED HOOPS



Topography | Opportunities and Constraints

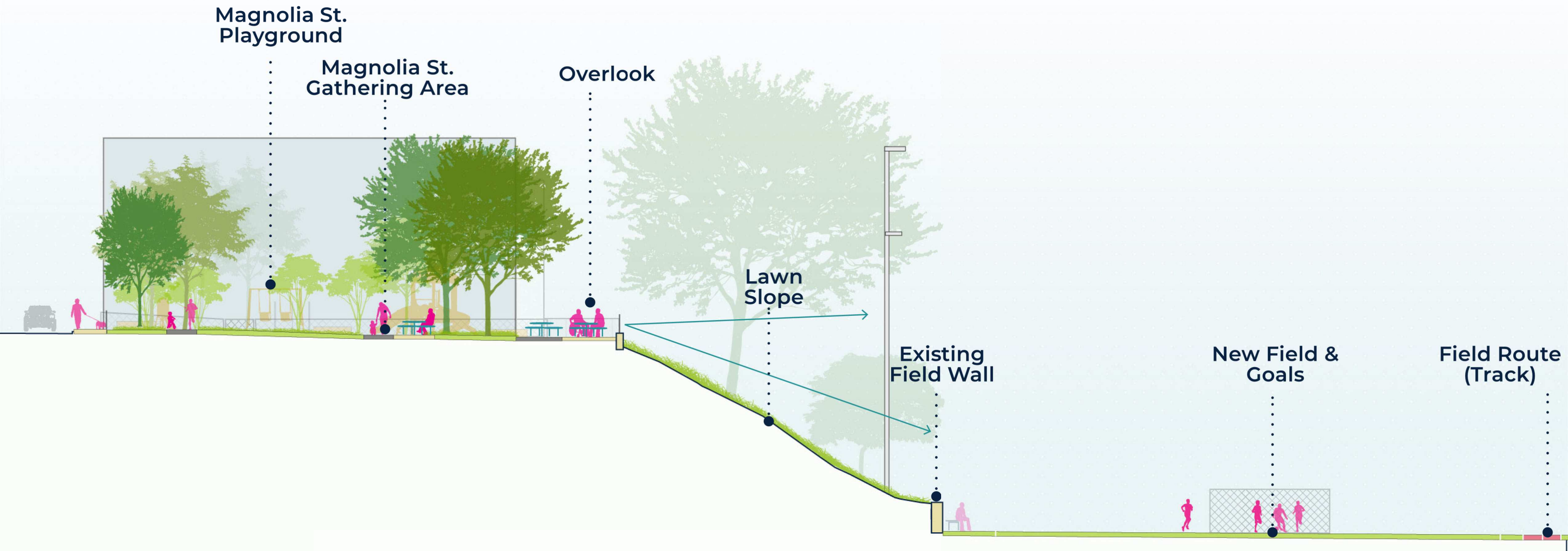

Schematic Design Plan



4

LISTENING & DISCUSSION





5 CLOSING REMARKS & NEXT STEPS



Thank You!



Improvements to Ceylon Park Project Information

Amy Linné

Project Manager

amy.linne@boston.gov or 617-961-3045

Project Website

Short Link: [www.boston.gov/
ceylon-park](http://www.boston.gov/ceylon-park)



Full Link: [https://www.boston.gov/
departments/parks-and-recreation/
improvements-ceylon-park](https://www.boston.gov/departments/parks-and-recreation/improvements-ceylon-park)

Survey Link

Short Link: bit.ly/CeylonSurvey



Full Link: [https://survey.alchemer.
com/s3/7293769/Ceylon-Park-
Renovation](https://survey.alchemer.com/s3/7293769/Ceylon-Park-Renovation)







6 APPENDIX



Design Meeting 2: Results

Sticky-Dot Voting Results: Concept 1

CONCEPT 1: PLAY

Balance the sports field with gathering areas at Ceylon and Magnolia St.

Strategies Include:

- Circulation & Viewing:** Add seating and viewing areas along the new accessible route through the park.
- Spectator Seating:** At both ends of the field, with above the wall at field level. Team benches main in place.
- Other/Play/Picnic:** Keep and improve both upper and lower areas, add more picnic space at top.
- Playground Theme:** "Up in the Air" with nature, tree, and bird focus.

CONCEPTO 1: JUEGOS

Equilibrar el campo de deportes con áreas de reunión y juego en Ceylon y Magnolia St.

Las estrategias de diseño incluyen:

- Circulación:** agregar asientos y áreas de observación a lo largo del nuevo camino accesible a través del parque.
- Asientos para espectadores:** en ambos extremos del campo, tanto por encima del muro como a nivel del campo. Los bancos de los equipos permanecen en su lugar.
- Reuniones/Juegos/Picnic:** Mantener y mejorar las zonas superior e inferior, añadir más espacio para picnic en la parte superior.
- Tema del parque infantil:** "En el aire" con enfoque en la naturaleza, el cielo, los árboles y las aves.

CONCEPTO 1: JOGU

Balance kanpus di jogu ku arias di lazer i na Ceylon i Magnolia St.

Strategies di Design ta inklui:

- Circulacion & Miradouru:** Poia arias di xinta i di miradouru na novu rota asesivel dentu di parki.
- Asientos pa Spetador:** Pa tudu ladu di kanpu, pa nivel di paredi di kanpu. Bankus di ekipas ta na lugar.
- Other/Jogu/Pikiniki:** Manti i midjora tantu arias di kanpu kuantu di baxu, poi mas spasu pa pikiniki i na topu.
- Tema di Parki Infantil:** "La Riba na Ar" fokadu na naturaleza, seu, arvi, i pasaru.

KONSÈP 1: JWÈT

Fè ekilib teren espò yo ak rasanbleman ak espas jwèt yo nan Ceylon ak Magnolia St.

Estrateji Konsepsyon yo genyen:

- Sikilasyon:** Ajoute plas pou chita ak espas pou gade ansanm a t aksesib ki mennen nan pak la.
- Plas pou Chita sou Teren an:** Nan tou de pwent teren an, ni pa anwo mi nan nivo teren an. Ban ekip yo rete sou plas.R
- Reyini/Jwe/Fè Piknik:** Konsève ak amelyore ni espas anwo ak anba yo, ajoute plis espas piknik pa anwo.
- Tem Teren Jwèt:** "Byen wo Anlè a" ak fokalize sou lanati, syel, pyebwa, ak zwazo.



PLAYGROUND THEME

TEMA DEL PARQUE INFANTIL
TEMA DI PARKI INFANTIL
TÈM TEREN JWÈT

DISLIKE NO ME GUSTA KA GOSTA PA RENMEN
USE A STICKER TO VOTE UTILICE UN STICKER PARA VOTAR: UZA UN STICKER PA VOTA: SEVI AK YON OTOKOLAN POU VOTE:
LIKE ME GUSTA MUCHO GOSTA TXEU RENMEN ANPIL

LOGS
LEAVES & FLOWERS
DIHDS AND BUTTERFLIES
TREE HOUSE

GATHER/ PLAY/PICNIC

REUNIONES/JUEGOS/PICNIC
LAZER/ JOGU/PIKINIKI
REYINI/JWE/FÈ PIKNIK

@ COLUMBIA RD

DISLIKE NO ME GUSTA KA GOSTA PA RENMEN
USE A STICKER TO VOTE UTILICE UN STICKER PARA VOTAR: UZA UN STICKER PA VOTA: SEVI AK YON OTOKOLAN POU VOTE:
LIKE ME GUSTA MUCHO GOSTA TXEU RENMEN ANPIL

AMPHITHEATRE
PICNIC TABLES
BENCHES

GATHER/ PLAY/PICNIC

REUNIONES/JUEGOS/
LAZER/ JOGU/PIKINIKI
REYINI/JWE/FÈ PIKNIK

@ MAGNOLIA ST

DISLIKE NO ME GUSTA KA GOSTA PA RENMEN
USE A STICKER TO VOTE UTILICE UN STICKER PARA VOTAR: UZA UN STICKER PA VOTA: SEVI AK YON OTOKOLAN POU VOTE:
LIKE ME GUSTA MUCHO GOSTA TXEU RENMEN ANPIL

PLAYGROUND
PICNIC TABLES

CIRCULATION & VIEWING

SIRKULACION Y VISTA
CIRCULASION & MIRADOURU
SIKILASYON

DISLIKE NO ME GUSTA KA GOSTA PA RENMEN
USE A STICKER TO VOTE UTILICE UN STICKER PARA VOTAR: UZA UN STICKER PA VOTA: SEVI AK YON OTOKOLAN POU VOTE:
LIKE ME GUSTA MUCHO GOSTA TXEU RENMEN ANPIL

SPECTATOR SEATING

ASIENTOS PARA ESPACTADORES
BANKUS PA SPETADOR
PLAS CHITA ESPEKTATÈ

DISLIKE NO ME GUSTA KA GOSTA PA RENMEN
USE A STICKER TO VOTE UTILICE UN STICKER PARA VOTAR: UZA UN STICKER PA VOTA: SEVI AK YON OTOKOLAN POU VOTE:
LIKE ME GUSTA MUCHO GOSTA TXEU RENMEN ANPIL

BENCHES
SPECTATOR SEATING

Design Meeting 2: Results

Sticky-Dot Voting Results: Concept 2

CONCEPT 2: FITNESS

Emphasizes exercise with a new walking route and gym equipment.

Design Strategies Include:

- Circulation & Viewing: Add a walking route around the top of the field wall.
- Spectator Seating: All around the field above the wall (along new walking route).
- Gather/Play/Picnic: Add gym equipment in place of lower play area. Keep and improve upper playground and picnic area.
- Playground Theme: "Learning Lab" alphabet, number, color, and discovery theme.

CONCEPTO 2: ACTIVIDAD FÍSICA

Enfatiza el ejercicio con un nuevo sendero peatonal y equipamiento de gimnasio.

Las estrategias de diseño incluyen:

- Circulación y vista: agregar un sendero peatonal alrededor de la parte superior del muro del campo.
- Asientos para espectadores: alrededor del campo por encima del muro (a lo largo de un nuevo sendero peatonal).
- Reuniones/Juegos/Picnic: agregar aparatos de gimnasia en lugar de un área de juegos inferior. Mantener y mejorar el área superior de juegos y picnic.
- Tema del parque infantil: "Laboratorio de aprendizaje", tema del alfabeto, los números, colores y descubrimiento.

KONSEITU 2: IZERSISIU

Midjora izersisiu ku un novu rota di kaminhada i ekipamentu di jinaziu.

Stratejias di Design ta inklui:

- Sirkulasyon & Miradouru: Poi un rota di kaminhada a volta di topu di paredi di kanpu.
- Banku pa Spetador: Tudu a volta di kanpu pa riba di paredi (djuntu ku novu rota di kaminhada).
- Lazer/Jogu/Pikiniki: Poi ekipamentu di jinaziu na lokal di un aria di jogu mas baxu. Manti i midjora parki infantil i aria di pikiniki.
- Tema di Parki Infantil: "Laboratoriu di Aprendizaje" ("Laboratoriu di Aprendizaje") alfabetu, numeru, kor, i tema di diskoberta.

KONSÈP 2: SANTE FIZIK

Mete aksan sou egzèsis ak yon nouvo wout pou mache ak ekipman djim.

Estrateji Konsepsyon yo genyen:

- Sikilasyon ak Vizyonman: Ajoute yon wout pou mache ozalantou mi teren an.
- Plas Chita Espektatè: Ozalantou teren an pa anwo mi an (ansanm ak yon wout pou mache).
- Reyini/Jwe/Fè Piknik: Ajoute ekipman djim nan yon espas yo jwe mwens. Konseve ak amelyore teren jwèt pa anwo ak espas piknik la.
- Tèm Teren Jwèt: "Laboratwa Aprantisaj" dekouvèt alfabè, chif, koule, ak tèm.



PLAYGROUND THEME

TEMA DEL PARQUE INFANTIL
TEMA DI PARKI INFANTIL
TÈM TEREN JWÈT

DISLIKE: NO ME GUSTA KA GOSTA PA RENMEN
USE A STICKER TO VOTE: UTILICE UN STICKER PARA VOTAR: UZA UN STICKER PA VOTA: SEVI AK YON OTOKOLAN POU VOTE:
LIKE: ME GUSTA MUCHO GOSTA TXEU RENMEN ANPIL

A 1 B C 2 3

COLORS

NUMBERS

SHADES

GATHER/ PLAY/PICNIC

REUNIONES/JUEGOS/PICNIC
LAZER/ JOGU/PIKINIKI
REYINI/JWE/FÈ PIKNIK

@ COLUMBIA RD

DISLIKE: NO ME GUSTA KA GOSTA PA RENMEN
USE A STICKER TO VOTE: UTILICE UN STICKER PARA VOTAR: UZA UN STICKER PA VOTA: SEVI AK YON OTOKOLAN POU VOTE:
LIKE: ME GUSTA MUCHO GOSTA TXEU RENMEN ANPIL

TIERED SEATING

EXERCISE EQUIPMENT

OUTDOOR GYM

GATHER/ PLAY/PICNIC

REUNIONES/JUEGOS/
LAZER/ JOGU/PIKINIKI
REYINI/JWE/FÈ PIKNIK

@ MAGNOLIA ST

DISLIKE: NO ME GUSTA KA GOSTA PA RENMEN
USE A STICKER TO VOTE: UTILICE UN STICKER PARA VOTAR: UZA UN STICKER PA VOTA: SEVI AK YON OTOKOLAN POU VOTE:
LIKE: ME GUSTA MUCHO GOSTA TXEU RENMEN ANPIL

SOCIAL + PLAYFUL SEAT

PICNIC GROVE

CIRCULATION & VIEWING

CIRCULACIÓN Y VISTA
SIRKULASON & MIRADOURU
SIKILASYON:

DISLIKE: NO ME GUSTA KA GOSTA PA RENMEN
USE A STICKER TO VOTE: UTILICE UN STICKER PARA VOTAR: UZA UN STICKER PA VOTA: SEVI AK YON OTOKOLAN POU VOTE:
LIKE: ME GUSTA MUCHO GOSTA TXEU RENMEN ANPIL

WALKING LOOP

JUMP OVER THE HURDLES

PAVED PATHWAYS

TRAIL

STAIRS

SPECTATOR SEATING

ASIENTOS PARA ESPACTADORES
BANKU PA SPETADOR
PLAS CHITA ESPEKTATÈ

DISLIKE: NO ME GUSTA KA GOSTA PA RENMEN
USE A STICKER TO VOTE: UTILICE UN STICKER PARA VOTAR: UZA UN STICKER PA VOTA: SEVI AK YON OTOKOLAN POU VOTE:
LIKE: ME GUSTA MUCHO GOSTA TXEU RENMEN ANPIL

FIELD LOOP PATHWAY

STEPPED SEATING

ABOVE FIELD

Design Meeting 2: Results

Sticky-Dot Voting Results: Concept 3

CONCEPT 3: GATHERING

Focuses on gathering areas at the lower level and terraced seating at the field.

Design Strategies Include:

- Circulation & Viewing: Create a gently sloping, long route from Columbia Rd to Magnolia St.
- Spectator Seating: Rebuild part of the field wall with amphitheater seating.
- Gather/Play/Picnic: Keep and improve play and picnic at Magnolia St. Rebuild the amphitheater with some play elements.
- Playground Theme: "Community Helpers" with healthcare, construction, fire fighter and other similar themed elements.

CONCEPTO 3: REUNIÓN

Se enfoca en áreas de reunión en el nivel inferior y asientos en terrazas en el campo.

Las estrategias de diseño incluyen:

- Circulación y vista: crear un camino largo de pendiente suave desde Columbia Rd. hasta Magnolia St.
- Asientos para espectadores: reconstruir parte del muro del campo con asientos de anfiteatro.
- Reuniones/Juegos/Picnic: mantener y mejorar el juego y el picnic en Magnolia St. Reconstruir el anfiteatro con algunos elementos de juego.
- Tema del parque infantil: "Ayudantes de la comunidad" con elementos relacionados con la salud, la construcción, los bomberos y otros temas similares.

KONSEITU 3: LAZER

Foka na arias di lazer na nivel mas baxu i banku di xinta na terasu di kanpu.

Stratejias di Design ta inklui:

- Sirkulasyon & Miradouru: Kria un rota kunpridu i un kuzinha inklinaadu di Columbia RD ti Magnolia St.
- Banku pa Spetador: Refazi parti di pardi di kanpu ku banku di anfiteatu.
- Lazer/Jogu/Pikiniki: Manti i midjora jogu i pikiniki na Magnolia St. Refazi anfiteatu ku alguns ilimentus di jogu.
- Tema di Parki Infantil: "Community Helpers" ("Ajudantis Kumunitarius") ku ilimentus di kuidadu di saudi, konstruson, boonberus i otus ilimentus tematikus pasesidu.

KONSÈP 3: RASANBLEMAN

Fokalize sou espas rasanbleman nan nivo anba ak plas chita ki sou teras teren an.

Estrateji Konsepsyon yo genyen:

- Sikilasyon ak Vizyonman Create a gently sloping, long route from Columbia RD to Magnolia St.
- Plas Chita Espektatè: Rekonstwi yon pati nan mi teren an sou form plas chita anfiteyat.
- Reyini/Jwe/Fè Piknik: Konsève ak amelyore jwèt ak piknik nan Magnolia St. Rekonstwi anfiteyat la ak kèlke eleman jwèt.
- Tèm Teren Jwèt: "Sipote Kominote" ak swen sante, konstwiwksyon, ponpye ak lot eleman tèm ki sanble ak sa.

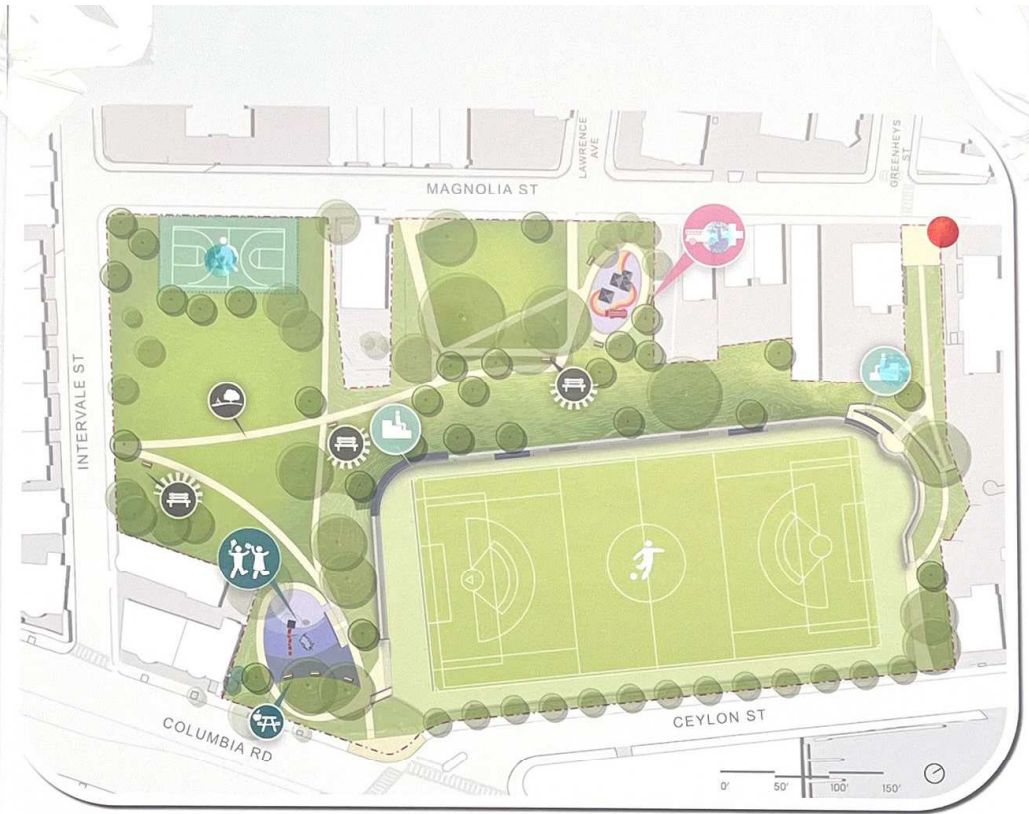

PLAYGROUND THEME
TEMA DEL PARQUE INFANTIL
TÈM TEREN JWÈT

DISLIKE NO ME GUSTA KA GOSTA PA RENMEN

USE A STICKER TO VOTE UTILICE UN STICKER PARA VOTAR: UZA UN STICKER PA VOTA: SÈVI AK YON OTOKOLAN POU VOTE.

LIKE ME GUSTA MUCHO GOSTA TXEU RENMEN ANPIL

TEACHERS, HEALTHCARE WORKERS, FIRE FIGHTERS

GATHER/ PLAY/PICNIC
REUNIONES/JUEGOS/PICNIC
LAZER/ JOGU/PIKINIKI
REYINI/JWE/FÈ PIKNIK

@ COLUMBIA RD

DISLIKE NO ME GUSTA KA GOSTA PA RENMEN

USE A STICKER TO VOTE UTILICE UN STICKER PARA VOTAR: UZA UN STICKER PA VOTA: SÈVI AK YON OTOKOLAN POU VOTE.

LIKE ME GUSTA MUCHO GOSTA TXEU RENMEN ANPIL

SLIDES, SHADED GROVE, CLIMBING

CIRCULATION & VIEWING
CIRCULACIÓN Y VISTA
SIRKULASON & MIRADOURU
SIKILASYON:

DISLIKE NO ME GUSTA KA GOSTA PA RENMEN

USE A STICKER TO VOTE UTILICE UN STICKER PARA VOTAR: UZA UN STICKER PA VOTA: SÈVI AK YON OTOKOLAN POU VOTE.

LIKE ME GUSTA MUCHO GOSTA TXEU RENMEN ANPIL

BENCH, GENTLY SLOPING PATHS, POSITIVE CIRCULATION

SPECTATOR SEATING
ASIENTOS PARA ESPACTADORES
BANKU PA SPETADOR
PLAS CHITA ESPEKTATÈ

DISLIKE NO ME GUSTA KA GOSTA PA RENMEN

USE A STICKER TO VOTE UTILICE UN STICKER PARA VOTAR: UZA UN STICKER PA VOTA: SÈVI AK YON OTOKOLAN POU VOTE.

LIKE ME GUSTA MUCHO GOSTA TXEU RENMEN ANPIL

STEPS AT CORNERS, STEPPED SEATING

GATHER/ PLAY/PICNIC
REUNIONES/JUEGOS/
LAZER/ JOGU/PIKINIKI
REYINI/JWE/FÈ PIKNIK

@ MAGNOLIA ST

DISLIKE NO ME GUSTA KA GOSTA PA RENMEN

USE A STICKER TO VOTE UTILICE UN STICKER PARA VOTAR: UZA UN STICKER PA VOTA: SÈVI AK YON OTOKOLAN POU VOTE.

LIKE ME GUSTA MUCHO GOSTA TXEU RENMEN ANPIL

LAWN AREA, LEVEL GATHERING SPACE, SASAKI

Survey 2: Results

Online Survey 2

16. Overall, which concept do you like the best?

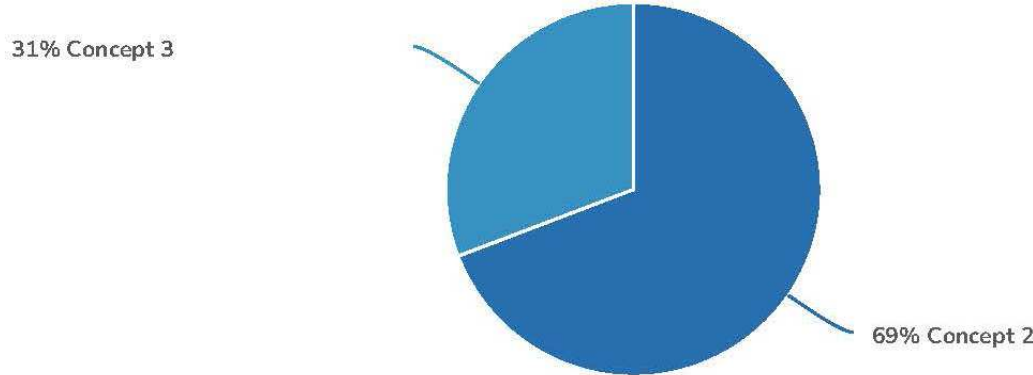

Value	Percent	Responses
Concept 2	69.2%	9
Concept 3	30.8%	4

Totals: 13

Survey 2: Results

Online Survey 2

18. What do you typically do at Ceylon Park? Select the activities from the list below that you play, watch, or bring someone else to play. Choose all that apply.

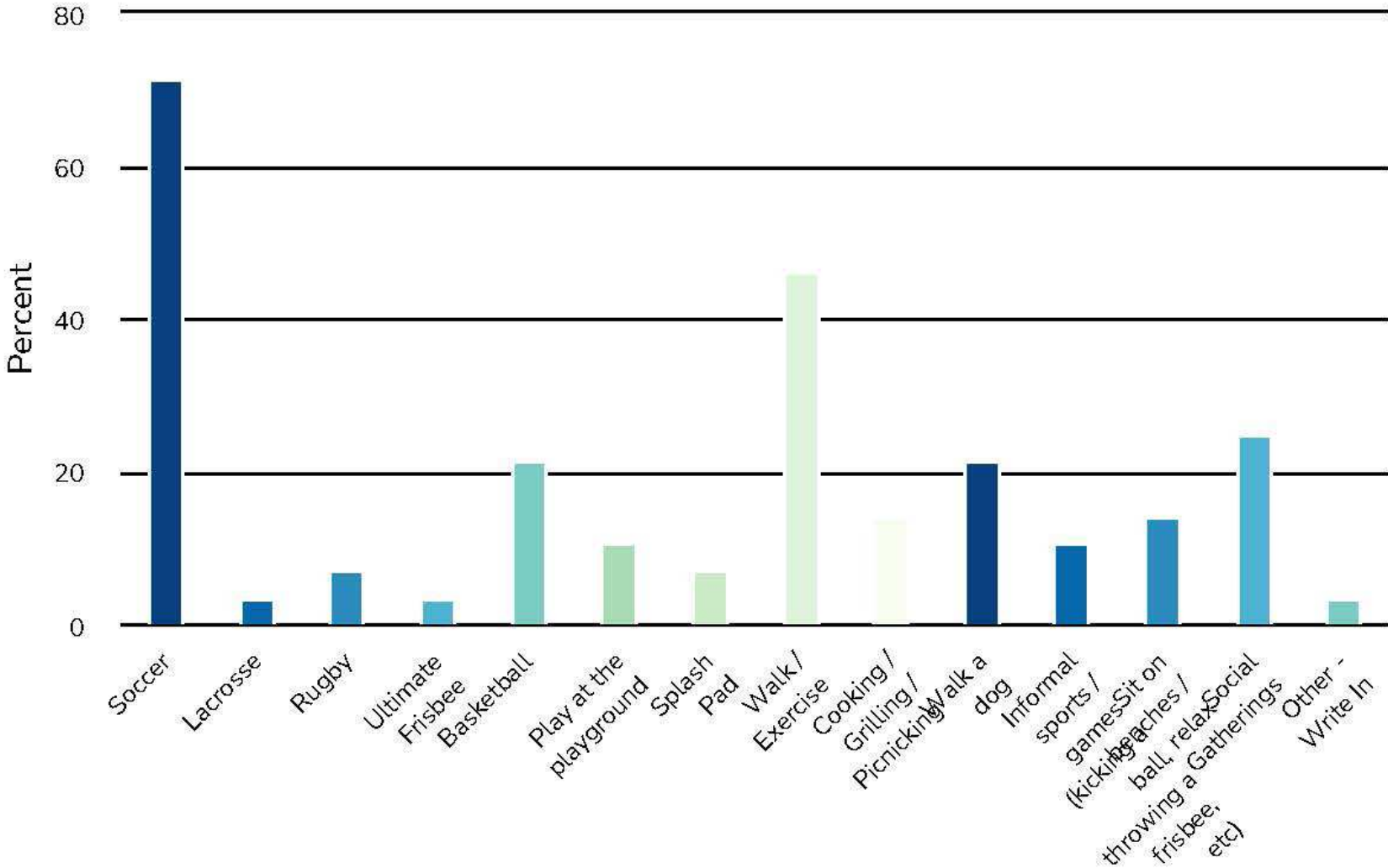

Survey 2: Results

Online Survey 2

20. Do you or any members of your household match any of the following descriptions? (Select all that apply.)

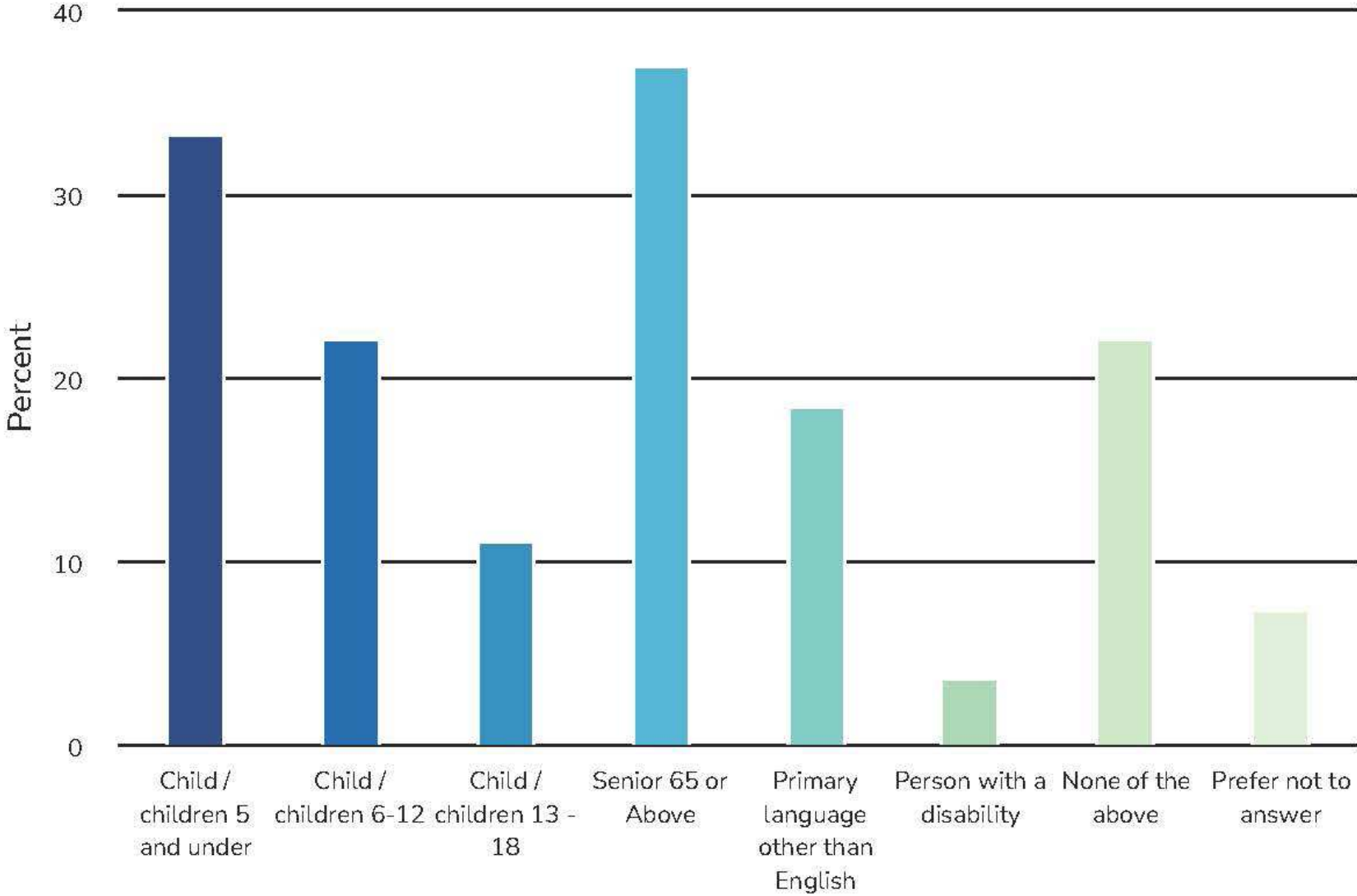

Survey 2: Results

Online Survey 2

20. Do you or any members of your household match any of the following descriptions? (Select all that apply.)

