



# RINGER PARK

## Phase 1 Improvements

### Community Meeting #2



# AGENDA

---

1

**INTRO (PROJECT TEAM, TIMELINE, GOALS)**

---

2

**PROJECT STATUS/RECAP**

---

3

**PRESENTATION OF SCHEMATIC DESIGN**

---

4

**DISCUSSION**

---

5

**NEXT STEPS**

---

# PROJECT TEAM

---

## **B Chatfield**

Project Manager

[abigail.chatfield@boston.gov](mailto:abigail.chatfield@boston.gov) or 617-504-7709

## **Danielle Desilets**

Associate Principal, Kyle Zick Landscape Architecture, Inc.

## **Jae Lee**

Associate, Kyle Zick Landscape Architecture, Inc.

## **Francis Mendoza-McCarthy**

Office of Neighborhood Services

[francis.mendozamccarthy@boston.gov](mailto:francis.mendozamccarthy@boston.gov) or 617-635-2678





# CITY OF BOSTON PRIORITIES

---

- **Expanding walkable access to parks**
- **Addressing equity**
- **Climate resilience**
- **Health**
- **Community building**





# PARK & RECREATION GOALS

---

- **Accessible and available to all**
- **Diverse, balanced, and efficient mix of uses**
- **Meaningful and inclusive community engagement**
- **Adaptive and resilient landscapes**
- **Promote connections**



# PROJECT TIMELINE

---





# Comprehensive Plan: 2020-2021

## Community meetings:

- October 2020
- January 2021
- March 2021





# Phase 1 Improvements

Phase 1 Funded for 2023-2024

\$1,250,000

- Scope includes accessibility improvements, pathways, entrances, tree work, dog park

- 1:** Entrance
- 2:** Pathway
- 3:** Dog park
- 4:** Pathway lighting
- 5:** Erosion mitigation
- 6:** Drainage improvements



# Proposed Entrances & Edges

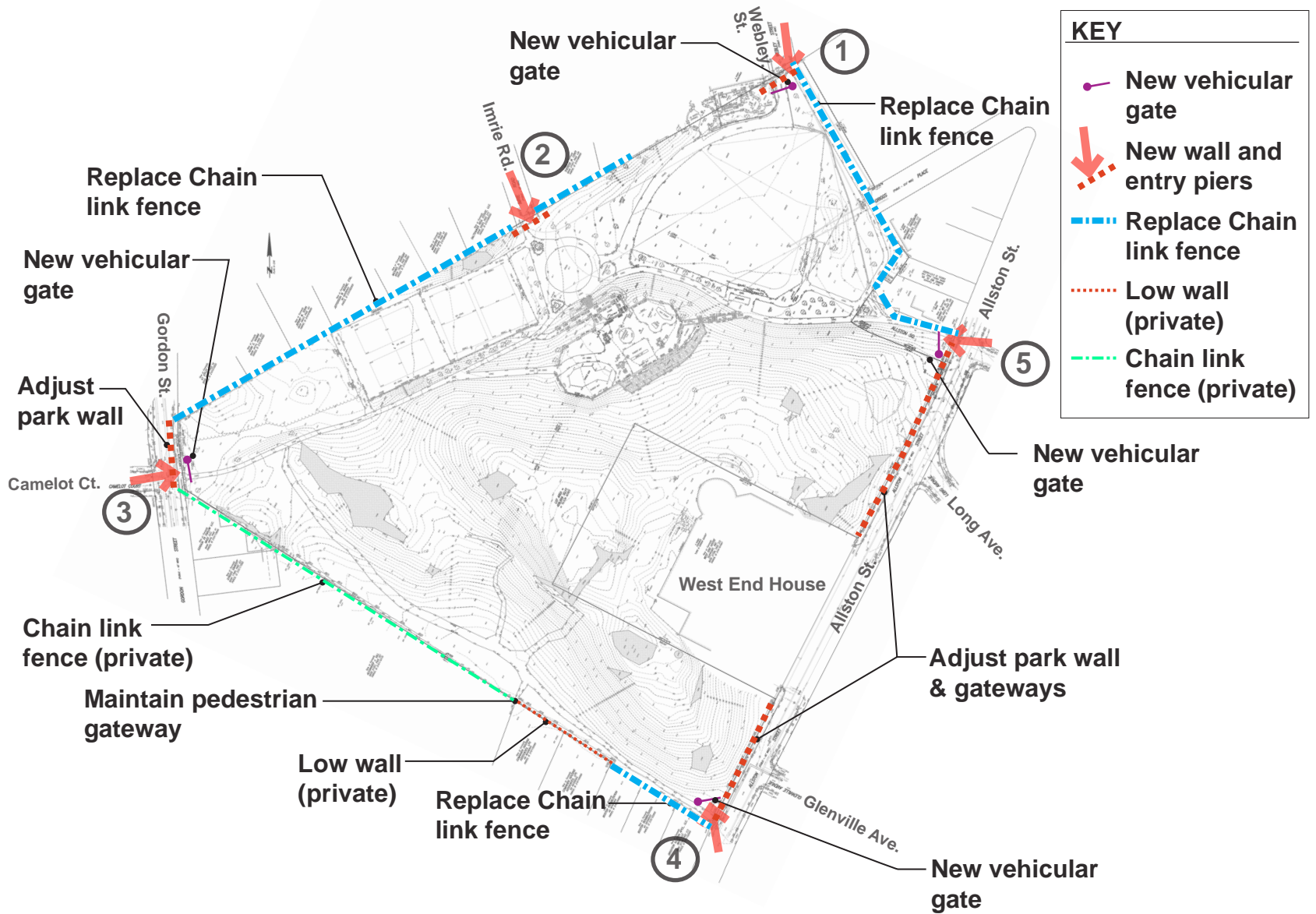



# Entrances

- Add stone piers & wall to define entry
- Add vehicular gate & maintain 4 feet minimum open for accessibility
- Remove existing bollards
- Replace existing concrete sidewalk & curbs
- Widen & harden walkway for accessibility & maintenance access



## 1 Park entrance at Webley Street

SWING GATE

### Swing Gate Bollard

MODEL NUMBER: EHG5-GATE

SIZE: Various Sizes Available

Coat Aluminum Top & Base

Installation Options Available

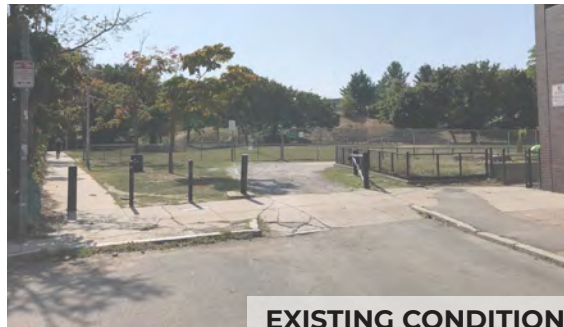

Key Map

# Entrances

- Remove existing bollards
- Replace existing park ID sign with lighted art pylon
- Add stone piers &/ or wall to define pedestrian entry?



## ② Park entrance at Imrie Road

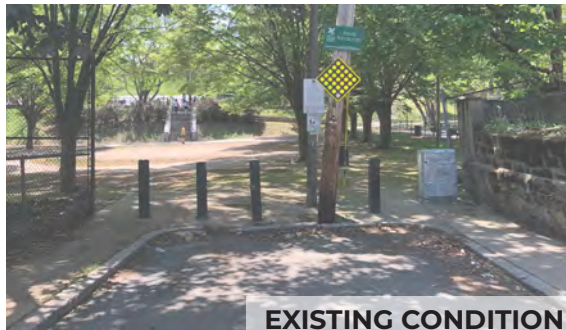



# Entrances

- Add stone piers & wall to define entry
- Add vehicular gate & maintain 4 feet minimum open for accessibility
- Remove existing bollards
- Coordinate with City for new accessible crosswalk
- Establish curb ramp for accessibility
- Relocate walkway for accessibility & maintenance access
- Relocate light fixture to new walkway alignment



## 3 Park entrance at Gordon Street



# Entrances

- Add stone piers & connect to existing wall to define entry
- Add vehicular gate & maintain 4 feet minimum open for accessibility
- Remove existing bollards



## 4 Park entrance at Allston Street near Glenville Street





# Entrances

- Add stone piers & extend wall to define entry
- Add vehicular gate & maintain 4 feet minimum open for accessibility
- Coordinate with City for new accessible crosswalk
- Re-establish curb ramp for accessibility
- Relocate walkway to add screening & ease buffer
- Relocate light fixture to new walkway alignment



## 5 Park entrance at Allston Street near Greylock Road



EXISTING CONDITION



Key Map

# Dog park

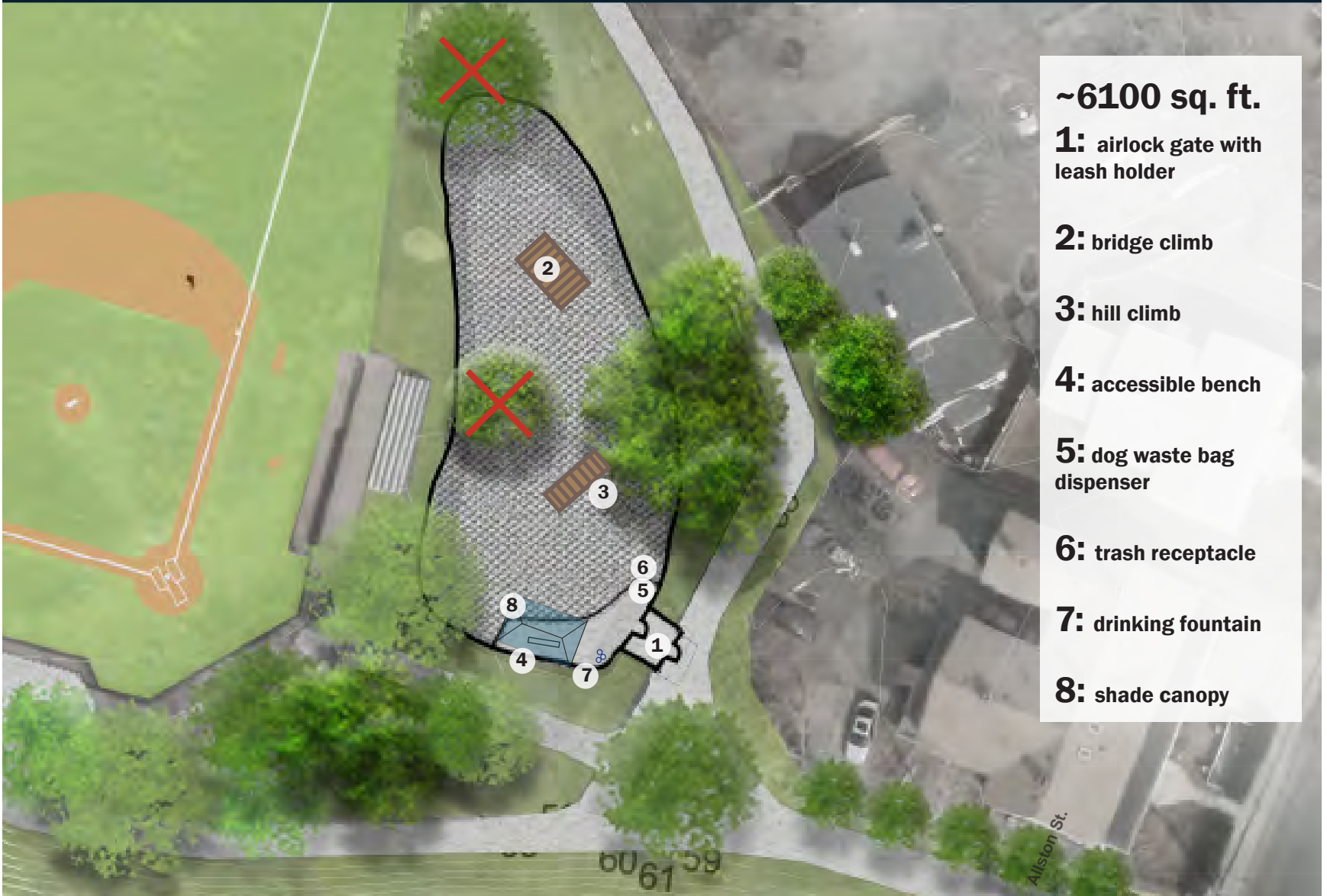

**~6100 sq. ft.**

**1:** airlock gate with leash holder

**2:** bridge climb

**3:** hill climb

**4:** accessible bench

**5:** dog waste bag dispenser

**6:** trash receptacle

**7:** drinking fountain

**8:** shade canopy



# Dog park

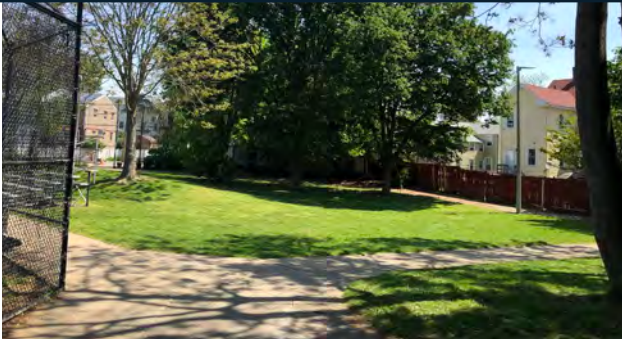

**PROPOSED DOG PARK AREA**



**PETERS PARK DOG PARK, SOUTH BOSTON**



**BRIDGE CLIMB**



**AIRLOCK GATE**



**SHADE CANOPY**



**HILL CLIMB**



**DRINKING FOUNTAIN**



**WASTE BAG DISPENSER**

# Pathways

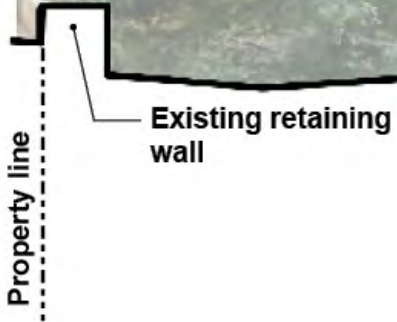

Key Map



# Woodland Path Paving Options

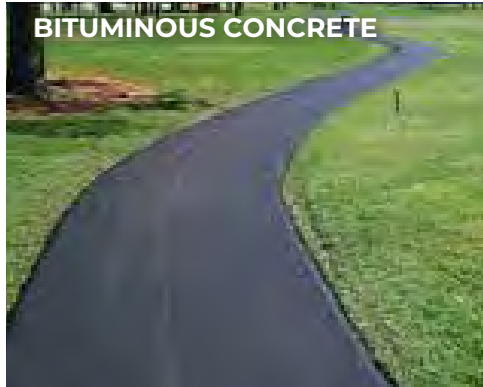

- Can be hot in summer
- Recedes into the landscape
- Accessibility: fully accessible
- Maintenance: minimal
- Suitable for flat surfaces & steeper slopes
- Typically lasts 12-20 years depending on quality of construction & usage
- Cross-section: 12"-16" typical
- Impervious



- Needs to be resurfaced every 7-10 years
- Requires 3" asphalt surface, with liquid hot asphalt sprayed on to adhere 1/4"-3/8" washed crushed stone
- Accessibility: full with maintenance
- Surface look and texture similar to gravel
- Impervious



- Needs re-grading, weeding and topdressing.
- Can be soft in spring thaw.
- Avoid installation on long pitches of 6% or greater
- Accessibility: full with maintenance

# Pathways



Existing retaining wall

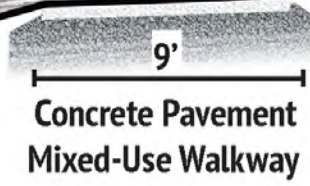

Light fixture



Key Map



# Pathways

3



9'  
**Concrete Pavement  
Mixed-Use Walkway**

Light fixture



Key Map

# Pathways

4



Reset entrance sign

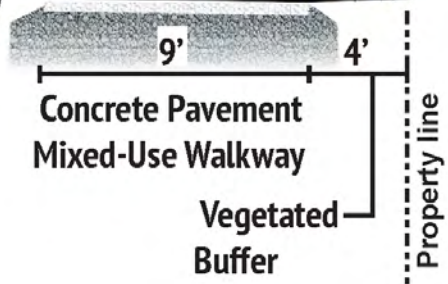

Key Map



# EXISTING SITE CONDITION

---



**MAIN PATHWAY  
FROM ALLSTON ST.**



**MAIN PATHWAY  
TO ALLSTON ST.**



**WOODLAND PATH**

# Lighting

(Proposed conditions plan)





# LIGHTING

---



**LIGHTING FIXTURE AND EMERGENCY TELEPHONE**



**NIGHT VIEW AT PATH APPROACHING PLAYGROUND**

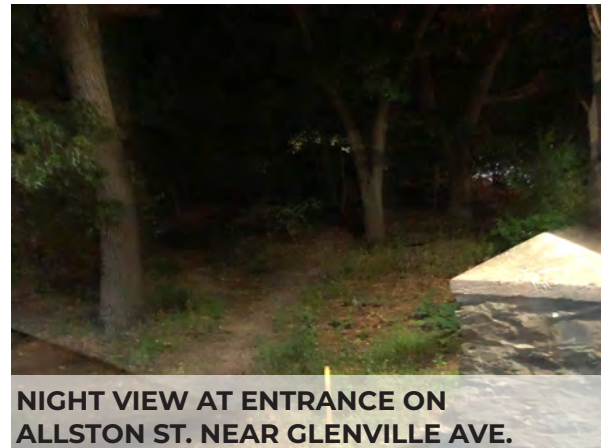

**NIGHT VIEW AT ENTRANCE ON ALLSTON ST. NEAR GLENVILLE AVE.**



# TREE INVENTORY



Prepared By:  
**kzla**  
 4328 Washington Street  
 Boston, MA 02131  
 617-451-1018 Tel  
 www.kzla.com  
 Consultant  
 Project No. CPRXXXXX



No.	Date	Revision

Approved By: \_\_\_\_\_ Date: \_\_\_\_\_

Project Name:  
**Ringer Park Improvements  
 Phase 1**

SPRD Project No.	CPRXXXXX
Date	06/23/2023
Scale	1"=50'-0"
Drawn	YL
Checked	KZ

Sheet Name:  
**Existing Site Plan**

Sheet:  
**EX**

# TREE INVENTORY

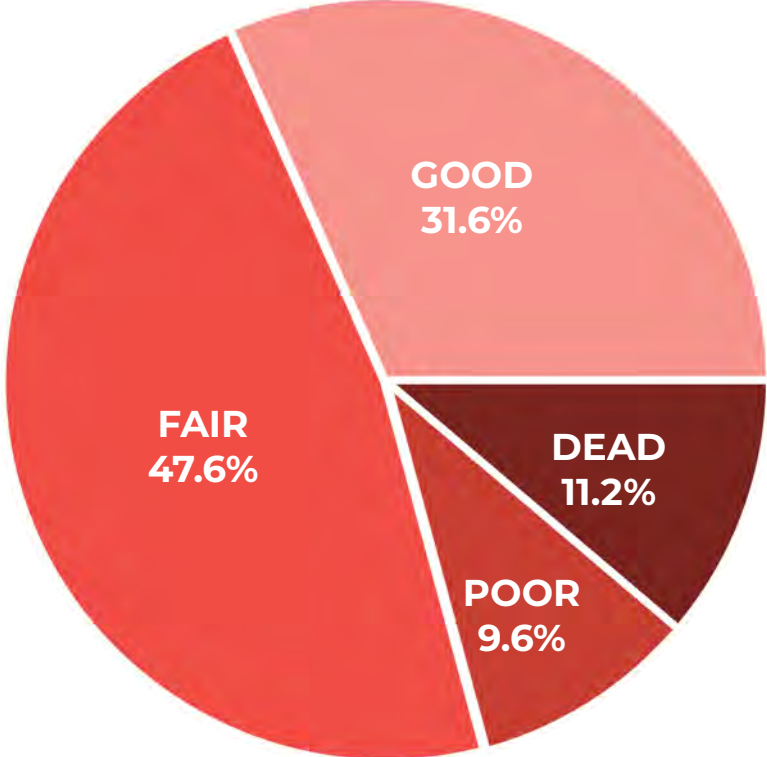

**CONDITION**

**# OF TREES INVENTORIED TO DATE: 250**

## TOP TEN SPECIES

- |     |                   |       |
|-----|-------------------|-------|
| 1.  | BLACK LOCUST      | 32.8% |
| 2.  | NORWAY MAPLE      | 25.6% |
| 3.  | RED OAK           | 10.4% |
| 4.  | BLACK CHERRY      | 7.2%  |
| 5.  | JAPANESE ZELKOVA  | 6.8%  |
| 6.  | HONEY LOCUST      | 2.8%  |
| 7.  | EASTERN RED CEDAR | 1.6%  |
| 8.  | TREE OF HEAVEN    | 1.6%  |
| 9.  | AMERICAN ELM      | 1.6%  |
| 10. | AUSTRIAN PINE     | 1.6%  |



# Fitness circuit

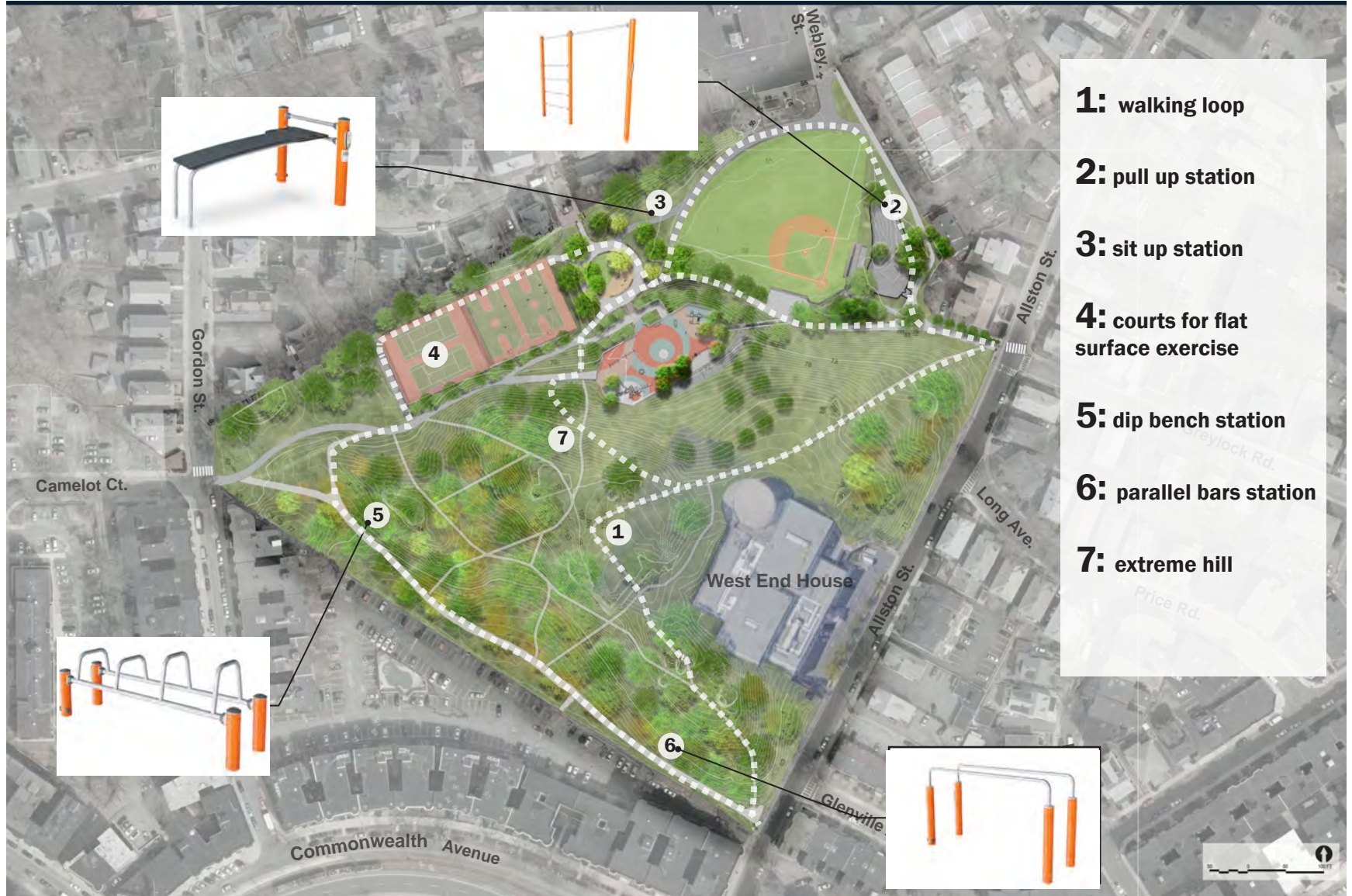

**1:** walking loop

**2:** pull up station

**3:** sit up station

**4:** courts for flat surface exercise

**5:** dip bench station

**6:** parallel bars station

**7:** extreme hill

# PROJECT TIMELINE

---





# LISTENING & DISCUSSION





# NEXT STEPS

---

## PHASE 1 IMPROVEMENTS

---

- Advance design
- Community meeting #3 - November

## VISIT PROJECT WEBSITE

---

### WEB LINK:

*<https://www.boston.gov/departments/parks-and-recreation/ringer-park-improvements>*

Scan me with your  
phone's camera!

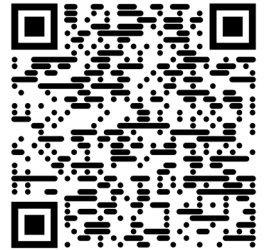

## CONTACT

---

**B Chatfield**, BPRD Project Manager  
abigail.chatfield@boston.gov  
617-504-7709



# THANK YOU!

See the project website for future updates.

For questions, maintenance requests or concerns regarding any of our parks contact 311

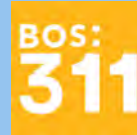

September 19, 2023  
Boston Parks and Recreation

