



FRANKLIN PARK BEAR DENS MEETING #1

Site Inventory,
Analysis and
Safety Improvements



January 4, 2024
Boston Parks and Recreation



Zoom Interpretation Services



English: For interpretation in [____],

1. Go to the horizontal control bar at the bottom of your screen. Click on “Interpretation.”
2. Then click on the language that you would like to hear.
3. You are now accessing this meeting in [_____]

Mandarin: 若需普通话口译服务：

1. 在屏幕下方的长方形控制栏中，请点击“Interpretation.”
2. 请点击您所需收听的语言。
3. 您即可收听普通话的会议口译。

Vietnamese: Cho thông dịch Tiếng Việt

1. Tìm thanh điều khiển ngang phía dưới màn hình của bạn. Bấm vào từ: "Interpretation"
2. Sau đó chọn lựa ngôn ngữ mà bạn cần lắng nghe.
3. Hiện tại bạn đang tham gia buổi họp bằng Tiếng Việt

Cabo Verdean Creole: Gossim bu ta entra na reuniao na kriolu,

1. Bai na barra de controlo horizontal na parte inferior di computador bu kalka na “Interpretation”.
2. Depos kalka na idioma qui bu kre ovi.
3. Agora djabu sta ta entra na reuniaun em creole.

Spanish: Para traducción en Español,

1. Vaya a la parte baja de la pantalla, en la barra horizontal, y presione la tecla “Interpretation”.
2. Luego seleccione el idioma que desea escuchar.
3. Después de seleccionar, usted entrará a la reunión en el idioma “Español”.

Cantonese: 若需粵語口譯服務：

1. 與屏幕下方之長方形控制欄中，煩請點擊“Interpretation.”
2. 煩請點擊您所需收聽的語言。
3. 您即可聽到粵語的會議口譯。

Haitian Creole: Pou entèpretasyon Kreyòl ayisyen,

1. Ale nan kontwòl ba nan pati anba ekran an epi Klike sou "Interpretation"
2. Apre sa, klike sou lang ke ou ta renmen tande a.
3. Kounye a ou gen aksè a reyinyon an Kreyòl ayisyen

1.



2.

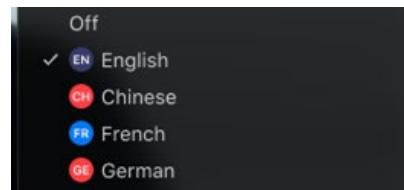

3.





FRANKLIN PARK BEAR DENS MEETING #1

Site Inventory,
Analysis and
Safety Improvements



MEETING RECORDING



Scan me with your phone's camera!



The Boston Parks and Recreation Department will be recording the meeting and posting to our project webpage for those who are unable to attend the Zoom meeting live.

It is possible that participants may also be recording the meeting with their phones cameras or other devices. If you do not wish to be recorded during this meeting, please keep your microphone muted and camera off.

Please share with your neighbors and friends

WEB LINK:

www.boston.gov/bear-dens

VIRTUAL MEETING ETIQUETTE

We want to ensure this conversation is a pleasant experience for all and that all community members/stakeholders are comfortable sharing their comments, questions and feedback.

Please be respectful and mindful of each other's time when asking questions/ providing comments, so that all attendees are able to participate in the meeting.

Keep questions/ comments project-specific and not personal to yield solution-driven discussion.

Please wait until all attendees have had the opportunity to ask a question/ provide a comment before providing additional questions/ comments.

*You can always set up a conversation with **Amy Linne**, amy.linne@boston.gov, to further discuss the project or process.*

ZOOM TIPS

Here is how you can participate during the question and answer part of the presentation.

DURING THE PRESENTATION:



VIA WEB:

Turn video on / off.

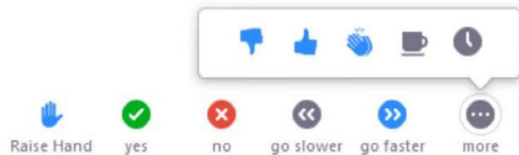

To use these non-verbal options click on participants (bottom of screen); these options will pop up in side bar.

DURING THE Q&A:



JOINING VIA PHONE?

Use *9 to raise hand to ask for audio / video permission to ask questions or provide comments.



VIA WEB:

Chat to ask questions / comments or provide responses to poll questions



Raise hand to ask for audio / video permission to ask questions or provide comments.

AGENDA

1

PROJECT TEAM

2

PROJECT STATUS AND SCOPE OF WORK

3

PRESENTATION OF HISTORY, INVENTORY AND ANALYSIS

4

LISTENING AND DISCUSSION

5

CLOSING REMARKS & NEXT STEPS

Improvements to
Franklin Park Bear Dens
Meeting 1 | Inventory and Analysis

PROJECT TEAM

Amy Linnè

Project Manager

amy.linne@boston.gov or 617-961-3045

Lauren Bryant

Project Manager, Franklin Park Action Plan

lauren.bryant@boston.gov or 617-961-3019

Kwanna Wise

Director of Community Engagement - Environment, Energy & Open Space Cabinet

Kwanna.wise@boston.gov or 617-961-3006

Office of Neighborhood Services

www.boston.gov/ONS or 617-961-3485

-Jamaica Plain: Melissa Beltran

-Roxbury: Asha Janay

-Dorchester: Ross Cochran

-Mid-Dorchester: Ashley Gomes

-Roslindale: Dianna Bronchuk

Kyle Zick

Principal, Kyle Zick Landscape Architecture, Inc.

Mike Doucette

Project Landscape Architect, Kyle Zick Landscape Architecture, Inc.



GROUPS WE ARE COORDINATING WITH

- **Franklin Park Coalition**
- **Emerald Necklace Conservancy**
- **Boston Landmarks Commission**
- **Community**
- **Power Corps**
- **City of Boston Arborists**
- **City of Boston Office of Neighborhood Services**

PROJECT SCHEDULE

BEAR DENS SAFETY IMPROVEMENTS

TOTAL PROJECT BUDGET: \$900,000 (CAPITAL FUNDING)

CONSTRUCTION BUDGET: \$720,000

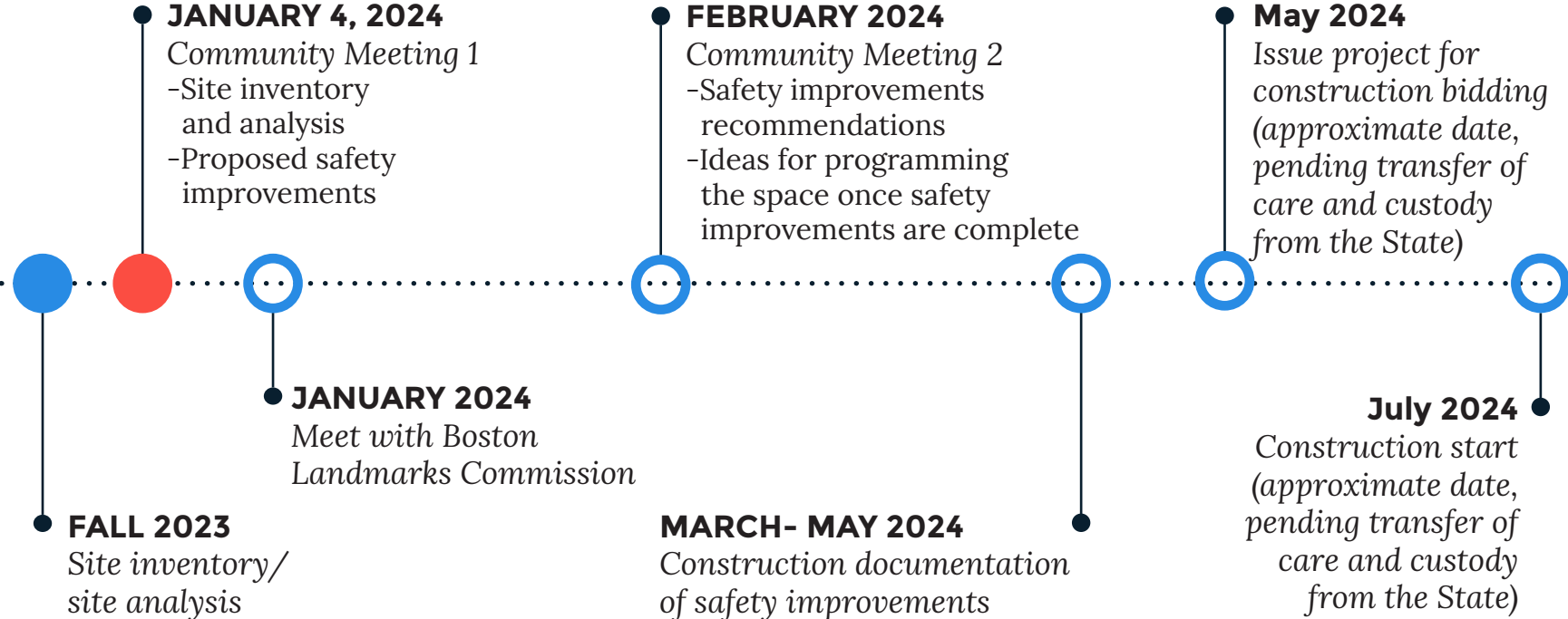

Improvements to
Franklin Park Bear Dens
Meeting 1 | Inventory and Analysis

FRANKLIN PARK TRUST PROJECTS

Year 1 (2023)

Maintenance:

- Invasive vegetation removal and treatment at the Overlook
- Debris removal at Blue Hill Ave/Refectory entrance
- Cobble gutter cleaning
- Drain cleaning

Design work:

- Glen Road pathway repaving
- Overlook stairs resetting and repointing

Programming through Franklin Park Coalition:

- Music in the Park
- Kite Festival
- Nature Tours

Year 2 (2024)

Maintenance:

- Repaving of Glen Road pathway
- Repair of Overlook stairs
- Continued invasive vegetation treatment
- Continued cobble gutter cleaning
- Rehabilitation of picnic area in the Wilderness

Programming through Franklin Park Coalition:

- Music in the Park
- Kite Festival
- Nature Tours

DESIGN TEAM ORGANIZATION CHART

City of Boston
Parks and Recreation

Prime Consultant
Landscape Architect
Kyle Zick Landscape Architecture, Inc.
Kyle Zick, ASLA — Principal-in-Charge
Mike Doucette, RLA — Project Landcape Architect

Structural Engineers
Silman-Structural Engineers
Mike Auren, PE

3D Scanning
ScanSure
Doug Magners

Historic Preservation
Consultant
Building Conservation
Associates
Lisa Howe

Survey
Nitsch Engineering

MEETING GOALS

- **Clarify the scope of this project**
- **Present analysis of the existing conditions of the Bear Dens**
- **Present potential safety improvements**



FRANKLIN PARK BEAR DENS PROJECT SCOPE OF WORK

Analyze existing conditions and make recommendations to improve Bear Dens:

- **Safety (funding will be prioritized for safety issues)**
- **Stabilization of historic features**



FRANKLIN PARK BEAR DENS EXISTING CONDITIONS

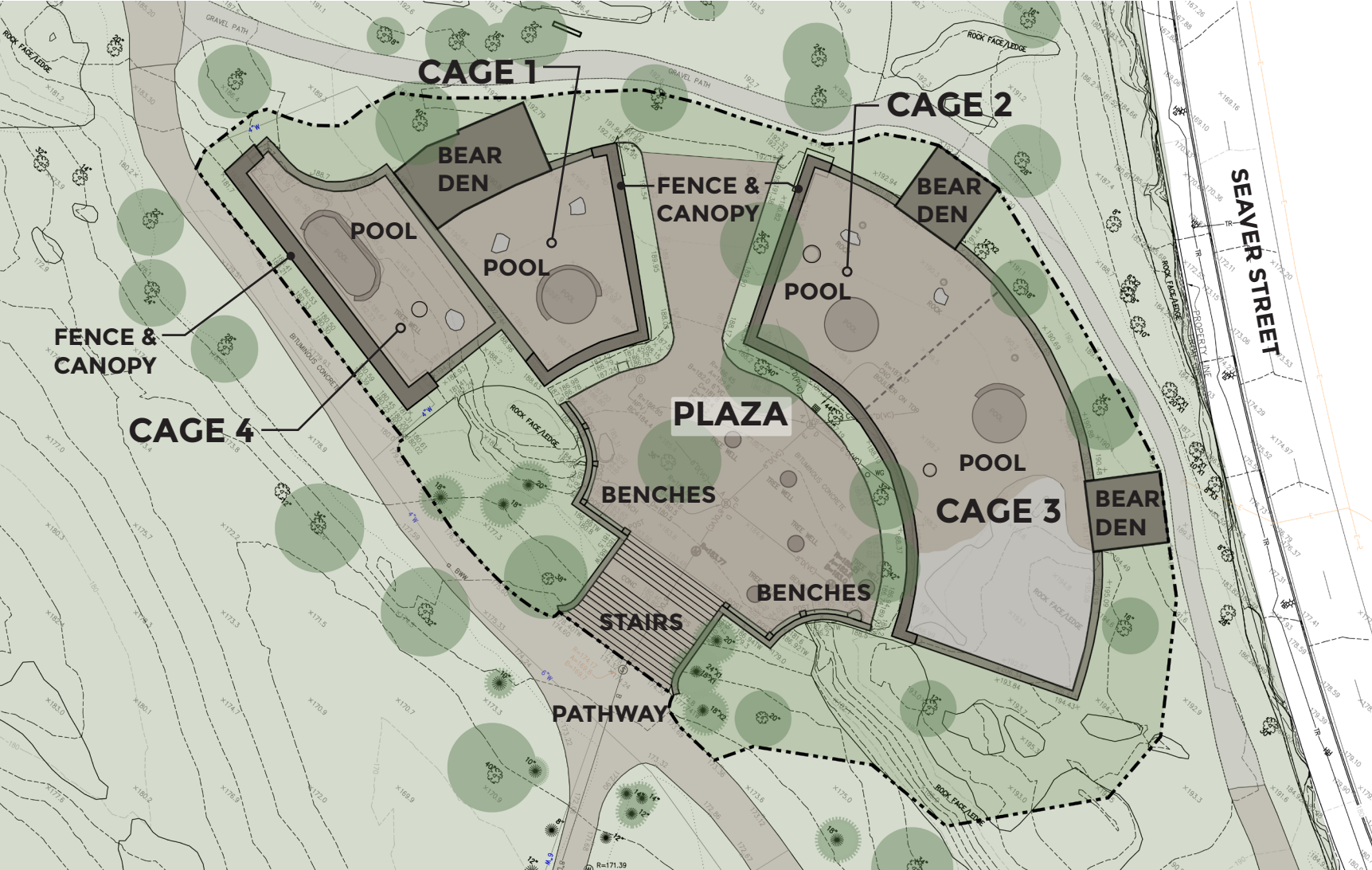

FRANKLIN PARK BEAR DENS SITE OVERVIEW

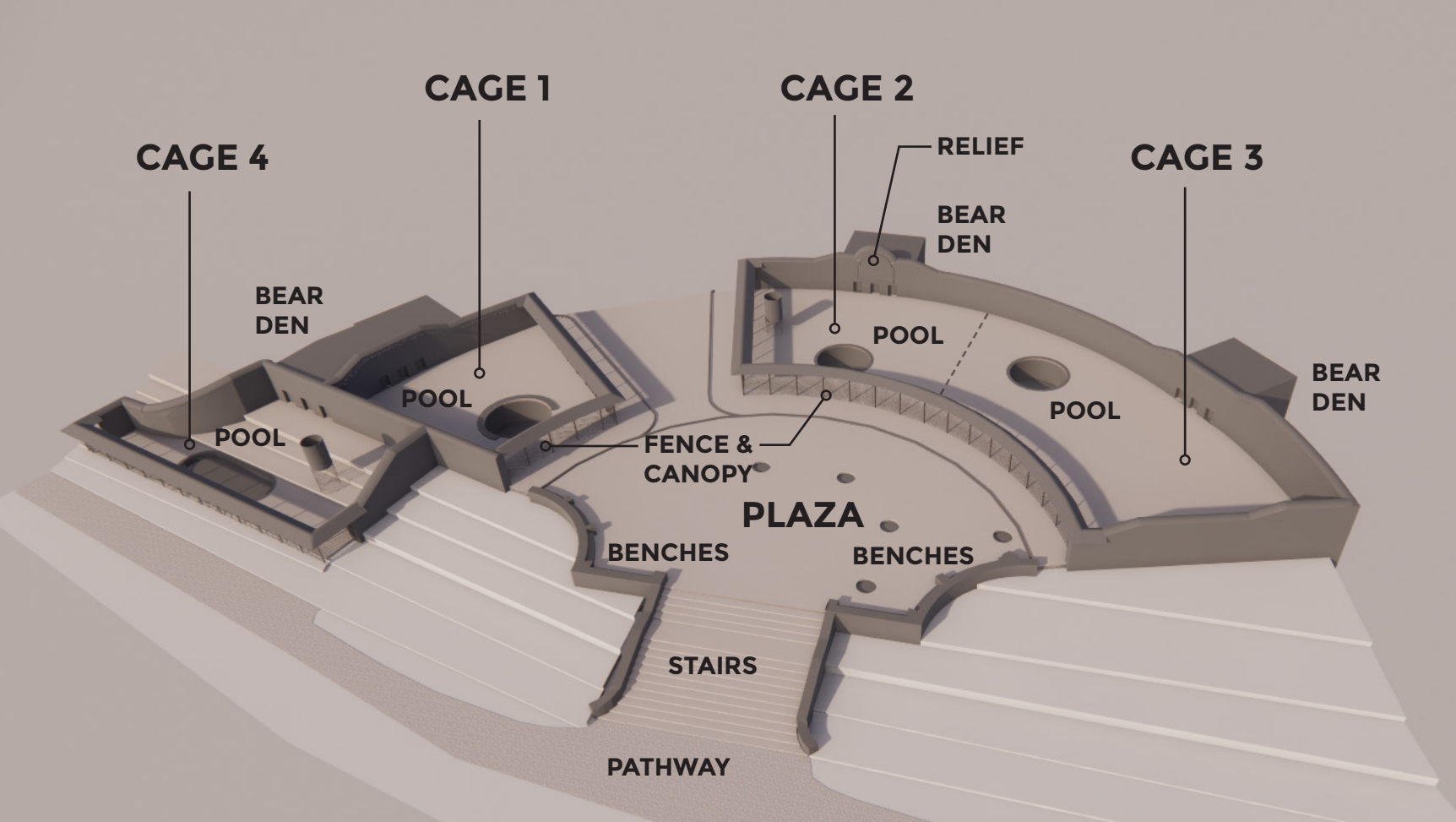

FRANKLIN PARK ZOO ORIGINAL PLAN

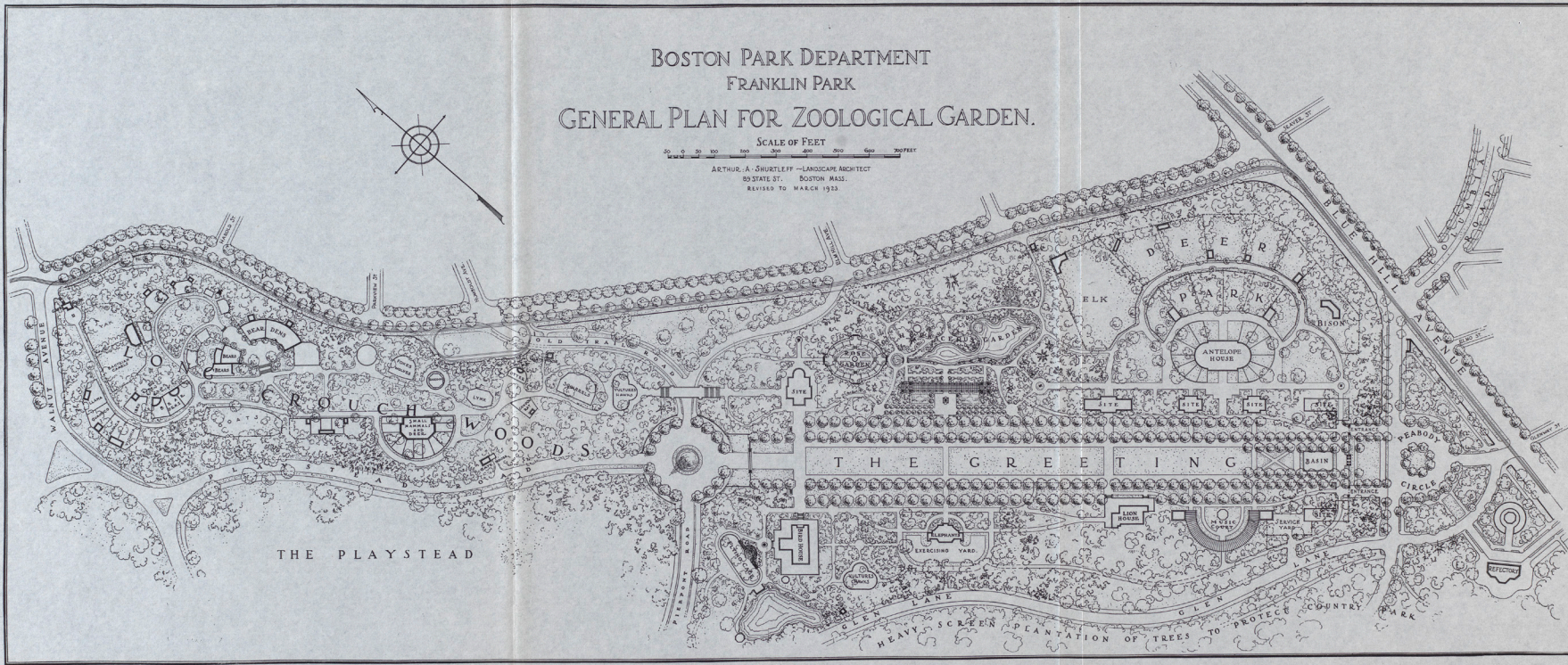

Source: Shurcliff, A., & Boston (Mass.). Department of Parks. ([1925]). Franklin Park general plan for zoological garden [Map]. Retrieved from <https://ark.digitalcommonwealth.org/ark:/50959/vd66zg13x>

FRANKLIN PARK BEAR DENS ORIGINAL PLAN

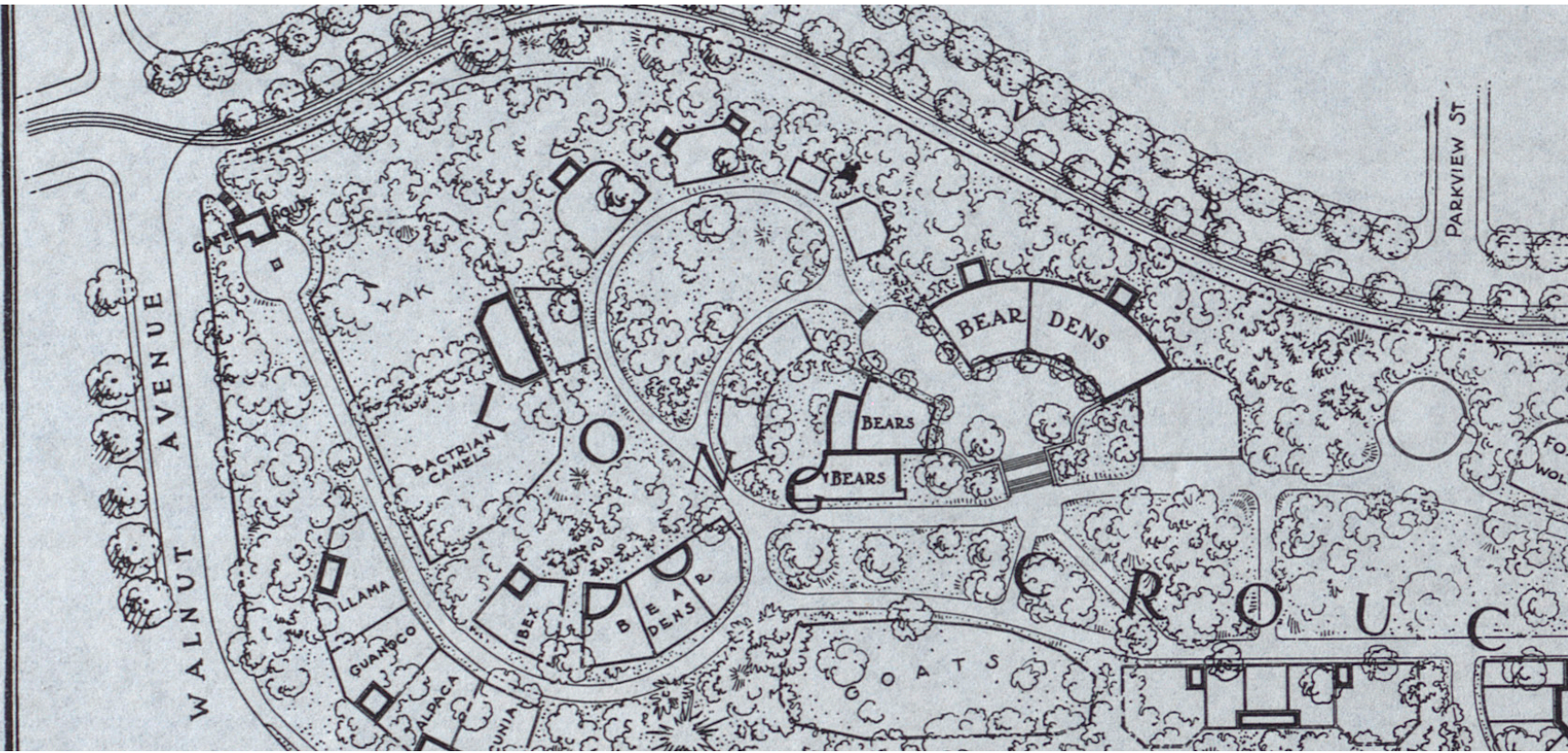

Source: Shurcliff, A., & Boston (Mass.). Department of Parks. ([1925]). Franklin Park general plan for zoological garden [Map]. Retrieved from <https://ark.digitalcommonwealth.org/ark:/50959/vd66zg13x>

FRANKLIN PARK BEAR DENS 1912 PLAN

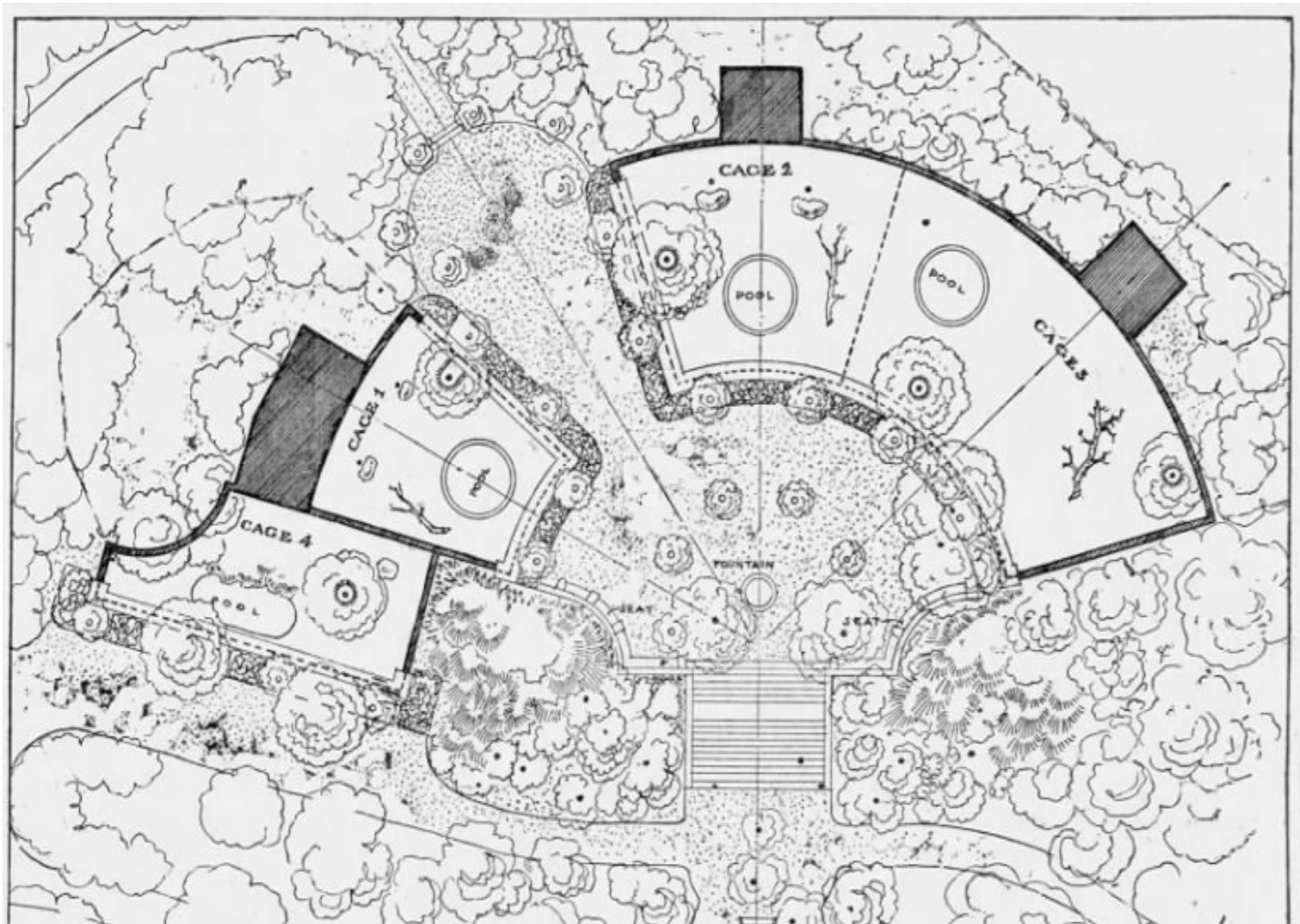

Source: "A plan for the bear cages published in the Boston Evening Standard in October 1912 ahead of their opening" - Boston.com

FRANKLIN PARK BEAR DENS FENCE & CANOPY DETAILS

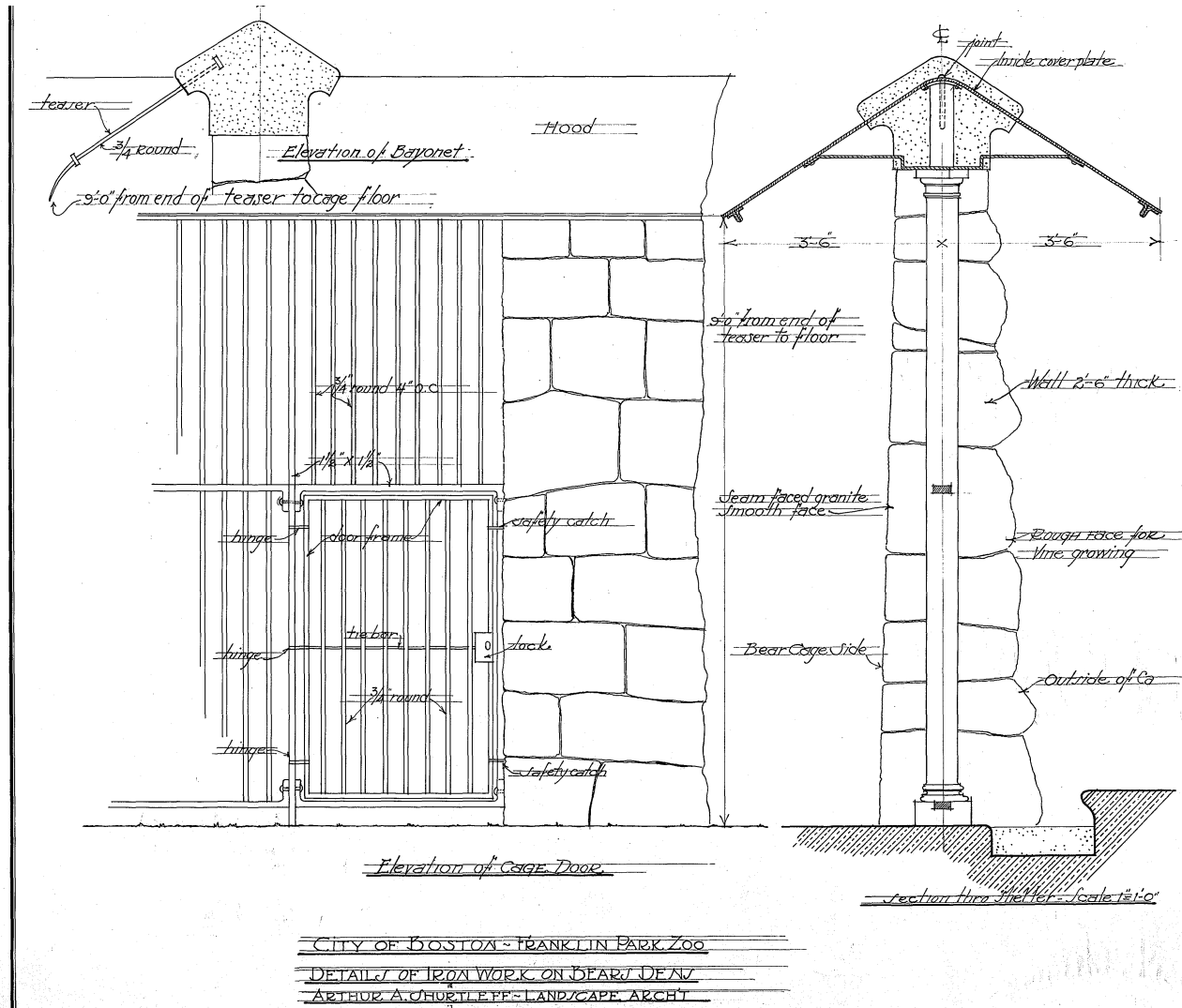

Source: City Of Boston Archives, Details of iron work on Bear Dens, Arthur Shurtleff, drawing #12

FRANKLIN PARK BEAR DENS HISTORY

Bears at Zoological Gardens, Franklin Park, Boston, Mass.



Source:<https://www.cardcow.com/504905/brown-bears-zoological-garden-franklin-park-boston-massachusetts/>

FRANKLIN PARK BEAR DENS HISTORY



Source: Jones, L. (1922). Franklin Park Zoo: brown bears and cubs [Photograph]. Retrieved from <https://ark.digitalcommonwealth.org/ark:/50959/6682xn88f>

FRANKLIN PARK BEAR DENS HISTORY



Source: Jones, L. ([ca. 1917-1934]). Brown bears, Minka & her cubs Rose & Grace, Franklin Park Zoo [Photograph]. Retrieved from <https://ark.digitalcommonwealth.org/ark:/50959/6682xs225>

Bear cages, Franklin Park, west side, Boston, Mass., undated [Photograph]. (n.d.). Retrieved from <http://gusn.us/197357>

Jones, L. ([ca. 1918-1920]). Polar bears at Franklin Park Zoo [Photograph]. Retrieved from <https://ark.digitalcommonwealth.org/ark:/50959/5h73tt704>

FRANKLIN PARK BEAR DENS BEAR TYPOLOGY

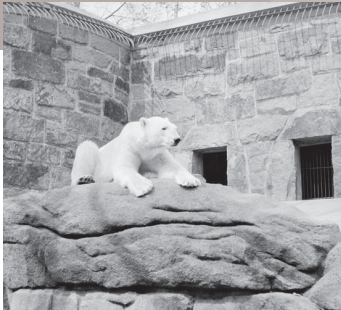
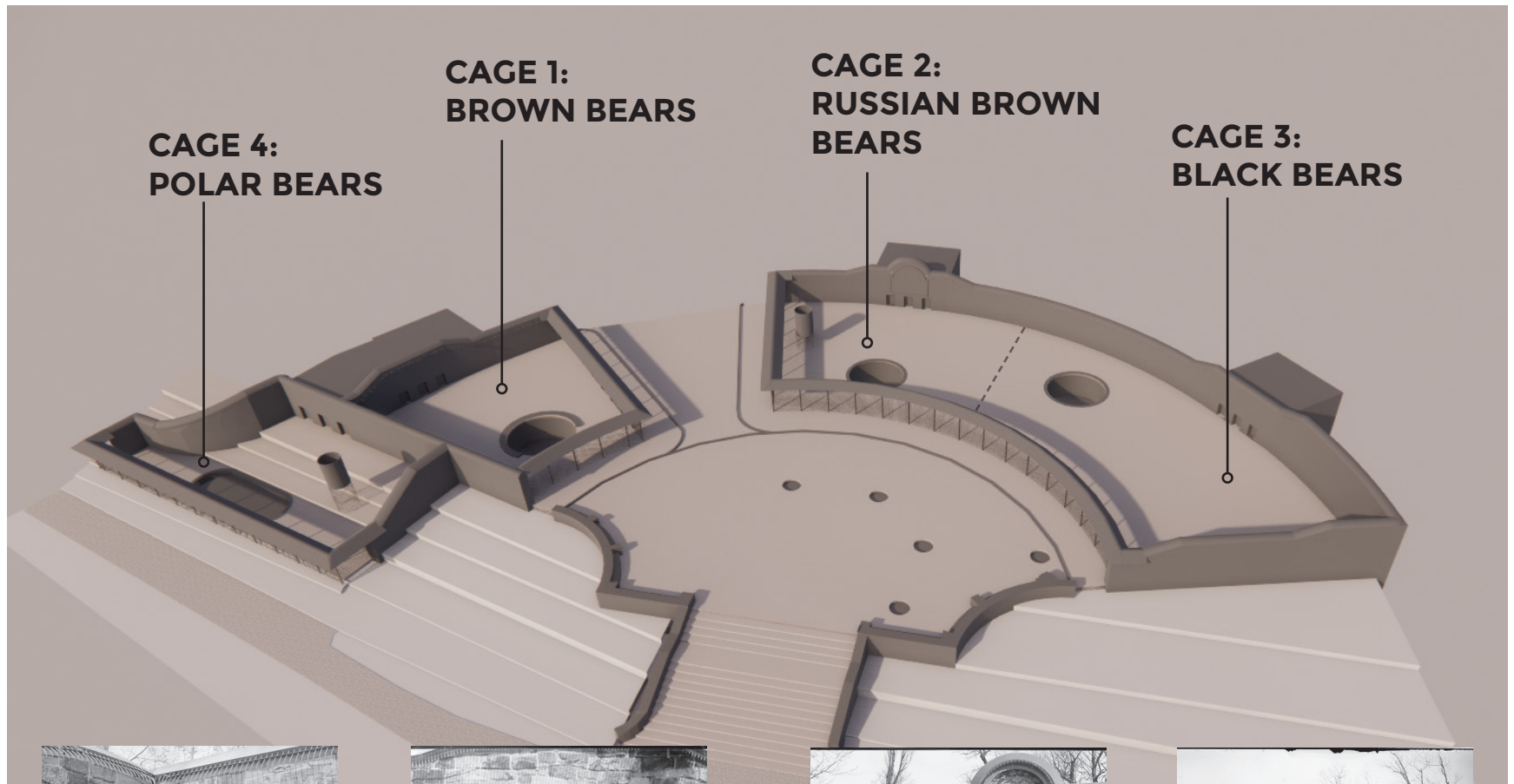

FRANKLIN PARK ACTION PLAN, 2022

Reimagine the Bear Dens Design for Flexible Use

As part of the original set of zoological displays from 1912, the Bear Dens served as the anchoring attraction in Long Crouch Woods. Due to increasing expenses, the display was closed in the mid-1950s when the zoo was migrated to its existing location, and the dens were left to deteriorate in the woods. Stabilizing this important park feature presents a prime opportunity for imaginative new uses that respect the historic fabric, while integrating elements of fun and play, with flexibility for gathering and smaller programs to serve the Roxbury side of the park.

BEAR DENS STRATEGIES

Restore the Dens & Integrate New Use

- Stabilize and restore the character defining features of the Bear Dens, including the metal work and overhang, masonry walls, steps, and benches, the relief sculpture, and the attached buildings.
- Integrate new program within the framework of the dens with flexible use in mind.
- Inspired by the historic bear pools, introduce shallow splash pads, designed to allow the space to function both for water play and for flexible events when turned off.
- Provide temporary furnishings throughout.
- Extend the woodland canopy cover with new trees.
- Install festive catenary lighting for evening events.



Park goers use stabilized ruins as flexible space for a variety of programming today, like yoga in the Schoolmaster Hill Shelter. Restoring the Bear Dens would provide a similar space on the east side of the park, which does not exist today.

BEAR DENS OPPORTUNITIES



2 Metal Overhang/Awning



3 Bear Relief Sculpture, Metalwork, & Stone Wall



4 Stone walls & built-in benches with cages behind



5 Flexible programming with canopy & lighting.



6 Splash pad & water play in rock outcrops for children at a range of ages.



7

RESTORE THE RUINS, INSERT NEW PROGRAM

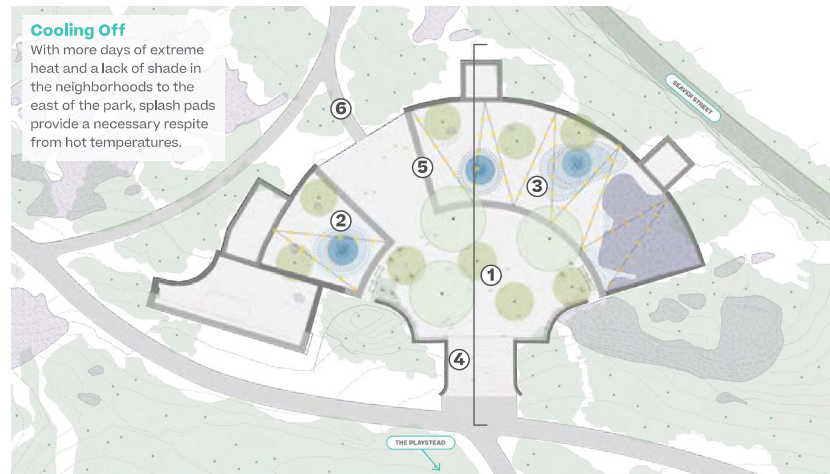

The Bear Dens Proposed Program

- Tree Canopy Cover
- Rock Outcrops
- Pedestrian Paths
- Walls
- Section Cut Line
- Proposed Canopy Tree
- Existing Canopy Tree
- Proposed Catenary Lights
- 1 Central Grove with Next Generation Canopy Tree Planting
- 2 Little Kids Splash Pad
- 3 Big Kids Splash Pad
- 4 Restored Steps, Walls, & Built-in Benches
- 5 Restored Historic Metal Overhang
- 6 Accessible Point of Entry



Source: Boston Parks and Recreation,
<https://www.boston.gov/departments/parks-and-recreation/franklin-park-action-plan>

FRANKLIN PARK BEAR DENS - SITE INVENTORY

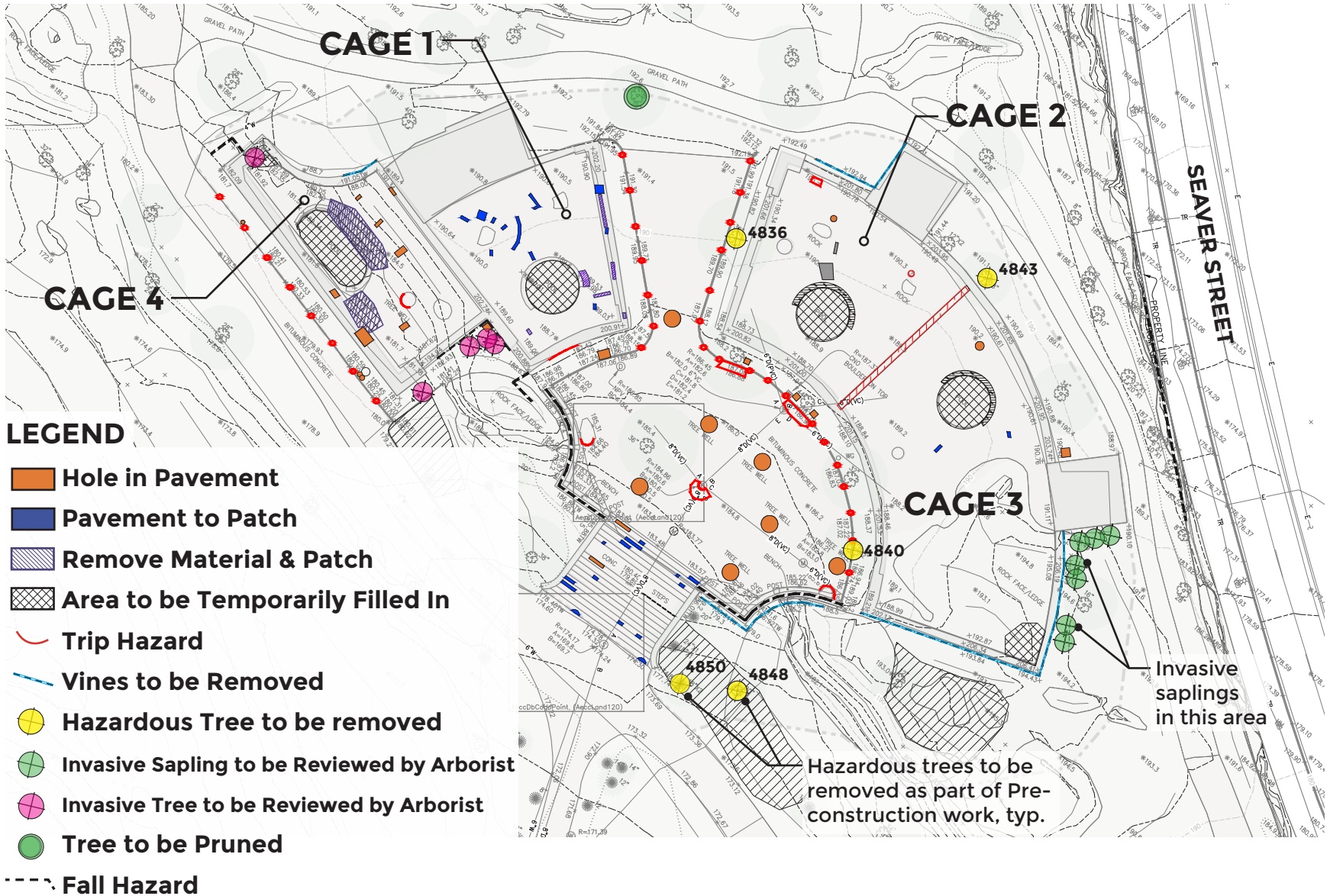

OVERALL SAFETY ISSUES



Several tripping hazards



Existing pool areas



Failing steel fence & canopy



Areas of failing concrete; sink holes

OVERALL STABILIZATION ISSUES



CAGE 1 OVERALL ISSUES



- Limited access in and out of cage
- Pool, fall hazard
- Fence canopy deterioration
- Trip hazards
- Missing fence panel
- Graffiti

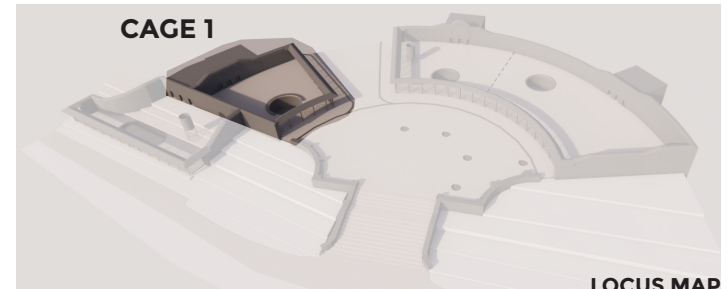

CAGE 1 SPECIFIC ISSUES AND RECOMMENDATIONS

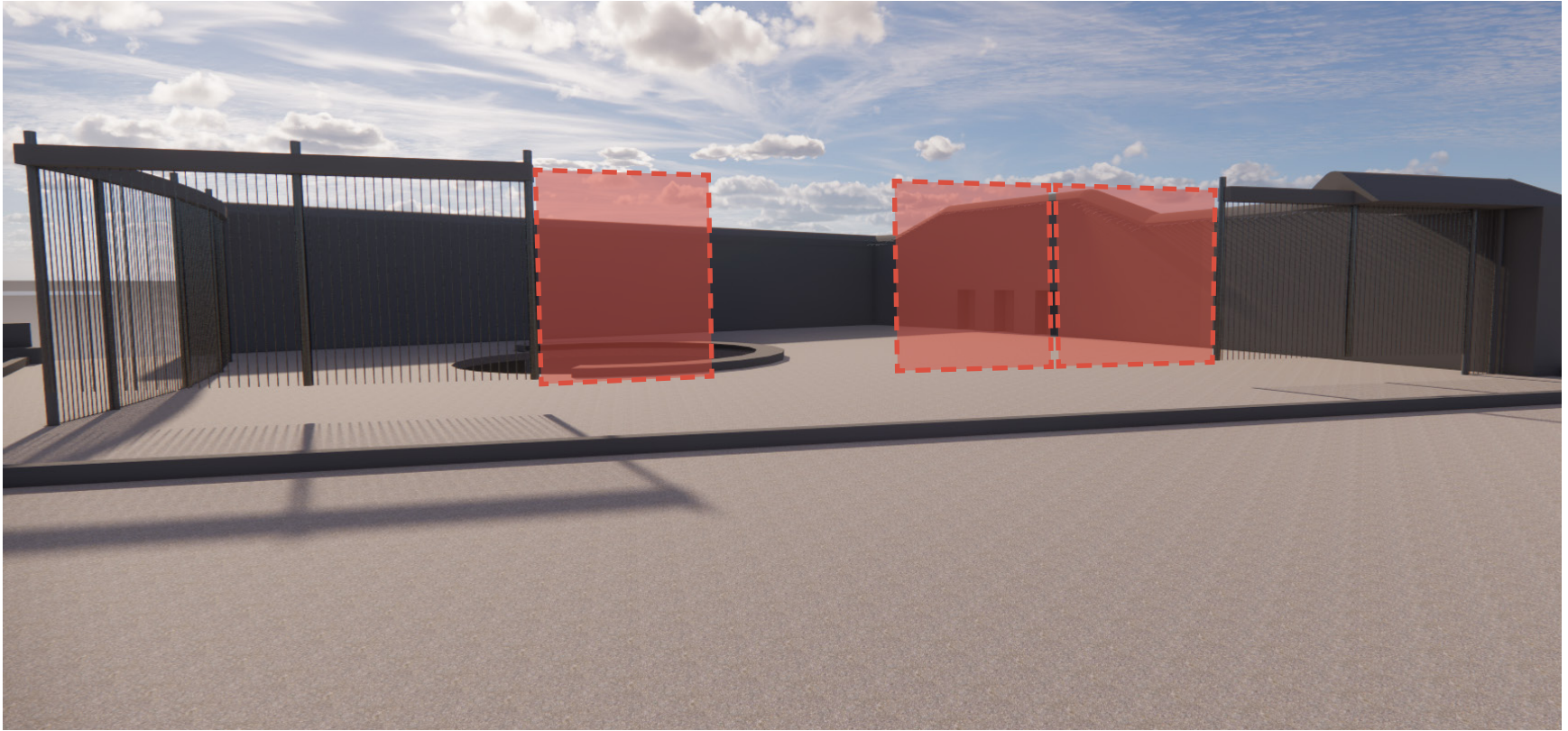

- **Limited access in and out of cage-**
Recommendation: Remove 1 panel to the left and 2 panels to the right of the missing panel.

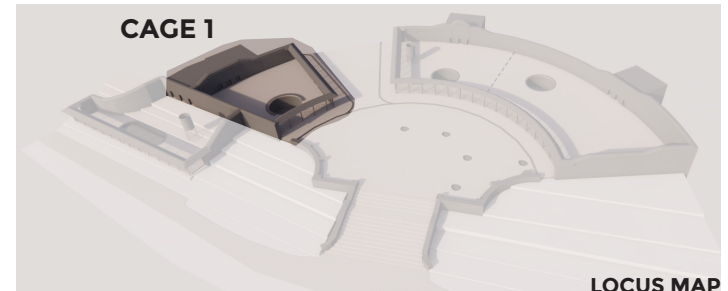

CAGE 1 SPECIFIC ISSUES AND RECOMMENDATIONS

CAGE 1

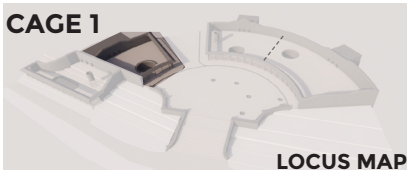

Curb deterioration - exposed rebar, trip hazard

Recommendation: Cut deteriorated curb section and exposed rebar out

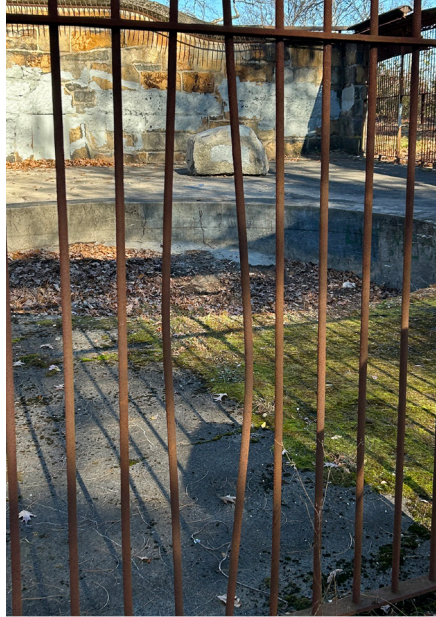

Bent cage pickets create a hazard

Recommendation: Repair or replace bent pickets



Trip hazard, cracking in concrete pavement

Recommendation: Clean out debris and patch concrete as needed

Pool - fall hazard



Recommendation:

Option 1: Remove sediment and debris and fill pool with gravel

Option 2: Install pressure treated deck

- **Cracking in concrete pavement** - *Recommendation: Patch concrete as needed*
- **Some cracking has organic material build up** - *Recommendation: Clean out debris and patch concrete as needed*
- **Graffiti** - *Recommendation: Remove paint covering graffiti and apply anti-graffiti coating*
- **Remnant fence post bases along perimeter, trip hazard** - *Recommendation: Remove curb and area with concrete to match existing grades*
- **Abandoned utility vault, outside of cage, fall hazard** - *Recommendation: Fill vault with gravel*

CAGE 2 OVERALL ISSUES



- **Tree cage instability**
- **Multiple sink holes/failing pavement**
- **Curb dividing cages, trip hazard**
- **Failing fence canopy**
- **Pool, fall hazard**
- **Remnant fence post bases along perimeter, trip hazard**
- **Graffiti**

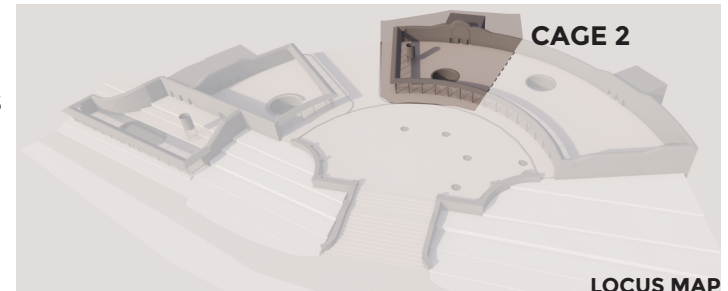

CAGE 2 SPECIFIC ISSUES AND RECOMMENDATIONS

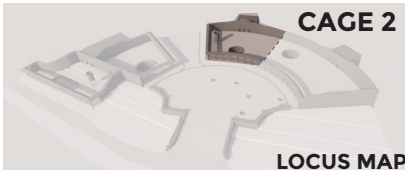

Tree cage instability
Recommendation: Secure structure and close open access panel



Curb dividing cages, trip hazard

Recommendation: Remove curb and area with concrete to match existing grades

Existing utility access, deterioration, trip hazard



Recommendation: Remove structure and patch with concrete

Concrete pavement void, trip hazard



Recommendation: Patch concrete as needed

Pool - fall hazard



Recommendation:

- Option 1: Remove sediment and debris and fill pool with gravel*
- Option 2: Install pressure treated deck*

- **Multiple sink holes/failing pavement** - *Recommendation: Patch concrete as needed*
- **Failing fence canopy** - *Recommendation: Remove compromised sections of canopy*

- **Remnant fence post bases along perimeter, trip hazard** - *Recommendation: Remove curb and area with concrete to match existing grades*
- **Graffiti** - *Recommendation: Remove paint covering graffiti and apply anti-graffiti coating*

CAGE 3 OVERALL ISSUES



- **Failing fence canopy**
- **Fence instability**
- **Deteriorating wall cap**
- **Leaning retaining wall**
- **Pool, fall hazard**
- **Remnant fence post bases along perimeter, trip hazard**
- **Curb dividing cage, trip hazard**
- **Graffiti**

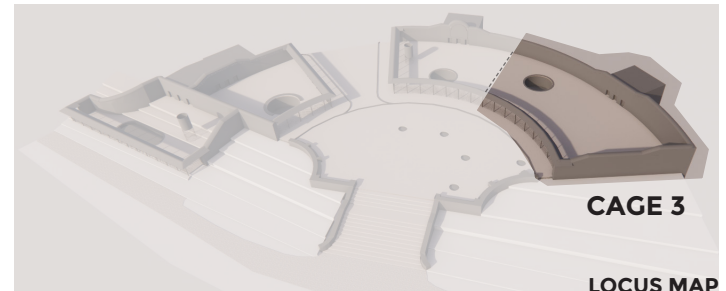

CAGE 3 SPECIFIC ISSUES AND RECOMMENDATIONS

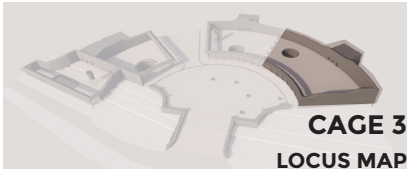

Exposed catch basin/ drain, fall hazard (rear)

Recommendation: Clean out and fill catch basin with gravel

Failing fence canopy - *Recommendation: Remove compromised sections of canopy*

Deteriorating wall cap - *Recommendation: Patch areas of deterioration with concrete to alleviate water intrusion*

Curb dividing cage, trip hazard - *Recommendation: Remove curb and area with concrete to match existing grades*



Fence panel instability

Recommendation: Remove compromised fence panel

Pool - fall hazard



Recommendation:

Option 1: Remove sediment and debris and fill pool with gravel

Option 2: Install pressure treated deck



Trip hazard, cracking in concrete pavement

Recommendation: Patch concrete as needed

Remnant fence post bases along perimeter, trip hazard - *Recommendation: Grind fence post base to be flush with curbing*

Graffiti - *Recommendation: Remove paint covering graffiti and apply anti-graffiti coating*

Leaning retaining wall - *Recommendation: Monitor lean to determine if condition worsens*

CAGE 4 OVERALL ISSUES



- Extensive safety issues
- Only cage with a semi-intact canopy
- Steep grade change
- High number of fall and tripping hazards within this cage

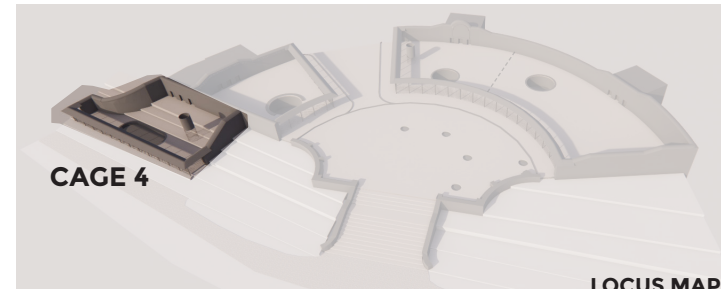

LOCUS MAP

CAGE 4 SPECIFIC ISSUES



Tree cage instability



Pool - fall hazard, organic matter build up



Steep grades, multiple layer of curbing and voids in pavement, trip hazards



Retaining wall, fall hazard



Concrete pavement void, trip hazard



Settling curbing, trip hazard

- **Failing fence canopy**
- **Retaining wall settling**
- **Fire damage**
- **Concrete pavement failing in multiple areas**

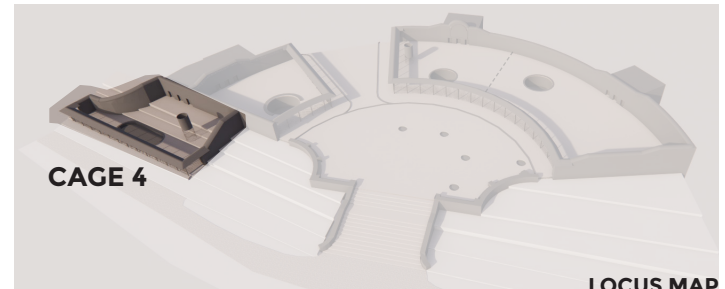

CAGE 4 RECOMMENDATIONS



- *Recommendation: Install missing cage fence panel and access panel to prohibit any access to the cage*
- *Recommendation: Repair deteriorating canopy structure*

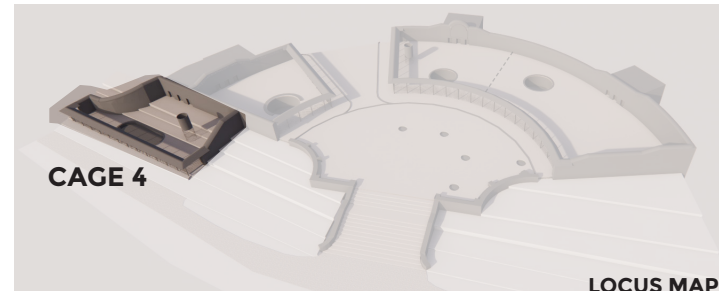

OVERALL PLAZA AND STAIR ISSUES

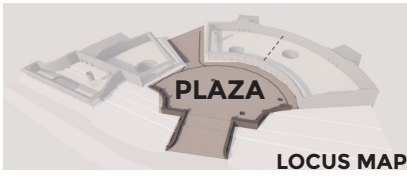

- **Granite bench pieces have fallen, creating fall hazards** - *Recommendation: Replace fallen stones*
- **Multiple empty tree pits, trip hazards** - *Recommendation: Fill tree pits with asphalt*
- **Poor condition trees. (Some trees are being removed this month.)** - *Recommendation: Remove hazardous plant material and vegetation that impacts existing walls*
- **Concrete stairs have voids, sub base eroded** - *Recommendation: Patch with concrete*
- **Fence post bases along perimeter, trip hazard** - *Recommendation: Grind fence post base to be flush with curbing*
- **Fence growing into tree** - *Monitor for tree future tree decline*
- **Graffiti** - *Recommendation: Remove paint covering graffiti and apply anti-graffiti coating*

VEGETATION ISSUES AND RECOMMENDATIONS



• *Recommendation: Remove hazardous trees and vegetation that impacts existing walls*



- **Trees with deferred maintenance**
- **Areas of invasive plant material**
- **Vines growing on fence panels and exterior walls (Seaver Street side)**
- **Tree roots potentially interfering with wall footing**

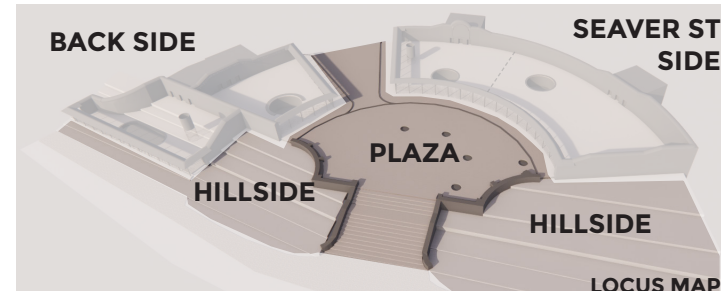

PRE-CONSTRUCTION VEGETATION AND REMOVALS



Tree 4836



Tree 4840



Tree 4848



Tree 4843



Tree 4850

- (5) Hazardous trees to be removed as part of Pre-construction work

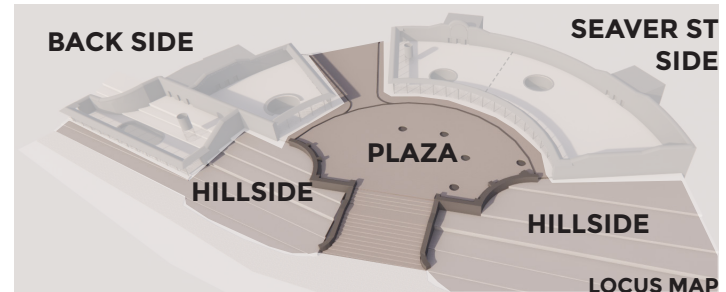

ADDITIONAL ISSUES AND RECOMMENDATIONS



- **Ledge is slippery, creating a potential fall hazard**
Recommendation: Restrict access

A blurred photograph of a public meeting or community discussion. The scene is set in a room with a projector screen at the front. A person is standing near the screen, likely presenting. The audience is seated in rows of chairs, facing the front of the room. The overall image has a blue tint.

LISTENING & DISCUSSION

Help us build great parks.
Let us know what matters to you.

NEXT STEPS

NEXT STEPS

DEVELOP COST ESTIMATES
BOSTON LANDMARKS COMMISSION REVIEW

NEXT PUBLIC MEETING

FEBRUARY, 2024 (Date to be finalized)

VISIT PROJECT WEBSITE

WEB LINK:

www.boston.gov/bear-dens

Scan me with your
phone's camera!



Improvements to
Franklin Park Bear Dens
Meeting 1 | Inventory and Analysis



THANK YOU!

See the project website for future updates.

BOS:
311

For questions, maintenance requests or concerns regarding any of our parks contact 311



January 4, 2023
Boston Parks and Recreation

