

Improvements to **HARDIMAN PLAYGROUND**



February 8, 2024
Boston Parks and Recreation



MEETING RECORDING



The Boston Parks and Recreation Department will be recording the meeting and posting to our project webpage for those who are unable to attend the Zoom meeting live.

It is possible that participants may also be recording the meeting with their phones cameras or other devices. If you do not wish to be recorded during this meeting, please keep your microphone off.



VIRTUAL MEETING ETIQUETTE

We want to ensure this conversation is a pleasant experience for all and that all community members/ stakeholders are comfortable sharing their comments, questions and feedback.

Please be respectful and mindful of each other's time when asking questions/ providing comments, so that all attendees are able to participate in the meeting.

Keep questions/ comments project-specific and not personal to yield solution-driven discussion.

Please wait until all attendees have had the opportunity to ask a question/ provide a comment before providing additional questions/ comments.

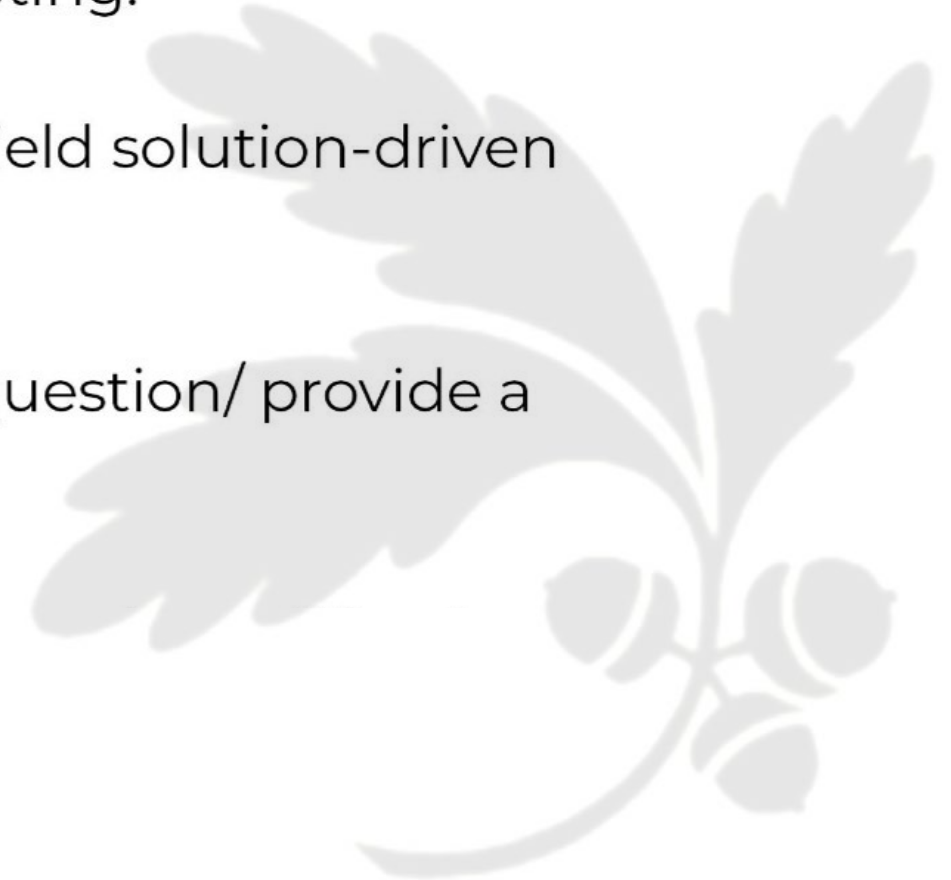

ZOOM TIPS

Here is how you can participate during the question and answer part of the presentation.

DURING THE PRESENTATION:



VIA WEB:

Turn video on / off.

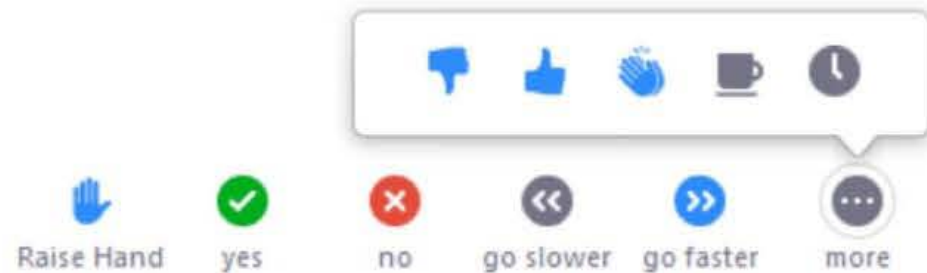

DURING THE Q&A:



JOINING VIA PHONE?

Use *9 to raise hand to ask for audio / video permission to ask questions or provide comments.



VIA WEB:

Chat to ask questions / comments or provide responses to poll questions

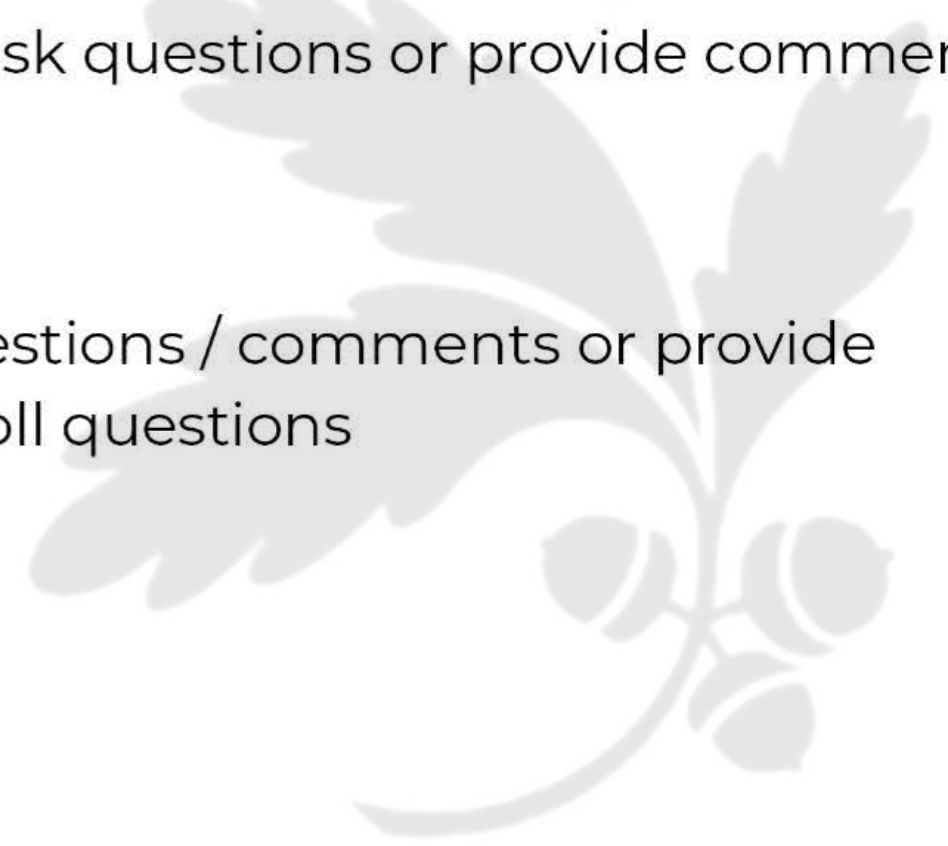

AGENDA

- 1 **PROJECT TEAM INTRODUCTION**
- 2 **PROJECT OVERVIEW**
- 3 **MEETING 1 AND 2 REVIEW**
- 4 **CONCEPTUAL DESIGN PRESENTATION**
- 5 **LISTENING & DISCUSSION**
- 6 **CLOSING REMARKS & NEXT STEPS**



PROJECT TEAM

LAUREN BRYANT

PROJECT MANAGER, BOSTON PARKS AND RECREATION DEPARTMENT
617-961-3019 or Lauren.Bryant@boston.gov

THAMMY PIERRE-LOUIS

OUTREACH COORDINATOR, BOSTON PARKS AND RECREATION DEPARTMENT
Thamara.pierrelouis@boston.gov

FRANK MENDOZA

ALLSTON-BRIGHTON LIAISON, OFFICE OF NEIGHBORHOOD SERVICES
francis.mendozamccarthy@boston.gov

DAVID WARNER

PRESIDENT/PRINCIPAL-IN-CHARGE, WARNER LARSON LANDSCAPE ARCHITECTS

SAMEER BHOITE

DESIGN DIRECTOR, WARNER LARSON LANDSCAPE ARCHITECTS

AMY ALLEN

PROJECT MANAGER, WARNER LARSON LANDSCAPE ARCHITECTS

YUXIAO LIAO

LANDSCAPE DESIGNER, WARNER LARSON LANDSCAPE ARCHITECTS



PROJECT OVERVIEW



MEMORIALIZATION

Kevin Barry Hardiman

Private First Class
1ST PLT, F CO, 2ND BN, 3RD MARINES, 3RD MARDIV, III MAF
United States Marine Corps

[New Bedford, Massachusetts](#)

August 20, 1949 to December 29, 1967

[KEVIN B HARDIMAN](#) is on the Wall at [Panel 32E, Line 93](#)

See the [full profile](#) or [name rubbing](#) for Kevin Hardiman

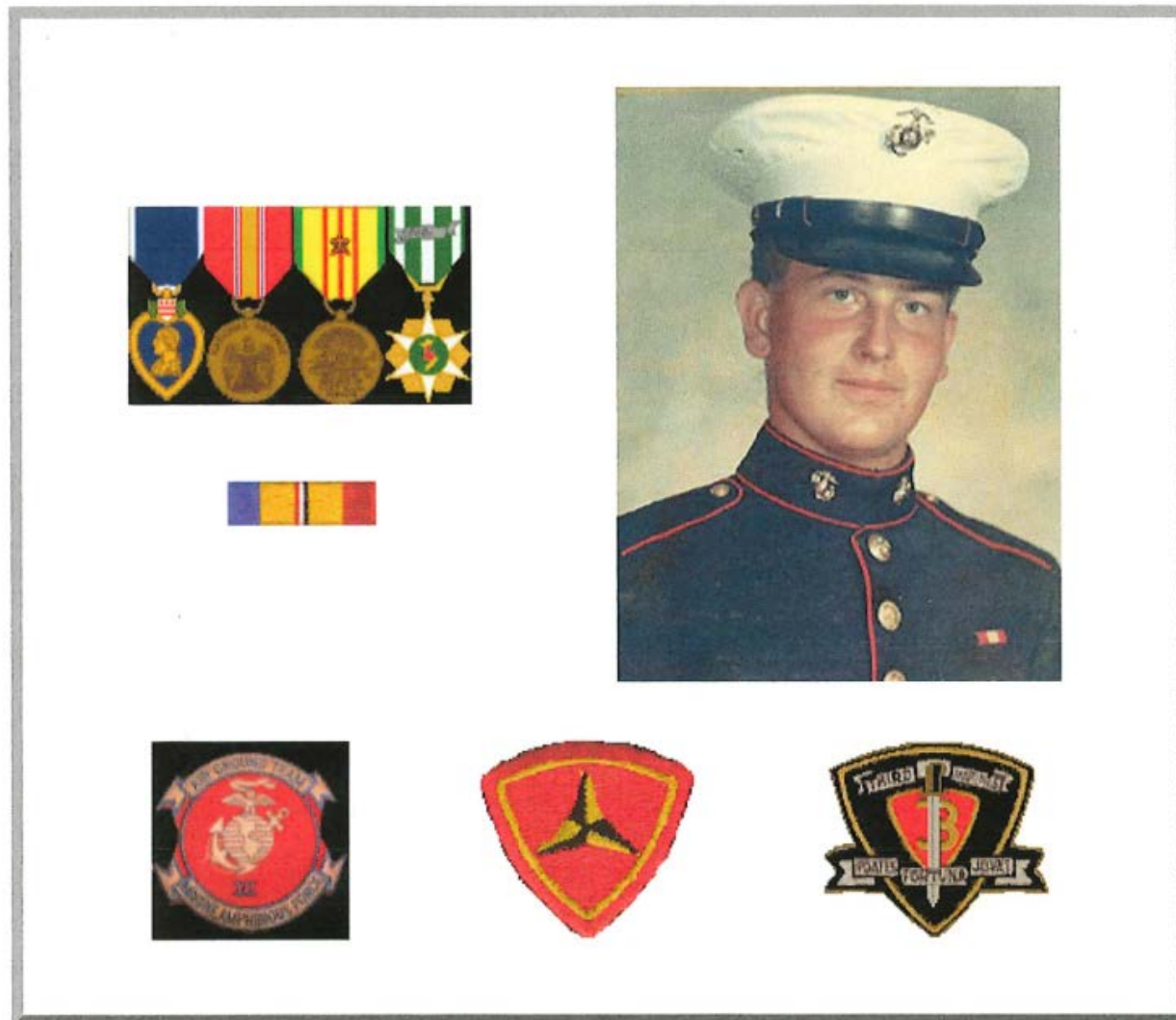

Kevin Barry Hardiman

ON THE WALL: Panel 32E Line 93

This page Copyright© 1997-2018 www.VirtualWall.org Ltd.

PERSONAL DATA:

Home of Record: New Bedford, MA

Date of birth: 08/20/1949

MILITARY DATA:

Service Branch: United States Marine Corps

Grade at loss: E2

Rank: Private First Class

Promotion Note: None

ID No: 2357525

MOS: 0311: RIFLEMAN

Length Service: 00

Unit: 1ST PLT, F CO, 2ND BN, 3RD MARINES,
3RD MARDIV, III MAF

CASUALTY DATA:

Start Tour: 11/14/1967

Incident Date: 12/29/1967

Casualty Date: 12/29/1967

Status Date: Not Applicable

Status Change: Not Applicable

Age at Loss: 18

Location: Quang Nam Province, South Vietnam

Remains: Body recovered

Repatriated: Not Applicable

Identified: Not Applicable

Casualty Type: Hostile, died outright

Casualty Reason: Ground casualty

Casualty Detail: Gun or small arms fire

URL: <https://VirtualWall.org/dh/HardimanKB01a.htm>

Data accessed: 9/22/2023

PROJECT SCHEDULE & FUNDING

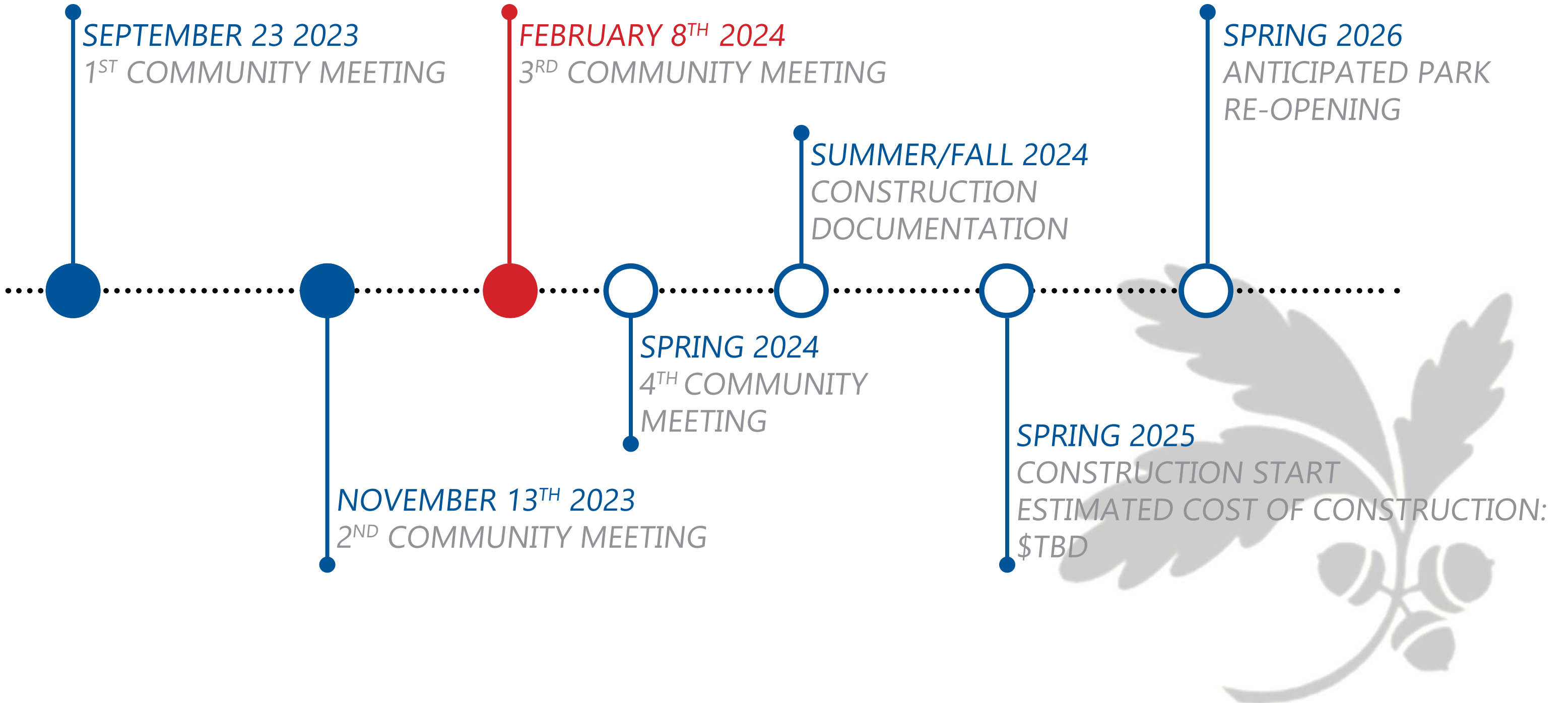



PROJECT SCOPE

- *Improvements to 2-5 and 5-12 playground and water play*
- *Improvements to Little League Field and infrastructure*
- *Provide ADA access*
- *Improvements to site amenities*
- *Repainting of basketball court and added seating*
- *Formalize the dog park*

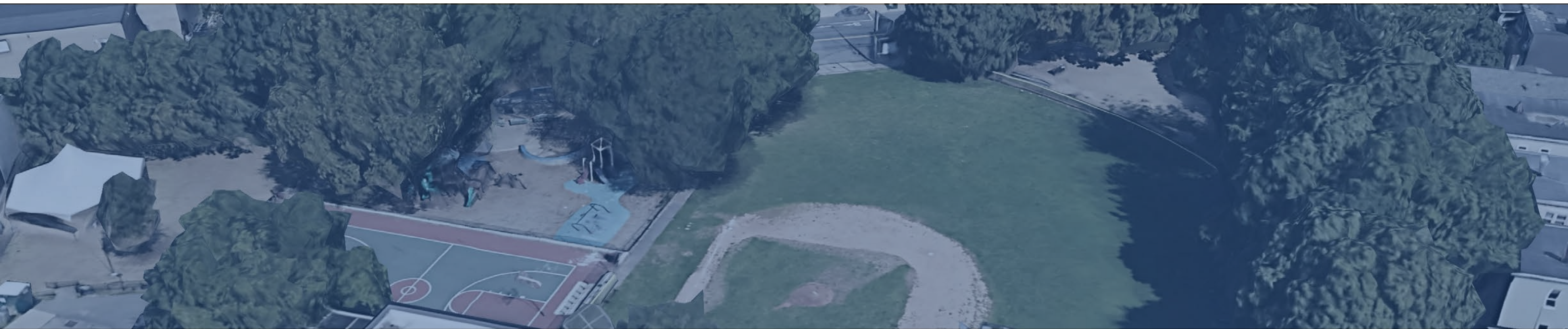

ENGAGEMENT RESULTS



COMMUNITY INPUT

SEPTEMBER.23 COMMUNITY ENGAGEMENT



ONLINE SURVEY

Hybrid



14. Please provide any general comments if you wish to add towards park improvements.

15. Email address to continue to receive project updates and notices for upcoming community meetings / workshops (optional):

Thank you for taking our survey. Your response is very important to us. If you have any questions, comments or concerns please contact:

Lauren Bryant

Project Manager

Boston Parks and Recreation Department

617-961-3019

Lauren.Bryant@boston.gov

SURVEY SUMMARY

42 RESPONSES ARE RECEIVED

Q9 What do you typically do at Hardiman Playground? Please choose all that apply.

Answered: 42 Skipped: 1

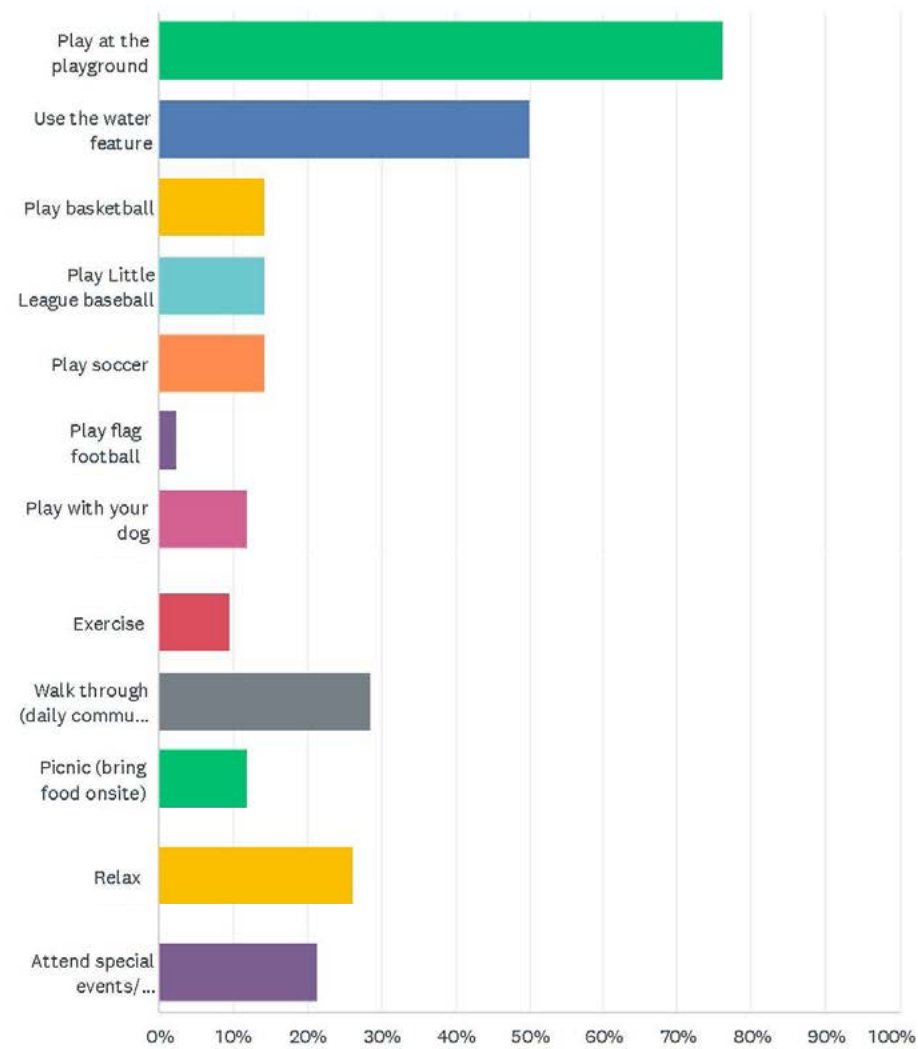

Q11 Which amenities (existing or new) are most important to you? Please choose all that apply.

Answered: 42 Skipped: 1

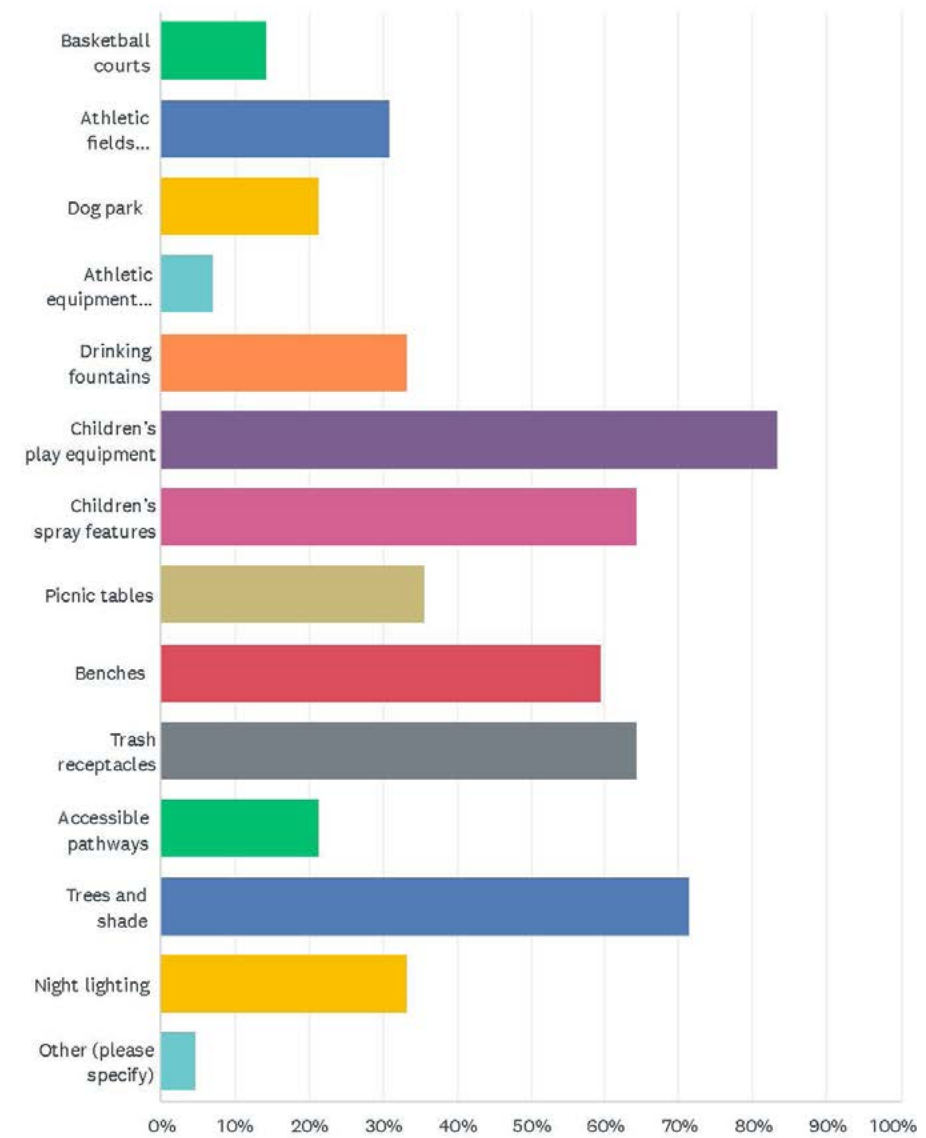

SURVEY SUMMARY

Q13 Which play equipment style do you prefer? Choose one.

Answered: 41 Skipped: 2

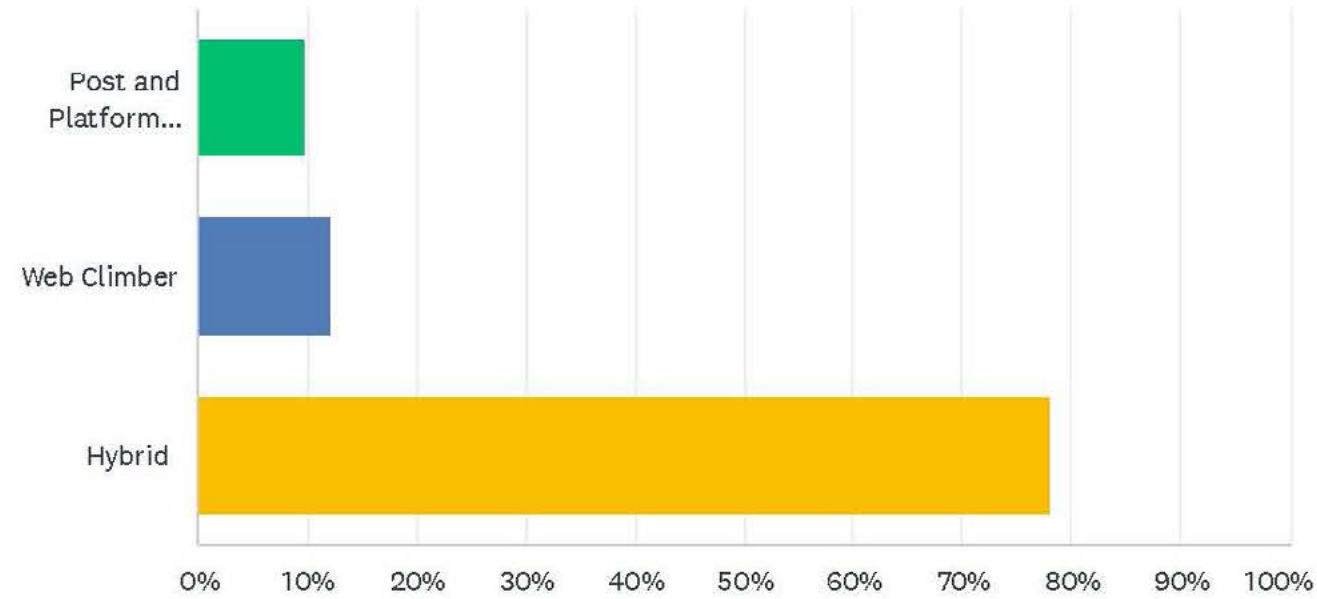

POST AND PLATFORM



WEB CLIMBER





HYBRID



ANSWER CHOICES

RESPONSES

 Post and Platform	9.76%	4
 Web Climber	12.20%	5
 Hybrid	78.05%	32
TOTAL		41

WHAT WE HAVE HEARD

ACTIVITIES:

- Play at the playground
- Use the water feature
- Exercise
- Walk through
- Picnic
- Relax
- Attend special events

PLAY STRUCTURES:

- Better splash pad
- More swings/ADA swings
- Slides are too high
- Some smooth concrete areas are nice for chalking.
- Risk play is smart play.
- Handrails/Ninja warrior
- Balancing activities, lily pads, walls, balance beams, climbing structures.

Site Amenities Requested:

- Shade over the swings & courts
- Toilets
- Keep trees and add more Shade.
- Picnic tables
- Better flashlight at crosswalk to park, car speed through it
- ADA entrance

LITTLE LEAGUE FIELD:

- Keep field, concern about having dog on the field.
- Needs improvement-new benches, drainage, and storage.
- Bleachers in dog area can go.
- Foul ball hazards

BASKETBALL:

- Heavily used especially in the evenings.
- Need additional seating.
- Some shade would be nice.

DOGS:

- Occasionally, dogs are seen off-leash in the play area.
- A formalized dog park would help.

DESIGN STUDY

- LITTLE LEAGUE
- BASKETBALL COURT
- NEW PLAYGROUND PROGRAMMING AND CIRCULATION OPTIONS
- PLAY EQUIPMENT CHOICES
- SITE AMENITIES



LITTLE LEAGUE STUDY OPTIONS

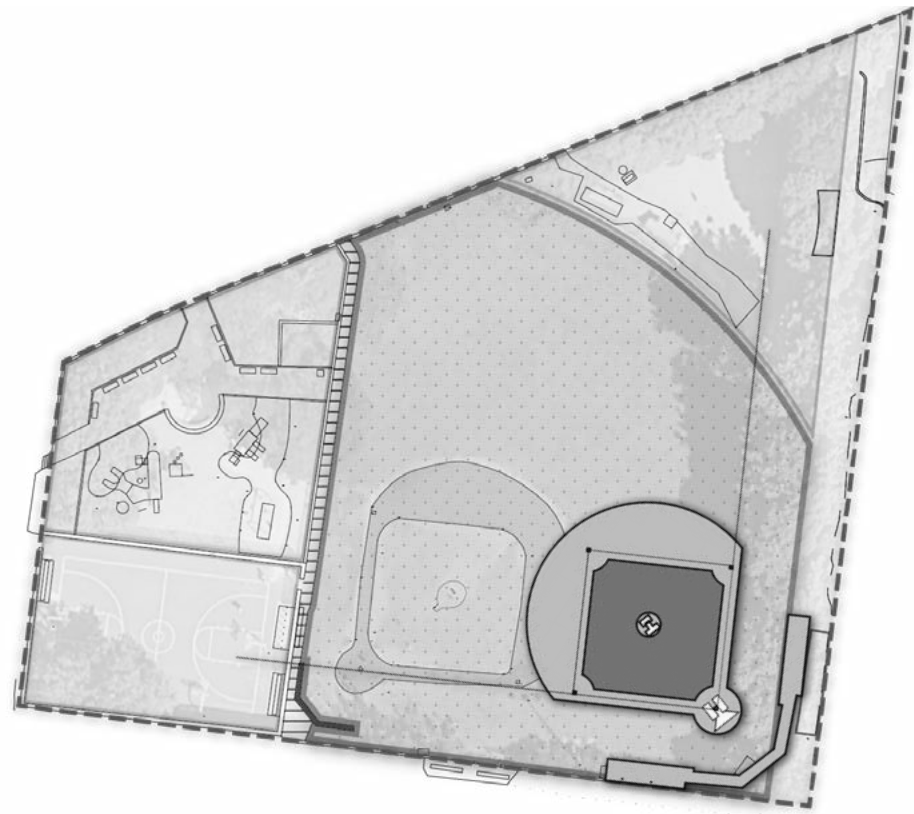

OPTION A

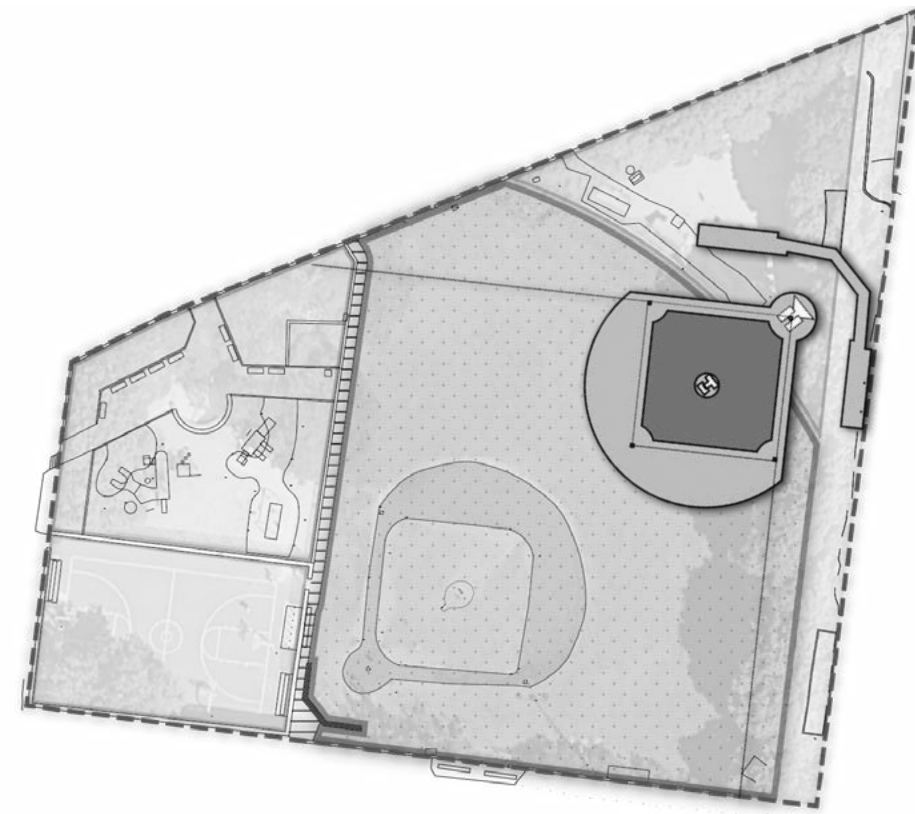

OPTION B

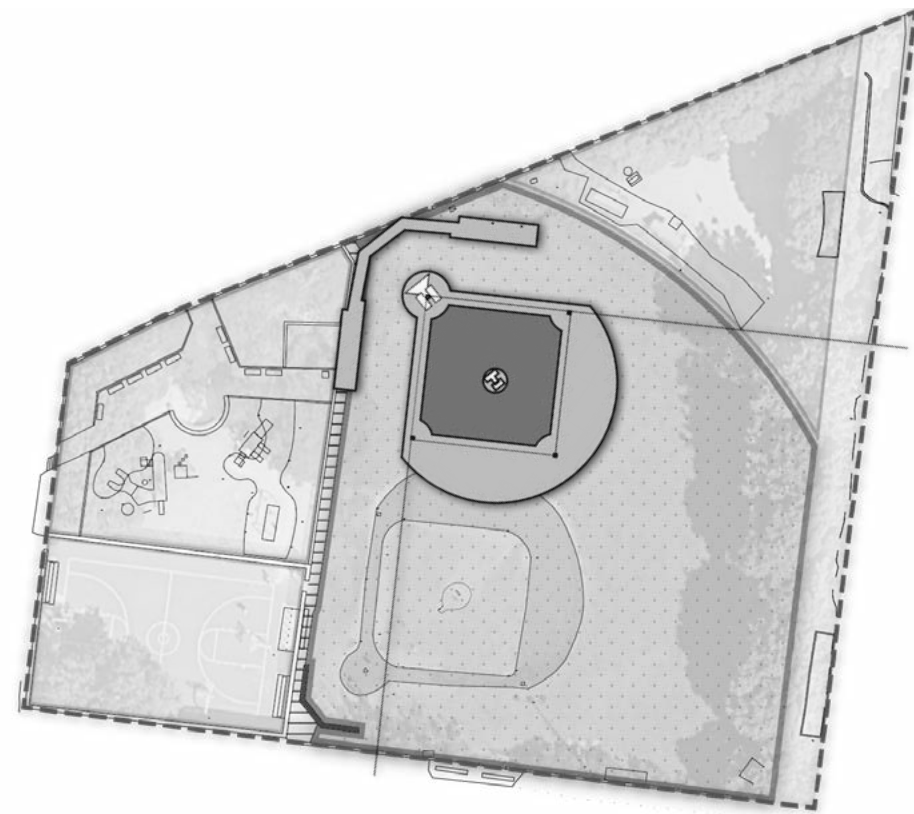

OPTION C

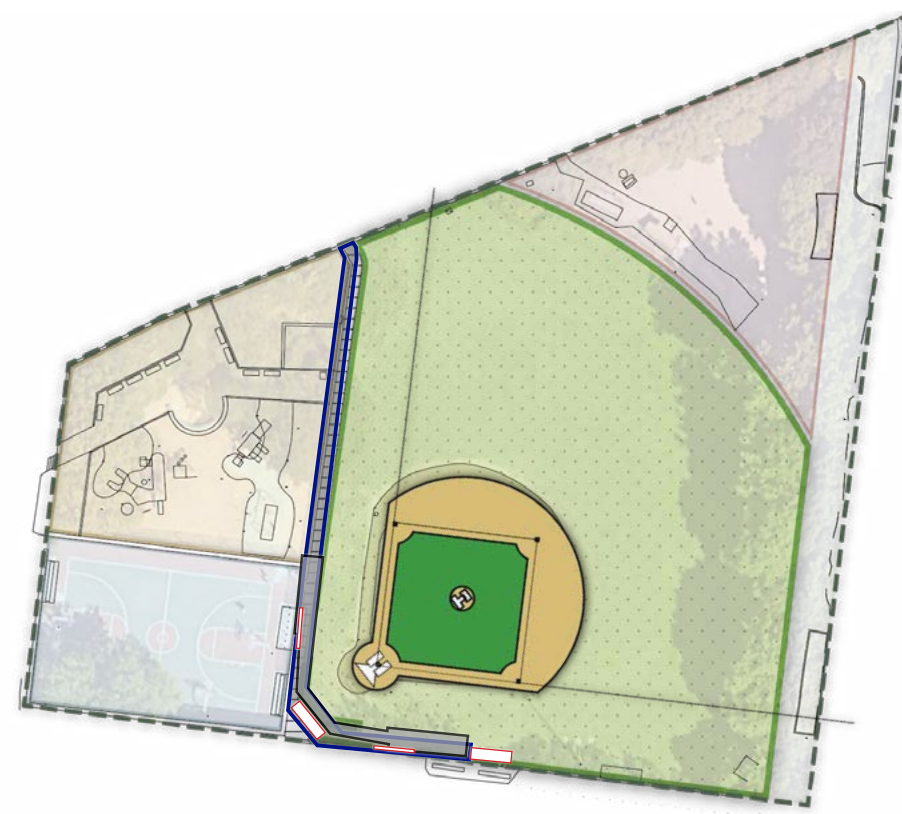

OPTION D (RECOMMENDED)

LITTLE LEAGUE

CONFIGURATION

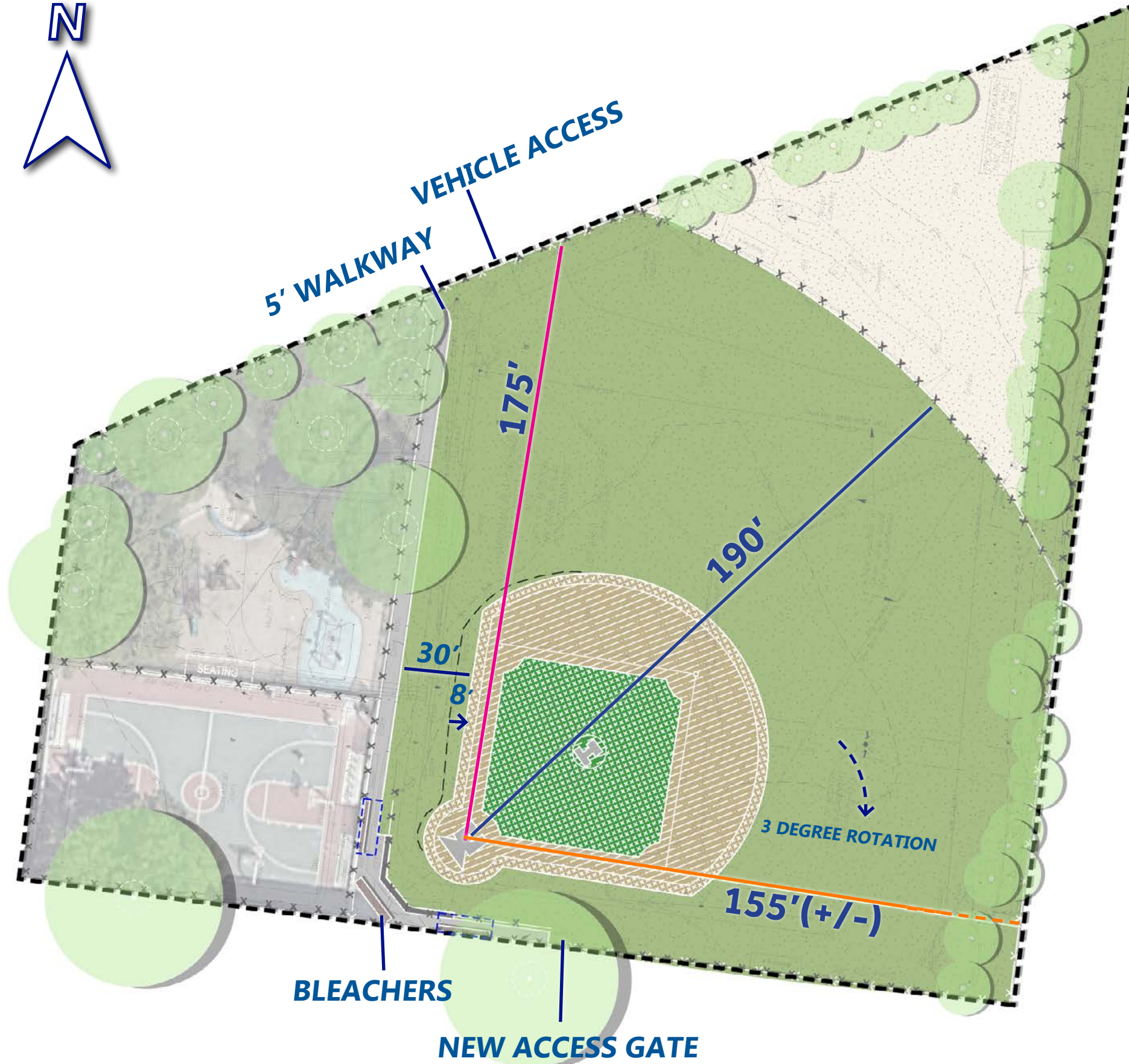

PROS

- Good solar orientation
- Allows space for dog area to remain
- Spectator access around backstop
- More space between field and playground

CONS

- Reduced outfield size

	EXISTING	RELOCATED	REGULATION
1ST BASE FOUL LINE	160'	155' (+/-)	200'
CENTER FIELD	190'	190'	200'
3RD BASE FOUL LINE	173'	175'	200'

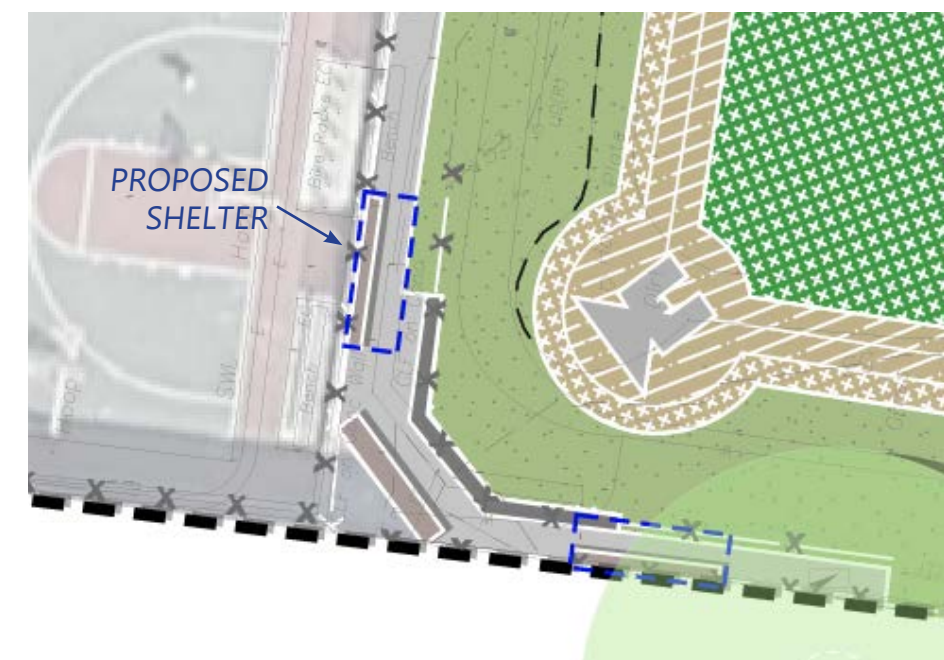

LITTLE LEAGUE



DUGOUT



BLEACHER

BASKETBALL COURT

BASKETBALL COURT

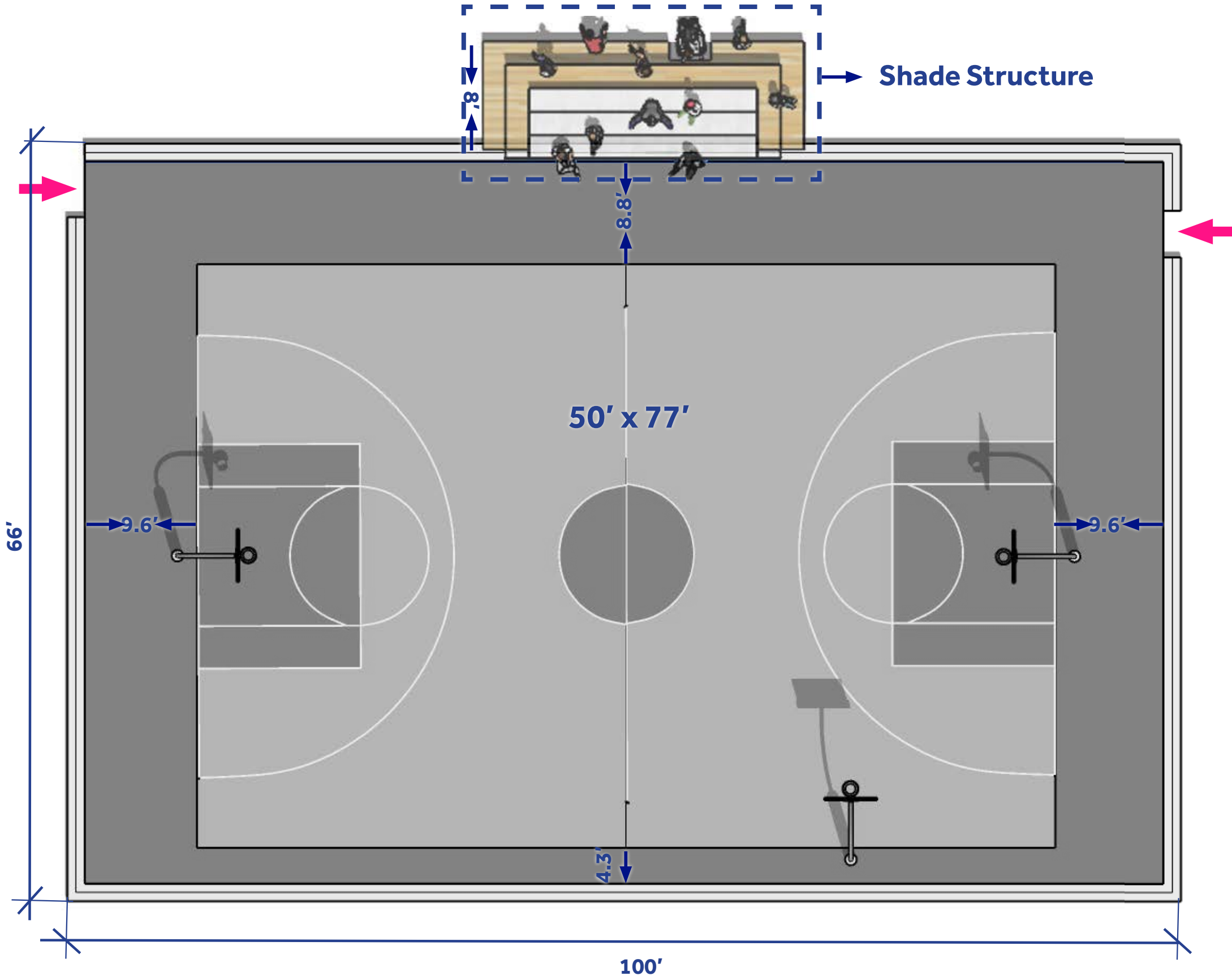

COURT DIMENSIONS

- *High school, and Junior High court 84 feet by 50 feet*
- *Minimum of 3 feet is required for out-of-bound space but where there is spectator seating 10 feet is recommended.*
- *Additional seating preferred as courts used for summer camps as well as several exercise groups*
- *Shade is also desired*

BASKETBALL COURT

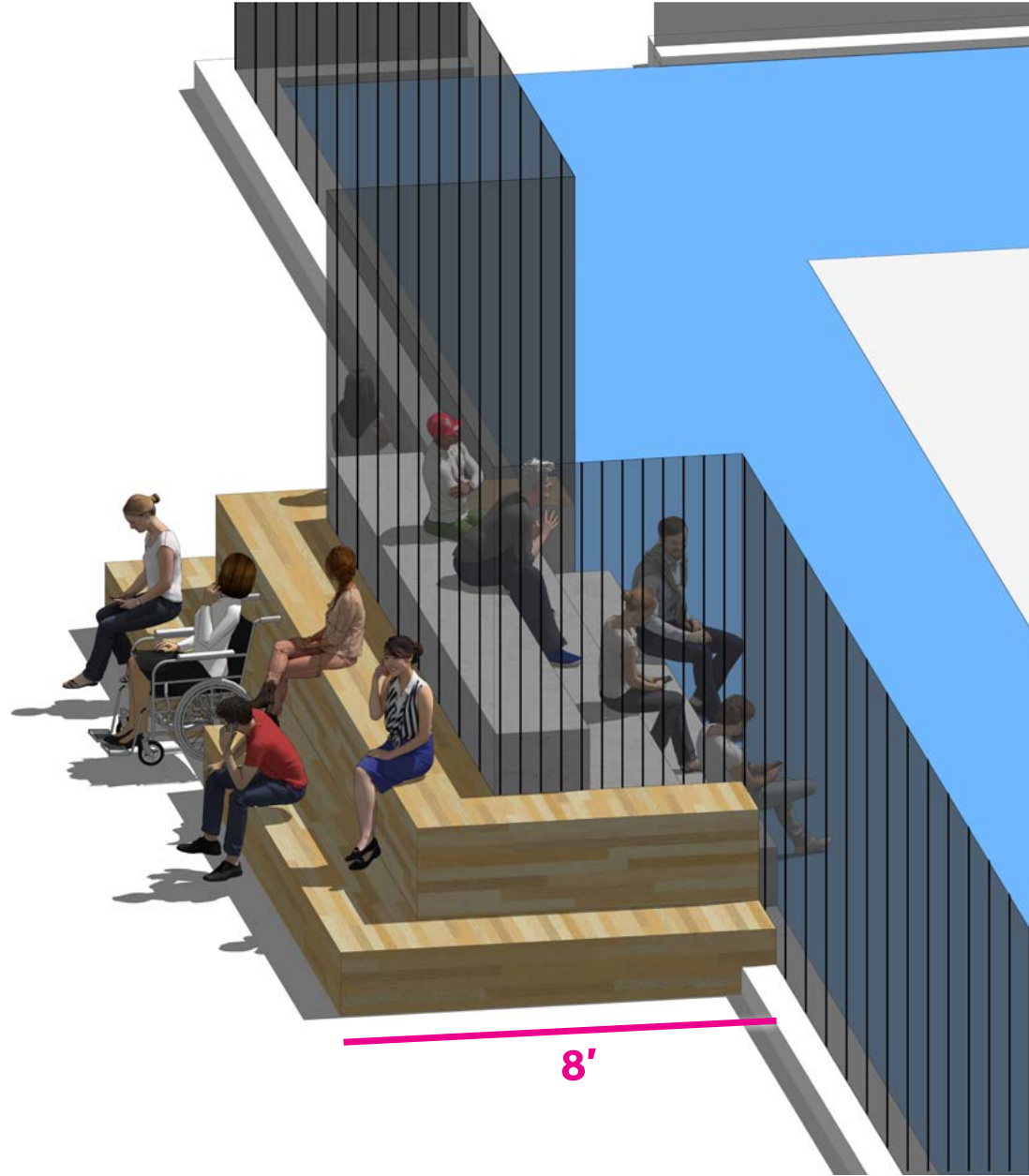
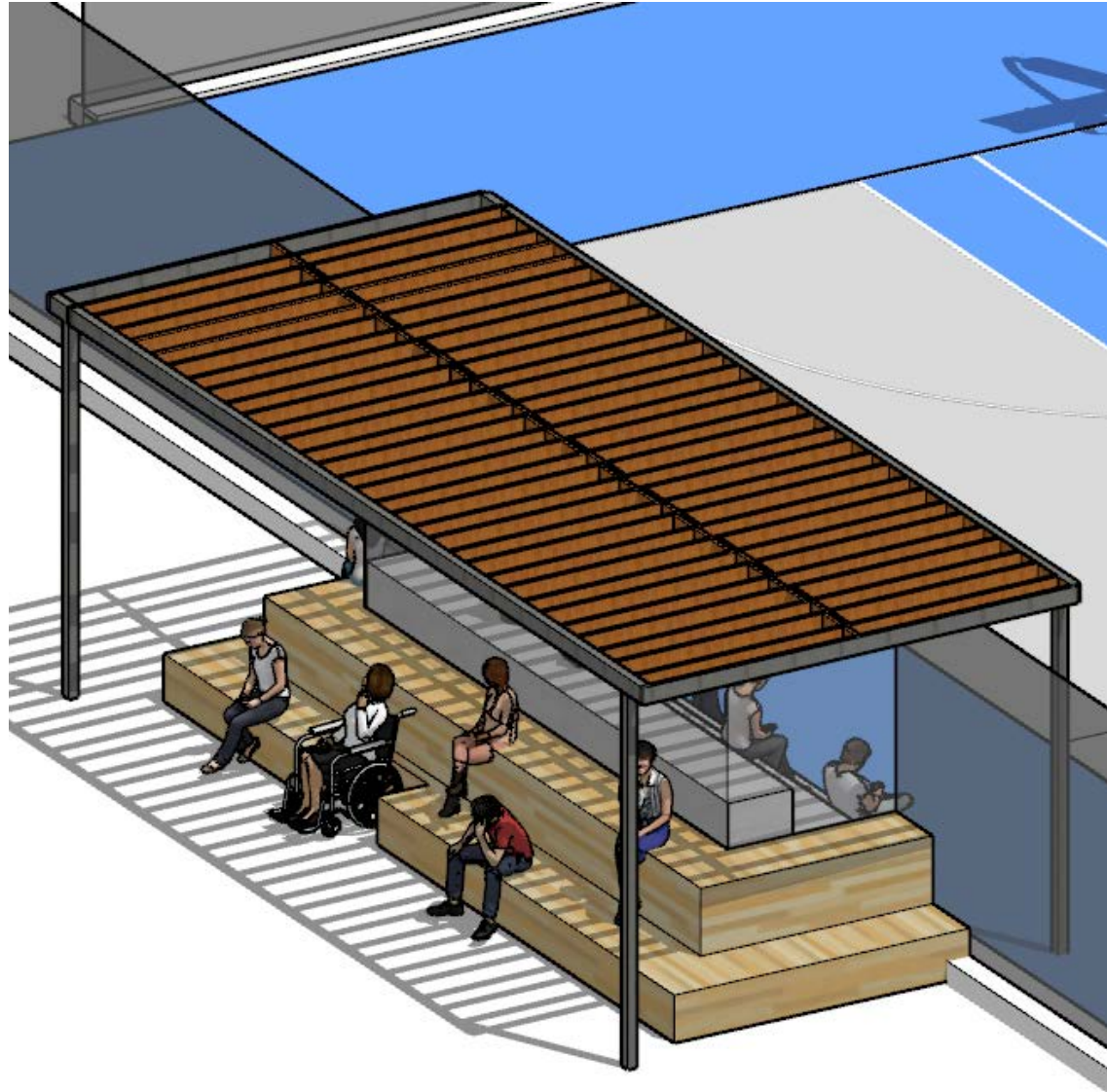

**TREXX DECKING
(COMPOSITE WOOD)**

BASKETBALL COURT



TRADITIONAL PAINTING



COLORFUL PAINTING

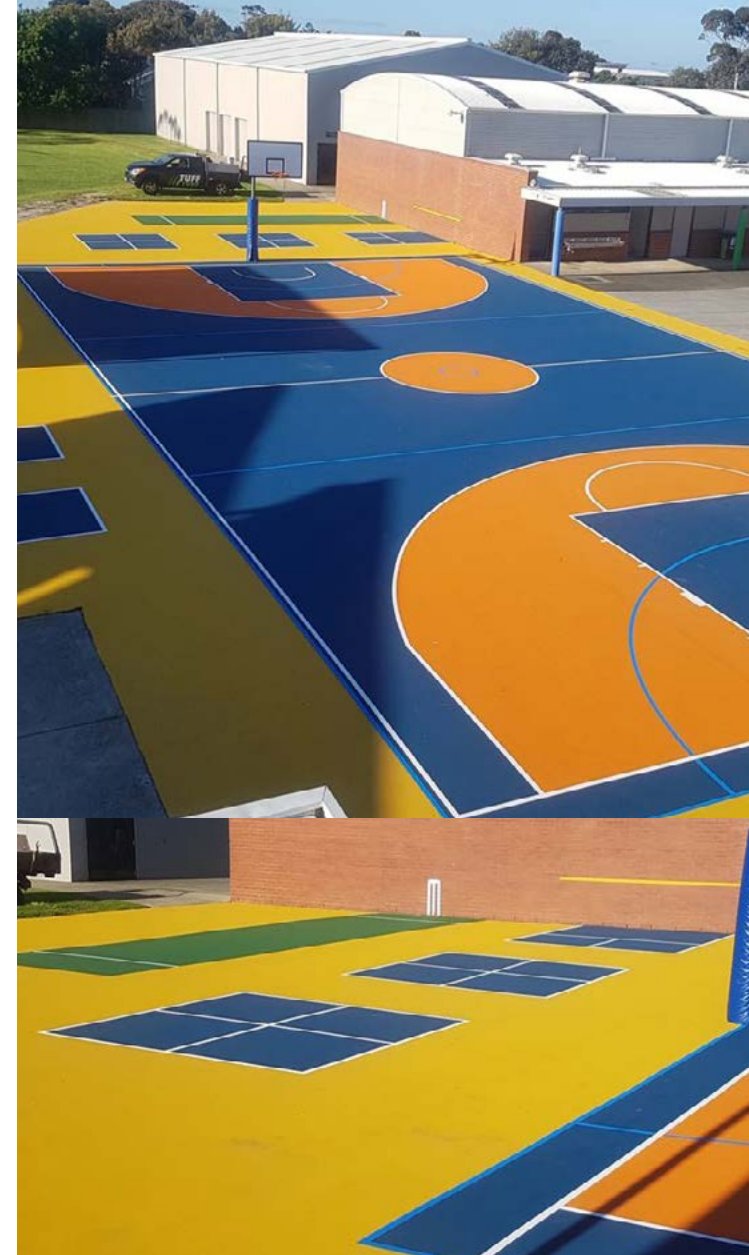

MULTI-SPORT GAME COURT



KID GAMES COURT

NEW PLAYGROUND PROGRAMMING AND CIRCULATION OPTIONS

DESIGN CONCEPTS



EXISTING



CONCEPT A



CONCEPT B



CONCEPT C

-  SWINGS
-  PICNIC
-  TODDLER
-  5-12
-  2-5
-  WATER PLAY

CONCEPT A-THE CAMP



CONCEPT A-THE CAMP (5-12 STRUCTURE)



CONCEPT A-THE CAMP (2-5/TODDLER STRUCTURE)



2-5



TODDLER

CONCEPT B-SPACE PODS



CONCEPT B-SPACE PODS

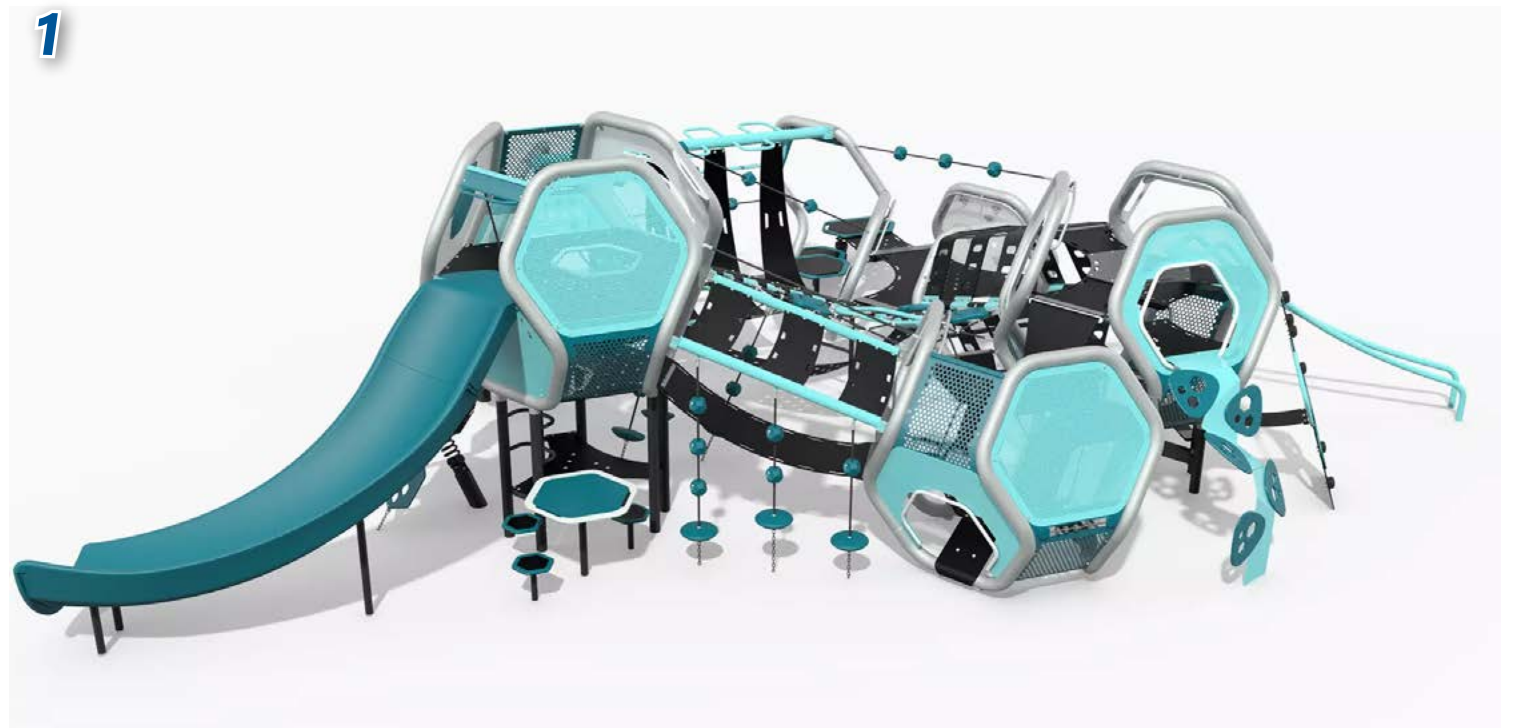
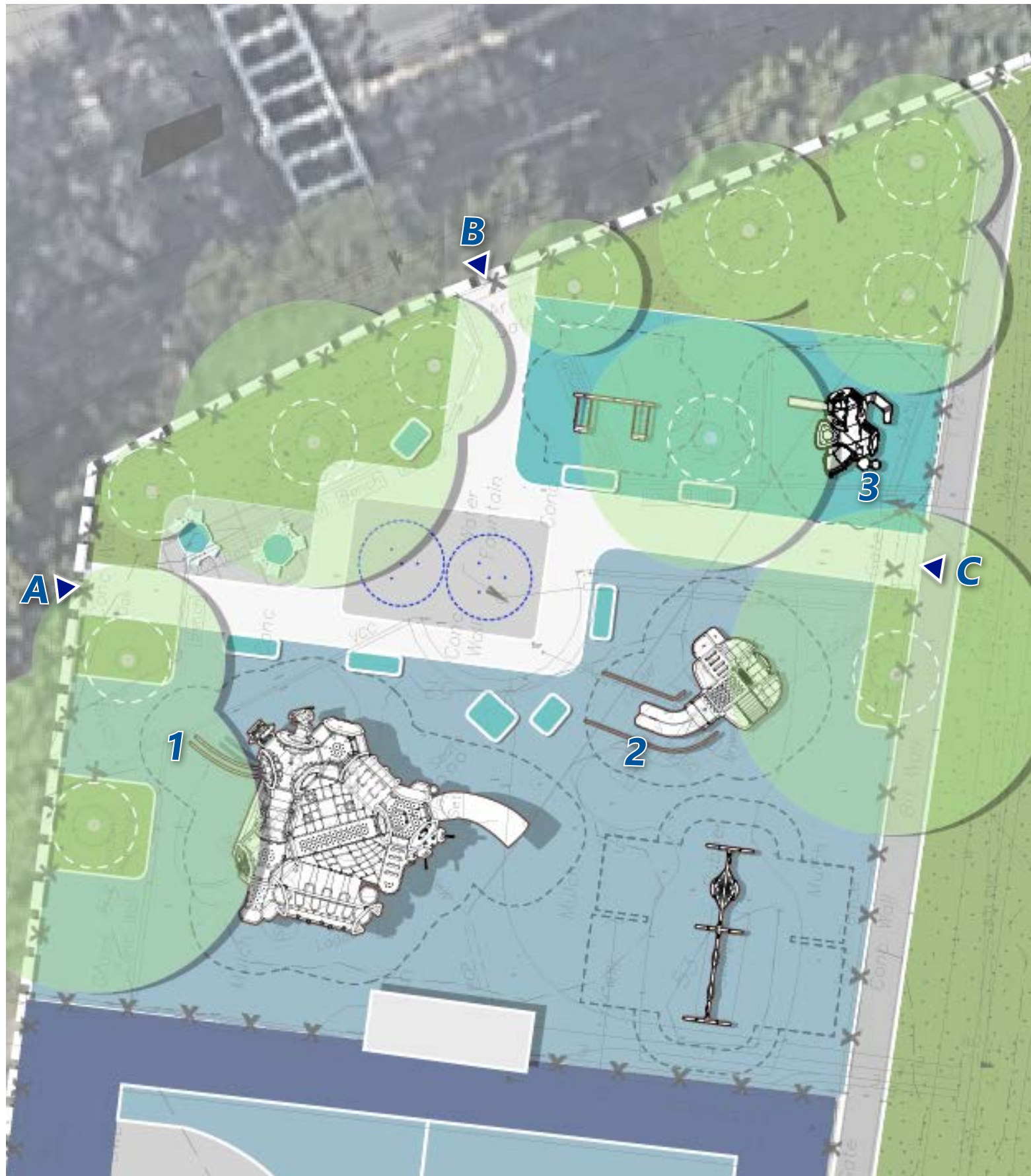

CONCEPT B-SPACE PODS (5-12 STRUCTURE)



CONCEPT B-SPACE PODS (2-5/TODDLER STRUCTURE) —



2-5

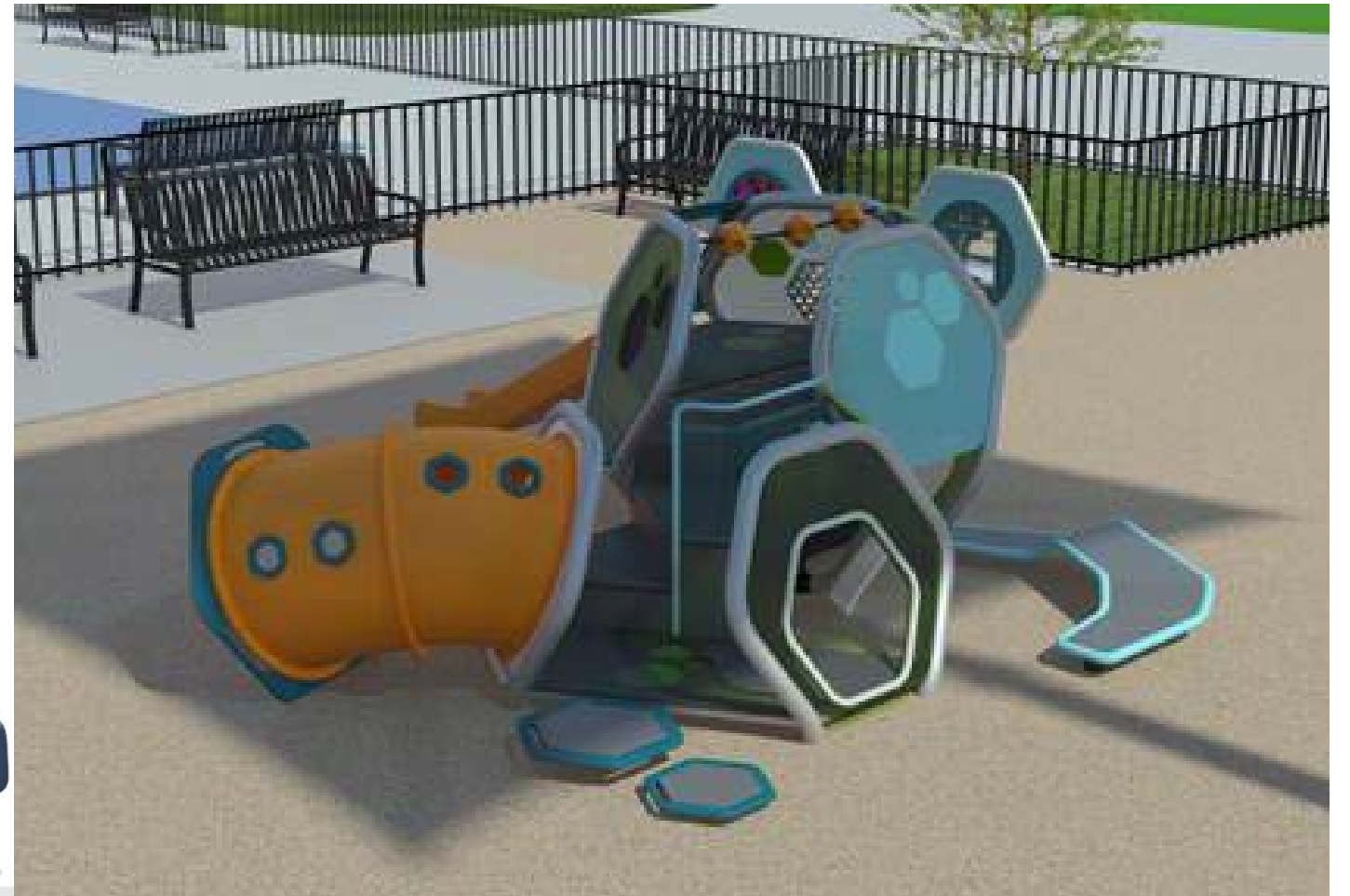

TODDLER

CONCEPT C-URBAN TOPS



CONCEPT C-URBAN TOPS

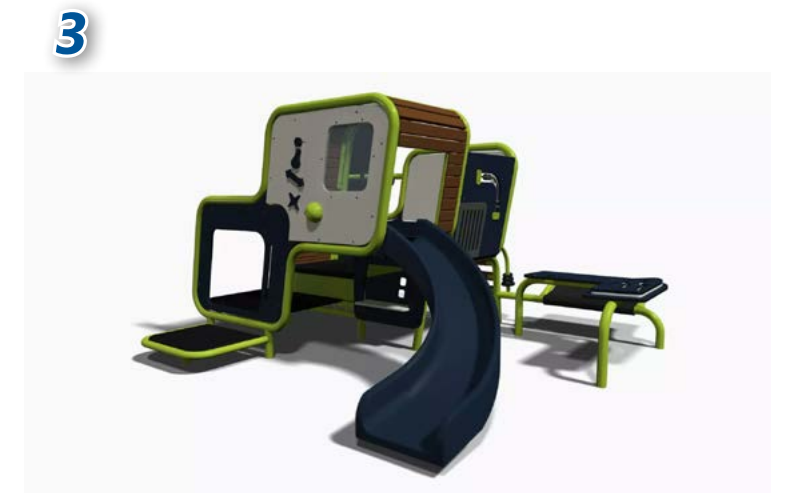
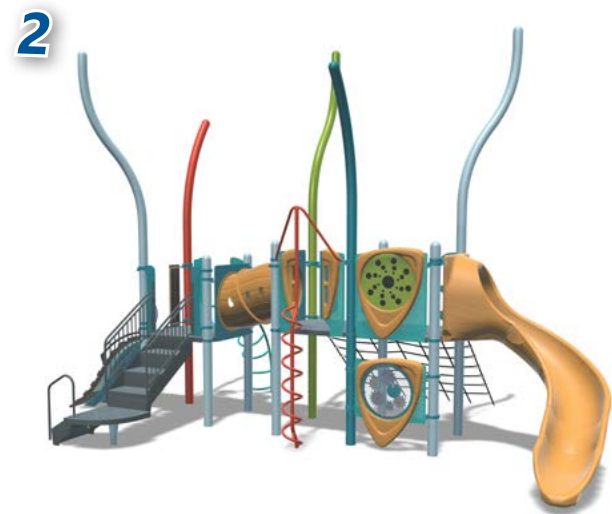

CONCEPT C-URBAN TOPS (5-12 STRUCTURE)

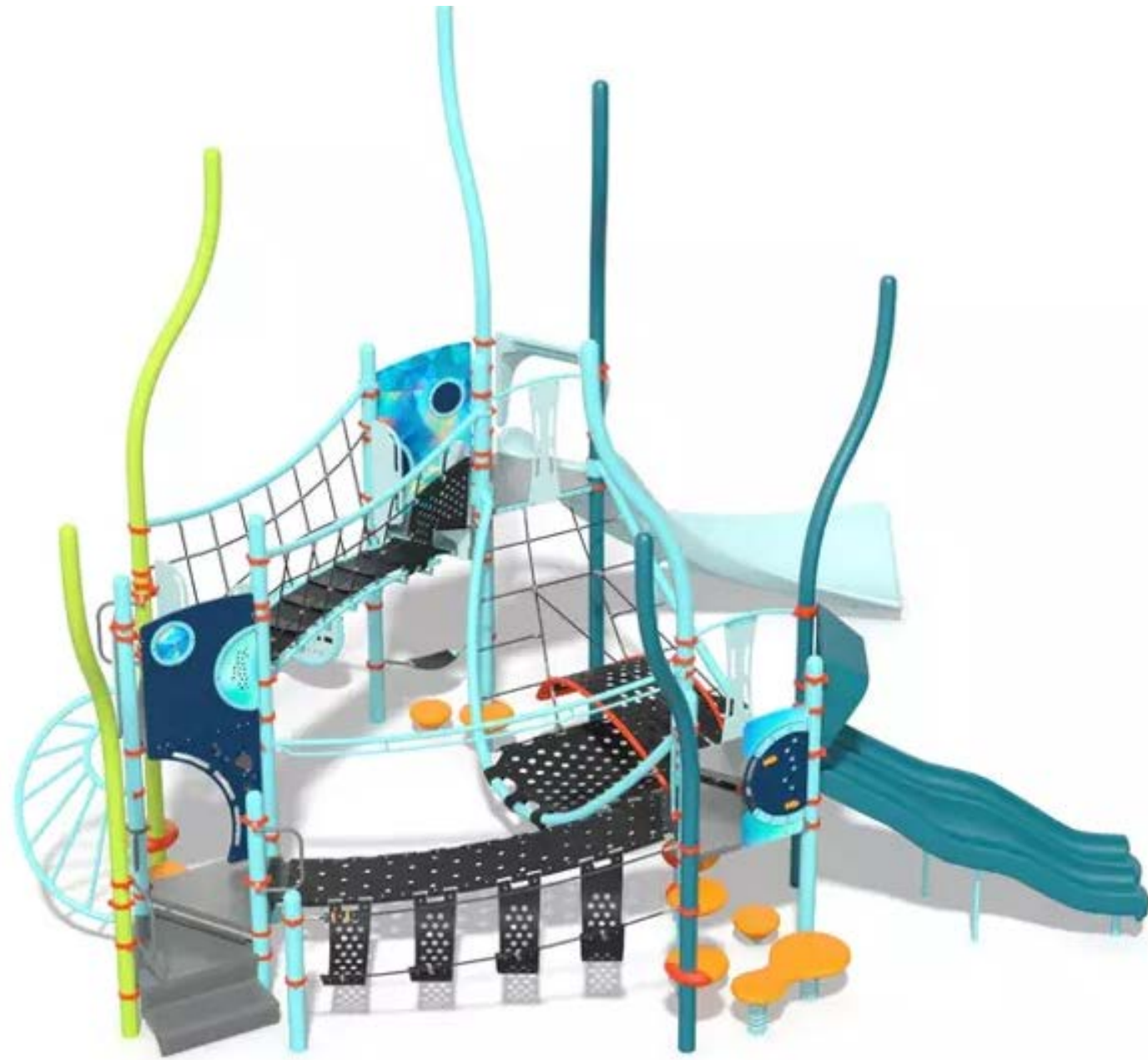

CONCEPT C-URBAN TOPS(2-5/TODDLER STRUCTURE) —



2-5



TODDLER

SWINGS



5-12

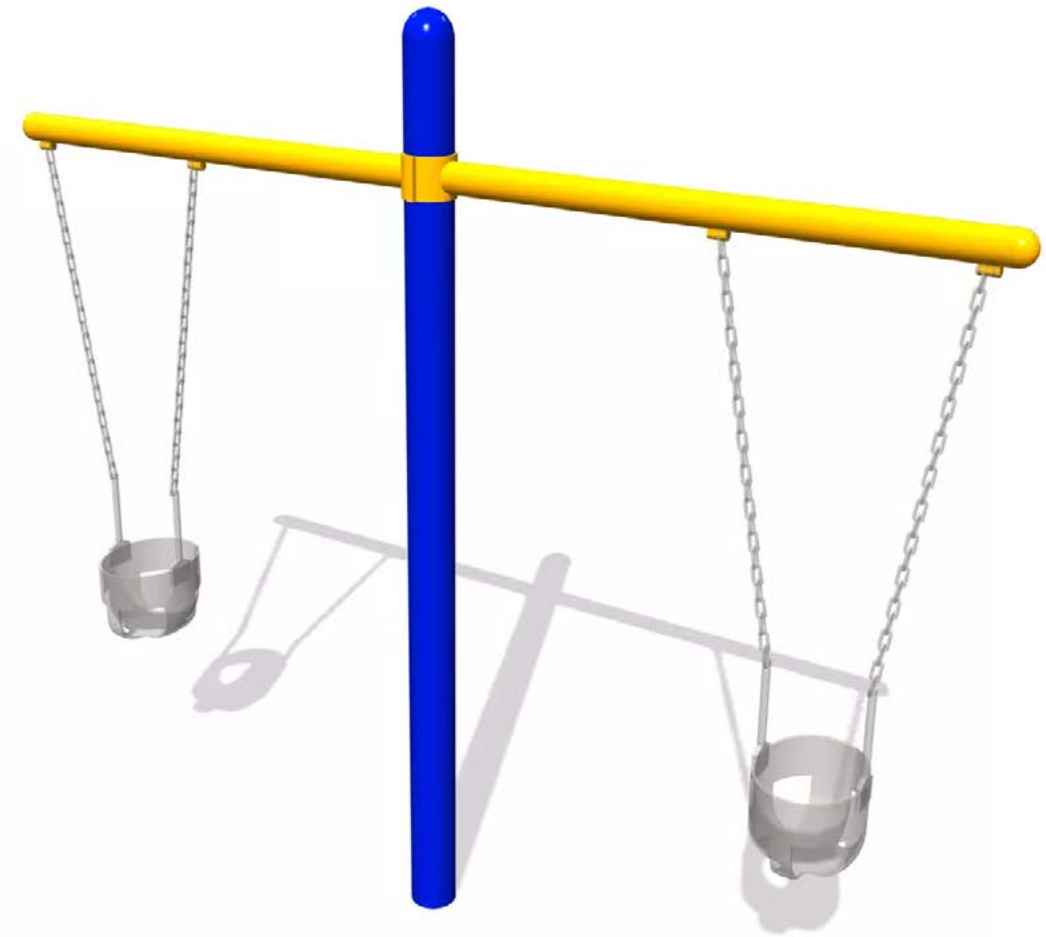

TODDLER

BOSTON PARK STANDARD SITE FURNISHINGS

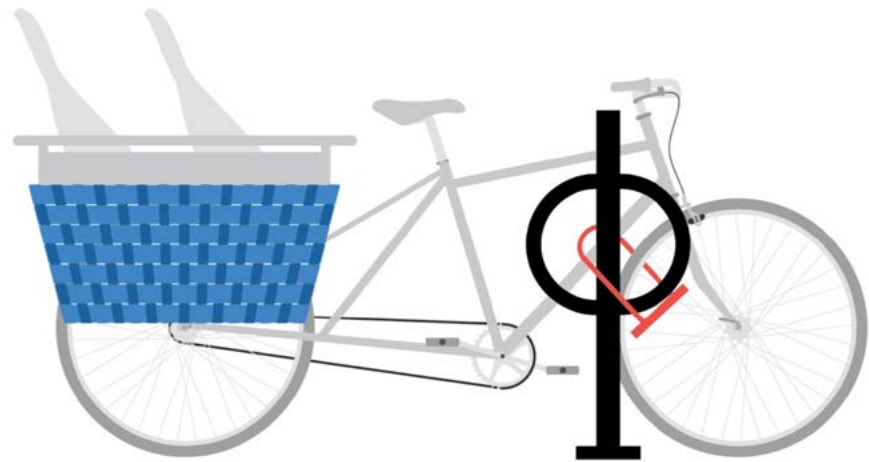

BIKE RACK



TRASH CAN



METAL BENCH

NON-STANDARD SITE FURNISHINGS



PICNIC TABLE

BENCH

SPLASH PAD

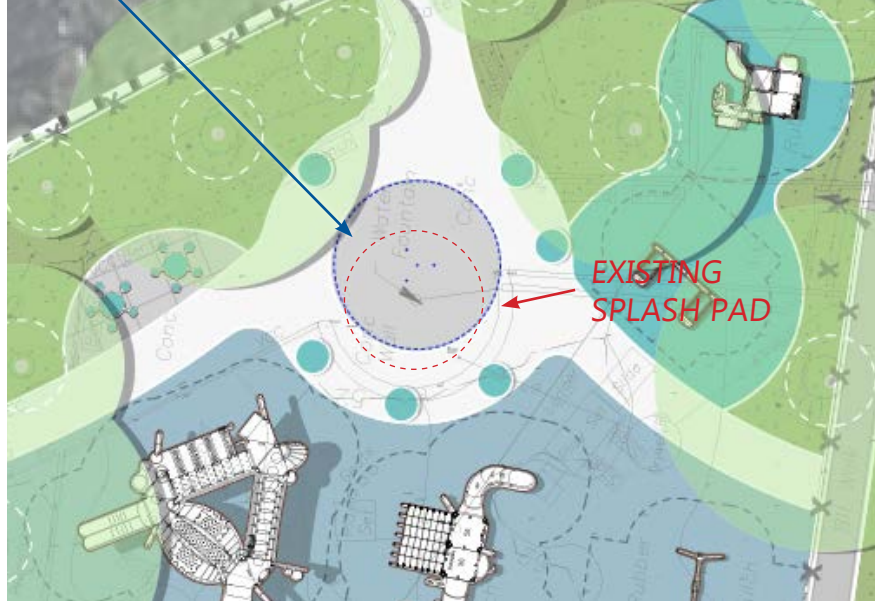
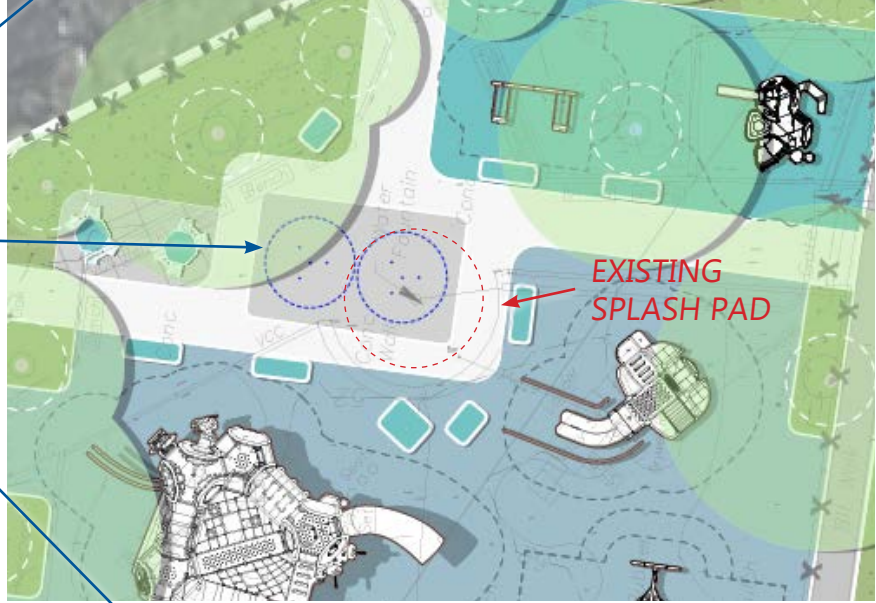
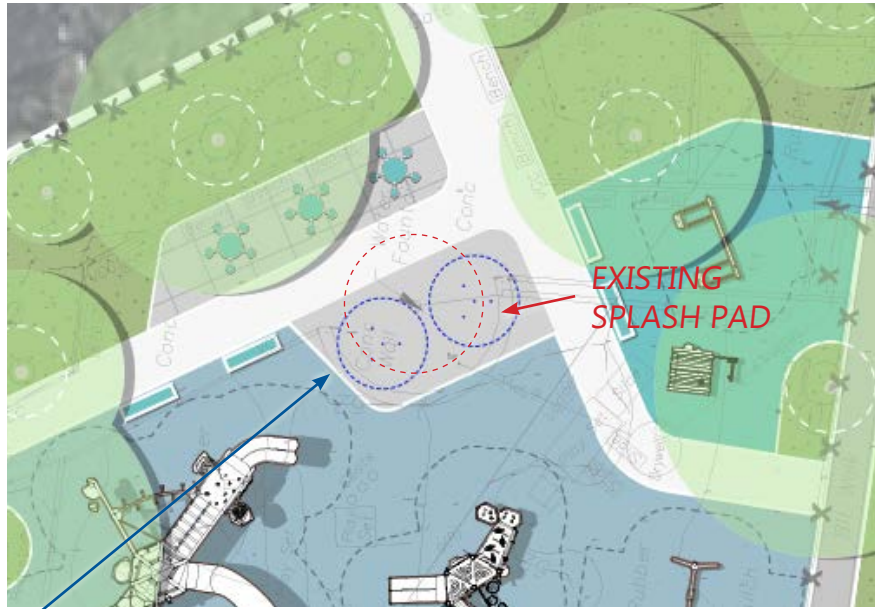
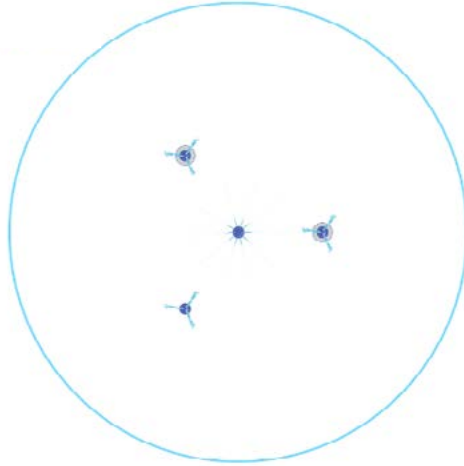
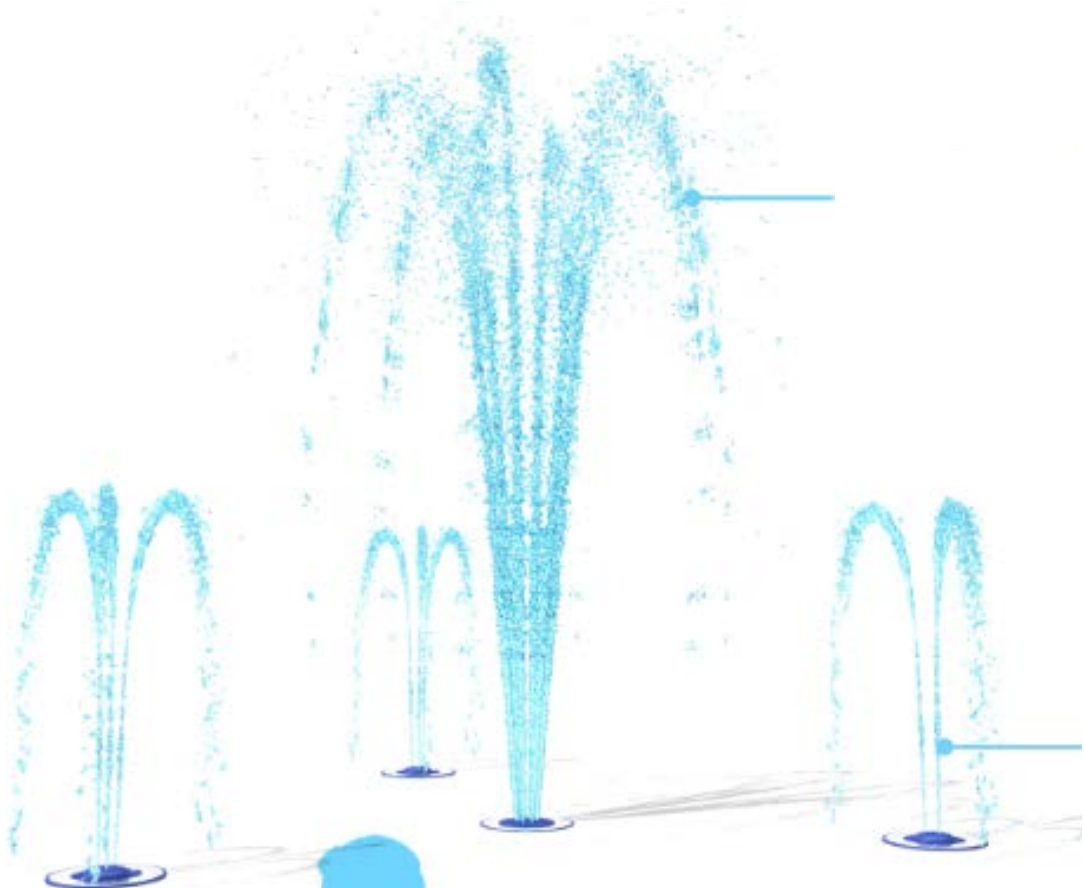

COLOR PATTERN AND PALETTE OPTIONS

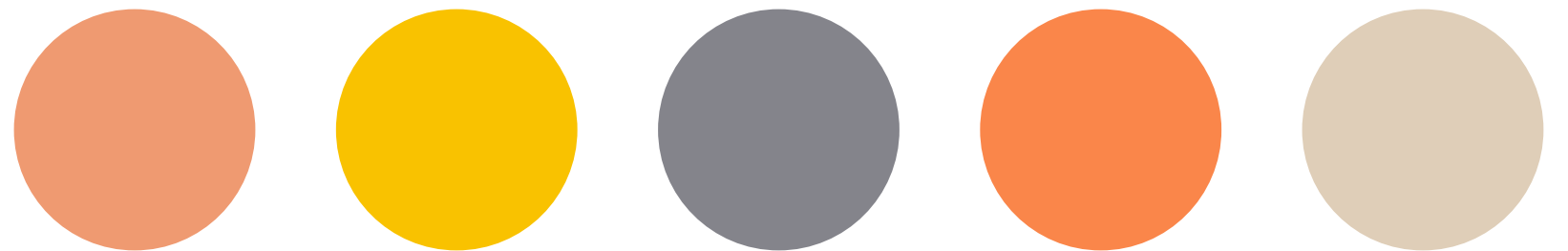
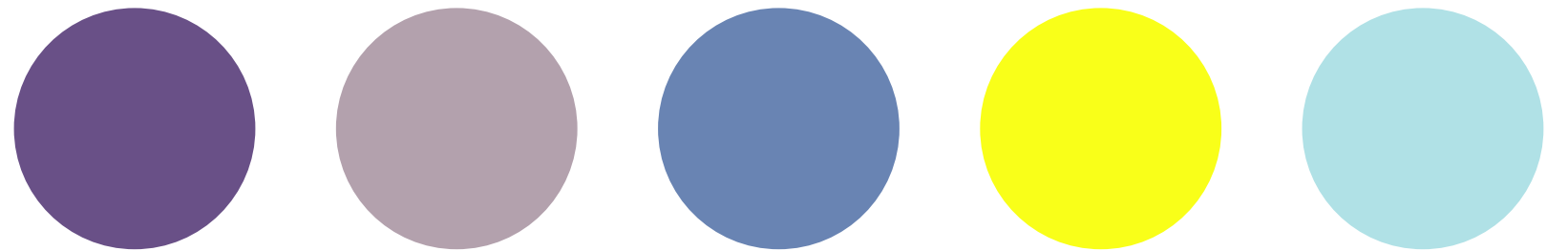
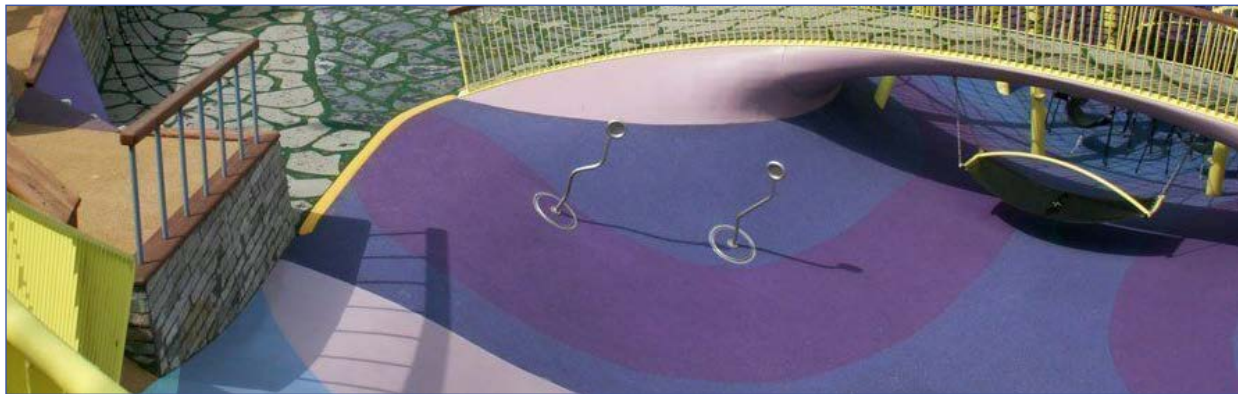
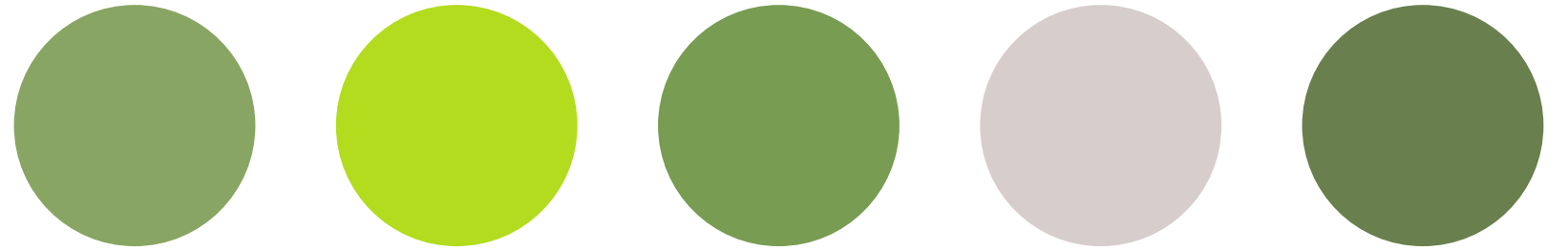
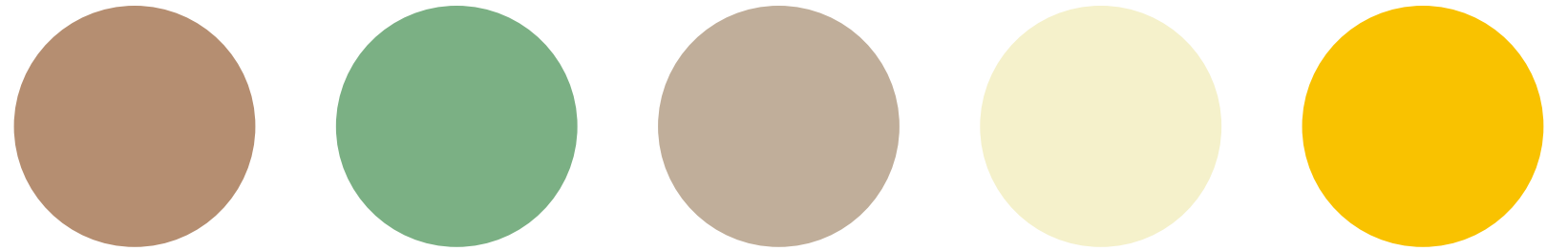

COLOR PATTERN AND PALETTE OPTIONS

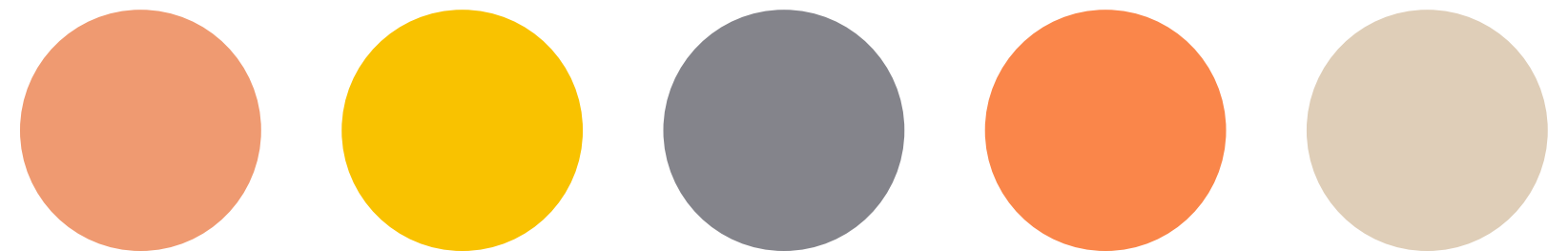
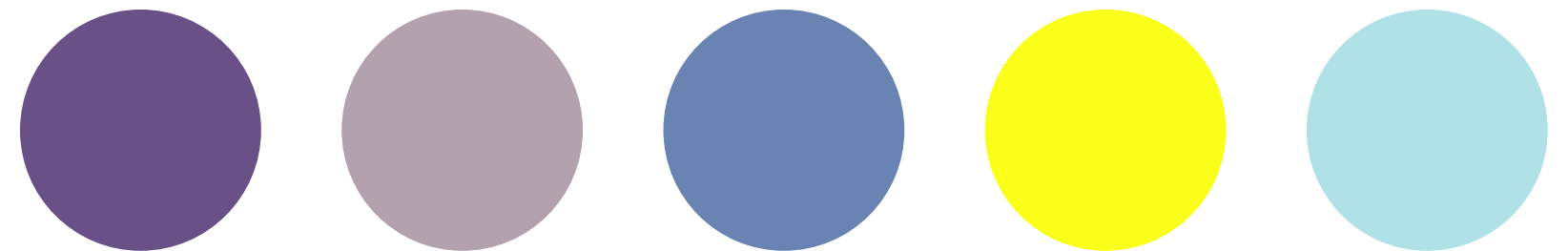
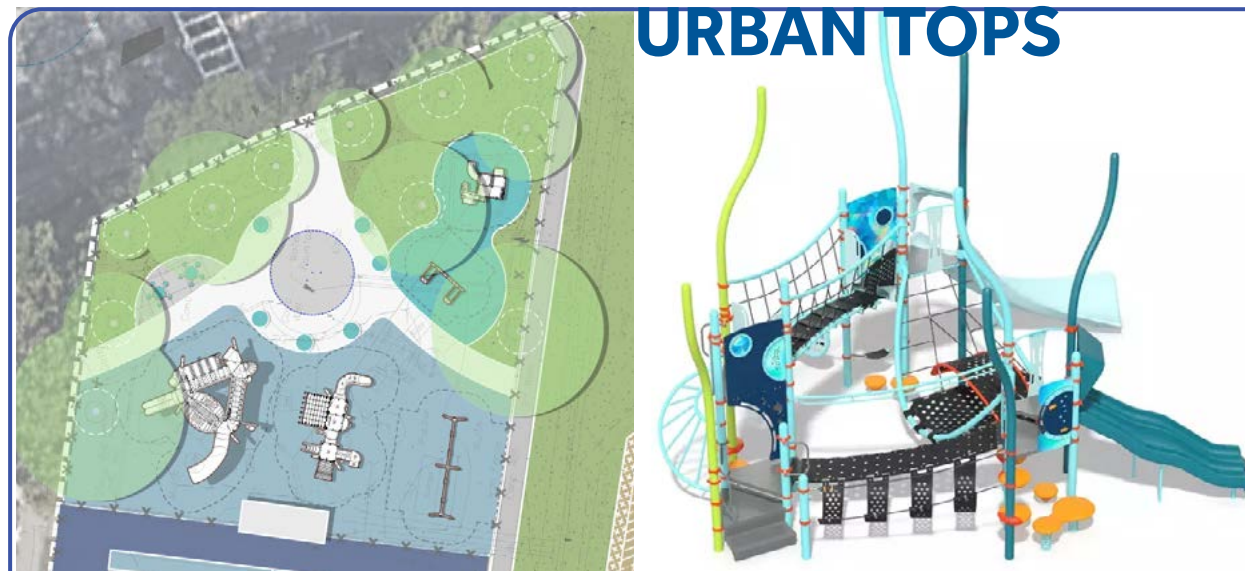
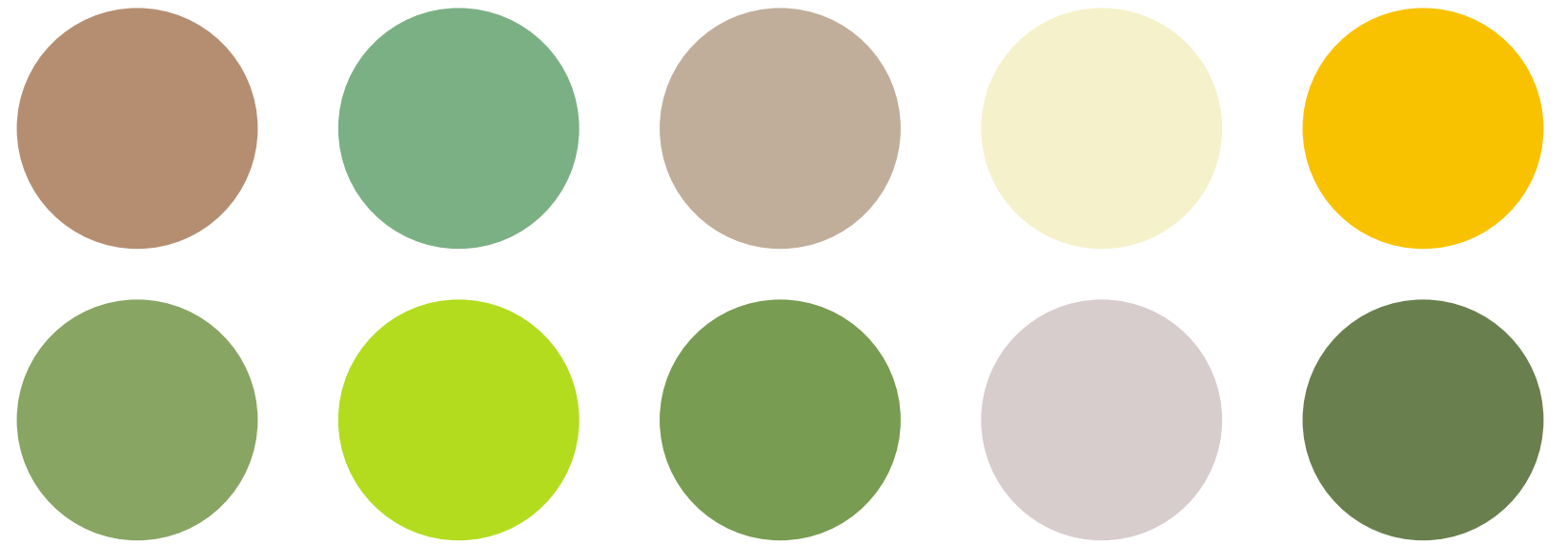

DOG PARK FEATURES



RICE STONE SURFACING

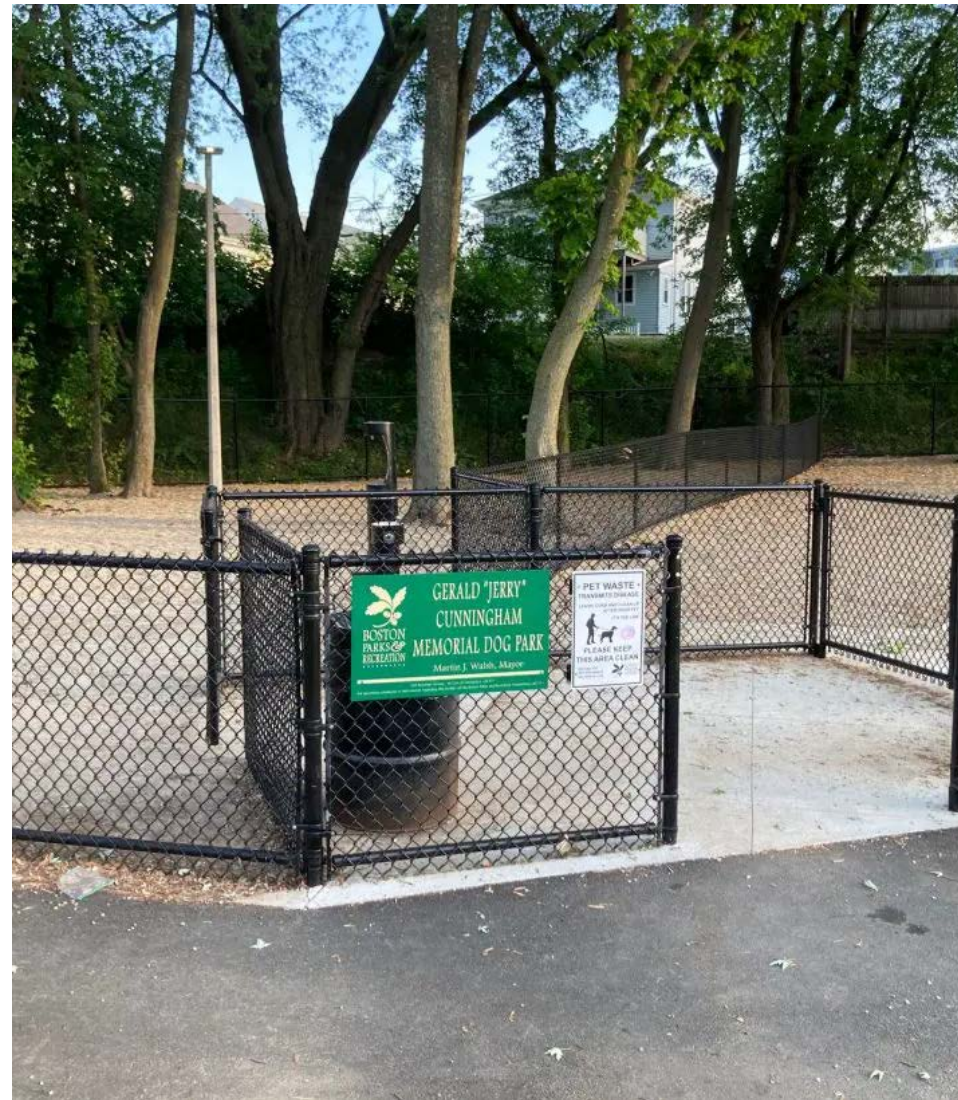

DOUBLE GATE



SEATING AND DOG WATER FOUNTAIN

DOG PARK AGILITY EQUIPMENT



THANK YOU!

For questions, maintenance requests or concerns regarding any of our parks contact 311



Final meeting will be in Spring 2024. Please reach out to Lauren Bryant at Lauren.Bryant@boston.gov if you would like to be on the e-mail list for the meeting information



February 8, 2024

Boston Parks and Recreation

