

# RESILIENT MOAKLEY PARK

## COMMUNITY MEETING



11.08.2025  
Boston Parks and Recreation



**Thanks for sharing your  
time with us!  
Please grab a seat &  
we'll start shortly.**



## INTERPRETATION

---

Please let us know if you would like Spanish language interpretation, and one of the team members will support translation.

*Por favor, háganos saber si desea interpretación en español, y uno de los miembros del equipo le ayudará con la traducción.*

# AGENDA

---

1

## **PROJECT TEAM INTRODUCTION**

---

2

## **PROJECT OVERVIEW- WHERE WE WERE**

---

3

## **PRESENTATION- WHERE WE ARE GOING** RESILIENT MOAKLEY PARK PHASE A, PHASE B, & CONNECTORS

---

4

## **INTERACTIVE STATIONS**

---

5

## **SHARE OUT & TAKEAWAYS**

---

## PROJECT TEAM

---

### MARIN BRACO

SENIOR PROJECT MANAGER

[marin.braco@boston.gov](mailto:marin.braco@boston.gov)

### CATHY BAKER-ECLIPSE

INTERIM COMMISSIONER

[cathy.baker-eclipse@boston.gov](mailto:cathy.baker-eclipse@boston.gov)

### CHRIS OSGOOD

DIRECTOR, OFFICE OF CLIMATE RESILIENCE

[chris.osgood@boston.gov](mailto:chris.osgood@boston.gov)

### MY'KEL MCMILLEN

COMMUNITY ENGAGEMENT COORDINATOR

[corey.mcmillen@boston.gov](mailto:corey.mcmillen@boston.gov)

### LYDIA POLASKI

NEIGHBORHOOD LIAISON SOUTH BOSTON

[lydia.polaski@boston.gov](mailto:lydia.polaski@boston.gov)

### MARK MCGONAGLE

DEPUTY DIRECTOR, COMMUNITY ENGAGEMENT

[mark.mcgonagle@boston.gov](mailto:mark.mcgonagle@boston.gov)

### CHARLIE CONNORS

RECREATION, PROGRAM MANAGER

[charles.conners@boston.gov](mailto:charles.conners@boston.gov)

## DESIGN TEAM

---



SSOLS

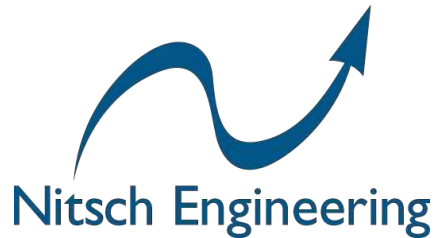

JLP+D

# COMMUNITY ADVISORY TEAM

---

1. Arthur Fritch
2. Clerk Michael Donovan
3. Greg Lally
4. Kevin Lally
5. Tom Tinlin
6. Kim Matthews
7. Pattie McCormick, Andrew Square Civic
8. Mercy Robinson, SBEA
9. Kathy Lafferty, SBNH
10. Ginger DeShaney, Southie Trees
11. Joe Christino, Little League
12. Buddy Lane, Seniors' Babe Ruth
13. Erin Brogan, Lacrosse

14. Michele Farquharson, Volo
15. Phyllis Corbitt, Old Colony Tenant Task Force
16. Orlando Perilla, Harbor Point Community Task Force
17. George Benner, Community Garden
18. Katie Burke, SB MOMS Club
19. Kerri McGrath, Colin's Joy Project
20. Milly Pena, Tierney Learning Center
21. Euridio Evora, Boston Collegiate Charter
22. Jaye Meakem, Boston Harbor Now
23. Sarah White, DCR

# PROJECT GOALS

---

**PROVIDE SAFE & EQUITABLE ACCESS TO:**  
OPEN SPACE, BOSTON'S WATERFRONT, COMMUNITY RESOURCES, ATHLETICS, + EVENTS  
FOR ALL AGES, ABILITIES, & BACKGROUNDS

## RECREATION & PLAY

### **FOSTER A HIGHLY ENGAGING & ACTIVE LANDSCAPE THROUGH:**

- HIGH-QUALITY SPORTS FIELDS
- MULTI-FUNCTIONAL FACILITIES
- DYNAMIC PLAY ENVIRONMENTS THROUGHOUT THE PARK

## PUBLIC HEALTH & COMMUNITY WELL-BEING

### **DEVELOP COMMUNITY-CENTERED PROGRAMMING THAT WILL STRENGTHEN PHYSICAL WELLNESS, ENVIRONMENTAL HEALTH, & SOCIAL CONNECTION BY PROVIDING:**

- SAFE, WALKABLE CONNECTIONS TO THE PARK & BEACH
- LARGE & SMALL COMMUNITY GATHERING SPACES
- AMENITIES THAT ENCOURAGE AN ACTIVE LIFESTYLE

## RESILIENCY & THE ENVIRONMENT

### **CREATE A SAFE & CLIMATE-RESILIENT PARK BY IMPLEMENTING STRATEGIES THAT WILL PROMOTE:**

- COASTAL & STORMWATER FLOODING MANAGEMENT FOR CURRENT & FUTURE CONDITIONS
- URBAN HEAT ISLAND REDUCTION
- BIODIVERSE HABITATS
- SUSTAINABLE PRACTICES IN OPERATIONS & ACCESS



# A COMMUNITY INFORMED PLAN

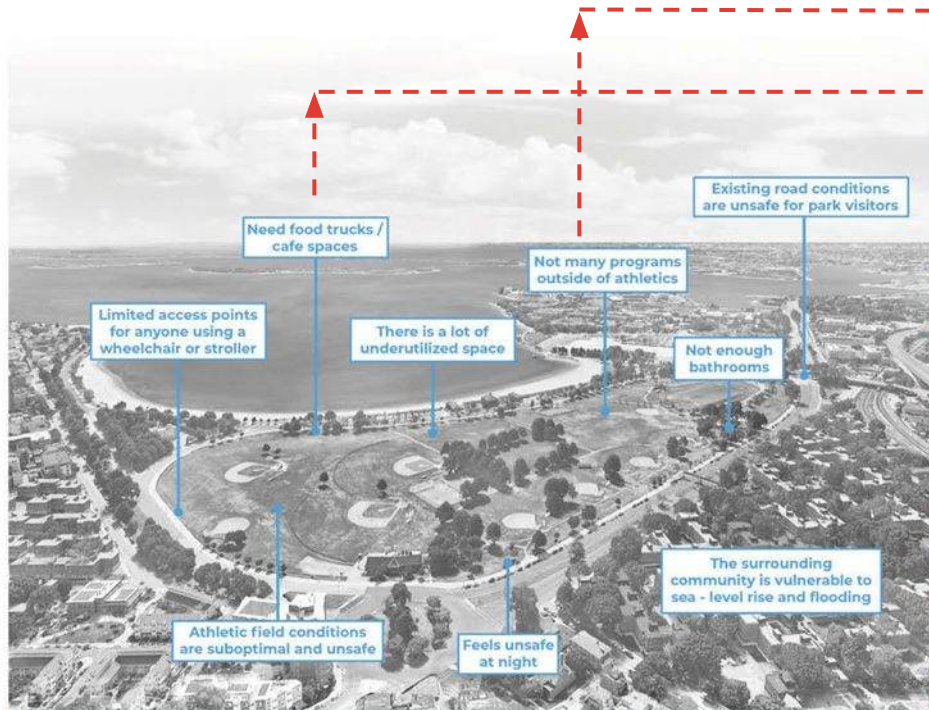

EXISTING MOAKLEY PARK FEEDBACK

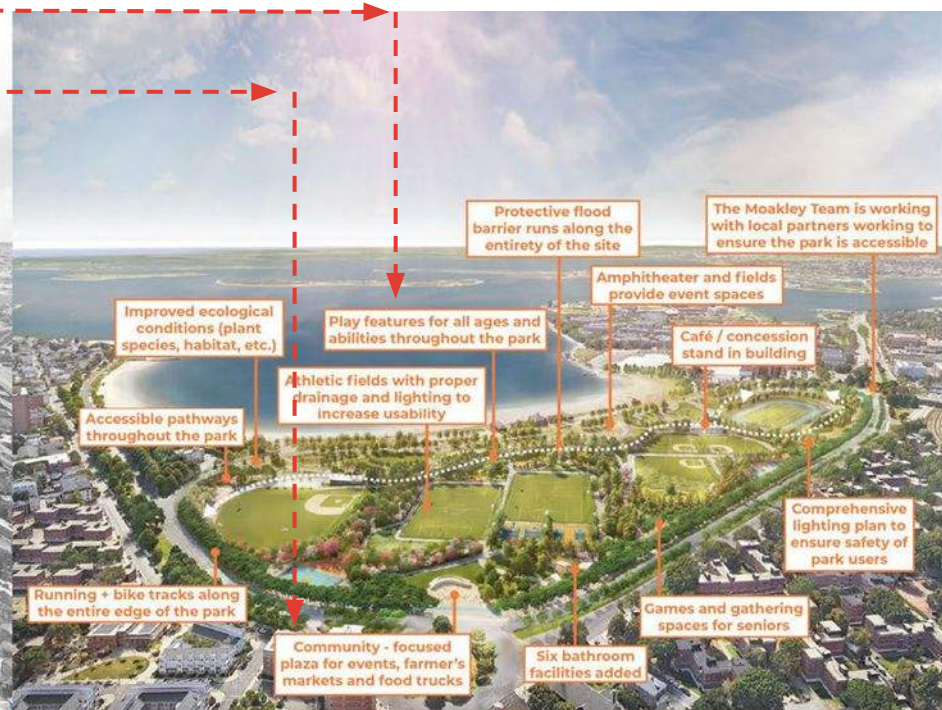

PRELIMINARY PLAN RESPONSE



# A COMMUNITY INFORMED PLAN

---



# MOAKLEY PARK INTERACTIVE STATIONS

---

M STREET  
ENTRANCE

WE ARE HERE!

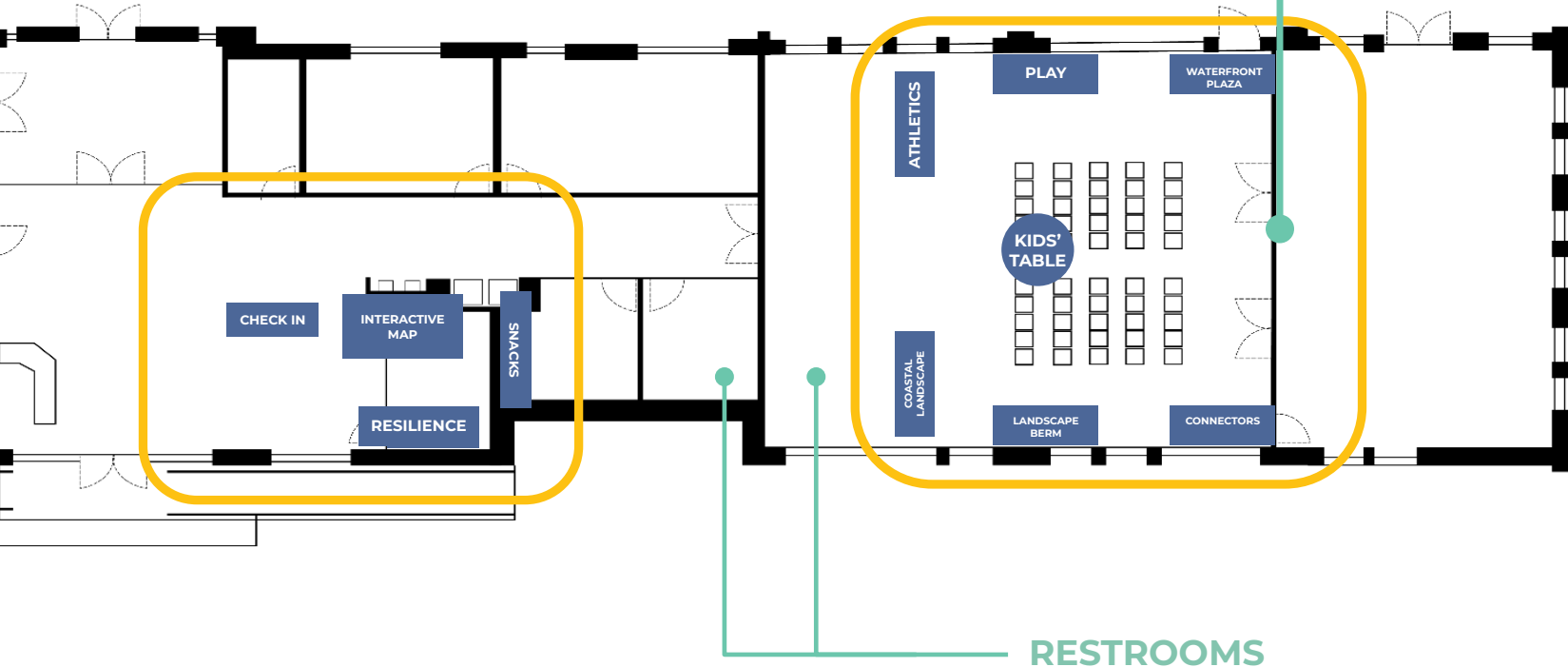



# MOAKLEY PARK INTERACTIVE STATIONS

---



PLAY



GATHERING



RESILIENCE



ATHLETICS

# MOAKLEY PARK INTERACTIVE STATIONS

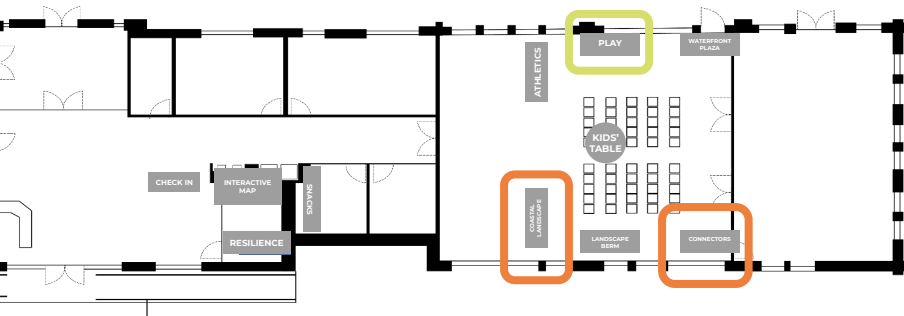

## PLAY & PLAYGROUNDS

It's important that there be features + spaces for different ages + abilities

We like play structures that incorporate natural elements and tie into the landscape

We have concerns about proper maintenance of play features

We'd like to see play features that are distinct from what already exists in South Boston



## GATHERING & COMMUNITY SPACE

There is a real lack of farmers markets in SB and I'm really excited about having one in the park

A cafe and/or food truck space in the park could be an opportunity for local restaurants,, organizations, + entrepreneurs

Love the idea of picnic tables + spaces for games (chess, bingo, checkers)

# MOAKLEY PARK INTERACTIVE STATIONS

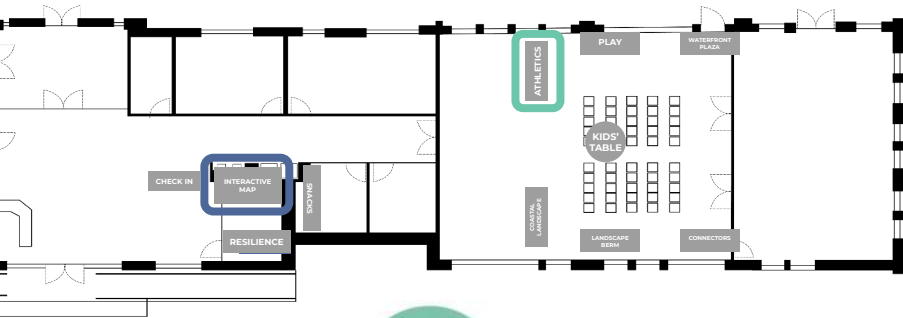

## ATHLETICS

Having pickleball and tennis near each other fosters great intergenerational relationships

The tennis courts are well-loved now- can we add more for the future Moakley Park?

Please build a skate park on Day Blvd side near the police station! Accessible by T. Noise not an issue!

New lighting would allow us to play for longer; right now have to rely on the sun



## ACCESS & AMENITIES

I'd like to see concessions with clean bathrooms

I hope they put in a water feature, preferably a pool. Like surrounding towns have and if not a pool, and actual working splash pad

How can we have pollinators throughout the park?

The park sidewalks are not well maintained and at parts feel unsafe, especially for the elderly



# WHY MOAKLEY CONDITIONS TODAY

---

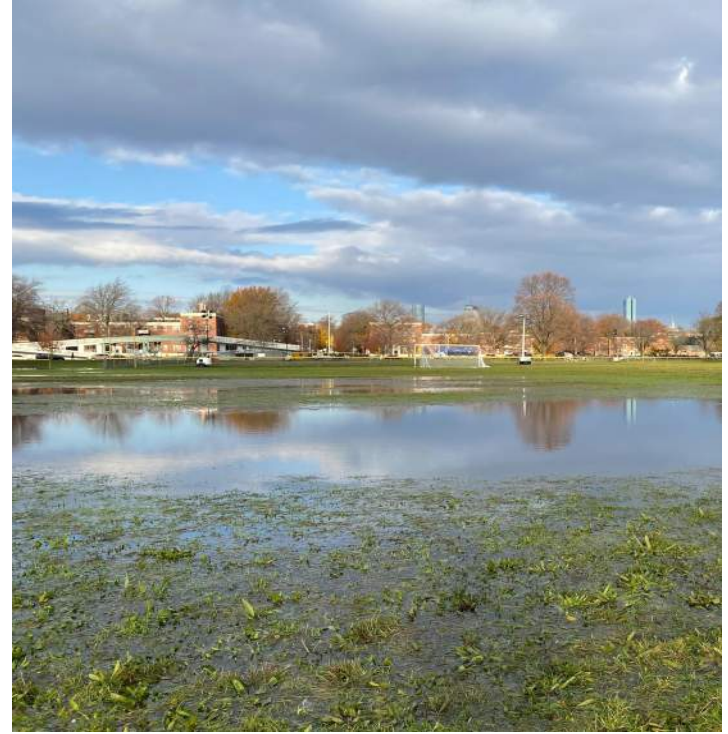

## EXISTING FIELD CONDITIONS



FREQUENTLY FLOODED FIELD



ILLUMINATED FIELDS / COURTS



FIELDS REQUIRING IMPROVEMENT

## WHAT WE HEARD FIELDS THAT STAY DRY





# WHY MOAKLEY CONDITIONS TODAY

---

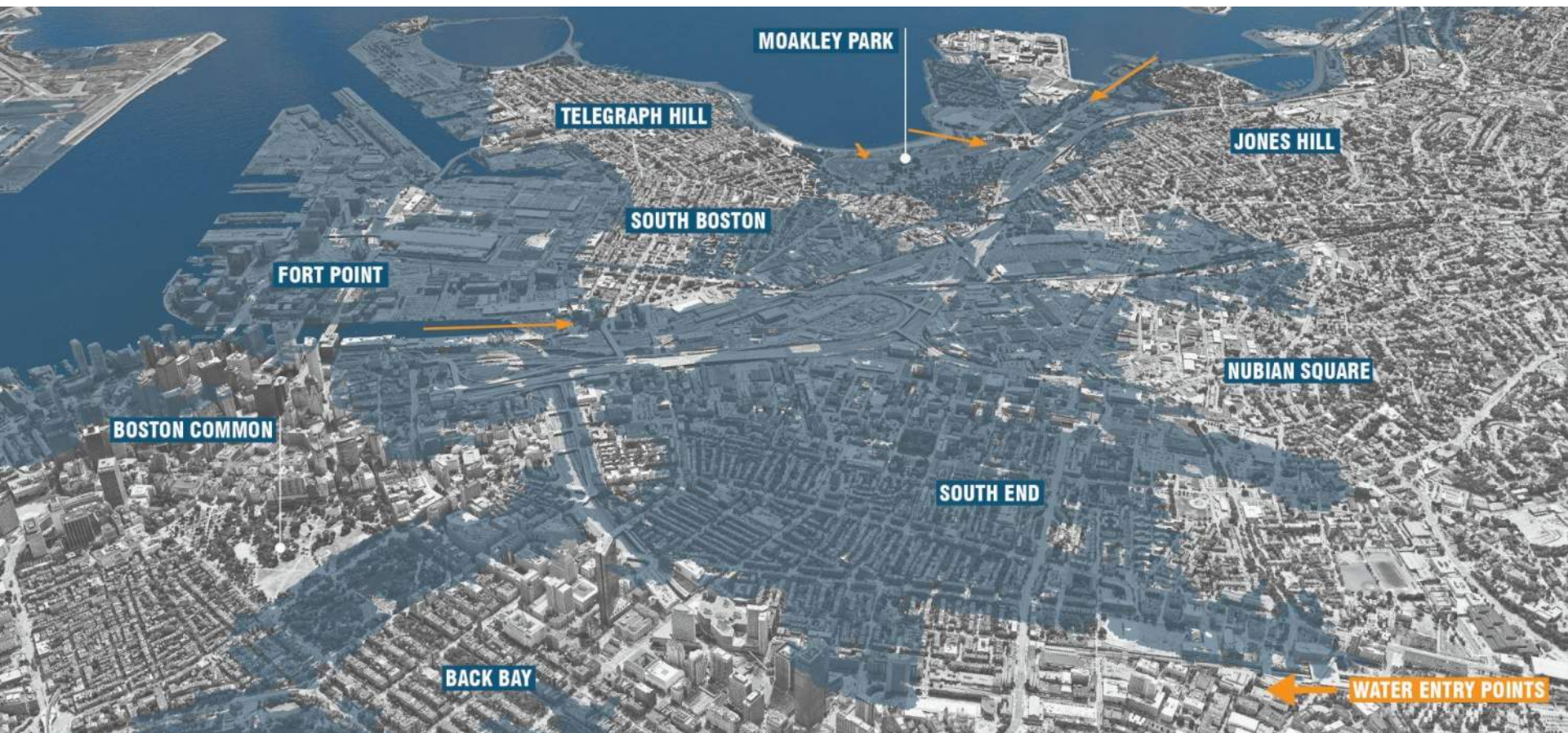

# MOAKLEY PARK APPROACH

---

## FLOOD WALL



Scituate, MA



Nantasket, MA



Sunbury, PA

## FLOOD PROTECTION INTEGRATED INTO PARK LANDSCAPE



Calgary, AB Canada



Atlanta, GA



# MOAKLEY PARK PROJECT TIMELINE

---

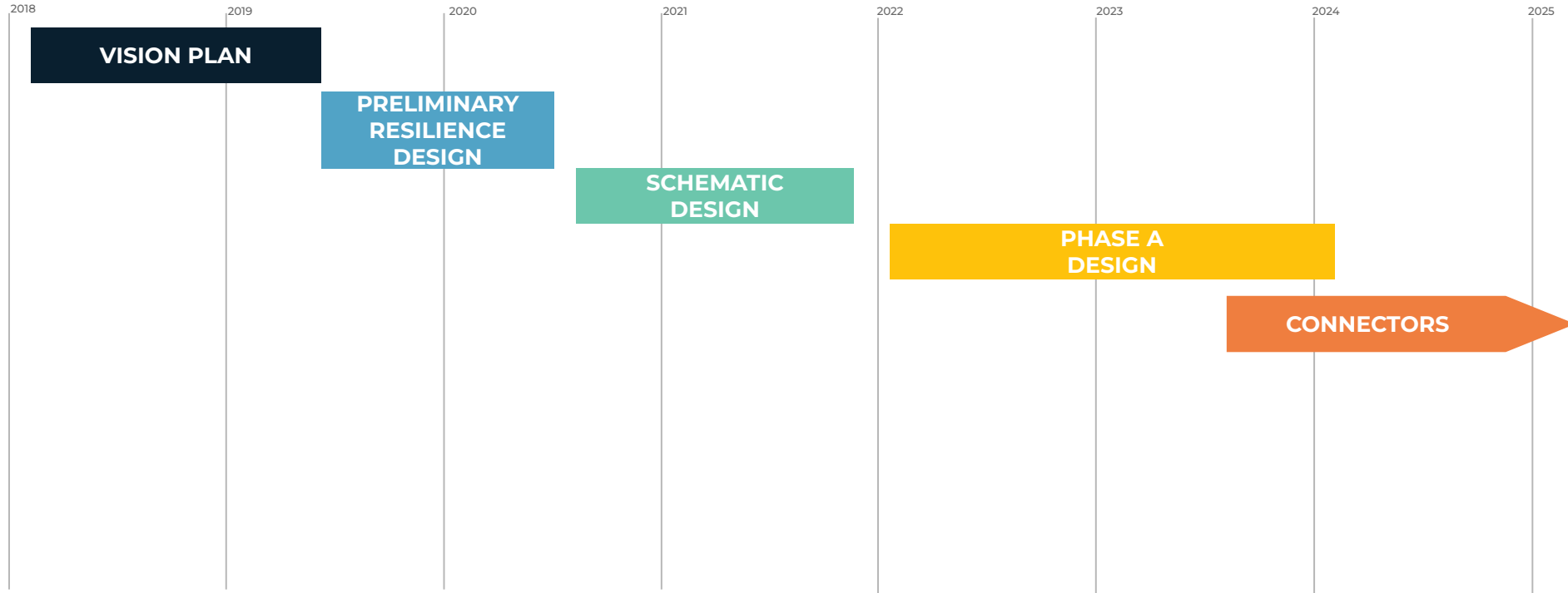



# COMMUNITY ENGAGEMENT 2018-2021

## VISION PLAN PHASE



ONE-ON-ONE INTERVIEWS



COMMUNITY ADVISORY GROUP



ON-SITE EVENTS



ON-SITE BIKE TOUR

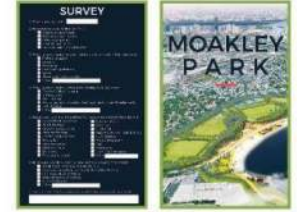

PHYSICAL SURVEY

## PRELIMINARY PHASE



KIDS COLORING SHEETS



MOAKLEY TRAILER

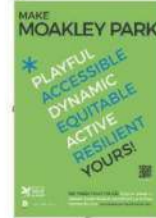

BUS CAMPAIGN



NEIGHBORHOOD EVENTS



HARBOR TOUR

## CURRENT PHASE



DIGITAL CAMPAIGN



ON-SITE SIGNAGE



ONLINE SURVEY

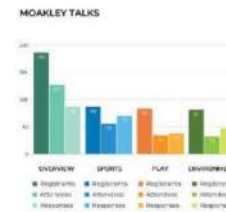

ONLINE OPEN HOUSE



FOCUS GROUP MEETINGS

# BERM REALIGNMENT STUDY PREVIOUS WORK

---

**2018**

VISION PLAN ALIGNMENT + UTILITIES

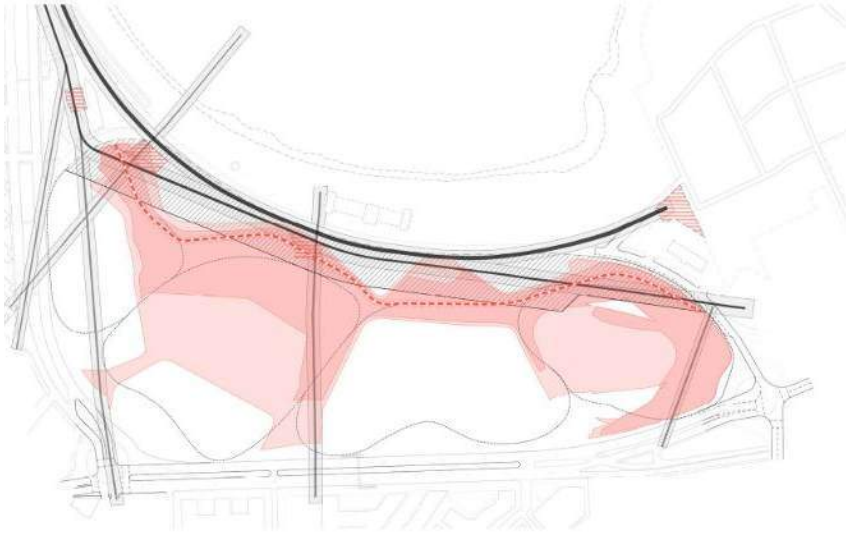

**2020**

REVISED ALIGNMENT + UTILITIES

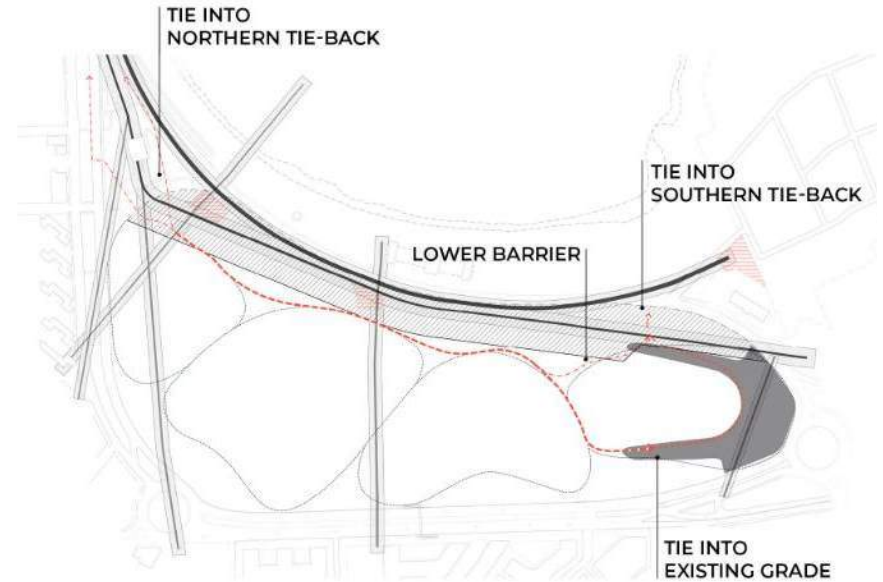



A photograph of three children playing on a colorful rocking horse in a park. The child on the left is a girl with blonde hair, wearing a white shirt and pink pants. The child in the middle is a girl with brown hair, wearing a red beanie with a pom-pom and a light blue jacket. The child on the right is a boy wearing a dark hooded jacket. They are all smiling and looking towards the camera. The background shows other people and trees in a park setting. The entire image has a blue tint.

**WHERE ARE WE GOING  
NEXT?**

# MOAKLEY PARK UPCOMING WORK

---

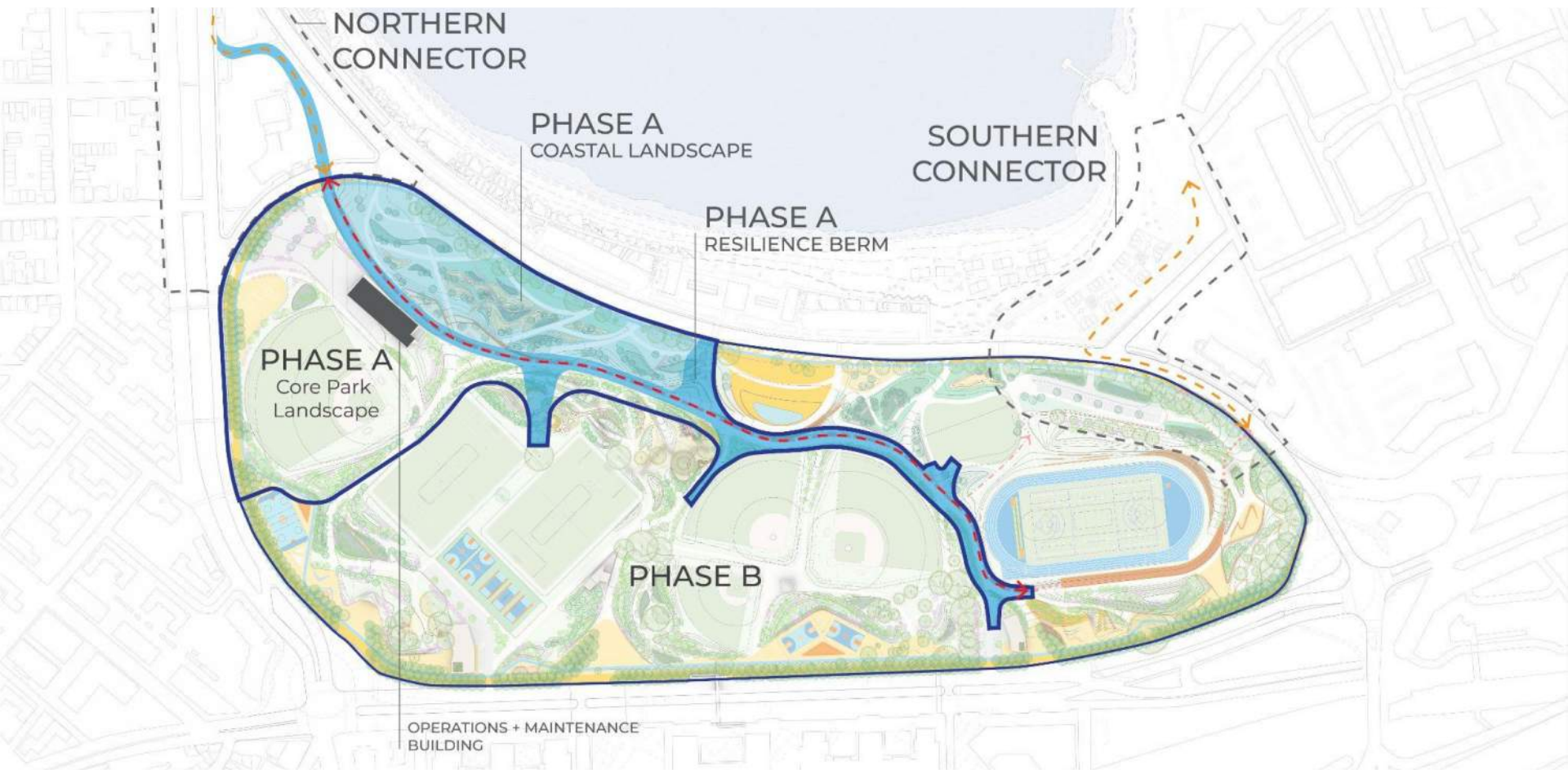

# MOAKLEY PARK NEXT PHASES OF DESIGN + CONSTRUCTION

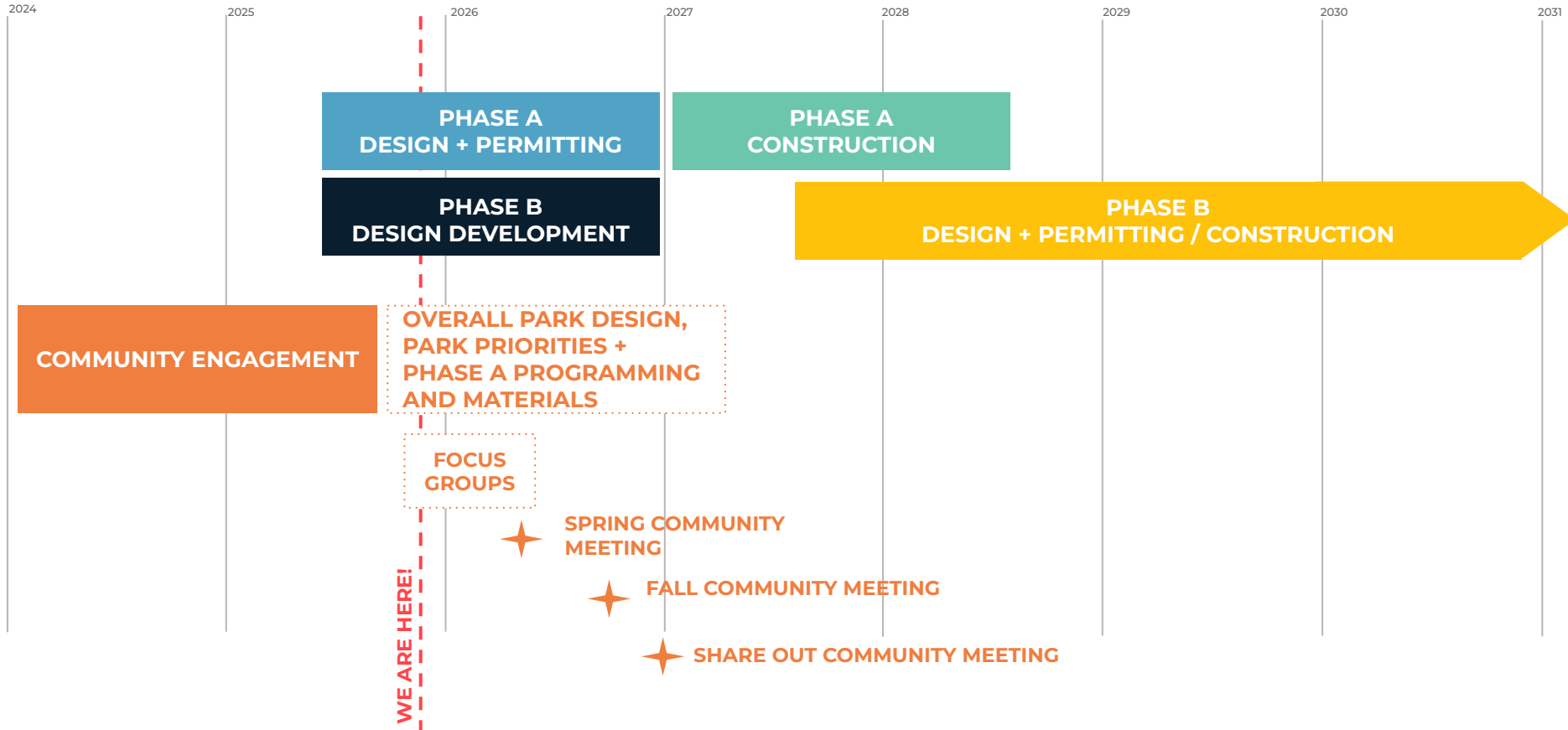



# MOAKLEY PARK PHASE A

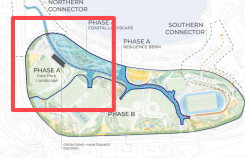

PREMIERE  
MULTI-USE FIELD



COMMUNITY PATH +  
RUNNING TRACK



COASTAL LANDSCAPE +  
NATURE PATHS



OLD HARBOR OVERLOOK /  
BBQ + PICNIC

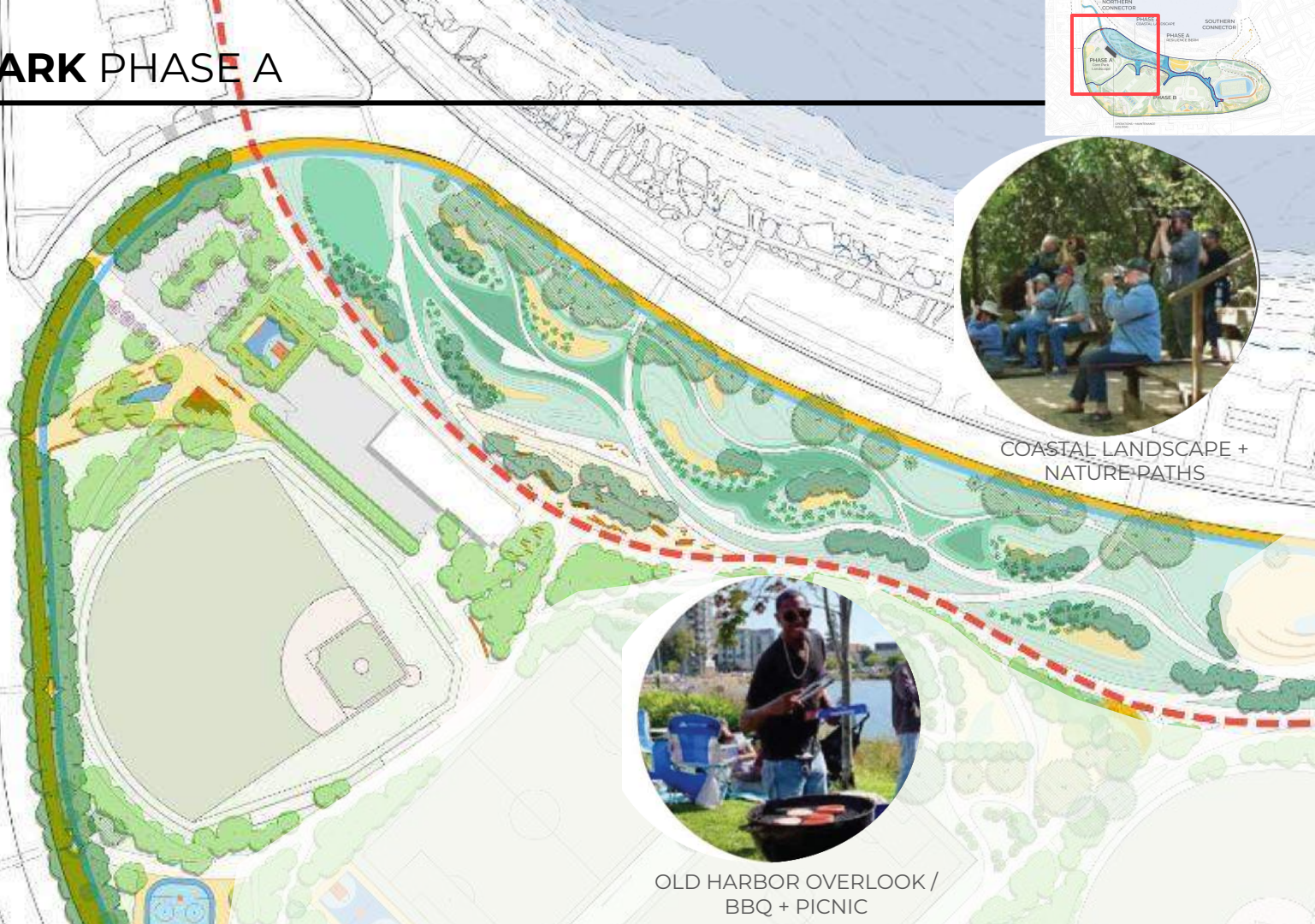



# MOAKLEY PARK PHASE B

PHASE A

NATURE PLAYGROUND

WATERFRONT PLAZA

DAY BOULEVARD

IMPROVED SPORTS  
COURTS + FIELDS

COMMUNITY SPACES





# PARKS MANAGEMENT STUDY



# COMMUNITY ENGAGEMENT 2022-2025

PARK ACTIVATION + STEWARDSHIP + PHASE A



# PARKS MANAGEMENT STUDY

---

## We want your input on a suitable parks management model for Moakley Park

We've identified three parks management models that can help ensure the financial and operational sustainability of Moakley Park now and into the future.



Public responsibility

The diagram consists of two horizontal, rounded, teardrop-shaped bars. The top bar is blue and tapers from left to right, containing the text 'Public responsibility'. The bottom bar is a lighter blue-grey and tapers from right to left, containing the text 'Nonprofit responsibility'. These bars are positioned above three columns of text, which represent different management models along this spectrum.

Nonprofit responsibility

**City-Led with  
“Friends of” Group(s)**

Est. by: Grassroots

**City-Nonprofit(s)  
Partnership**

Est. by: Contract  
Agreement

**Dedicated Nonprofit  
with  
City Oversight**

Est. by: Legislation



# MOAKLEY PARK OVERVIEW

## BEFORE + AFTER

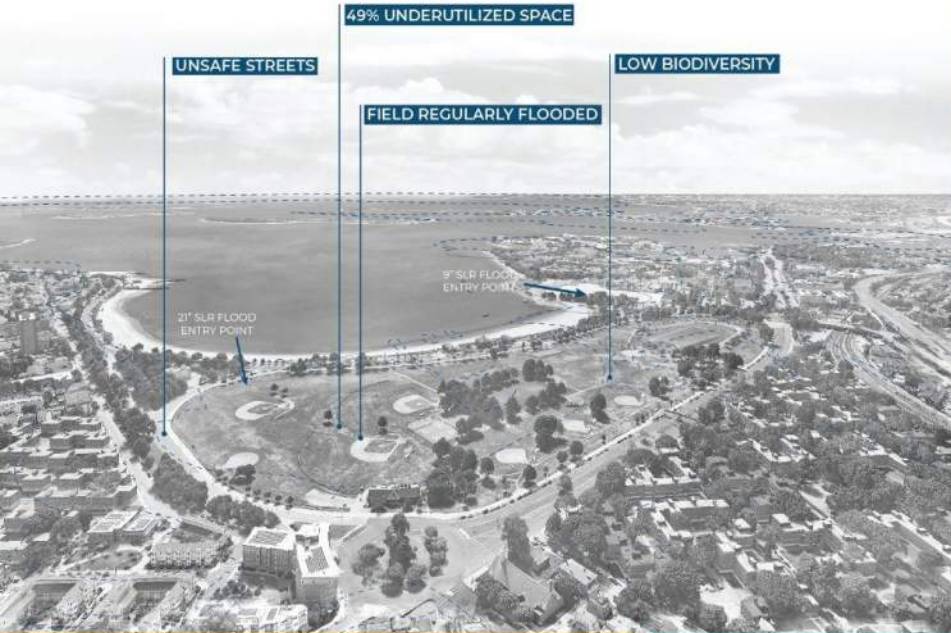

ACCESSIBILITY + SAFETY

PUBLIC HEALTH + COMMUNITY

RESILIENCY + BIODIVERSITY

INCLUSION