



Mayor Michelle Wu's

# GARDEN CONTEST



A citywide celebration of urban gardening.

Entry Deadline: Wednesday, July 8, 2026  
 Judges Visit Gardens: Week of July 27th  
 Awards Ceremony: Late August

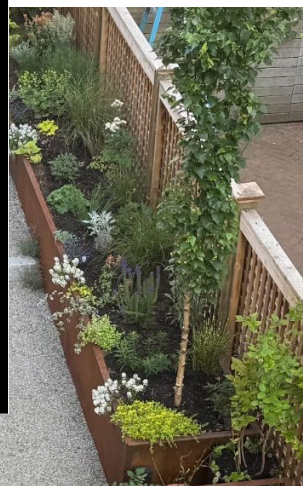

**CITY of BOSTON**      [boston.gov/garden-contest](https://boston.gov/garden-contest)       Parks and Recreation

**CATEGORIES (Check only ONE)**

- Porch, Balcony, or Container Garden
- Shade Garden
- Small Yard Garden (250 sq. ft. or less)
- Medium Yard Garden (250 - 500 sq. ft.)
- Large Yard Garden (larger than 500 sq. ft.)
- Community Garden (individual plot)
- Vegetable or Herb Garden
- Age Strong Garden Category (Senior 65 & older)
- Storefront, Organization, or Main Street District Garden
- Pollinator Garden

Gardener's Name: \_\_\_\_\_

Organization: \_\_\_\_\_

Address: \_\_\_\_\_

Neighborhood: \_\_\_\_\_ Zip: \_\_\_\_\_

Phone #: \_\_\_\_\_

Email Address: \_\_\_\_\_

Garden Address if different than above: \_\_\_\_\_

**JUDGING CRITERIA:**

- General appeal and neatness
- Natural or formal layout
- Use of color
- Plant material
- Variety & quality of plants
- Sustainable features & methods used
- Garden hardware, furnishings & art

*We prefer applications submitted online.*  
**Questions? [GardenContest@Boston.gov](mailto:GardenContest@Boston.gov)**

**\*\*MUST BE A BOSTON RESIDENT  
 AMATEUR GARDENERS ONLY  
 CITY OF BOSTON EMPLOYEES AND THEIR IMMEDIATE  
 FAMILY ARE NOT ELIGIBLE**

**SPONSORED BY:**



Completed applications with photos can be mailed to:  
 Garden Contest - 3rd Floor  
 1010 Massachusetts Ave.  
 Boston, MA 02118