

BOSTON, MASSACHUSETTS

133-135 Stuart Street

APCC Parking
Permit Application

Prepared for
City of Boston

Prepared by
Howard Stein Hudson

May 2026



HOWARD STEIN HUDSON

Engineers + Planners



May 18, 2026

Boston Air Pollution Control Commission
c/o Environment Department
26 Court Street, Floor 4
Boston, MA 02108

Email: apcc@boston.gov
Attn: Alice Brown and Alyssa Farkas

**Re: 133-135 Stuart Street, Boston, Massachusetts
APCC Parking Permit Application for Permit Modification**

To Whom it May Concern,

Enclosed please find the Application of THEATRE DISTRICT LLC (the Applicant) to the City of Boston Air Pollution Control Commission (APCC) for a modification to APCC South Boston Parking Freeze Permit No. APCC453676, in connection with a request for additional spaces within the Boston Proper Freeze Zone. The Site is currently permitted for 275 commercial spaces with additional exempt spaces for fleet vehicles. The Applicant requests to convert all existing except spaces to commercial, an additional 70 spaces (345 total), to meet the demands of current garage operations. The Permit Application retains the existing parking configuration and site access. The Site has no ongoing or expected review by other City agencies.

As further detailed in the enclosed materials, the Applicant seeks the APCC's approval of a modified South Boston Parking Freeze Permit. In support of this application, we provide the following Exhibits:

- A. APCC Permit Application
- B. Statement of Need
- C. Proof of Ownership
- D. Location of Facility
- E. Site Plan and Parking Level Layouts
- F. Abutters List (within 300 feet of Facility)

We respectfully request to be included on the agenda for the next scheduled APCC meeting on June 17, 2026. Hardcopies of the enclosed materials, together with a Joint Staff Report will be submitted not less than two (2) weeks before the anticipated hearing date.



If you have any questions about this matter, please do not hesitate to contact me if any additional information is required.

Sincerely,

Ian McKinnon, P.E., PTOE, RSP
Associate Principal

Cc: Alejandro Miranda, Boylston Properties



HOWARD STEIN HUDSON

Engineers + Planners

Appendix A

APCC Permit Application



A. GENERAL APPLICATION INFORMATION

1. Project Location

133-135 Stuart Street a. Street Address	Boston b. City/Town	02116 c. Zip Code
1A f. Assessors Map/Plat Number	0500010000, 0500010001 g. Parcel/Lot Number	

2. Applicant

Alejandro a. First Name	Miranda b. Last Name	Boylston Properties c. Company	
800 Boylston Street, Suite 1390 d. Mailing Address			
Boston e. City/Town		MA f. State	02199 g. Zip Code
617-262-4646 h. Phone Number		amiranda@boylprop.com j. Email address	
	i. Fax Number		

3. Property Owner

		Theatre District LLC c. Company	
800 Boylston Street, Suite 1390 d. Mailing Address			
Boston e. City/Town			02199 g. Zip Code
617-262-4646 h. Phone Number			
	i. Fax Number	j. Email address	

Check if more than one owner:

(If there is more than one property owner, please attach a list of these property owners to this form.)



4. Representative (if any)

Ian a. First Name	McKinnon b. Last Name	Howard Stein Hudson c. Company	
11 Beacon Street, Suite 1010 d. Mailing Address			
Boston e. City/Town		MA f. State	02199 g. Zip Code
617-348-3341 h. Phone Number		imckinnon@hshassoc.com j. Email address	

5. What kind of application is being filed?

- Request a New Parking Freeze Permit or Exemption Certification
- Modify an existing Parking Freeze Permit or Exemption Certification

6. Which Parking Freeze is your facility located in

- Downtown Boston
- South Boston

B. PARKING FACILITY INFORMATION

1. Applicant

Downtown Boston		South Boston	
Commercial Spaces	345	Commercial Spaces	
Exempt Spaces		Residential Included Spaces	
Residential Excluded Spaces		Residential Excluded Spaces	

2. Do you currently or will you charge for parking?

- Yes
- No
- Not sure

3. What is your current or proposed parking method and facility type? (select all that apply)

- Valet
- Surface Lot
- Self-Parking
- Garage



4. Is your project compliant with the City's Bicycle Parking Guidelines?

Number of Long-Term Bicycle Spaces: 36	Number of Showers: 4
Number of Short-Term Bicycle Spaces: 12	Bikeshare Station Size and Contribution: n/a
Number of Lockers: 59	Other Amenities (Please List):

5. Is your project compliant with the City's Electric Vehicle Readiness Policy?

EVSE-Installed Points: A 7	Total number of spaces: C 275
EV-Ready Points: B 0	Does A + B = C ? <input type="checkbox"/> Yes <input checked="" type="checkbox"/> No

Note: Please attach the Electric Vehicle Equivalency Calculator to this application, available at www.boston.gov/recharge-boston.

6. Please fill out the information below:

Total Number of Proposed Spaces: 345	Total Parking Facility Square Footage:
Number of New Spaces: 70	Ratio of Residential Spaces to Units: n/a
Number of Existing Spaces: 275	(Optional) Number of Spaces Returned: n/a

7. Please list the total facility square footage by use type:

Residential Sqft: n/a	Retail Sqft: 48,656
Office/Admin Sqft: 711,795	Institutional Sqft: n/a
Industrial Sqft: n/a	Lodging Sqft: n/a

8. Are you required to execute a Transportation Access Plan Agreement (TAPA)?

Yes No

(If yes, please attach the draft or final TAPA to this form if available.)



C. SIGNATURES AND SUBMITTAL REQUIREMENTS

I hereby certify under the penalties of perjury that the foregoing Notice of Intent and accompanying plans, documents, and supporting data are true and complete to the best of my knowledge. I understand that the Applicant will place notification of this Application in a local newspaper at the expense of the applicant in accordance with the Procedures and Criteria for the Issuance of Parking Freeze Permits.

Alejandro Miranda

Digitally signed by Alejandro Miranda
DN: C=US, E=amiranda@boylprop.com, O=Boylston
Properties, CN=Alejandro Miranda
Date: 2026.05.18 13:54:09-04'00'

5/18/26

Signature of Applicant

Date

Signature of Property Owner (if different)

Date

Digitally signed by Ian McKinnon
DN: C=US, E=imckinnon@hshassoc.com, O=Howard Stein Hudson,
OU=Howard Stein Hudson, CN=Ian McKinnon
Reason: I am the author of this document
Date: 2026.05.18 14:41:58-04'00'

5/18/26

Signature of Representative (if any)

Date

D. ADDENDUM: IMPORTANT APPLICATION INFORMATION

PAYMENT

Please include a check or money order made payable to the City of Boston, Air Pollution Control Commission. The fee is \$20 per parking space. Application and renewal fees apply to all locations within the Downtown, East Boston, and South Boston Parking Freeze Zones.

WRITTEN PROOF

Please attach written proof that the applicant is the owner of record or has written approval from the owner of record to file this application.

STATEMENT OF NEED

Please attach a general description of the facility and the parking needs of the project, local entities, and patrons that the proposed facility will serve. Any written support (letters, etc.) that you wish to supply in support of this statement should be attached



SITE PLANS

Please attach a site plan of the parking facility showing:

- location of the facility;
- layout of the spaces;
- entry and exit locations;
- total square footage of the parking area;
- location, type and amount of electric vehicle parking;
- location and amount of bicycle parking and bicycle facilities.

OTHER APPLICABLE REVIEWS

If you are working in a historic district or on a designated landmark, you should consult with the appropriate historic or architectural commission. If you are working in the floodplain or within 100 feet of a wetland, you should consult with the Conservation Commission. Visit boston.gov/landmarks and boston.gov/conservation before starting any work.

WHERE TO SEND

We prefer you complete the digital application using this form. Export the form as a PDF and email your application and supporting documents to APCC@boston.gov. You can also mail your application, documents, and payment to: Air Pollution Control Commission, Boston City Hall, 1 City Hall Square, Room 709, Boston, MA 02201. Please notify us that you have sent an application by mail at APCC@boston.gov.



HOWARD STEIN HUDSON

Engineers + Planners

Appendix B

Statement of Need

133-135 STUART STREET – STATEMENT OF NEED

Parking Freeze Application to Modify Downtown Parking Freeze Permit

Exemption #APCC453676

Theatre District LLC (the “Applicant”), an affiliate of Boylston Properties., is the master lessee for 48,000 square feet of ground floor retail and below grade garage at 133-135 Stuart Street, commonly known as 10 Park Plaza or the State Transportation Building, bordering Charles Street S, Stuart Street, and Tremont Street in the Bay Village neighborhood of Boston (the “Property”). The Property Owner (Massachusetts Department of Transportation - MassDOT) has a long-term ground lease with the Applicant. The Applicant has been issued Downtown Parking Freeze Permit Exemption #APCC453676, which expires on July 1, 2026, for a parking facility at the Property with 275 commercial vehicle parking spaces (as described below, the “Garage”).

The Garage contains 275 commercial vehicle parking spaces, has a single access point on Charles Street South. The Property meets the intentions of the BTD EV Readiness Guidelines and Bike Parking through 7 spaces with Type 2 EVSE installed chargers and, as well as 36 long-term/employee bicycle parking spaces with access to two locker rooms, 4 showers and 59 lockers. In addition, 12 visitor bicycle parking spaces in six racks are provided around the Site. The Garage specifics are further shown on the enclosed Site Plan and Parking Level Plans.

The Garage is integrated within, and located directly below, the State Transportation Building, eight story office and retail building. The office floors two through eight are fully occupied by State Agency Office including MassDOT-including Highway, Rail, Aeronautics, Office of Diversity and Civil Rights, General Counsel-, Massachusetts Bay Transportation Authority (MBTA), Department of Conservation and Recreation (DCR), Boston Region Metropolitan Planning Organization and executive offices for the Secretary of Transportation . The Garage is generally self-park with a small valet component to allow for surge of capacity during week workdays.

The number of vehicle parking spaces in the garage was originally approved by the Commission via letter dated February 24, 1978, issued by the Acting Executive Director. That approval included 275 commercial parking spaces and 100 fleet vehicle spaces. Since that time, the operational needs of the Commonwealth’s office space have evolved, and the Executive Office of Transportation and MassHighway (the predecessor to MassDOT) have continuously occupied space at the property.

In 1985, a letter from EOT’s General Counsel indicated that the garage could accommodate up to 340 vehicles, including 124 spaces reserved for the motor pool and 33 reserved spaces. Subsequently, a 1994 letter from the APCC Executive Director approved the facility for up to 375 spaces, including 18 spaces associated with a rental car function.

More recently, the garage underwent a major rehabilitation in 2022 that included structural repairs, ventilation upgrades, parking system improvements, EVSE installation, and restriping.

Through this Parking Freeze application, the Applicant requests to modify the existing Downtown Parking Freeze Permit to increase the number of commercial parking spaces from 275 to 345 to reflect current garage operations. This modification would formalize fleet vehicle spaces that were previously not included in the permit space count but have generally been considered exempt under the Downtown Boston Parking Freeze Regulations. Given changes in the use of the facility, the request seeks to classify all spaces as commercial to provide flexibility as the Commonwealth's state agency office needs continue to evolve. The intent is to continue supporting general commercial parking needs, including evening and weekend demand associated with the adjacent Theatre District.

For these reasons, approval of this application is respectfully requested. Thank you for your consideration.



HOWARD STEIN HUDSON

Engineers + Planners

Appendix C

Proof of Ownership

SUFFOLK COUNTY, MASSACHUSETTS
REGISTERED DEEDS

NOTICE OF MASTER LEASE

SEP 31 10 49 AM '85

NOTICE IS HEREBY GIVEN, pursuant to the provisions of Chapter 183, Section 4 of the General Laws of Massachusetts, of the below described Lease:

PARTIES TO LEASE:

LANDLORD: THE COMMONWEALTH OF MASSACHUSETTS

TENANT: THE THEATRE DISTRICT LIMITED PARTNERSHIP,
a Massachusetts limited partnership.

DATE OF EXECUTION: September 12, 1985

PREMISES:

The following portions of the Massachusetts Transportation Building (the "Building") situated at Charles Street South and Stuart and Tremont Streets in Boston, Massachusetts, situated on the parcel of land (the "Land") described on Exhibit B hereto.

- (i) the portion of the first floor of the Building so labeled and identified on Exhibit A hereto;
- (ii) the portion of the second floor of the Building labeled and identified on Exhibit A as the "Building Food Service Area", unless and to the extent the same is removed from the Premises as provided in the Lease;
- (iii) to the extent (and as long as) the same is a part of the Premises pursuant to the Lease, the portion of the second floor labeled and identified on Exhibit A as the "Second Floor Option Premises"
- (iv) the portion of the Building labeled and identified on Exhibit A as the "Food Court".

together with the Collateral Rights described in Schedule C hereto.

See
12586
036
See
13106
322

11928 160

TERM: The period commencing on September 12, 1985 and ending on January 31, 2021, subject to the options to extend described below.

OPTIONS TO EXTEND OR RENEW

Tenant has two (2) options to extend the term for two consecutive periods of ten (10) years each, and, subject to the provisions of the Lease, certain holders of a leasehold mortgage on the Tenant's interest under the Lease have the right to extend the term for an additional period of five (5) years.

OTHER PROVISIONS

The Lease also contains the following provisions:

Notwithstanding the bankruptcy of Landlord and any rejection of the Lease, any Permitted Leasehold Mortgage (i.e., a mortgage on Tenant's interest in the Lease which qualifies as such under the Lease) shall be deemed to have encumbered, and its rights shall extend to, any continuing rights to possession of the Premises by Tenant which shall retain the same priority as the Permitted Leasehold Mortgage possessed at the time of recording thereof.

In the event of termination of the Lease by reason of certain defaults of Tenant or in the event of the rejection of the Lease in a bankruptcy or insolvency or similar proceeding involving Tenant, Landlord will enter into a new Lease with the holder of a Permitted Leasehold Mortgage on the same terms as the Lease as existed immediately prior to such termination, subject to certain provisions set forth in the Lease. Any such new Lease shall be superior to and shall not be subordinated to any mortgage or other lien or other encumbrance now or hereafter existing on all or any portion of the Building and/or the Land.

For the authority of Landlord to execute and deliver the Lease, see Chapter 240 of the Acts of 1984.

This instrument is executed pursuant to the provisions contained in the Lease and is not intended to vary the terms and provisions thereof.

WITNESS the execution hereof as an instrument under seal as of ~~Sept 12~~, 1985.
September 12

LANDLORD
THE COMMONWEALTH OF MASSACHUSETTS

By [Signature]
Deputy Commissioner, Division
of Capital Planning and Operations

TENANT
THE THEATRE DISTRICT LIMITED PARTNERSHIP

By William P. McQuillan
William P. McQuillan, General Partner

Commonwealth of Massachusetts)
County of Suffolk) ss August 16, 1985

Then personally appeared before me, Tunney Lee, Deputy Commissioner of Capital Planning and Operations of The Commonwealth of Massachusetts, and acknowledged the foregoing instrument to be the free act and deed of The Commonwealth of Massachusetts.

[Signature]
Notary Public
My commission expires:

ROBERT M. SCHLEIN, Notary Public
My Commission Expires Feb, 2, 1990

Commonwealth of Massachusetts)
County of Suffolk) ss

~~September 12, 1985~~
September 12, 1985

Then personally appeared before me William P. McQuillan a General Partner of The Theatre District Limited Partnership and acknowledged the foregoing to be the free act and deed of said limited partnership.

[Signature]
Notary Public
My commission expires:

ROBERT M. SCHLEIN, Notary Public
My Commission Expires Feb, 2, 1990

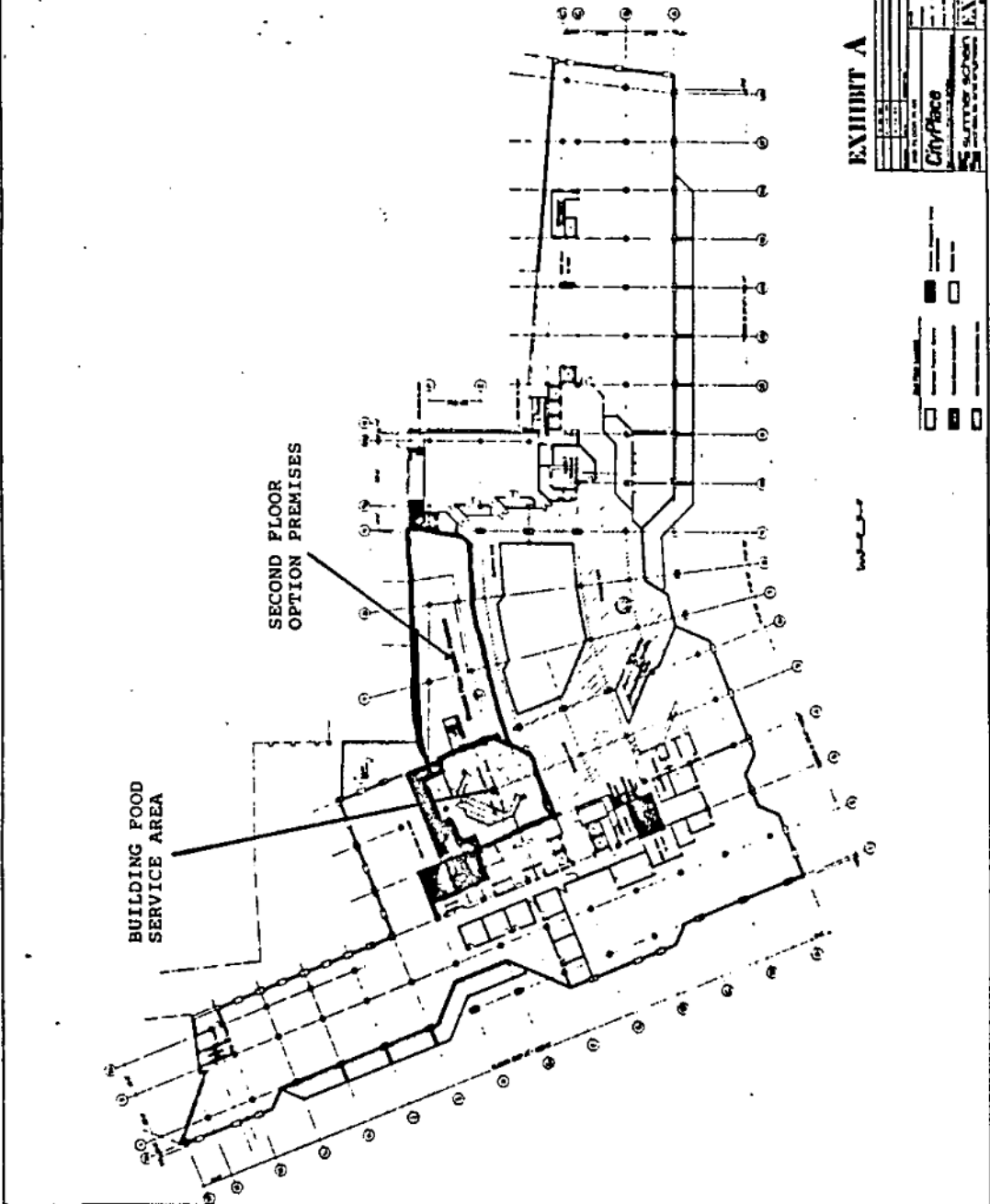

EXHIBIT A

DATE	11/11/11
BY	CityPlace
FOR	SUNNY SCHOOL
SCALE	1/4" = 1'-0"

WALL	---
DOOR	-○-
WINDOW	-□-
COLUMN	○
STAIR	□

11926 164

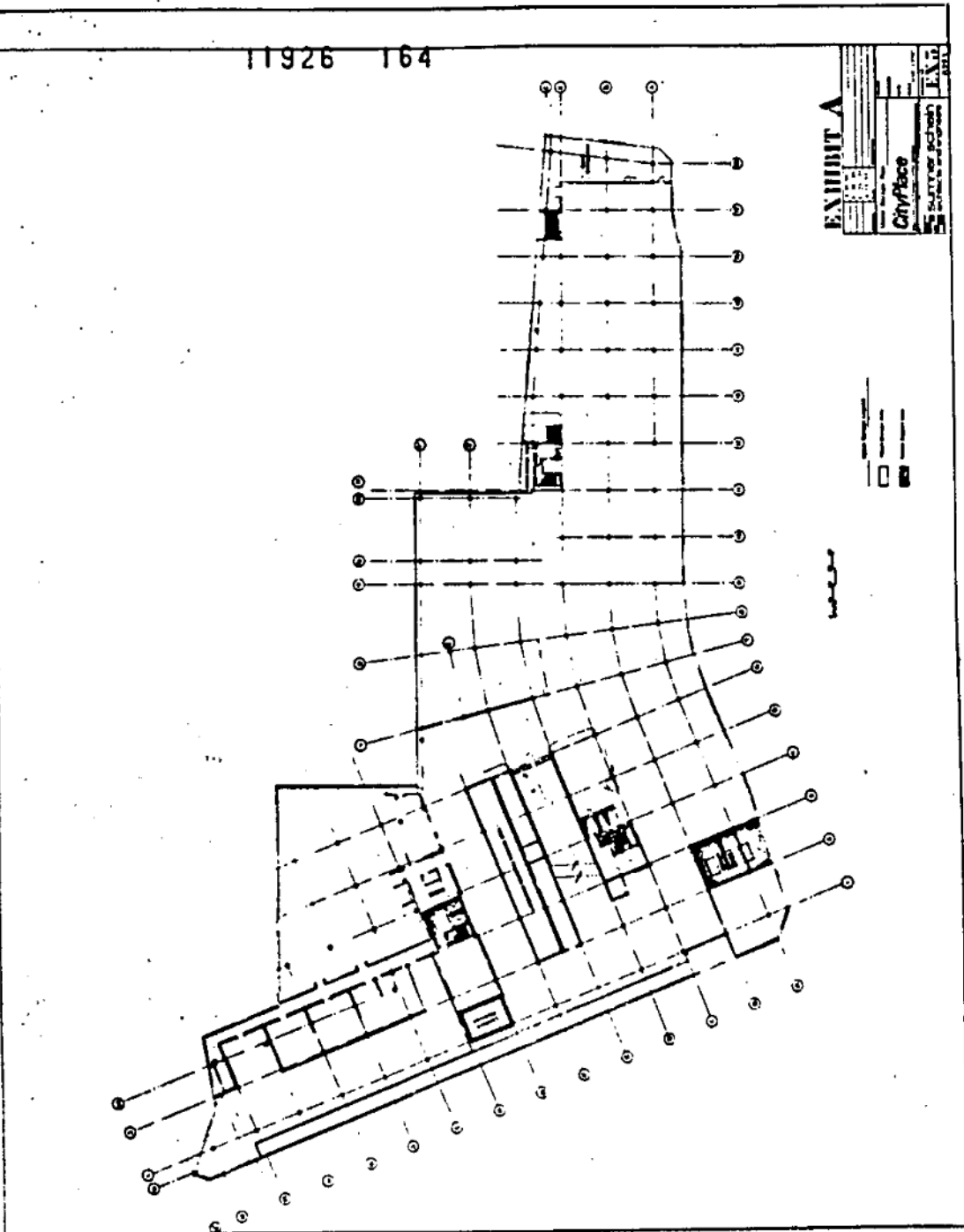

EXHIBIT A

City/Place	LA
Surveyor's Name	...
Scale	...
Date	...

Legend

- Room
- Corridor
- Staircase

Scale

11926 165

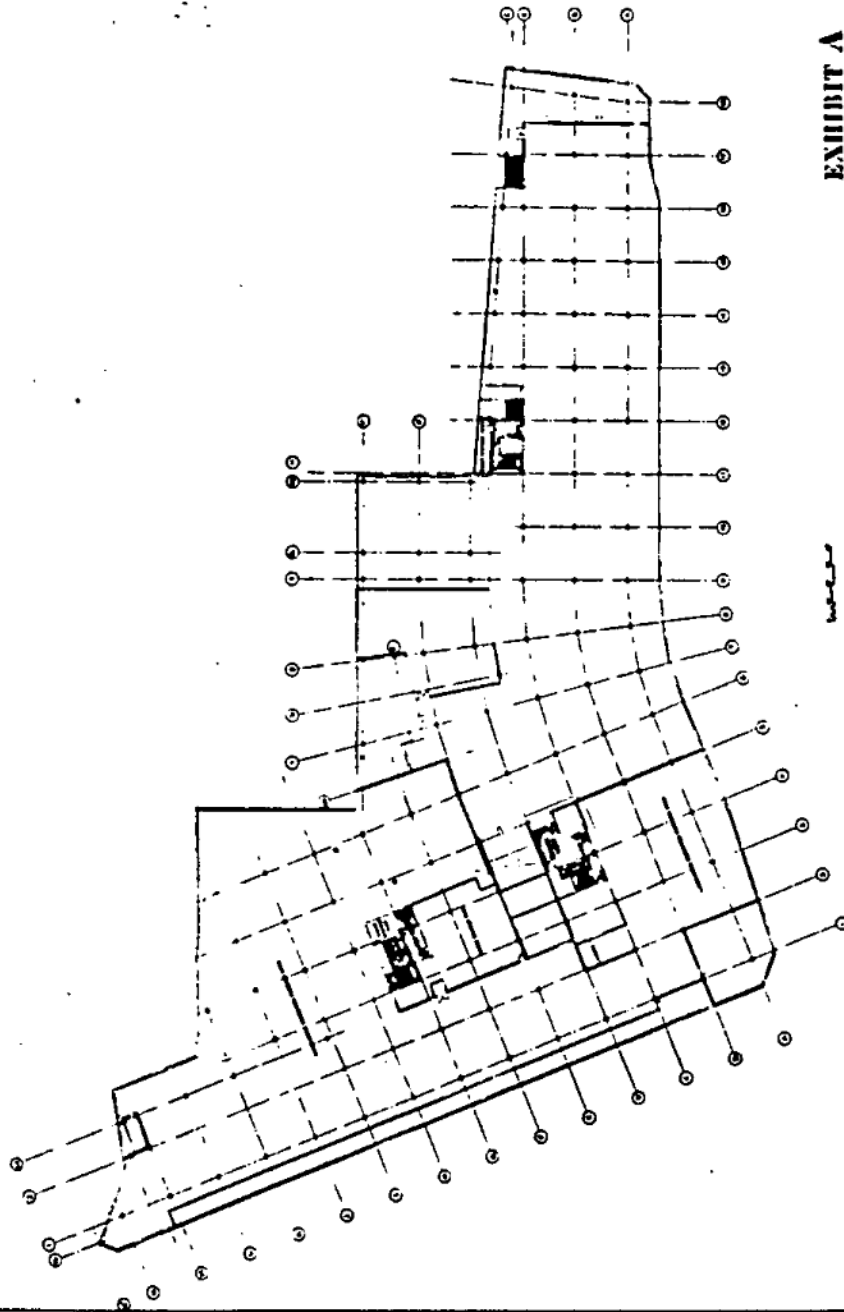

EXHIBIT A

Case No.	11926
Page No.	165
City/State	Chicago, Ill.
Surveyor	John J. Schuchman
Scale	1/4" = 1'-0"
Date	1926

Legend

- Room
- Corridor
- Stair
- Elevator

EXHIBIT B

11926 166

The land in Boston, Suffolk County, Massachusetts, together with all buildings and other improvements thereon situated on Tremont Street, Stuart Street and Charles Street South, shown as "MASSACHUSETTS TRANSPORTATION HEADQUARTERS BUILDING SITE AREA ABOUT 2.64 ACRES" on a plan entitled "The Commonwealth of Massachusetts Plan of Land in the City of Boston, Suffolk County, showing location of the Department of Transportation Building Site" dated October 26, 1983 by Robert J. McDonagh, Chief Engineer, recorded with Suffolk Deeds in Book 10640, Page 159 and bounded and described as follows:

EASTERLY by said Tremont Street fifty-eight and 07/100 (58.07) feet;

SOUTHEASTERLY by a curve of thirty (30) feet radius forming the intersection of said Tremont Street with Stuart Street forty-three and 60/100 (43.60) feet;

SOUTHERLY two hundred forty-five and 31/100 (245.31) feet, SOUTHEASTERLY by a curve of one hundred seventy-eight and 66/100 (178.66) feet radius sixty-nine and 78/100 (69.78) feet and again SOUTHEASTERLY one hundred forty-six and 67/100 (146.67) feet, all by the northerly location line of the first section of the 1980 City layout (Stuart Street);

SOUTHWESTERLY by a curve of nine and 67/100 (9.67) feet radius forming the intersection of said Stuart Street and Charles Street South fifteen and 18/100 (15.18) feet; again

SOUTHWESTERLY by Charles Street South three hundred ninety-six and 58/100 (396.58) feet;

NORTHWESTERLY by the southeasterly sideline of Park Square five and 85/100 (396.58) feet;

NORTHWESTERLY by southeasterly sideline of Park Square five and 85/100 (5.85) feet;

NORTHEASTERLY forty-three and 65/100 (43.65) feet,
WESTERLY two and 78/100 (2.78) feet, and
NORTHERLY thirty-six and 11/100 (36.11)
feet, all by the southerly limits of land
now or formerly of Michael B. Moskow; again

NORTHERLY by the remaining portion of Carver Street
twenty-six and 91/100 (26.91) feet;

EASTERLY by the westerly limits of land now or
formerly of Jerome F. Murphy, Jr., and Paul
E. Murphy, Trustees of the Murphy Real
Estate Trust a total of forty-five and
69/100 (45.69) feet;

NORTHERLY by the northerly sideline of Townsend Place,
so-called, by four courses, fifty-eight and
59/100 (58.59) feet, twenty-five and 16/100
(25.16) feet, twenty-five and 40/100 (25.40)
feet, and twenty and 31/100 (20.31) feet;

EASTERLY by the westerly limits of land of the
following owners, by land nor or formerly of
the Mansfield Realty Co., Inc., and by land
nor or formerly of the Tavern Club, by two
courses forty-one and 72/100 (41.72) feet
and fifty-eight and 29/100 (58.29) feet;

NORTHERLY twenty-five and 82/100 (25.82) feet,
WESTERLY 34/100 (.34) feet and again
NORTHERLY seventy (70) feet all by the
southerly limits of land nor or formerly off
said Tavern Club; again

EASTERLY 33/100 (.33) feet and **NORTHERLY** twenty and
34/100 (20.34) feet by the lines marking the
westerly and southerly limits of Boylston
Place, so-called; again

NORTHERLY by two courses seven and 84/100 (7.84) feet
and fifty-one and 37/100 (51.37) feet,
WESTERLY five and 66/10 (5.66) feet and
again **NORTHERLY** eight and 23/100 (8.23)
feet, in part, marking the southerly limits
of land nor or formerly of Joseph Walker,
Trustee; again

NORTHERLY by the southerly limits of Allens Alley,
so-called (formerly called Van Rensselaer
Place) ninety-nine and 02/100 (99.02) feet;
and

1926 168

EASTERLY seventy-seven and 08/100 (77.08) feet and
NORTHERLY one hundred twenty-nine and 98/100
(129.98) feet, both marking the westerly and
southerly limits respectively of land now or
formerly of the Saxon Theatre Corporation of
Boston.

Said premises are conveyed together with the easement taken
by The Commonwealth of Massachusetts by Order of Taking dated
February 22, 1984 recorded with said Deeds in Book 10816, Page
276.

SCHEDULE C

Collateral Rights: The following items shall together constitute the Collateral Rights:

- (i) The non-exclusive right to utilize the Parking Garage in common with Landlord, those authorized by Landlord consistent with the provisions of this Indenture and the public as such right is specifically described in this Indenture and subject to the terms hereof.
- (ii) The exclusive right to use the areas labelled and identified on Exhibit A as "Retail Storage Area" and "Tenant's Exclusive Support Area" and the right to use, in common with Landlord and those authorized by Landlord, the areas labelled and identified on Exhibit A as "Tenant's Non-exclusive Support Area."
- (iii) The right, in common with Landlord and others entitled thereto, including without limitation, Landlord's employees, persons having business with Landlord, other tenants of Landlord, all Building occupants, and the public generally to use: (A) all public or commonly used streets, sidewalks, drives and ways located on the Land providing access and egress to and from the Building and the Parking Garage, provided, however, that there is hereby reserved unto Landlord the right, after not less than thirty (30) days prior written notice to Tenant, to relocate any such access or egress at any time and from time to time in such manner as may be reasonably satisfactory to Tenant; (B) all public doors of the Building, public stairs and stairwells, public elevators and escalators and freight elevators providing access to and egress from the Building; (C) such non-public Building entryways not otherwise included in the Collateral Rights hereunder which Landlord may permit Tenant to use from time to time (which use of such non-public building entryways by Tenant may be revoked from

11926 170

time to time or at any time by written notice from Landlord); (D) the loading docks, freight areas, freight elevators, service courts, and the compactor and rubbish room shown on Exhibit A during the normal business hours in which such areas are utilized by Landlord, Monday through Friday, and such other days and times as Landlord may approve in writing prior to the commencement of such use, such approval not to be unreasonably withheld, provided that Tenant shall pay to Landlord all of Landlord's additional costs, including additional security and/or maintenance costs (or, at Landlord's option, Tenant shall provide such additional security and/or maintenance at Tenant's expense), resulting from Tenant's use of the same during such other days and times, all to the reasonable satisfaction of Landlord; (E) the "Common Areas" hereinafter defined; (F) all pipes, ducts, conduits, wires and meters and appurtenant equipment serving the Premises, whether or not in common with other portions of the Building, including, without limitation, the duct risers shown on Exhibit A, all central installations of utility services intended to serve the Premises or the Building and the right to use the areas near the ceiling of the upper level of the Parking Garage for the installation and maintenance of utility lines serving the Premises; (G) the areas referred to in Section 26.27 used as sidewalk cafes in accordance with and subject to said Section; and (H) subject to Landlord's prior approval, which shall not be unreasonably withheld or delayed, in writing in each instance, the Land and such portions of the Building, including Landlord's risers, conduits, feeders, pipes, wiring and the like, necessary or convenient to provide utilities and other services to the Premises from time to time, including, without limitation, water, electricity, sewerage, sprinklers, heating, ventilating, air-conditioning and telephone, provided that all installations in the unimproved portions of the Land shall be underground only, and all other such utility connections shall be within interior walls or in areas designed therefor or otherwise located so as not to be visible or otherwise receive Landlord's prior written consent.

(iv) Such rights as Landlord may have to use, in common with Landlord and those authorized by Landlord, the alleys abutting the Land or in the vicinity thereof now known as Allen's Alley, Boylston Place and Carver Street.

Common Areas: The common areas and facilities of the Building as identified on Exhibit A, including without limitation, the Mall, hydraulic elevators and stairs and stairwells leading from and to each floor of the Parking Garage and the ground floor of the Building and, solely to the extent that the Second Floor Premises remain a part of the Premises, the second floor lobby and corridors adjacent to or serving the Second Floor Premises and all stairs and stairwells, escalators, and hydraulic elevators leading from and to the second floor and the ground floor of the Building. The restrooms in the First Floor Premises and the Food Court are part of the Premises, but shall be available for use by the public as provided in this Indenture and shall be considered as Common Areas hereunder for the purpose of the reserved rights of Landlord described in this Section 1.

Parking Garage: The two-level Parking Garage situated in the basements of the Building and so labelled and identified on Exhibit A.



HOWARD STEIN HUDSON

Engineers + Planners

Appendix D

Location of Facility

- Area Locus Map
- Area Garage Map



Figure 1. *Locus Map*





Figure 2. *Area Garage Map*





HOWARD STEIN HUDSON

Engineers + Planners

Appendix E

Location of Facility

- Site Plan
- Parking Floor Plan - Upper Level
- Parking Floor Plan - Lower Level



Figure 3. *Site Plan*

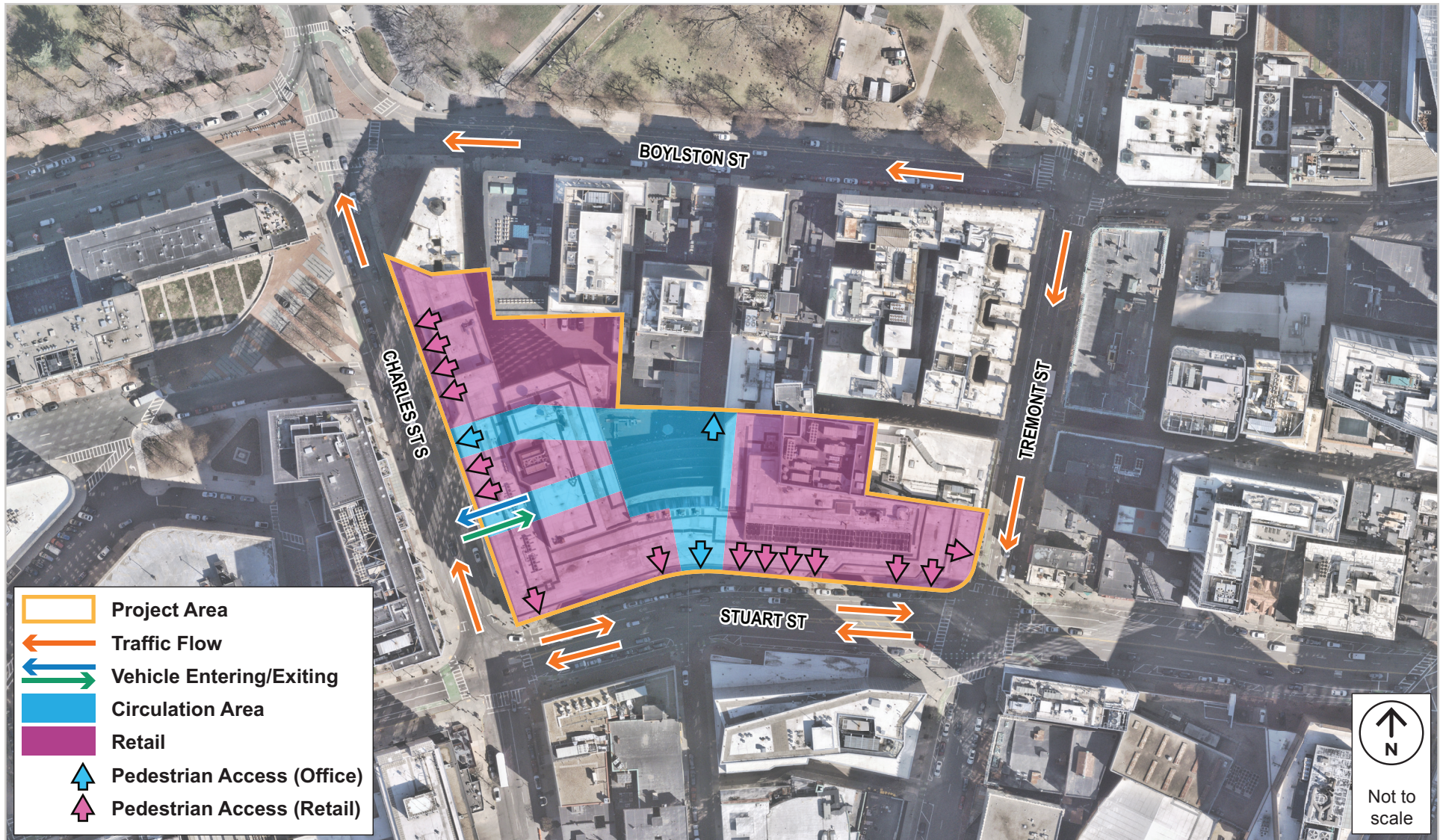



Figure 4. *Parking Floor Plan - Upper Level*

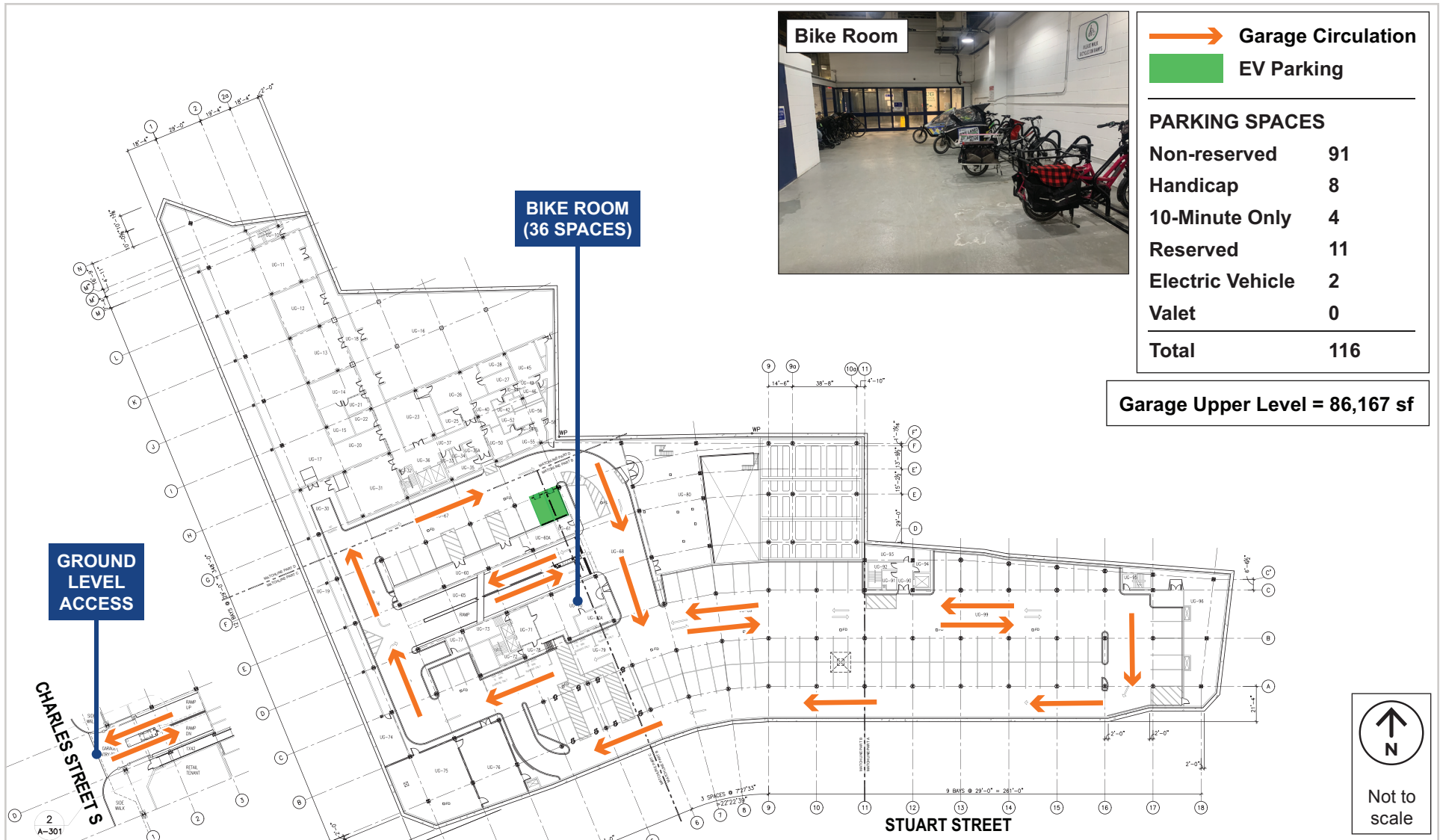
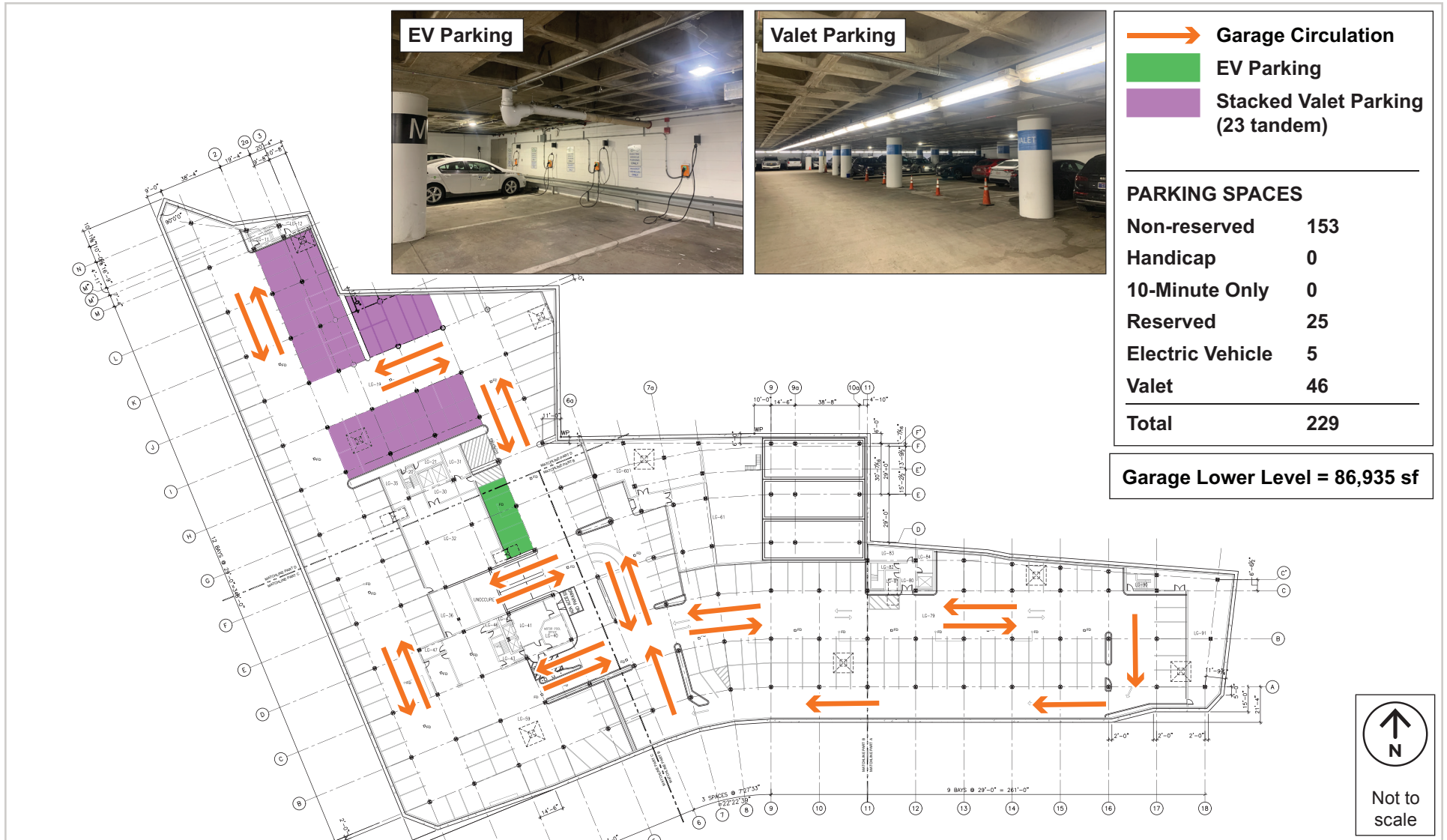



Figure 5. *Parking Floor Plan - Lower Level*





HOWARD STEIN HUDSON

Engineers + Planners

Appendix F

Abutters List (within 300 feet of Facility)

PID	OWNER	MAIL_ADDRESSEE	FULL_ADDRESS
304892000	BOYLSTON DOWNTOWN LP MASS LP		62-60 Boylston ST, BOSTON, MA 02116
304893010	48 BOYLSTON STREET CONDOMINIUM TRUST		48 Boylston ST, BOSTON, MA 02116
304893100	FPG LAGRANGE OWNER ONE LLC	C/O FORTIS PROPERTY GROUP LLC	LOWELL CT, BOSTON, MA 02116
304906000	PARKER CONDOMINIUM TRUST	C/O FORTIS PROPERTY GROUP LLC	47-55 LAGRANGE ST, BOSTON, MA 02116
304906001	SFH 48 BOYLSTON ST LLC		LAGRANGE ST, BOSTON, MA 02116
304906002	ZENG KEVIN		47-55 LAGRANGE ST 2A (201), BOSTON, MA 02116
304906004	DINH MAY		47-55 LAGRANGE ST 2B (202), BOSTON, MA 02116
304906006	HATEM JOHNNY		47-55 LAGRANGE ST 2C (203), BOSTON, MA 02116
304906008	LIU JASON		47-55 LAGRANGE ST 2D (204), BOSTON, MA 02116
304906010	SUN DING		47-55 LAGRANGE ST 2E (205), BOSTON, MA 02116
304906012	NAGENDRA BATCHU JAYANTH VENKATA		47-55 LAGRANGE ST 2F (206), BOSTON, MA 02116
304906014	ZHANG CELIA M		47-55 LAGRANGE ST 2G (207), BOSTON, MA 02116
304906016	GUPTA GAURAV		47-55 LAGRANGE ST 3A (301), BOSTON, MA 02116
304906018	LALEZARI YIZHAQ		47-55 LAGRANGE ST 3B (302), BOSTON, MA 02116
304906020	PIRES MARTHA		47-55 LAGRANGE ST 3C (303), BOSTON, MA 02116
304906024	WHITE ZURI		47-55 LAGRANGE ST 3E (305), BOSTON, MA 02116
304906026	YANG FRANK S		47-55 LAGRANGE ST 3F (306), BOSTON, MA 02116
304906028	MABREY CARLTON		47-55 LAGRANGE ST 3G (307), BOSTON, MA 02116
304906030	BAKER MCKENZI		47-55 LAGRANGE ST 3H (308), BOSTON, MA 02116
304906032	KARIM HABIBI AND SALAM HABIBI TRUST	C/O KARIM HABIBI	47-55 LAGRANGE ST 3I (309), BOSTON, MA 02116
304906034	VO NHUNG TUYET		47-55 LAGRANGE ST 3J (310), BOSTON, MA 02116
304906036	MERHEJ JOSEPH		47-55 LAGRANGE ST 4A (401), BOSTON, MA 02116
304906038	HAGGERTY KATHLEEN E		47-55 LAGRANGE ST 4B (402), BOSTON, MA 02116
304906040	ZARROUK FIRAS		47-55 LAGRANGE ST 4C (403), BOSTON, MA 02116
304906042	DIAZ JR PEDRO		47-55 LAGRANGE ST 4D (404), BOSTON, MA 02116
304906044	HANLON ASHLEY		47-55 LAGRANGE ST 4E (405), BOSTON, MA 02116
304906046	LOU XINHUA		47-55 LAGRANGE ST 4F (406), BOSTON, MA 02116
304906048	WASHINGTON PHILIP III		47-55 LAGRANGE ST 4G (407), BOSTON, MA 02116
304906050	LUU SAMSON		47-55 LAGRANGE ST 4H (408), BOSTON, MA 02116
304906052	BRANNAN SYDNEY		47-55 LAGRANGE ST 4I (409), BOSTON, MA 02116
304906054	MA MENGGAO		47-55 LAGRANGE ST 4J (410), BOSTON, MA 02116
304906056	LJACK M		47-55 LAGRANGE ST 5A (501), BOSTON, MA 02116
304906058	GU BILLY		47-55 LAGRANGE ST 5B (502), BOSTON, MA 02116
304906060	PARKER 5C LLC		47-55 LAGRANGE ST 5C (503), BOSTON, MA 02116
304906062	HONKONEN ERIK D		47-55 LAGRANGE ST 5D (504), BOSTON, MA 02116
304906064	ANDREWS MARI C		47-55 LAGRANGE ST 5E (505), BOSTON, MA 02116
304906066	ALLEN JUSTIN M		47-55 LAGRANGE ST 5F (506), BOSTON, MA 02116
304906068	SAVILLE LUKE		47-55 LAGRANGE ST 5G (507), BOSTON, MA 02116
304906070	KHANDELWAL ALIZA	C/O ALIZA KHANDELWAL	47-55 LAGRANGE ST 5H (508), BOSTON, MA 02116
304906072	YU XUEFEI		47-55 LAGRANGE ST 5I (509), BOSTON, MA 02116
304906074	SHERWILL JENNIFER LINDSEY		47-55 LAGRANGE ST 5J (510), BOSTON, MA 02116
304906076	DEL AGUILA RACHELLE		47-55 LAGRANGE ST 6A (601), BOSTON, MA 02116
304906078	LINDHE PAMELA		47-55 LAGRANGE ST 6B (602), BOSTON, MA 02116
304906080	PERUSSE KARA		47-55 LAGRANGE ST 6C (603), BOSTON, MA 02116
304906082	TEJADA KATE SHANELL		47-55 LAGRANGE ST 6D (604), BOSTON, MA 02116
304906084	GUAN ALICE		47-55 LAGRANGE ST 6E (605), BOSTON, MA 02116
304906086	AMADA ALEXANDRA S		47-55 LAGRANGE ST 6F (606), BOSTON, MA 02116
304906088	PAN JUN		47-55 LAGRANGE ST 6G (607), BOSTON, MA 02116
304906090	VALLURU MAHITHA		47-55 LAGRANGE ST 6H (608), BOSTON, MA 02116
304906092	HUANG CHRISTIE XU		47-55 LAGRANGE ST 6I (609), BOSTON, MA 02116
304906094	SAINI PUNEET S		47-55 LAGRANGE ST 6J (610), BOSTON, MA 02116
304906096	ZHANG ZHAOYAN		47-55 LAGRANGE ST 7A (701), BOSTON, MA 02116
304906098	KHANDELWAL LEENAM		47-55 LAGRANGE ST 7B (702), BOSTON, MA 02116
304906100	PARK MIN GI		47-55 LAGRANGE ST 7C (703), BOSTON, MA 02116
304906104	PARKER 7E LLC		47-55 LAGRANGE ST 7E (705), BOSTON, MA 02116
304906106	FOLEY COLM		47-55 LAGRANGE ST 7F (706), BOSTON, MA 02116
304906108	MONTAMARTA FRANCISCO T		47-55 LAGRANGE ST 7G (707), BOSTON, MA 02116
304906110	PARENT MATTHEW JOHN		47-55 LAGRANGE ST 7H (708), BOSTON, MA 02116
304906112	BAI SHA		47-55 LAGRANGE ST 7I (709), BOSTON, MA 02116
304906116	LI YICHEN		47-55 LAGRANGE ST 8A (801), BOSTON, MA 02116
304906118	STEFFENS LOUIS N		47-55 LAGRANGE ST 8B (802), BOSTON, MA 02116
304906122	COLON GISELLE		47-55 LAGRANGE ST 8D (804), BOSTON, MA 02116
304906124	HUANG DAN-CHING		47-55 LAGRANGE ST 8E (805), BOSTON, MA 02116
304906126	GOERTZEN BRAD		47-55 LAGRANGE ST 8F (806), BOSTON, MA 02116
304906146	ZHENG CATHERINE K		47-55 LAGRANGE ST 9F (906), BOSTON, MA 02116
304906150	DENG MIAOLI		47-55 LAGRANGE ST 9H (908), BOSTON, MA 02116
304906152	HUANG WEIHUA		47-55 LAGRANGE ST 9I (909), BOSTON, MA 02116
304906156	ZHOU ALEX		47-55 LAGRANGE ST 10A (1001), BOSTON, MA 02116
304906158	CECELI ARHAN		47-55 LAGRANGE ST 10B (1002), BOSTON, MA 02116
304906162	MEI XUEHUA		47-55 LAGRANGE ST 10D (1004), BOSTON, MA 02116
304906168	TUNCER IZIM		47-55 LAGRANGE ST 10G (1007), BOSTON, MA 02116
304906170	GADH ADIT		47-55 LAGRANGE ST 10H (1008), BOSTON, MA 02116
304906172	NEUGEBAUER SYDNEY ERIN		47-55 LAGRANGE ST 10I (1009), BOSTON, MA 02116
304906174	IRWIN MUSKAT 1992 TRUST		47-55 LAGRANGE ST 10J (1010), BOSTON, MA 02116
304906182	SPAHIJA JUNIDA		47-55 LAGRANGE ST 11D (1104), BOSTON, MA 02116
304906190	ZHOU SHUYUAN		47-55 LAGRANGE ST 11H (1108), BOSTON, MA 02116
304906192	LI XINXIN		47-55 LAGRANGE ST 11I (1109), BOSTON, MA 02116
304906194	SARKIS MARTINS MARCUS V		47-55 LAGRANGE ST 11J (1110), BOSTON, MA 02116
304906210	PETTENATI MARTINO		47-55 LAGRANGE ST 12H (1208), BOSTON, MA 02116
304906212	MA XIN		47-55 LAGRANGE ST 12I (1209), BOSTON, MA 02116
304906214	47-55 UNIT 12J LAGRANGE STREET TRUST		47-55 LAGRANGE ST 12J (1210), BOSTON, MA 02116
304906228	ABAY PINAR	C/O PINAR ABAY	47-55 LAGRANGE ST 14G (1407), BOSTON, MA 02116
304906230	PARKER GEMS LLC		47-55 LAGRANGE ST 14H (1408), BOSTON, MA 02116

PID	OWNER	MAIL_ADDRESSEE	FULL_ADDRESS
304906232	KIS MEHMET		47-55 LAGRANGE ST 14I (1409), BOSTON, MA 02116
304906234	XU CHIMIAO		47-55 LAGRANGE ST 14J (1410), BOSTON, MA 02116
304906250	BALAJI SHARANYA		47-55 LAGRANGE ST 15H (1508), BOSTON, MA 02116
304906252	FINZ RAKEL LISA		47-55 LAGRANGE ST 15I (1509), BOSTON, MA 02116
304906254	ZHU ANDREW		47-55 LAGRANGE ST 15J (1510), BOSTON, MA 02116
304906264	WILLIAMS APRIL		47-55 LAGRANGE ST 16E (1605), BOSTON, MA 02116
304906266	ZHANG YAN		47-55 LAGRANGE ST 16F (1606), BOSTON, MA 02116
304906270	NAIR RESMI		47-55 LAGRANGE ST 16H (1608), BOSTON, MA 02116
304906272	NGUYEN NGOC MAI		47-55 LAGRANGE ST 16I (1609), BOSTON, MA 02116
304906274	GOUTOPOULOS ANDREAS		47-55 LAGRANGE ST 16J (1610), BOSTON, MA 02116
304906278	TOPLUSOY ZEHRA		47-55 LAGRANGE ST 17B (1702), BOSTON, MA 02116
304906284	YUAN JIER		47-55 LAGRANGE ST 17E (1707), BOSTON, MA 02116
304906286	YU TINGTING		47-55 LAGRANGE ST 17F (1708), BOSTON, MA 02116
304906312	BOLTON GRAHAM JOHN		47-55 LAGRANGE ST 20C (2003), BOSTON, MA 02116
304906332	JIANG XINRONG		47-55 LAGRANGE ST PH22D, BOSTON, MA 02116
304909000	EMERSON COLLEGE		216-218 Tremont ST, BOSTON, MA 02116
304910020	CP IX LUKA LLC		24-58 LAGRANGE ST, BOSTON, MA 02116
304928000	JACOB WIRTH NOMINEE TRUST	C/O JULIUS SOKOL & FRED STARIKOV	31-39 Stuart ST, BOSTON, MA 02116
304931000	KAI FEUNG LLC MASS LLC		59-51 Stuart ST, BOSTON, MA 02116
304934000	DONLAN MICHAEL F TS	C/O MYRNA MEROWITZ	71 Stuart ST, BOSTON, MA 02116
304934010	MUI SIU MAN		75-77 Stuart ST, BOSTON, MA 02116
304935000	TREMONT 230 NOMINEE TRUST		230 Tremont ST, BOSTON, MA 02116
304936000	FOURTH WALL EQUITY LLC		228 Tremont ST, BOSTON, MA 02116
304937000	MOY RUTH C TS	C/O RUTH C MOY	226 Tremont ST, BOSTON, MA 02116
304938000	AXIOTIS STEPHEN TS		224 Tremont ST, BOSTON, MA 02116
304939000	GREATEST BOSTON BAR COMPANY LLC		222-220 Tremont ST, BOSTON, MA 02116
305640000	HTA-BIEWEND LLC	C/O TUFTS MEDICAL/KATHY DAVIS	252-272 Tremont ST, BOSTON, MA 02116
305645000	TREMONT ENTERTAINMENT ENTERPRISES	C/O ANDREA PEARCE	248-244 Tremont ST, BOSTON, MA 02116
305648000	TS LODGING INC		240-242 Tremont ST, BOSTON, MA 02116
305651000	NEMC REAL ESTATE CO INC		50 Stuart ST, BOSTON, MA 02116
500010000	MASSACHUSETTS DEPARTMENT OF		Tremont ST, BOSTON, MA 02116
500010001	THEATRE DISTRICT LLC	C/O WILDER COMPANIES LTD	133-135 Stuart ST, BOSTON, MA 02116
500020000	TWO PARK PLAZA LLC MASS LLC		2 PARK PZ, BOSTON, MA 02116
500026000	162 BOYLSTON ST LLC	C/O THIEBEAULT PROPERTY DEVELOPMENT	8 CARVER ST, BOSTON, MA 02116
500028000	ONE SIXTY CORPORATION THE		160 Boylston ST, BOSTON, MA 02116
500032000	VENTOURIS EMILIOS TS	C/O EMILIOS VENTOURIS	140 Boylston ST, BOSTON, MA 02116
500034000	BOYLSTON PLACE CONDO TR		132-130 Boylston ST, BOSTON, MA 02116
500034002	BOYLSTON COMMONS LLC MASS LLC		132 Boylston ST, BOSTON, MA 02116
500034004	URDANG CHARLES P		132 Boylston ST 132-3, BOSTON, MA 02116
500034006	NEW ENGLAND URBAN LLC		132 Boylston ST 132-4, BOSTON, MA 02116
500034008	HALSTROM FREDERIC N TRSTS		132 Boylston ST 132-5, BOSTON, MA 02116
500034010	COOKE WILLIAM		132 Boylston ST 132-6, BOSTON, MA 02116
500034012	BOYLSTON PLACE RLTY LLC MASS LLC		130 Boylston ST, BOSTON, MA 02116
500038000	TAVERN CLUB	C/O ANNA CARUSO	4 Boylston PL, BOSTON, MA 02116
500055010	COMMONWEALTH OF MASS		CHARLES STREET SOUTH, BOSTON, MA 02116
500062000	TWO 53 TREMONT STREET LLC MASS LLC		253-261 Tremont ST, BOSTON, MA 02116
500063000	SHUBERT FOUNDATION INC	C/O THE SHUBERT FOUNDATION INC	263-265 Tremont ST, BOSTON, MA 02116
500075020	ONE HUNDRED STUART ST	C/O JACK MCLAUGHLIN	100 Stuart ST, BOSTON, MA 02116
500075024	RAZORBACKS OWNER LLC	C/O RYAN, LLC / ONE INTERNATIONAL PLACE	100 Stuart ST, BOSTON, MA 02116
500075030	RESIDENTIAL CONDOMINIUM		110 Stuart ST, BOSTON, MA 02116
500075032	KATANYUTANON SAKDHISAPOL	C/O SAKDHISAPOL KATANYUTANON	110 Stuart ST 16-A, BOSTON, MA 02116
500075034	LARSEN VICTOR CHRISTIAN		110 Stuart ST 16-B, BOSTON, MA 02116
500075036	WHDM LLC		110 Stuart ST 16-C, BOSTON, MA 02116
500075040	PETER LONGIARU REVOCABLE TRUST		110 Stuart ST 16-E, BOSTON, MA 02116
500075042	VOEVODSKI KONSTANTIN		110 Stuart ST 16-F, BOSTON, MA 02116
500075044	HENRY P SCHEIDEL REVOCABLE TRUST	C/O HENRY P SCHEIDEL REVOCABLE TRUST C/O PLH GLOBAL	110 Stuart ST 16-G, BOSTON, MA 02116
500075046	LARSEN VICTORIA ISABELLA MARY		110 Stuart ST 16-H, BOSTON, MA 02116
500075048	YABLONOVSKY SASHA	C/O SASHA YABLONOVSKY	110 Stuart ST 16-I, BOSTON, MA 02116
500075050	KUZNETSOVA ZHANNA		110 Stuart ST 17-A, BOSTON, MA 02116
500075052	DIPPON CHRISTIAN		110 Stuart ST 17-B, BOSTON, MA 02116
500075054	YOUNG BRENT H		110 Stuart ST 17-C, BOSTON, MA 02116
500075056	PETERS JAMES A		110 Stuart ST 17-D, BOSTON, MA 02116
500075058	KIM KWANGBUM		110 Stuart ST 17-E, BOSTON, MA 02116
500075060	MANISH M AND MAHESH C KARAMCHANDANI NOMINEE TRUST		110 Stuart ST 17-F, BOSTON, MA 02116
500075062	KRAEMER PAUL F		110 Stuart ST 17-G, BOSTON, MA 02116
500075064	RAI LLC	C/O RAI, LLC	110 Stuart ST 17-H, BOSTON, MA 02116
500075066	CHEN PERRY		110 Stuart ST 17-I, BOSTON, MA 02116
500075068	GUPTA ANURAG DR	C/O DR. ANURAG GUPTA	110 Stuart ST 18-A, BOSTON, MA 02116
500075070	SUFI ARSHAD HUSSAIN		110 Stuart ST 18-B, BOSTON, MA 02116
500075072	KATHERINE GREENBERG 2007 REVOCABLE TRUST		110 Stuart ST 18-C, BOSTON, MA 02116
500075074	ZHENG CHEN J		110 Stuart ST 18-D, BOSTON, MA 02116
500075076	KNUTS MICHAEL		110 Stuart ST 18-E, BOSTON, MA 02116
500075078	TIMOTHY ZHENG 2020 REVOCABLE LIVING TRUST		110 Stuart ST 18-F, BOSTON, MA 02116
500075080	MERLE WINER TRUST		110 Stuart ST 18-G, BOSTON, MA 02116
500075082	REVOCABLE TRUST AGREEMENT OF		110 Stuart ST 18-H, BOSTON, MA 02116
500075084	LIU-CHANG LIVING TRUST		110 Stuart ST 18-I, BOSTON, MA 02116
500075086	ZHANG MING	C/O LUPING GE	110 Stuart ST 18-J, BOSTON, MA 02116
500075088	SINA INVESTMENT TRUST		110 Stuart ST 19-A, BOSTON, MA 02116
500075090	ZHU YIYU		110 Stuart ST 19-B, BOSTON, MA 02116
500075092	ILSOO LONGIARU REVOCABLE TRUST	C/O ILSOO LONGIARU	110 Stuart ST 19-C, BOSTON, MA 02116
500075094	WARWICK HELEN A TS	C/O HELEN A WARWICK	110 Stuart ST 19-D, BOSTON, MA 02116
500075096	ALFADDAGH KHALID D		110 Stuart ST 19-E, BOSTON, MA 02116
500075098	110 STUART STREET 19F LLC		110 Stuart ST 19-F, BOSTON, MA 02116

PID	OWNER	MAIL_ADDRESSEE	FULL_ADDRESS
500075100	110 STUART STREET 19G LLC		110 Stuart ST 19-G, BOSTON, MA 02116
500075102	WANG HSIUMEI		110 Stuart ST 19-H, BOSTON, MA 02116
500075104	JEN PROPERTIES LTD		110 Stuart ST 19-I, BOSTON, MA 02116
500075106	CHEN GRACE		110 Stuart ST 19-J, BOSTON, MA 02116
500075108	TABBOUCHE KARIM EID		110 Stuart ST 20-A, BOSTON, MA 02116
500075110	NEUREITER KIRK		110 Stuart ST 20-B, BOSTON, MA 02116
500075112	LIU LOUIS		110 Stuart ST 20-C, BOSTON, MA 02116
500075114	R&L LLC		110 Stuart ST 20-D, BOSTON, MA 02116
500075116	MADSA LLC MASS LLC	C/O HOMENET INTERNATIONAL	110 Stuart ST 20-E, BOSTON, MA 02116
500075118	SPINALE JOHN S		110 Stuart ST 20-F, BOSTON, MA 02116
500075120	HUNT WILLIAM JAECKLE		110 Stuart ST 20-G, BOSTON, MA 02116
500075122	MACRINA G HJERPE REVOCABLE TRUST		110 Stuart ST 20-H, BOSTON, MA 02116
500075124	AHMED SULMAN	C/O SULMAN AHMED	110 Stuart ST 20-I, BOSTON, MA 02116
500075126	CAO ZHENG		110 Stuart ST 20-J, BOSTON, MA 02116
500075128	ALI ZANN		110 Stuart ST 21-A, BOSTON, MA 02116
500075130	DELSIGNORE STEPHANIE LYN		110 Stuart ST 21-B, BOSTON, MA 02116
500075132	HARA DEAN T		110 Stuart ST 21-C, BOSTON, MA 02116
500075136	ZOU JI		110 Stuart ST 21-E, BOSTON, MA 02116
500075138	ESKANDAR ZIAD		110 Stuart ST 21-F, BOSTON, MA 02116
500075140	XU CHENG		110 Stuart ST 21-G, BOSTON, MA 02116
500075142	RY1 LLC		110 Stuart ST 21-H, BOSTON, MA 02116
500075144	DS TRUST 2024		110 Stuart ST 21-I, BOSTON, MA 02116
500075146	XU YIFAN		110 Stuart ST 21-J, BOSTON, MA 02116
500075148	WU QIONG		110 Stuart ST 22-A, BOSTON, MA 02116
500075150	ZHOU MING		110 Stuart ST 22-B, BOSTON, MA 02116
500075152	BARRETT MARIE C	C/O MARIE CALE BARRETT	110 Stuart ST 22-C, BOSTON, MA 02116
500075154	LOWRY KENNETH E JR	C/O KENNETH E LOWRY JR	110 Stuart ST 22-E, BOSTON, MA 02116
500075156	2014 CHEUNG FAMILY TRUST		110 Stuart ST 22-F, BOSTON, MA 02116
500075160	GARGI CHAKRABARTY REVOCABLE TRUST		110 Stuart ST 22-H, BOSTON, MA 02116
500075162	SINGH RAJKARAN		110 Stuart ST 22-I, BOSTON, MA 02116
500075164	GUCCIARDO CHRISTOPHER A		110 Stuart ST 22-J, BOSTON, MA 02116
500075166	OSATHANUGRAH NATEE	C/O RUBIN AND RUDMAN LLP/DONNA M WHITE, ESQ	110 Stuart ST 23-A, BOSTON, MA 02116
500075168	DENALI ESTATE LLC		110 Stuart ST 23-B, BOSTON, MA 02116
500075170	OSATHANUGRAH RATCH	C/O RUBIN AND RUDMAN LLP/DONNA M WHITE ESQ	110 Stuart ST 23-C, BOSTON, MA 02116
500075174	PHILLIPS TIMOTHY A		110 Stuart ST 23-E, BOSTON, MA 02116
500075176	CGGED BOSTON LLC		110 Stuart ST 23-F, BOSTON, MA 02116
500075178	AJL HOLDINGS LLC	C/O LUDWIG HANTSON	110 Stuart ST 23-G, BOSTON, MA 02116
500075180	BORTKIEWICZ MARIA M TS	C/O MARIA M BORTKIEWICZ	110 Stuart ST 23-H, BOSTON, MA 02116
500075182	LOI CHRISTOPHER		110 Stuart ST 23-I, BOSTON, MA 02116
500075184	ZHOU HUA		110 Stuart ST 23-J, BOSTON, MA 02116
500075186	ZHAO XIAOYING	C/O LINDA SU	110 Stuart ST 24-A, BOSTON, MA 02116
500075188	BLAGOSKLONNY MIKHAIL		110 Stuart ST 24-B, BOSTON, MA 02116
500075190	KWAN ALISON F		110 Stuart ST 24-C, BOSTON, MA 02116
500075192	110 STUART STREET 24D LLC		110 Stuart ST 24-D, BOSTON, MA 02116
500075194	LONGIARU PETER		110 Stuart ST 24-E, BOSTON, MA 02116
500075196	ODZE ROBERT D		110 Stuart ST 24-F, BOSTON, MA 02116
500075198	TILLINGER DOUGLAS CHARLES	C/O DOUGLAS C TILLINGER	110 Stuart ST 24-G, BOSTON, MA 02116
500075200	GTE REAL ESTATE INVESTMENTS LLC		110 Stuart ST 24-H, BOSTON, MA 02116
500075204	TWAN REAL ESTATE LP		110 Stuart ST 24-J, BOSTON, MA 02116
500075206	LI LIYING	C/O LI LIYING	110 Stuart ST 25-A, BOSTON, MA 02116
500075208	KATBE SALEH		110 Stuart ST 25-B, BOSTON, MA 02116
500075210	EKATERINA MAMULASHVILI REVOCABLE TRUST		110 Stuart ST 25-C, BOSTON, MA 02116
500075212	110 STUART STREET 25D LLC		110 Stuart ST 25-D, BOSTON, MA 02116
500075214	BAGGETT SUSAN K		110 Stuart ST 25-E, BOSTON, MA 02116
500075216	ZHANG TIEDAN		110 Stuart ST 25-F, BOSTON, MA 02116
500075218	SAMSON I LLC		110 Stuart ST 25-G, BOSTON, MA 02116
500075220	JOHAR SACHIN		110 Stuart ST 25-H, BOSTON, MA 02116
500075222	GALVIN MARIANNE JILL		110 Stuart ST 25-I, BOSTON, MA 02116
500075224	SAEIDPOURAZAR REZA		110 Stuart ST 25-J, BOSTON, MA 02116
500075226	PACKARD RICHARD		110 Stuart ST 26-A, BOSTON, MA 02116
500075228	HADDAD GEORGE		110 Stuart ST 26-B, BOSTON, MA 02116
500075230	STUART STREET 26 LLC		110 Stuart ST 26-C, BOSTON, MA 02116
500075232	110 STUART STREET 26D LLC		110 Stuart ST 26-D, BOSTON, MA 02116
500075234	LU PEIQIAN		110 Stuart ST 26-E, BOSTON, MA 02116
500075236	HERZALLAH KHADER HATEM		110 Stuart ST 26-F, BOSTON, MA 02116
500075238	LINEMAYR THOMAS		110 Stuart ST 26-G, BOSTON, MA 02116
500075240	WOO ALBERT S		110 Stuart ST 26-H, BOSTON, MA 02116
500075242	LI KIT WA	C/O IKIT WA LI	110 Stuart ST 26-I, BOSTON, MA 02116
500075244	SIMONIAN JEFFREY RONALD		110 Stuart ST 26-J, BOSTON, MA 02116
500075246	AM STUART 27 LLC	C/O CELESTE O'NEILL	110 Stuart ST 27-A, BOSTON, MA 02116
500075248	ANGRY MAN PARTNERS LTD		110 Stuart ST 27-B, BOSTON, MA 02116
500075250	JAFRI MAHMUD S		110 Stuart ST 27-C, BOSTON, MA 02116
500075254	KENNETH J BARR REVOCABLE TRUST		110 Stuart ST 27-E, BOSTON, MA 02116
500075256	LEWIS KARIN SUSAN		110 Stuart ST 27-F, BOSTON, MA 02116
500075258	LIU YA-WEN		110 Stuart ST 27-G, BOSTON, MA 02116
500075260	OHRI AMIT		110 Stuart ST 27-H, BOSTON, MA 02116
500075262	KLIO LLC A MASS LLC		110 Stuart ST 27-I, BOSTON, MA 02116
500075264	LI HAIMING		110 Stuart ST 27-J, BOSTON, MA 02116
500075266	WIJNAENDTS VAN RESANDT ROELOF		110 Stuart ST PH-1, BOSTON, MA 02116
500075268	SSM 2019 TRUST		110 Stuart ST PH-2, BOSTON, MA 02116
500075270	POSITION ONE PROPERTIES LLC		110 Stuart ST PH-3, BOSTON, MA 02116
500075272	110 STUART STREET PH4 NOMINEE TRUST	C/O THOMAS & DANIELA LINEMAYR	110 Stuart ST PH-4, BOSTON, MA 02116
500075274	TWO SEAS HOLDINGS LLC		110 Stuart ST PH-5, BOSTON, MA 02116

PID	OWNER	MAIL_ADDRESSEE	FULL_ADDRESS
500077000	NEW ENGLAND SCHOOL OF LAW		56-48 CHARLES STREET SOUTH, BOSTON, MA 02116
500080000	BOSTON EDISON CO MASS CORP		Warrenton ST, BOSTON, MA 02116
500082000	BOSTON EDISON CO		80-84 Warrenton ST, BOSTON, MA 02116
500088000	BOSTON EDISON CO MASS		CHARLES STREET SOUTH, BOSTON, MA 02116
500089000	YEE FRANCES S M	C/O FRANCES S M YEE	60 CHARLES STREET SOUTH, BOSTON, MA 02116
500090000	NEW ENGLAND LAW/BOSTON		58 CHARLES STREET SOUTH, BOSTON, MA 02116
500105010	ONE CHARLES CONDOMINIUM		1 CHARLES STREET SOUTH, BOSTON, MA 02116
500105012	PARK PLAZA RETAIL LLC	C/O D DAVID GOBEN	1 CHARLES STREET SOUTH COMM A, BOSTON, MA 02116
500105014	OSTRA RE REALTY TRUST		1 CHARLES STREET SOUTH COMM B, BOSTON, MA 02116
500105018	THENEP 2018 IRREVOCABLE TRUST	C/O THANOS PANTAZIS	1 CHARLES STREET SOUTH 2A, BOSTON, MA 02116
500105020	PANTAZIS THANOS J		1 CHARLES STREET SOUTH 2B, BOSTON, MA 02116
500105024	CHARLESPARTNER REAL ESTATE CORP	C/O CHARLESPARTNER R E CORP	1 CHARLES STREET SOUTH 2D, BOSTON, MA 02116
500105026	KETT MARY E		1 CHARLES STREET SOUTH 3A, BOSTON, MA 02116
500105028	AL-KHARSA SAAD		1 CHARLES STREET SOUTH 3B, BOSTON, MA 02116
500105030	BOYCE JOHN		1 CHARLES STREET SOUTH 3C, BOSTON, MA 02116
500105032	SAINI AJAY		1 CHARLES STREET SOUTH 3D, BOSTON, MA 02116
500105034	CASTELLI ANDREA M		1 CHARLES STREET SOUTH 3E, BOSTON, MA 02116
500105036	GHASSEMI-TARY SARA		1 CHARLES STREET SOUTH 3F, BOSTON, MA 02116
500105038	WILLIAM M STEUL FAMILY TRUST		1 CHARLES STREET SOUTH 3G, BOSTON, MA 02116
500105040	GG REALTY TRUST		1 CHARLES STREET SOUTH 3H, BOSTON, MA 02116
500105042	CHAIMATTAYOMPOL NOPSARAN	C/O NOPSARAN CHIAMATTAYOMPOL	1 CHARLES STREET SOUTH 303, BOSTON, MA 02116
500105044	CHARTOFF BRENDA R		1 CHARLES STREET SOUTH 304, BOSTON, MA 02116
500105046	ULAKY CHRISTINE		1 CHARLES STREET SOUTH 305, BOSTON, MA 02116
500105048	SOUTH CORNER REALTY TRUST	C/O WILLIAM C TOBIN	1 CHARLES STREET SOUTH 306, BOSTON, MA 02116
500105050	ABU-EID NASSER Z		1 CHARLES STREET SOUTH 307, BOSTON, MA 02116
500105052	GARDILL MARY E		1 CHARLES STREET SOUTH 308, BOSTON, MA 02116
500105054	FUCCILLO GREGORY P		1 CHARLES STREET SOUTH 309, BOSTON, MA 02116
500105056	DALESSANDRO JOHN J		1 CHARLES STREET SOUTH 310, BOSTON, MA 02116
500105058	DEAN JEFFERY J	C/O JEFFERY DEAN	1 CHARLES STREET SOUTH 312, BOSTON, MA 02116
500105060	ZANDPARSA ROYA		1 CHARLES STREET SOUTH 4A, BOSTON, MA 02116
500105062	CHARLENE K HYLE DECLARATION OF TRUST		1 CHARLES STREET SOUTH 4B, BOSTON, MA 02116
500105064	FLORENCE M MACKIE TRUST		1 CHARLES STREET SOUTH 4C, BOSTON, MA 02116
500105066	MICHAEL A COGGIN REVOCABLE	C/O MICHAEL A COGGIN	1 CHARLES STREET SOUTH 4D, BOSTON, MA 02116
500105068	PIOTTI LISA M		1 CHARLES STREET SOUTH 4E, BOSTON, MA 02116
500105070	GERSTEN SAMUEL		1 CHARLES STREET SOUTH 4F, BOSTON, MA 02116
500105072	MERLIS SCOTT	C/O SCOTT MERLIS	1 CHARLES STREET SOUTH 4G, BOSTON, MA 02116
500105074	ROTH REBECCA		1 CHARLES STREET SOUTH 4H, BOSTON, MA 02116
500105076	SHILLING KIRSTEN		1 CHARLES STREET SOUTH 401, BOSTON, MA 02116
500105078	BROWN DOUGLAS R		1 CHARLES STREET SOUTH 402, BOSTON, MA 02116
500105080	GOLDBERG ALAN J		1 CHARLES STREET SOUTH 403, BOSTON, MA 02116
500105082	AGGARWAL JYOTI		1 CHARLES STREET SOUTH 404, BOSTON, MA 02116
500105084	NOTKIN BRETT		1 CHARLES STREET SOUTH 405, BOSTON, MA 02116
500105086	DESIMONE DAVID S		1 CHARLES STREET SOUTH 406, BOSTON, MA 02116
500105088	MONTANARI MONICA		1 CHARLES STREET SOUTH 407, BOSTON, MA 02116
500105090	CRANEBRIDGE CAPITAL LLC	C/O CRANEBRIDGE LLC	1 CHARLES STREET SOUTH 408, BOSTON, MA 02116
500105092	COSTIN ADRIAN		1 CHARLES STREET SOUTH 409, BOSTON, MA 02116
500105094	ZHOU BIN		1 CHARLES STREET SOUTH 410, BOSTON, MA 02116
500105096	PARK YOUNG		1 CHARLES STREET SOUTH 412, BOSTON, MA 02116
500105098	KELLAR JEFFREY		1 CHARLES STREET SOUTH 5A, BOSTON, MA 02116
500105100	WRIGHT GEORGE DENNY		1 CHARLES STREET SOUTH 5B, BOSTON, MA 02116
500105102	ICHA-U5C-BOS LLC		1 CHARLES STREET SOUTH 5C, BOSTON, MA 02116
500105104	DALLAI RICCARDO		1 CHARLES STREET SOUTH 5D, BOSTON, MA 02116
500105106	YOUNG SERENA		1 CHARLES STREET SOUTH 5E, BOSTON, MA 02116
500105108	PHILLIPS CONSTANTINE		1 CHARLES STREET SOUTH 5F, BOSTON, MA 02116
500105110	CHING YU KU FAMILY TRUST		1 CHARLES STREET SOUTH 5G, BOSTON, MA 02116
500105112	TITUS ETHAN		1 CHARLES STREET SOUTH 5H, BOSTON, MA 02116
500105114	BARNES JORDAN E		1 CHARLES STREET SOUTH 501, BOSTON, MA 02116
500105116	MOIN KAMBIZ		1 CHARLES STREET SOUTH 502, BOSTON, MA 02116
500105118	FAROOQUI HASAN R		1 CHARLES STREET SOUTH 503, BOSTON, MA 02116
500105120	ONE CHARLES STREET LLC		1 CHARLES STREET SOUTH 504, BOSTON, MA 02116
500105122	BARRY V ENGEL AND HARRIET M	C/O BARRY V ENGEL	1 CHARLES STREET SOUTH 505, BOSTON, MA 02116
500105124	FISHBEIN EVALYN LIPTON		1 CHARLES STREET SOUTH 506, BOSTON, MA 02116
500105126	CHARLES ACQUISITION TRUST	C/O EUGENIA ROMM	1 CHARLES STREET SOUTH 507, BOSTON, MA 02116
500105128	RITA CUKER REVOCABLE TRUST	C/O RITA CUKER TS	1 CHARLES STREET SOUTH 508, BOSTON, MA 02116
500105130	PARLAVECCHIO JOSEPH A		1 CHARLES STREET SOUTH 509, BOSTON, MA 02116
500105132	APARNA & URVASHI UPADHYAY IRREVOCABLE TRUST		1 CHARLES STREET SOUTH 510, BOSTON, MA 02116
500105134	CLARKE RICHARD		1 CHARLES STREET SOUTH 512, BOSTON, MA 02116
500105136	TSAI ELIZABETH HON-YU		1 CHARLES STREET SOUTH 6A, BOSTON, MA 02116
500105138	HATCH ROBERT F		1 CHARLES STREET SOUTH 6B, BOSTON, MA 02116
500105140	HARRY NEWTON REVOCABLE TRUST	C/O HARRY & SUSAN D NEWTON	1 CHARLES STREET SOUTH 6C, BOSTON, MA 02116
500105142	DWYER MATTHEW P JR	C/O MATTHEW P DWYER JR	1 CHARLES STREET SOUTH 6D, BOSTON, MA 02116
500105144	MARK DENNIS P		1 CHARLES STREET SOUTH 6E, BOSTON, MA 02116
500105146	EDWARDS JOSEPH R		1 CHARLES STREET SOUTH 6F, BOSTON, MA 02116
500105150	HOUARD ALAIN		1 CHARLES STREET SOUTH 6H, BOSTON, MA 02116
500105152	RAJ SHREYA		1 CHARLES STREET SOUTH 601, BOSTON, MA 02116
500105154	GRAVES BERNARD		1 CHARLES STREET SOUTH 602, BOSTON, MA 02116
500105156	AVK LLC A MASS LLC		1 CHARLES STREET SOUTH 603, BOSTON, MA 02116
500105158	TURNER ALVIN N		1 CHARLES STREET SOUTH 604, BOSTON, MA 02116
500105160	ALLENE DIAZ REVOCABLE TRUST	C/O ALLENE M DIAZ	1 CHARLES STREET SOUTH 605, BOSTON, MA 02116
500105162	DRAY JOANNE		1 CHARLES STREET SOUTH 606, BOSTON, MA 02116
500105164	KORTENHAUS LYNNE M		1 CHARLES STREET SOUTH 607, BOSTON, MA 02116
500105166	FOGAREN PETER B		1 CHARLES STREET SOUTH 608, BOSTON, MA 02116
500105168	WAMBACH VALAYA LYNN	C/O ROBERT FRANCIS WAMBACH	1 CHARLES STREET SOUTH 609, BOSTON, MA 02116

PID	OWNER	MAIL_ADDRESSEE	FULL_ADDRESS
500105170	NLH HOLDINGS LLC		1 CHARLES STREET SOUTH 610, BOSTON, MA 02116
500105172	LYNN R GARBER REVOCABLE TRUST 2024		1 CHARLES STREET SOUTH 612, BOSTON, MA 02116
500105174	SBROGNA DEBRA		1 CHARLES STREET SOUTH 7A, BOSTON, MA 02116
500105176	DOWNING DAVID		1 CHARLES STREET SOUTH 7B, BOSTON, MA 02116
500105178	DOROTHY E FALCIONE 2021 TRUST		1 CHARLES STREET SOUTH 7C, BOSTON, MA 02116
500105180	LINDA STONE 2015 REVOCABLE TRUST		1 CHARLES STREET SOUTH 7D, BOSTON, MA 02116
500105182	RUSSELL DAVID		1 CHARLES STREET SOUTH 7E, BOSTON, MA 02116
500105184	HELAIN E SILVERMAN TRUST (2016)		1 CHARLES STREET SOUTH 7F, BOSTON, MA 02116
500105186	ONE CHARLES ST LLC		1 CHARLES STREET SOUTH 7G, BOSTON, MA 02116
500105188	GEBRIAN EILEEN P		1 CHARLES STREET SOUTH 7H, BOSTON, MA 02116
500105190	PARK FAMILY TRUST	C/O CHARLIE PARK	1 CHARLES STREET SOUTH 701, BOSTON, MA 02116
500105192	CRANEBRIDGE CAPITAL III LLC		1 CHARLES STREET SOUTH 702, BOSTON, MA 02116
500105194	MOIN ROYA		1 CHARLES STREET SOUTH 703, BOSTON, MA 02116
500105198	TOOMEY CONSTANCE M		1 CHARLES STREET SOUTH 705, BOSTON, MA 02116
500105202	MDA PARTNERS LLC		1 CHARLES STREET SOUTH 707, BOSTON, MA 02116
500105204	TWEEDY ROBIN		1 CHARLES STREET SOUTH 708, BOSTON, MA 02116
500105206	MDA PARK LLC	C/O HYUN D KIM	1 CHARLES STREET SOUTH 709, BOSTON, MA 02116
500105208	SHAUGHNESSY ANNA C	C/O DANIEL R SHAUGHNESSY	1 CHARLES STREET SOUTH 710, BOSTON, MA 02116
500105210	YADAV PRAMILA R		1 CHARLES STREET SOUTH 712, BOSTON, MA 02116
500105212	LADHA SHAHREZAD		1 CHARLES STREET SOUTH 8A, BOSTON, MA 02116
500105214	WEISSMAN PAUL A		1 CHARLES STREET SOUTH 8B, BOSTON, MA 02116
500105216	DRISCOLL DAVID J		1 CHARLES STREET SOUTH 8C, BOSTON, MA 02116
500105218	LUPO CHRISOPHER		1 CHARLES STREET SOUTH 8D, BOSTON, MA 02116
500105220	WILLIAM A WOODCOCK LIVING TRUST		1 CHARLES STREET SOUTH 8E, BOSTON, MA 02116
500105222	ZAKON ELLEN		1 CHARLES STREET SOUTH 8F, BOSTON, MA 02116
500105224	YASHINSKY MARK E		1 CHARLES STREET SOUTH 8G, BOSTON, MA 02116
500105226	ANDREW E SNIDER TRUST-2020		1 CHARLES STREET SOUTH 8H, BOSTON, MA 02116
500105228	CHI B VU LIVING TRUST		1 CHARLES STREET SOUTH 801, BOSTON, MA 02116
500105230	CROWE KAREN	C/O KAREN CROWE	1 CHARLES STREET SOUTH 802, BOSTON, MA 02116
500105232	DAVID LONG CATTLE CO	C/O MARY LONG GORDON	1 CHARLES STREET SOUTH 803, BOSTON, MA 02116
500105234	A&V ASSOCIATES LLC	C/O VALERY KITARYEV	1 CHARLES STREET SOUTH 804, BOSTON, MA 02116
500105236	YOUNG YUK CHUEN DAVID		1 CHARLES STREET SOUTH 805, BOSTON, MA 02116
500105238	DUNN JUDITH		1 CHARLES STREET SOUTH 806, BOSTON, MA 02116
500105242	GREENE KATHERINE F		1 CHARLES STREET SOUTH 808, BOSTON, MA 02116
500105244	FLAGPORT PROPERTIES LLC		1 CHARLES STREET SOUTH 809, BOSTON, MA 02116
500105246	GIANGRASSO JOSEPH SR		1 CHARLES STREET SOUTH 810, BOSTON, MA 02116
500105248	ONE CHARLES UNIT 812 NOMINEE TRUST	C/O MARANT INC	1 CHARLES STREET SOUTH 812, BOSTON, MA 02116
500105250	CHIN COB TRUST		1 CHARLES STREET SOUTH 9A, BOSTON, MA 02116
500105252	JOHN FRANCIS GIBLIN JR REVOCABLE TRUST		1 CHARLES STREET SOUTH 9C, BOSTON, MA 02116
500105254	SYLVIA D LEWIS FAMILY TRUST		1 CHARLES STREET SOUTH 9D, BOSTON, MA 02116
500105256	FOX JOSHUA		1 CHARLES STREET SOUTH 9E, BOSTON, MA 02116
500105258	1 CHARLES STREET SOUTH UNIT 9G BOSTON LLC		1 CHARLES STREET SOUTH 9G, BOSTON, MA 02116
500105260	LANGBORT MELVIN B	C/O MERYL L LANGBORT	1 CHARLES STREET SOUTH 9H, BOSTON, MA 02116
500105262	DONG STEPHEN YU		1 CHARLES STREET SOUTH 901, BOSTON, MA 02116
500105264	PAUL BIMLA		1 CHARLES STREET SOUTH 902, BOSTON, MA 02116
500105266	KELIHER CYNTHIA B		1 CHARLES STREET SOUTH 904, BOSTON, MA 02116
500105268	MOELTE GREG		1 CHARLES STREET SOUTH 905, BOSTON, MA 02116
500105270	MA CONDO GROUP LLC	C/O MA CONDO GROUP LLC	1 CHARLES STREET SOUTH 906, BOSTON, MA 02116
500105272	FELDSCHER BARBARA		1 CHARLES STREET SOUTH 907, BOSTON, MA 02116
500105276	SHOMALI MARYAM		1 CHARLES STREET SOUTH 912, BOSTON, MA 02116
500105280	UNIT 10C ONE CHARLES ST	C/O SONJA YATES	1 CHARLES STREET SOUTH 10C, BOSTON, MA 02116
500105282	MORAN DONALD F		1 CHARLES STREET SOUTH 10D, BOSTON, MA 02116
500105284	NILOFF JONATHAN M		1 CHARLES STREET SOUTH 10E, BOSTON, MA 02116
500105286	FELDMAN FRANCES Y		1 CHARLES STREET SOUTH 10G, BOSTON, MA 02116
500105288	ANDRES REALTY LLC		1 CHARLES STREET SOUTH 10H, BOSTON, MA 02116
500105290	ONE CHARLES STREET SOUTH UNIT 1001 LLC	C/O ARTHUR K TONG	1 CHARLES STREET SOUTH 1001, BOSTON, MA 02116
500105292	MICHAELS JORDAN		1 CHARLES STREET SOUTH 1002, BOSTON, MA 02116
500105294	HUGHES MICHAEL		1 CHARLES STREET SOUTH 1004, BOSTON, MA 02116
500105296	CONNORS JAMES M		1 CHARLES STREET SOUTH 1005, BOSTON, MA 02116
500105298	DIMAMBRO ANTONIO G	C/O ANTONIO DIMAMBRO	1 CHARLES STREET SOUTH 1006, BOSTON, MA 02116
500105302	MALHOTRA URVASHI PAUL		1 CHARLES STREET SOUTH 1010, BOSTON, MA 02116
500105304	HASHIM HASHIM		1 CHARLES STREET SOUTH 1012, BOSTON, MA 02116
500105306	BARBARA J PADOS REVOCABLE TRUST	C/O FRANK J PADOS JR	1 CHARLES STREET SOUTH 11A, BOSTON, MA 02116
500105308	MICHELSON ALAN D		1 CHARLES STREET SOUTH 11C, BOSTON, MA 02116
500105310	ONE CHARLES STREET SOUTH 11D REALTY TRUST	C/O LAWRENCE & BARBARA FARRER	1 CHARLES STREET SOUTH 11D, BOSTON, MA 02116
500105312	CHAKRAVARTHY REVOCABLE INTERVIVOS TRUST		1 CHARLES STREET SOUTH 11E, BOSTON, MA 02116
500105314	MALKAWI ALI M		1 CHARLES STREET SOUTH 11G, BOSTON, MA 02116
500105316	SCERBO MARY A		1 Charles St South 11H, BOSTON, MA 02116
500105318	THERESA LUISI WARD LIVING TRUST	C/O THERESA L WARD	1 CHARLES STREET SOUTH 1101, BOSTON, MA 02116
500105320	MAZER HARVEY MARK	C/O MARK MAZER	1 CHARLES STREET SOUTH 1102, BOSTON, MA 02116
500105322	ICHA-U1104-BOS LLC		1 CHARLES STREET SOUTH 1104, BOSTON, MA 02116
500105324	KONIK LLC		1 CHARLES STREET SOUTH 1105, BOSTON, MA 02116
500105326	AL QADI WAEL		1 CHARLES STREET SOUTH 1106, BOSTON, MA 02116
500105328	RAMTEKE SMITA B		1 CHARLES STREET SOUTH 1107, BOSTON, MA 02116
500105330	ANGELA L SQUARCIA 2014 TRUST	C/O PAUL SQUARCIA	1 CHARLES STREET SOUTH 1110, BOSTON, MA 02116
500105332	TSAI VICKI		1 CHARLES STREET SOUTH 1112, BOSTON, MA 02116
500105334	JORDAN REID CHARLES	C/O CHARLES REID JORDAN	1 CHARLES STREET SOUTH 12A, BOSTON, MA 02116
500105336	COLMENERO ANA		1 CHARLES STREET SOUTH 12C, BOSTON, MA 02116
500105338	RAJENDRAN KRISHNA		1 CHARLES STREET SOUTH 12D, BOSTON, MA 02116
500105340	SLOCUM PHYLLIS S		1 CHARLES STREET SOUTH 12E, BOSTON, MA 02116
500105342	VITALINI WILLIAM J TS	C/O WILLIAM J VITALINI TS	1 CHARLES STREET SOUTH 12G, BOSTON, MA 02116
500105346	DOUBLE Z INC		1 CHARLES STREET SOUTH 1201, BOSTON, MA 02116
500105350	ONE CHARLES STREET SOUTH UNIT 1204 NOMINEE TRUST	C/O SANJIV MIRCHANDANI	1 CHARLES STREET SOUTH 1204, BOSTON, MA 02116

PID	OWNER	MAIL_ADDRESSEE	FULL_ADDRESS
500105352	EID NESSER ABU		1 CHARLES STREET SOUTH 1205, BOSTON, MA 02116
500105354	BERMAN HAL Z		1 CHARLES STREET SOUTH 1206, BOSTON, MA 02116
500105356	YANG CHAO P		1 CHARLES STREET SOUTH 1207, BOSTON, MA 02116
500105360	JOSEPH D GIANGRASSO JR REVOCABLE TRUST		1 CHARLES STREET SOUTH 1212, BOSTON, MA 02116
500105362	MENDU CAPITAL LLC	C/O MENACHEM ABRAHAM	1 CHARLES STREET SOUTH 14A, BOSTON, MA 02116
500105364	PANAS ALEXANDER S		1 CHARLES STREET SOUTH 14C, BOSTON, MA 02116
500105366	PANAS ALEXANDER		1 CHARLES STREET SOUTH 14D, BOSTON, MA 02116
500105368	LULL JOAQUIN P		1 CHARLES STREET SOUTH 14E, BOSTON, MA 02116
500105370	JONATHAN F WILSON 2019 TRUST		1 CHARLES STREET SOUTH 14G, BOSTON, MA 02116
500105372	HAWKINS DAVID		1 CHARLES STREET SOUTH 14H, BOSTON, MA 02116
500105374	FARRADJ ZEIN BASSEM		1 CHARLES STREET SOUTH 1401, BOSTON, MA 02116
500105376	KOHANLOO MICHELLE		1 CHARLES STREET SOUTH 1402, BOSTON, MA 02116
500105378	ANDREASEN PARSONS LEA		1 CHARLES STREET SOUTH 1404, BOSTON, MA 02116
500105380	JONES PETER		1 CHARLES STREET SOUTH 1405, BOSTON, MA 02116
500105382	CRAIG L WESTON 2015	C/O CRAIG L WESTON	1 CHARLES STREET SOUTH 1406, BOSTON, MA 02116
500105386	JAGANATHAN ARUN MARCEL		1 CHARLES STREET SOUTH 1410, BOSTON, MA 02116
500105388	JEJALO LLC		1 CHARLES STREET SOUTH 1412, BOSTON, MA 02116
500105390	ONE CHARLES REALTY TRUST	C/O ONE CHARLES REALTY TRUST	1 CHARLES STREET SOUTH 15A, BOSTON, MA 02116
500105394	MOWSCHENSON NADINE BERMAN		1 CHARLES STREET SOUTH 15D, BOSTON, MA 02116
500105396	CHARLES 1ST 15E LLC		1 CHARLES STREET SOUTH 15E, BOSTON, MA 02116
500105398	SAPIENZA LLC		1 CHARLES STREET SOUTH 15G, BOSTON, MA 02116
500105400	MESSING ARNOLD P		1 CHARLES STREET SOUTH 15H, BOSTON, MA 02116
500105402	LEED STEVEN B	C/O STEVEN LEED	1 CHARLES STREET SOUTH 1501, BOSTON, MA 02116
500105404	ALIEV SERGUEI TS	C/O MARANT INC	1 CHARLES STREET SOUTH 1502, BOSTON, MA 02116
500105406	SIMHA VIKRAM		1 CHARLES STREET SOUTH 1504, BOSTON, MA 02116
500105408	BOXER HOLDINGS LLC		1 CHARLES STREET SOUTH 1505, BOSTON, MA 02116
500105410	NOUF HOLDINGS LLC		1 CHARLES STREET SOUTH 1506, BOSTON, MA 02116
500105412	BOSTON SOUL RE US VI LLC		1 CHARLES STREET SOUTH 1507, BOSTON, MA 02116
500105414	WONG MING B	C/O MING WONG	1 CHARLES STREET SOUTH 1510, BOSTON, MA 02116
500105420	RATTIGAN JOHN JR TS	C/O ANTHONY PANGARO	1 CHARLES STREET SOUTH 16D, BOSTON, MA 02116
500105422	TUCK JUDITH R		1 CHARLES STREET SOUTH 16E, BOSTON, MA 02116
500105424	DRAY ISAAC		1 CHARLES STREET SOUTH 16G, BOSTON, MA 02116
500105426	STEVEN R ZOGG REVOCABLE	C/O STEVEN R ZOGG	1 CHARLES STREET SOUTH 16H, BOSTON, MA 02116
500105428	FLETCHER PAUL M		1 CHARLES STREET SOUTH 1601, BOSTON, MA 02116
500105430	YAP HOLSON ADI		1 CHARLES STREET SOUTH 1602, BOSTON, MA 02116
500105432	AL-SALEH ABDULLA		1 CHARLES STREET SOUTH 1604, BOSTON, MA 02116
500105434	MONTERO WILLIAM A		1 CHARLES STREET SOUTH 1605, BOSTON, MA 02116
500105436	ONE CHARLES STREET SOUTH	C/O HOLLAND & KNIGHT LLP	1 CHARLES STREET SOUTH 1606, BOSTON, MA 02116
500105438	SEBAOUN JEAN DAVID	C/O CHARLES GATE REALTY GROUP	1 CHARLES STREET SOUTH 1607, BOSTON, MA 02116
500105440	MAH HARRY SN TS	C/O TIMOTHY MAH	1 CHARLES STREET SOUTH 1610, BOSTON, MA 02116
500105442	BRUSHY LANE QUALIFIED PERSONAL RESIDENCE TRUST	C/O DAVID L TAYLOR	1 CHARLES STREET SOUTH 1612, BOSTON, MA 02116
500105444	WAGNER SHELDON		1 CHARLES STREET SOUTH PH1-A, BOSTON, MA 02116
500105446	KRAKOFF ROGER L		1 CHARLES STREET SOUTH PH1-B, BOSTON, MA 02116
500105448	FINK PETER W		1 CHARLES STREET SOUTH PH1-C, BOSTON, MA 02116
500105450	LUBIN KATE E TS	C/O KATE E LUBIN	1 CHARLES STREET SOUTH PH1-D, BOSTON, MA 02116
500105452	FIGUEIREDO MAGDA FERES		1 CHARLES STREET SOUTH PH-101, BOSTON, MA 02116
500105454	CORRIGAN MARK		1 CHARLES STREET SOUTH PH-102, BOSTON, MA 02116
500105456	DENNIS E CONDON LIVING TRUST		1 CHARLES STREET SOUTH PH-103, BOSTON, MA 02116
500105458	YODER MAUREEN B		1 CHARLES STREET SOUTH PH-104, BOSTON, MA 02116
500105460	LEE DONALD P		1 CHARLES STREET SOUTH PH-105, BOSTON, MA 02116
500105462	STEPHEN J HENDRICKSON 2014	C/O STEPHEN HENDRICKSON	1 CHARLES STREET SOUTH PH2-A, BOSTON, MA 02116
500105464	KRAM HOLDING LLC		1 CHARLES STREET SOUTH PH2-B, BOSTON, MA 02116
500105466	HAMERMESH RICHARD TS	C/O RICHARD HAMERMESH	1 CHARLES STREET SOUTH PH2-C, BOSTON, MA 02116
500105468	OLIVA SAMUEL G		1 CHARLES STREET SOUTH PH2-D, BOSTON, MA 02116
500105470	DARVISH MANOUCH		1 CHARLES STREET SOUTH PH-201, BOSTON, MA 02116
500105472	LAPMAN MARK		1 CHARLES STREET SOUTH PH-202, BOSTON, MA 02116
500105474	GIDGET LLC	C/O BARBARA M GINADER	1 CHARLES STREET SOUTH PH-203, BOSTON, MA 02116
500105476	MEGAN ELIZABETH WEEKS REVOCABLE TRUST OF 2020		1 CHARLES STREET SOUTH PH-204, BOSTON, MA 02116
500105478	390 COMMONWEALTH AVENUE LLC	C/O VIVEK NARENDRAN	1 CHARLES STREET SOUTH PH-205, BOSTON, MA 02116
500105480	KCW BOSTON PROPERTIES LLC	C/O KCW BOSTON PROPERTIES LLC	1 CHARLES STREET SOUTH 210, BOSTON, MA 02116
500105484	WEISS HUGH E		1 CHARLES STREET SOUTH 214, BOSTON, MA 02116
500135000	200 STUART STREET	C/O PEBBLEBROOK HOTEL TRUST	210-196 Stuart ST, BOSTON, MA 02116
500135002	NKOTB OWNER LLC		200 Stuart ST, BOSTON, MA 02116
500135004	200 STUART STREET (GARAGE OWNER) LLC		200 Stuart ST GARAGE UNIT, BOSTON, MA 02116
500135006	BDD HAK BOSTON REALTY LLC		200 Stuart ST RETAIL UNIT, BOSTON, MA 02116
500139000	201 STUART STREET (OWNER) LLC	C/O CUSHMAN & WAKEFIELD	201-241 Stuart ST, BOSTON, MA 02116
500811000	CITY OF BOSTON		PARK PZ, BOSTON, MA 02116
500812002	EARL OF SANDWICH BOSTON LLC	C/O DAVID CRABTREE	BEACON ST, BOSTON, MA 02116
500812003	WINTER ST ENTERPRISES	C/O KARL VOLMER	BEACON ST, BOSTON, MA 02116
500812004	RBS CITIZENS NA	C/O RYAN LLC	BEACON ST, BOSTON, MA 02116
501185000	FOUR SEASONS PLACE		220-200 Boylston ST, BOSTON, MA 02116
501185002	FSH BOYLSTON INC	C/O ACCOUNTS PAYABLE	200 Boylston ST, BOSTON, MA 02116
501185006	GWC REALTY LLC MASS LLC		220 Boylston ST 8012, BOSTON, MA 02116
501185008	ROMANO JOSEPH J TS		220 Boylston ST 8014, BOSTON, MA 02116
501185010	WONG ROBERT W TS	C/O ROBERT W WONG TS	220 Boylston ST 8016, BOSTON, MA 02116
501185012	GOGGINS KSENIA		220 Boylston ST 8018, BOSTON, MA 02116
501185014	HASMA HOLDINGS LTD	C/O MHC-USA, INC./GERARD TETO	220 Boylston ST 8020, BOSTON, MA 02116
501185017	220 BOYLSTON STREET UNITS 9001/9003 REALTY TRUST		220 Boylston ST 9001-9003, BOSTON, MA 02116
501185019	VACOVEC KENNETH J		220 Boylston ST 9002-9004, BOSTON, MA 02116
501185024	KARABELAS ARGERIS N		220 Boylston ST 9005, BOSTON, MA 02116
501185026	WILLIAMS WILLIAM II TS	C/O CHARLES GATE PROP MGT LLC	220 Boylston ST 9006, BOSTON, MA 02116
501185028	BIGGIO ANDREW A TS	C/O MARIE RANDOLPH	220 Boylston ST 9007, BOSTON, MA 02116
501185030	MARCIA C MORRIS 2013		220 Boylston ST 9008, BOSTON, MA 02116

PID	OWNER	MAIL_ADDRESSEE	FULL_ADDRESS
501185032	THERESE MILLER REVOCABLE TRUST AGREEMENT		220 Boylston ST 9009, BOSTON, MA 02116
501185034	KARA P TULLEY 1994 TRUST		220 Boylston ST 9010, BOSTON, MA 02116
501185036	SST BOSTON III LLC	C/O JAMES HAGERTY, KALBIAN HAGERTY LLP	220 Boylston ST 9011, BOSTON, MA 02116
501185038	FLATTO GAIL		220 Boylston ST 9012, BOSTON, MA 02116
501185040	FALLOS REALTY TRUST		220 Boylston ST 9013, BOSTON, MA 02116
501185042	KATHLEEN A MEYER REVOCABLE TRUST		220 Boylston ST 9014, BOSTON, MA 02116
501185044	RETALS LLC	C/O PARK PROPERTY MANAGEMENT GROUP LLC	220 Boylston ST 9015, BOSTON, MA 02116
501185046	RAUH REALTY TRUST		220 Boylston ST 9016, BOSTON, MA 02116
501185048	RASS HOLDINGS	C/O MHC-USA, INC. GERARD TETO	220 Boylston ST 9017, BOSTON, MA 02116
501185050	BAIN COLLEEN		220 Boylston ST 9018, BOSTON, MA 02116
501185052	BERENSON THEODORE S ETAL		220 Boylston ST 9020, BOSTON, MA 02116
501185054	400 BOYLSTON STREET REALTY TRUST	C/O HICHAM ALI HASSAN	220 Boylston ST 1001, BOSTON, MA 02116
501185056	BRINNER FAMILY INVESTMENT LLC	C/O ROGER BRINNER	220 Boylston ST 1002, BOSTON, MA 02116
501185058	FIVE ARLINGTON-7 NOMINEE TRUST		220 Boylston ST 1003, BOSTON, MA 02116
501185060	ROSE M REALTY TRUST	C/O ROSE M GILFORD	220 Boylston ST 1004, BOSTON, MA 02116
501185062	1005 DF DIMARE FOUR SEASONS REALTY TRUST	C/O CHARLES B DOLAN & JOANNE CIPRIANO DOLAN	220 Boylston ST 1005, BOSTON, MA 02116
501185066	PATTERSON SHEILA M TS	C/O SHEILA M PATERSON TS	220 Boylston ST 1007, BOSTON, MA 02116
501185068	JE REAL ESTATE HOLDINGS LLC		220 Boylston ST 1008, BOSTON, MA 02116
501185070	FALCONE JOSEPH P		220 Boylston ST 1009, BOSTON, MA 02116
501185072	SST BOSTON LLC	C/O JAMES R HAGERTY	220 Boylston ST 1010, BOSTON, MA 02116
501185074	WALDMAN MARVIN TS	C/O WALDMAN HIRSCH & COMPANY LLP	220 Boylston ST 1011, BOSTON, MA 02116
501185076	BOSTON AMA LLC	C/O WALTHER & SHUFFAIN PC	220 Boylston ST 1012, BOSTON, MA 02116
501185078	PILTCH RICHARD		220 Boylston ST 1013, BOSTON, MA 02116
501185081	PORTNOY ELIKA		220 Boylston ST 1014-1016, BOSTON, MA 02116
501185082	MARSHALL JANE W		220 Boylston ST 1015, BOSTON, MA 02116
501185086	LUNDER PETER		220 Boylston ST 1017, BOSTON, MA 02116
501185089	DEMARCH TRUST	C/O DEBORAH C HALE	220 Boylston ST 1018-1020, BOSTON, MA 02116
501185092	BFS1101 LLC	C/O MR. AND MRS. GEORGE N PETROVAS	220 Boylston ST 1101, BOSTON, MA 02116
501185094	STEPHANIE BROWN TRUST - 2003		220 Boylston ST 1102, BOSTON, MA 02116
501185096	MENDELSON MICHAEL E TS	C/O MICHAEL E MENDELSON TS	220 Boylston ST 1103, BOSTON, MA 02116
501185098	SCHEUER ALAN		220 Boylston ST 1104, BOSTON, MA 02116
501185101	BOBCAT FOX LLC	C/O LYNCH FINK HARRINGTON & GRAY LLP	220 Boylston ST 1106, BOSTON, MA 02116
501185102	MOONEY JAMES F III		220 Boylston ST 1107, BOSTON, MA 02116
501185106	MCENCHROE REIT LLC	C/O CROWE	220 Boylston ST 1109, BOSTON, MA 02116
501185108	TRUST DAVID ANDREW	C/O DAVID ANDREW TRUST TS	220 Boylston ST 1110, BOSTON, MA 02116
501185110	BETTY ANN BLUM TRUST	C/O CAPTRUST	220 Boylston ST 1111, BOSTON, MA 02116
501185112	ENG JAMES TS	C/O KENNETH J ENG	220 Boylston ST 1112, BOSTON, MA 02116
501185114	WALBA GERALD B		220 Boylston ST 1114, BOSTON, MA 02116
501185116	ROWERS ROBERT		220 Boylston ST 1115, BOSTON, MA 02116
501185118	REMILLARD JANE E		220 Boylston ST 1116, BOSTON, MA 02116
501185120	PUPS WORLD LLC		220 Boylston ST 1117, BOSTON, MA 02116
501185122	CLAUDIA R SCHWARTZ TRUST	C/O ANTHONY SCHWARTZ	220 Boylston ST 1118, BOSTON, MA 02116
501185124	KARON THELMA H TS		220 Boylston ST 1120, BOSTON, MA 02116
501185126	BASS MICHAEL A TS	C/O BASS, DOHERTY & FINKS	220 Boylston ST 1201, BOSTON, MA 02116
501185128	COONEY JONATHAN		220 Boylston ST 1202, BOSTON, MA 02116
501185130	ROBIN S WEINBERGER REVOCABLE TRUST		220 Boylston ST 1204, BOSTON, MA 02116
501185136	STEIN JAY		220 Boylston ST 1208, BOSTON, MA 02116
501185138	BFS1209 LLC	C/O MR AND MRS GEORGE PETROVAS	220 Boylston ST 1209, BOSTON, MA 02116
501185140	DAT RESIDENTIAL REALTY TRUST	C/O DAT RESIDENTIAL REALTY TRUST/ DAVID ANDREW TRUST	220 Boylston ST 1210, BOSTON, MA 02116
501185142	NNA ASSOCIATES MASS GP		220 Boylston ST 1211, BOSTON, MA 02116
501185144	MURRAY TERRENCE TS		220 Boylston ST 1212, BOSTON, MA 02116
501185146	LIVIS DOREEN E TS		220 Boylston ST 1213, BOSTON, MA 02116
501185148	MMAI LLC		220 Boylston ST 1214, BOSTON, MA 02116
501185150	THOMAS J SWAN JR 1999	C/O CHOATE, HALL & STEWART	220 Boylston ST 1215, BOSTON, MA 02116
501185152	NORMAN KNIGHT REVOCABLE TRUST	C/O JOHN T LYNCH	220 Boylston ST 1216, BOSTON, MA 02116
501185154	KLETJIAN CARMELLA		220 Boylston ST 1217, BOSTON, MA 02116
501185156	REGAN REMILLARD REVOCABLE TRUST OF 2020		220 Boylston ST 1218, BOSTON, MA 02116
501185158	JANE MCGINN BURKE REVOCABLE TRUST		220 Boylston ST 1220, BOSTON, MA 02116
501185160	FOUR SEASONS 1410 TRUST	C/O ANNE FITZPATRICK	220 Boylston ST 1410, BOSTON, MA 02116
501185162	SUSAN S PRIEM REVOCABLE TRUST		220 Boylston ST 1412, BOSTON, MA 02116
501185164	UNIT 1414 NOMINEE TRUST	C/O JOEL E CUTLER	220 Boylston ST 1414, BOSTON, MA 02116
501185166	PETERSON KEVIN		220 Boylston ST 1415, BOSTON, MA 02116
501185168	CUTLER JOEL E		220 Boylston ST 1416-1418, BOSTON, MA 02116
501185172	COX HOWARD E JR		220 Boylston ST 1510, BOSTON, MA 02116
501185174	KRANE DIANE TS	C/O DIANE KRANE TS	220 Boylston ST 1512, BOSTON, MA 02116
501185176	220 BOYLSTON STREET	C/O JOSEPH CIMINO	220 Boylston ST 1514, BOSTON, MA 02116
501185178	EISENSTEIN JAMES S		220 Boylston ST 1515, BOSTON, MA 02116
501185180	JUNO TRUST	C/O J BERGSTROM	220 Boylston ST 1516, BOSTON, MA 02116
501185182	DIMARE REALTY TRUST		220 Boylston ST 1518, BOSTON, MA 02116
501185184	KWT 4 SEASONS REAL ESTATE TRUST	C/O BREED'S HILL CAPITAL	220 Boylston ST 1610, BOSTON, MA 02116
501185186	250B1 LLC		220 Boylston ST 1612, BOSTON, MA 02116
501185190	220 BOYLSTON ST UN 1616 TR		220 Boylston ST 1616, BOSTON, MA 02116
501185192	BERGER MERLE J TS	C/O MERLE BERGER	220 Boylston ST 1618, BOSTON, MA 02116

