

Washington

St.

St.

East Concord

St.

East Newton

James

St.

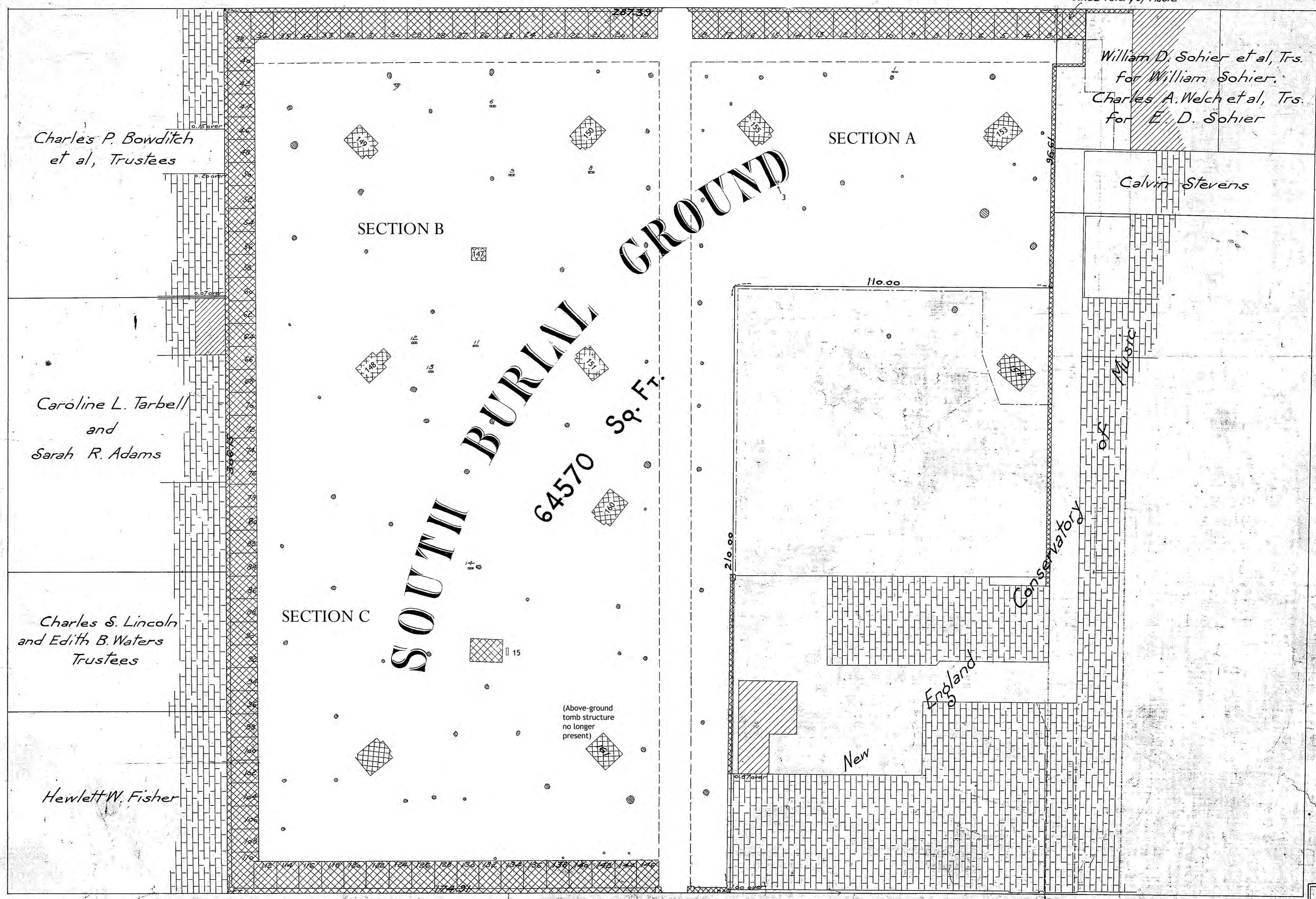

SOUTH BURIAL GROUND
64570 Sq. Ft.

Charles P. Bowditch
et al, Trustees

Caroline L. Tarbell
and
Sarah R. Adams

Charles S. Lincoln
and Edith B. Waters
Trustees

Hewlett W. Fisher

SECTION A

SECTION B

SECTION C

William D. Sohler et al, Trs.
for William Sohler.
Charles A. Welch et al, Trs.
for E. D. Sohler

Calvin Stevens

(Above-ground
tomb structure
no longer
present)

RECORD PLAN
CITY OF BOSTON
SOUTH BURIAL GROUND
BOSTON PROPER
February 18, 1898
William Jackson
City Engineer

K-23

Scale 1/64 feet to an inch

16